

210MM

## SOLAR CHARGER POWER BANK USER MANUAL

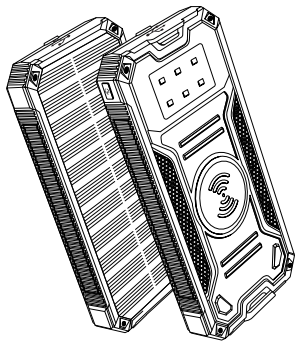

Thank you for purchasing our product, in order to use this product safely, please read the instructions carefully before use, and keep this manual for future reference.

### Function Introduction:

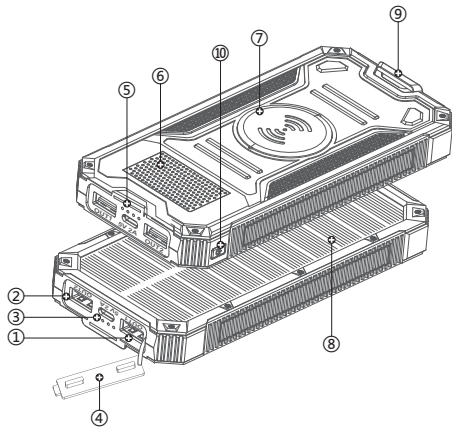

### Product Structure:

- ①Output (USB-OUT1)    ②Output (USB-OUT2)    ③Input    ④Silicone cover  
⑤LED indicator light    ⑥Flashlight    ⑦Wireless charging    ⑧Solar panel  
⑨Hanging rope hole    ⑩Switch button

### Safety Warnings:

- Full charge the product with your first time use;
- If swell, leakage, deformation, immerse in water, short circuit occurs, stop using immediately;
- Don't drop the device or use it in the high temperature, moist, strong magnetic environment;
- Please put the power bank on the place where kids can't reach;
- Don't leave the product on the car dashboard, the high temperature will damage the device cause by strong sunlight irradiation;
- Don't throw any debris in the input output ports, or it may cause damaged or short circuit;
- Avoid the unusual results happen, please use the standard or original packaged charging cable, power adapter etc;
- Don't use the all in one cable to charge multi devices simultaneously, it may cause damage to the power bank;
- Please confirm whether you device input voltage is the same with the power bank's output voltage before charging;
- Over discharge may occur if long time lay aside, in order to not affect the performance, please full charge and discharge the power bank at least every 3 months.

### Warning:

- The device include Li-ion battery cell, don't disassemble the power bank's shell without permission, may cause the cell damaged or other danger;
- Don't disassemble, press, puncture or make it short circuit, don't throw into water, fire or exposed outside that above 140°F, to avoid catching fire and other danger;
- The device has over heat protection, it will stop working when the environment's temperature exceed the normal condition, you should put it in the normal environment, then restore it's output by short press the button.

90MM

### Specification:

- Solar panel specification: 5.9" x 2.7" (1.4W)
- Temperature for use: 32°F~122°F
- Input: 5V/2A
- Output(USB-OUT2): 5V/2.1A
- Charging Time: About 6.5 hours(Use 5V/2A adapter)
- Size: 6.3"L x 3"W x 0.7"H
- Battery type: Li-polymer battery
- Input(Solar charging): 5.5V/170mA
- Output(USB-OUT1): 5V/2.1A
- Output(Wireless Charger): 5W
- Output(Type-C): 5V/2.1A
- Weight: 0.6 lbs

### Instructions:

1. Charge the power bank through power adapter  
Connect with the phone power adapter, you can charge for this power bank, the LED power indicator lights flash when charging, 4 LED power indicator light keep ON when full charged.

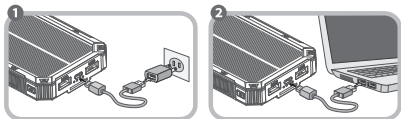

2. Charge the power bank through sunlight  
Put the power bank's solar panel under the sunlight's vertical irradiation or sunny environment (Avoid high temperature, battery may damaged under high temperature condition), the power bank will charge itself by absorbing the sunlight, the solar charging indicator become green at this moment, that means the power banks is being charged by sunlight.

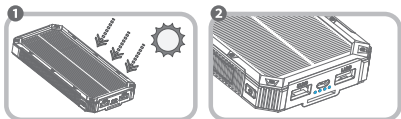

### Please Know:

The solar panel's output power depends on the panel's power itself and sunlight irradiate intensity etc. Due to the natural limitation such as day and night, seasons, geographical latitude, altitude and sunny, cloudy, raining random factors, so the solar irradiance on the ground is unstable, intermittent. During 10:00 AM to 3:00 PM, the atmospheric mass is AM 1.5, irradiate intensity is 1000W/M2, temperature is 77°F, solar panel's output power reach the maximum under this condition.

3. Short press once display the remaining power, the 4 LED indicator shows the power status below

Power indicator:	Light on	Light off	Battery capacity:
	●	●	0%
	●	●	1%-25%
	●	●	25%-50%
	●	●	50%-75%
	●	●	75%-100%

4. The flashlight's turn on and off

- ★Long press the button 4S, flashlight on ⇄ Strong mode;
- ★Then short-press, the flashlight's brightness becomes lower ⇄ Soft mode;
- ★Then short-press is SOS mode ⇄ SOS Mode;
- ★Then short-press is strobe mode ⇄ Warning mode
- ★Then short-press the button to turn off.

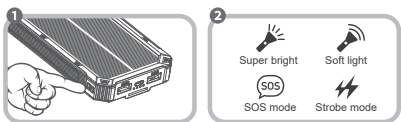

5. Charge the digital electronics by cable

The power bank has 2 USB-A output ports, connect the digital product with any output port, it can charge for the digital product. During the charging process of digital products, the LED battery indicator lights up. When the digital product is full charged, please stop charging to the digital device, and the LED power indicator off.

### Please Note:

When the power remaining is low, the power indicator flash for warning, the device can't output at this moment.

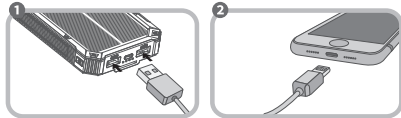

6. Charger for digital electronics with wireless function

Put the digital electronics with wireless function on the power bank's wireless charging area, then short press power button, wireless charging indicator turn on, can charge for digital products.

This power bank has debris detect function, when it detect there is metal debris on the wireless charging area, the wireless charging indicator becomes red, it can work normally after cleaning up the debris.

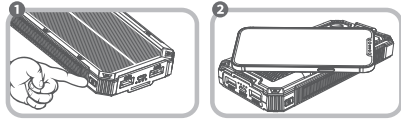

### FCC Caution:

This device complies with part 15 of the FCC Rules. Operation is subject to the following two conditions: (1) This device may not cause harmful interference, and (2) this device must accept any interference received, including interference that may cause undesired operation.

Any Changes or modifications not expressly approved by the party responsible for compliance could void the user's authority to operate the equipment.

**Note:** This equipment has been tested and found to comply with the limits for a Class B digital device, pursuant to part 15 of the FCC Rules. These limits are designed to provide reasonable protection against harmful interference in a residential installation. This equipment generates uses and can radiate radio frequency energy and, if not installed and used in accordance with the instructions, may cause harmful interference to radio communications. However, there is no guarantee that interference will not occur in a particular installation. If this equipment does cause harmful interference to radio or television reception, which can be determined by turning the equipment off and on, the user is encouraged to try to correct the interference by one or more of the following measures:

- Reorient or relocate the receiving antenna.
- Increase the separation between the equipment and receiver.
- Connect the equipment into an outlet on a circuit different from that to which the receiver is connected.
- Consult the dealer or an experienced radio/TV technician for help.

The device has been evaluated to meet general RF exposure requirement. The device can be used in portable exposure condition without restriction.