



# User Manual

# Emergency Stop Transmitter/Receiver User Manual

**QW045**

Emergency Stop Transmitter



**QW046**

Emergency Stop Receiver



# Emergency Stop Transmitter/Receiver User Manual

---

## 1. How to use

Connect the transmitter and receiver as shown in Figure 1.

Transmitter:

When wirelessly connected to the receiver, the Green LED blinks once every 2 seconds in standby mode. When Emergency SW is pressed, a signal is transmitted wirelessly and the RED LED blinks once every 2 seconds.

When the receiver sends an INPUT signal, the RED LED is displayed as On.

Receiver:

When you press the Emergency SW on the transmitter, an emergency stop signal (Emergency Stop Relay) is output from the receiver.

When the INPUT input on the receiver is set to LOW, a RED LED is displayed on the transmitter.

## 2. Caution

The transmitter must always be charged, and if the internal battery voltage is low, malfunction or inability to operate may occur.

## 2. Function description

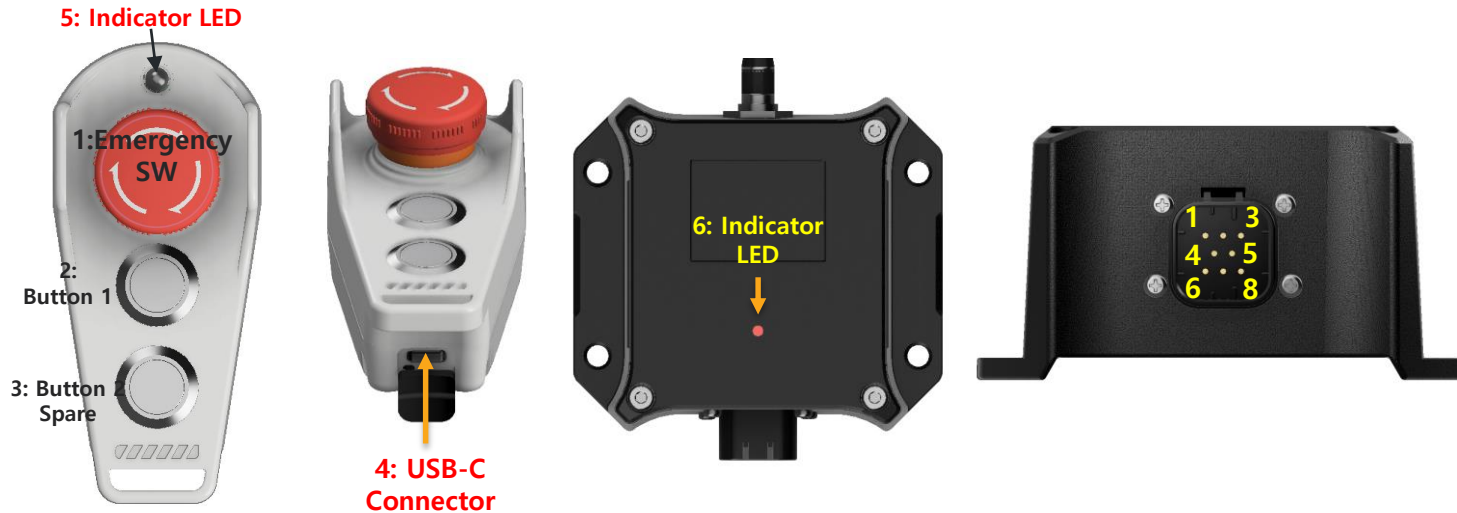

No	Name	Spec.	function	No	Pin NAME	Function	Output
1	Emergency SW	Emergency Button Switch	Emergency Stop	1	Power 24V	Power In (+)	
2	BUTTON SW1	Push Button Switch	Broadcast an emergency stop signal	2	Power 0V	Power In (-)	
3	BUTTON SW2(Spare)	Push Button Switch	Spare	3	HIGH OUT	+OutPut	+24V
4	USB-C Connector	USB-C	For battery charging	4	GND_IN	Input GND	
5	Indicator LED (Transmitter)	RGB 3 color	* Green Flicker : RF Connection OK. * Red Flicker : Emergency SW ON * Blue : charging	5	INPUT	Input (LOW)	
				6	N.C		
				7	RELAY	Emergency Stop Output Relay	Normal Open
6	Indicator LED (Receiver)	GREEN,RED	* Green Flicker : RF Connection OK. * Red On : Emergency IN	8	RELAY_1_COM	Emergency Stop Output Relay	Normal Open

### 3. Emergency Stop Transmitter/Receiver Connection Diagram

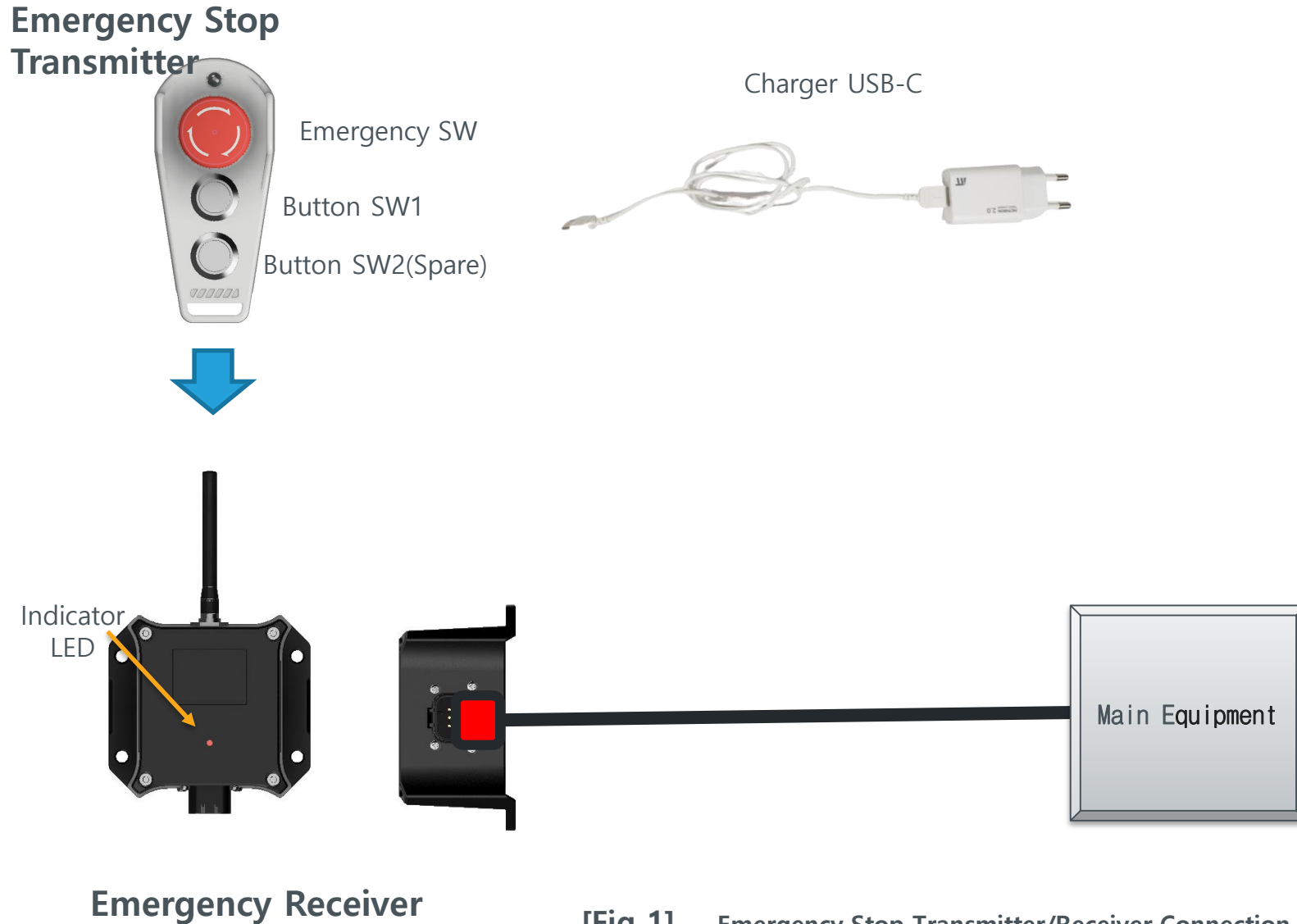

[Fig 1] Emergency Stop Transmitter/Receiver Connection Diagram

## 4. FCC/IC Compliance Statement

This device complies with Part 15 of the FCC Rules and Industry Canada license-exempt RSS standard(s).

Operation is subject to the following two conditions: (1) this device may not cause harmful interference, and (2) this device must accept any interference received, including interference that may cause undesired operation.

**CAUTION :** Any Changes or modifications not expressly approved by the manufacturer could void the user's authority to operate the equipment. This equipment has been tested and found to comply with the limits for a Class B digital device, pursuant to part 15 of the FCC Rules. These limits are designed to provide reasonable protection against harmful interference in a residential installation. This equipment generates, uses and can radiate radio frequency energy and, if not installed and used in accordance with the instructions, may cause harmful interference to radio communications. However, there is no guarantee that interference will not occur in a particular installation. If this equipment does cause harmful interference to radio or television reception, which can be determined by turning the equipment off and on, the user is encouraged to try to correct the interference by one or more of the following measures:

- Reorient or relocate the receiving antenna.
- Increase the separation between the equipment and receiver.
- Connect the equipment into an outlet on a circuit different from that to which the receiver is connected.
- Consult the dealer or an experienced radio/TV technician for help.

(For Receiver) A minimum separation distance of 20 cm must be maintained between the antenna and the person for this appliance to satisfy the RF exposure requirements.

Enonce d'Industrie Canada(IC)

Le present appareil est conforme aux CNR d'Industrie Canada applicables aux appareils radio exempts de licence. L'exploitation est autorisee aux deux conditions suivantes : (1) l'appareil ne doit pas produire de brouillage, et (2) l'utilisateur de l'appareil doit accepter tout brouillage radioelectrique subi, meme si le brouillage est susceptible d'en compromettre le fonctionnement.

Tout changement ou modification non expressement approuve par la partie chargee de la mise en conformite peut annuler le droit de l'utilisateur a utiliser l'equipement.

(For Receiver) Pour le récepteur) Une distance de séparation minimale de 20 cm doit être maintenue entre l'antenne et la personne pour que cet appareil satisfasse aux exigences d'exposition aux RF.

(For Transmitter) This equipment complies with FCC radiation exposure limits set forth for an uncontrolled environment.

(For Transmitter) Cet équipement est conforme aux limites d'exposition aux rayonnements IC établies pour un environnement non contrôlé.

"This device contains licence-exempt transmitter(s)/receiver(s) that comply with Innovation, Science and Economic Development Canada's licence-exempt RSS(s). Operation is subject to the following two conditions:

This device may not cause interference.

This device must accept any interference, including interference that may cause undesired operation of the device."