



**Product Name: Tablet PC**

**Model Name: IRADUO PRO**

Quick service manual

### **Special Explanation:**

**The new machine you got has entered the transportation mode, please try the matching charger and data cable to connect the tablet activation, and then press the power button to boot**

# Understand the equipment

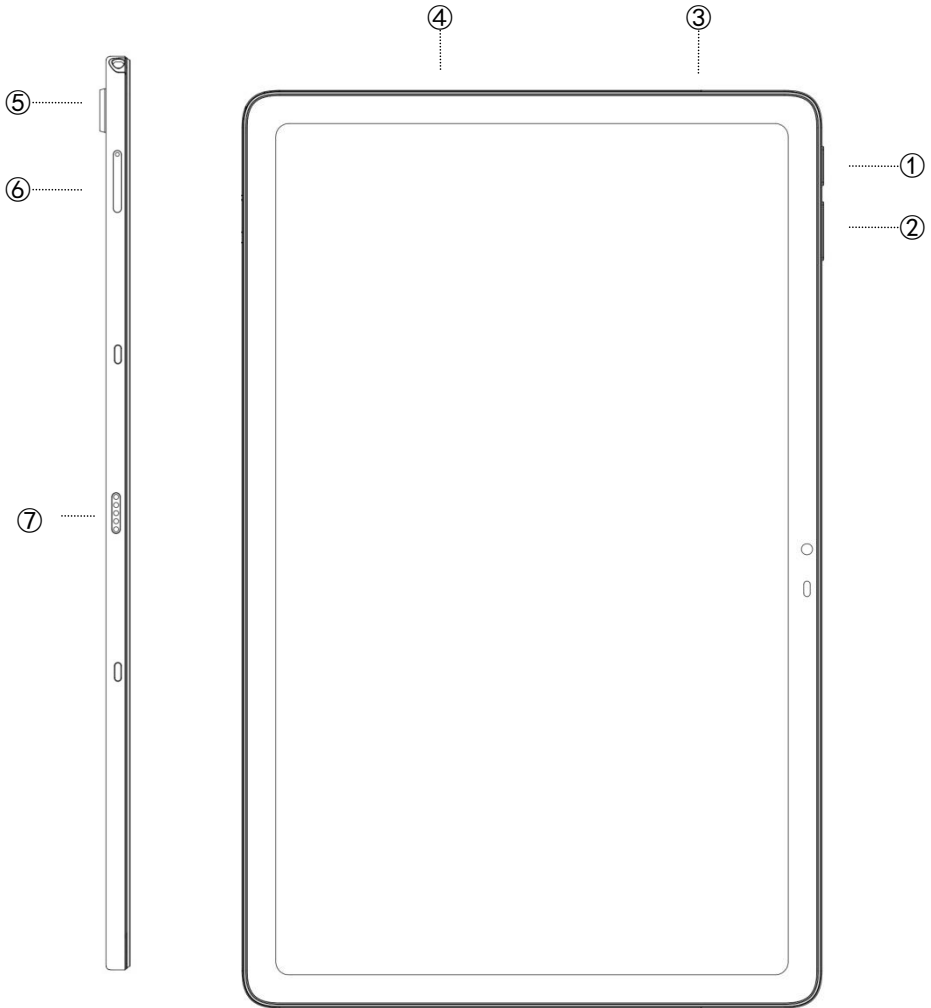

① Power button ② Volume key ③ USB Type-c interface ④ USB Type-c interface (charge only)

⑤ 3.5 Headphone jack ⑥ SIM / TF card slot ⑦ keyboard contact point

# Product Parameter

name	parameter
CPU	USM9620 (T760) octacore frequency 2.2 Ghz
memory	6GB+128GB
camera	Top 8MP (FF) + Back 13MP (AF)
network	Supports 4G cellular network, WiFi, and Bluetooth BT5.0
show	10.95-inch HD display resolution 1200 * 1920
joggle	1 * 5G SIM card slot 2 * Type-C 1*3.5mm headphone audio
cell	7000 mAh battery, standard with a charger
fingerboard	Special leather case keyboard
operating system	android14.0
Machine size	256.87*168.42*7.25mm (length * width * thick)

## Take / insert card instructions

- When using the card needle, please pay attention to safety to prevent finger injury or damage to the equipment.
  - Please take good care of the card needles and place them in a safe area to prevent children from inadvertently swallowing or injuring themselves.
  - The card slot allows for two nano-SIM cards or one nano-SIM card + one TF memory card.
  - Use a standard nano-SIM card or it may cause Cato damage causing the device to recognize the SIM card.
- ⑩ Please refer to the figure below to complete the operation of inserting the card. Please use the matching card pin when taking the card. Pay attention to the direction when inserting the card, and keep the cato horizontal direction.

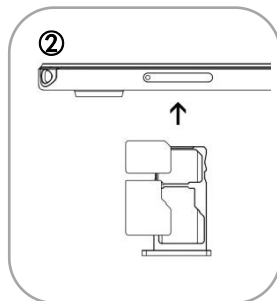
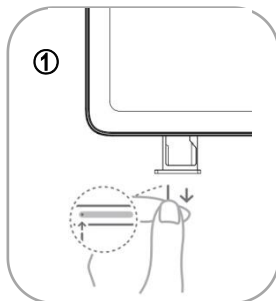

## **Get more**

If you encounter any problems in the use process, you can get more help information through the following ways and methods.

- Please visit <https://www.cerbook.com> for product information, more help, and other information.

## **security information**

[Warning] Before using and operating the equipment, to ensure the best performance of the equipment and to avoid dangerous or illegal situations, please consult and follow all safety information.

## **Operation and safety**

- Hearing damage is dangerous, please do not listen for a long time.
- Please use this product in the temperature range of  $0^{\circ}\text{C} \sim 35^{\circ}\text{C}$ , and store it in the range of  $-20^{\circ}\text{C} \sim +45^{\circ}\text{C}$ .
- This product USB Type-C, the interface can accept the power supply capacity of  $5.0\text{ V} = 2.0\text{ A}$  or  $9.0\text{ V} = 2.0\text{ A}$ .
- Power plug as disconnection device, power socket should be installed near the product and should be easy to operate.
- There is a risk of fire or explosion if the incorrect model battery is replaced.
- Do not expose the battery to high temperatures or around heating products, such as sunlight, heater, microwave, oven or water heater. An overheated battery may cause an explosion.
- Do not place the battery in an very low pressure environment that may cause an explosion or leakage of flammable liquid or gas.
- Do not throw the battery into the fire as it will cause a battery fire and explosion.

- The equipment adopts the non-removable built-in battery. Do not replace the battery by itself to avoid the normal operation of the equipment or battery damage. For your personal safety and to ensure the normal operation of the product, you are strongly recommended to replace the original battery of this equipment.
- When charging or not, disconnect the power adapter from the device and unplug the power adapter from the power socket.
- Do not use power adapter in wet places (such as sink, bathtub or shower), do not plug out power adapter with wet hand.
- Use of unapproved or incompatible power supplies, power adapter or battery may cause fire, explosion or other hazards.
- When the product is not sold with a power adapter, if the consumer uses the power adapter for power supply, they should buy a power adapter that meets the corresponding safety standards or a CCC certified power adapter.
- Upgrading device firmware and systems using unauthorized third-party software, there may be security risks such as not usable or leaking your personal information. It is recommended that you use an online upgrade or send your device to your nearby customer service center.



- Radio waves or containing magnets generated by devices may affect the normal operation of implantable medical devices or personal medical devices, such as pacemakers, cochlear implants, hearing aids, etc. If you use these medical devices, consult your manufacturer about the restrictions.
- When using this device, maintain a distance of at least 15 cm from the implanted medical device (e. g. pacemakers, cochlea, etc.).
- Only accessories approved by the equipment manufacturer and compatible with this type shall be used. If other types of accessories are used, they may violate the warranty terms of the equipment and the relevant regulations of the country where the equipment is located, and may lead to safety accidents. For approved accessories, please contact the Customer Service Center.
- To prevent data loss, it is recommended that you back up during daily use, before equipment upgrade or before repair.
- The exterior surface of the device keys and the camera decoration are treated with insulation coating, and the corresponding surface is an insulator.
- Do not drop, squeeze, or puncture the battery. Avoid exposing the battery to large external pressure, which leads to a short circuit and overheating inside the battery.
- Do not disassemble or modify the battery, insert a foreign matter, or immerse it in water or other liquid to avoid battery leakage, overheating, fire or explosion.
- Please dispose of the battery according to local regulations, not as household waste. If the battery is not disposed of properly, the battery may explode.

## Special substances

Part name	Name and content of hazardous substances in the product					
	lead (Pb)	mercury (Hg)	cadmium (Cd)	hexavalent chromium (Cr (VI) )	Polybrominated biphenyl (PBB)	Polybromodiphenyl ether (PBDE)
main engine	<input type="radio"/>	<input type="radio"/>	<input type="radio"/>	<input type="radio"/>	<input type="radio"/>	<input type="radio"/>
cell	<input type="radio"/>	<input type="radio"/>	<input type="radio"/>	<input type="radio"/>	<input type="radio"/>	<input type="radio"/>
charger	<input type="radio"/>	<input type="radio"/>	<input type="radio"/>	<input type="radio"/>	<input type="radio"/>	<input type="radio"/>
Shell material	<input type="radio"/>	<input type="radio"/>	<input type="radio"/>	<input type="radio"/>	<input type="radio"/>	<input type="radio"/>
appendix	<input type="radio"/>	<input type="radio"/>	<input type="radio"/>	<input type="radio"/>	<input type="radio"/>	<input type="radio"/>

\* This form is prepared according to the provisions of SJ / T 11364.



○: It indicates that the content of the harmful substance in all homogeneous materials of the component is below the limit requirements specified in GB / T26572.

⊙: It means that the content of the harmful substance in at least one of the homogeneous material of the component exceeds the limit requirements specified in GB / T26572.

Note: 1. PCBA includes the printed circuit board and its spare parts, components, solder joints, etc.

2. Depending on the product model, the product you buy may not contain all of the above parts.
3. The environmental protection service life of this product is 10 years, some removable parts will have different environmental protection service life, these environmental protection service life is separately posted on the corresponding parts.
4. The environmental protection service life of the product / component is only applicable to the product for use under the conditions specified in the product description.

## **disclaimer**

The copyright of the Quick Use Guide is owned by Shaanxi Cloud Voice.

This guide is for reference only, and does not constitute any form of commitment. Products (including but not limited to color, size, screen display, etc.), please refer to the physical object. In case of any discrepancy between the description of this guide and the official website, please follow the official website without further notice.

## **privacy protection**

To see how we can protect your personal information, please visit <https://help.cerbook.com/agreement.html#PrivacyTerms>  
Read about our privacy policy.

# warranty card

In order to provide you with better after-sales service and protect your legitimate rights and interests, please complete the warranty card.

surname and personal name:

contact number:

address:

SN a sign or object indicating number:

date of purchase:

Place of purchase:

invoice number:

remarks:

Warranty record		
Warranty time	question	Warranty results

### FCC Statement

Tablet PC has been tested and found to comply with the limits for a Class B digital device, pursuant to part 15 of the FCC Rules. These limits are designed to provide reasonable protection against harmful interference in a residential installation. This equipment generates, uses and can radiate radio frequency energy and, if not installed and used in accordance with the instructions, may cause harmful interference to radio communications. However, there is no guarantee that interference will not occur in a particular installation. If this equipment does cause harmful interference to radio or television reception, which can be determined by turning the equipment off and on, the user is encouraged to try to correct the interference by one or more of the following measures:

- Reorient or relocate the receiving antenna.
- Increase the separation between the equipment and receiver.
- Connect the equipment into an outlet on a circuit different from that to which the receiver is connected.
- Consult the dealer or an experienced radio/TV technician for help.

Caution: Any changes or modifications to this device not explicitly approved by manufacturer could void your authority to operate this equipment.

This device complies with part 15 of the FCC Rules. Operation is subject to the following two conditions:

This device may not cause harmful interference, and (2) this device must accept any interference received, including interference that may cause undesired operation.

### Specific Absorption Rate (SAR) information:

Tablet PC meets the government's requirements for exposure to radio waves. The guidelines are based on standards that were developed by independent scientific organizations through periodic and thorough evaluation of scientific studies. The standards include a substantial safety margin designed to assure the safety of all persons regardless of age or health. FCC RF Exposure Information and Statement the SAR limit of USA (FCC) is 1.6 W/kg averaged over one gram of tissue. Device types: Tablet PC has also been tested against this SAR limit.

This device was tested for typical body-worn operations with the back of the Tablet PC kept 0mm from the body. To maintain compliance with FCC RF exposure requirements, use accessories that maintain an 0mm separation distance between the user's body and the back of the Tablet PC. The use of belt clips, holsters and similar accessories should not contain metallic components in its assembly. The use of accessories that do not satisfy these requirements may not comply with FCC RF exposure requirements, and should be avoided.