

Wireless Charging

Instructions Manual

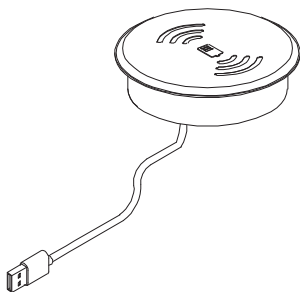

Version : 2025.04.11

Thank you for purchasing our Wireless Charging. Please read the user manual for a quick start with the product and keep it in a safe place for future reference.



IMPORTANT SAFETY INFORMATION

SAVE THESE INSTRUCTIONS

- Read and understand all of these instructions before using this product.
Read all instructions and warnings prior to using this product. Improper use of this product may result in product damage, excess heat, toxic fumes, fire or explosion.
- Keep these instructions in a safe place for future reference.
- For use with 120V, 60Hz electrical power supply (Not Included) only.
Not to be used with travel converters.

SPECIFICATIONS

Product Standard: Qi

Input: USB 5V/2A

Working Frequency: 115–205KHz

Operation Temperature Range: 0~40°C

Storage Temperature Range: -20~40°C

Operation Humidity: 10% ~ 80% RH

Storage Humidity: 5% ~ 95% RH

Compatibility: Qi-enabled devices, iPhone X or later, Samsung Galaxy S8, S8 Plus/S8+, S7, S7 Edge, Samsung Galaxy S3/S4/S5, Note 3/Note2 etc., and other devices with receiver card or receiver case, ect.

CHARGING YOUR WIRELESS DEVICE

- Connect the Wireless Charging to any 5V/2A USB power supply (not included). Be sure connections are secure.
- You may also hear a tone from your device indicating it is connected and charging properly.
- When removing the device from the charging pad, you may notice it feels warm during charging or if left on the charger after reaching full charge. This is normal.
- Remove the device once fully charged, as shown on the display. Some warmth during charging is normal and expected.

OPERATION

- Place a supported mobile device on the Wireless Charging.
- Check the charging icon displayed on the mobile device's screen for the charging status.

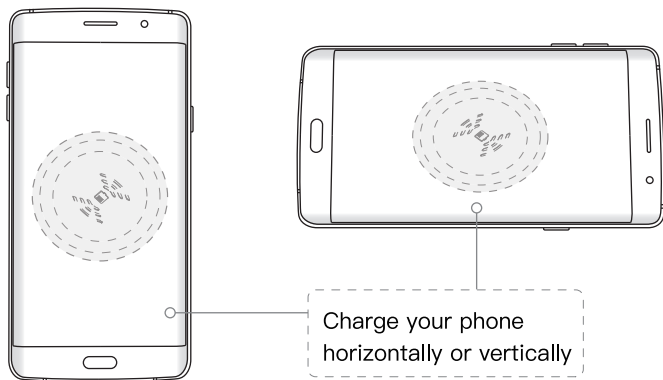

PRECAUTIONS

- Do not apply pressure to or impact this product.
- Do not disassemble or modify the device.
- Keep away from fire and liquids. Do not submerge in water.
- Avoid using in extremely hot, humid, or corrosive environments to prevent circuit damage.
- Keep magnetic / chip cards (e.g., ID, credit cards) at least 4 inches (10 cm) away to avoid data corruption.
- Maintain a minimum 8-inch (20 cm) distance from implanted medical devices (pacemakers, cochlear implants, etc.) to prevent interference.
- This is not a toy. Keep out of children's reach.
- For best performance, avoid high-temperature areas or surfaces that block ventilation (e.g., bedsheets, carpets).

Manufacturers:

Dongguan Baiyou Electronics Co.,Ltd

2nd Floor,Building A,Wufeng Industrial Zone,No.21 Jintan Road,Danwu Village,Shiqi Town,Dongguan City



This device complies with part 15 of the FCC Rules. Operation is subject to the following two conditions: (1) This device may not cause harmful interference, and (2) this device must accept any interference received, including interference that may cause undesired operation.

Any Changes or modifications not expressly approved by the party responsible for compliance could void the user's authority to operate the equipment.

Note: This equipment has been tested and found to comply with the limits for a Class B digital device, pursuant to part 15 of the FCC Rules. These limits are designed to provide reasonable protection against harmful interference in a residential installation. This equipment generates uses and can radiate radio frequency energy and, if not installed and used in accordance with the instructions, may cause harmful interference to radio communications. However, there is no guarantee that interference will not occur in a particular installation. If this equipment does cause harmful interference to radio or television reception, which can be determined by turning the equipment off and on, the user is encouraged to try to correct the interference by one or more of the following measures:

- Reorient or relocate the receiving antenna.
- Increase the separation between the equipment and receiver.
- Connect the equipment into an outlet on a circuit different from that to which the receiver is connected.
- Consult the dealer or an experienced radio/TV technician for help.
- This equipment complies with FCC radiation exposure limits set forth for an uncontrolled environment. This equipment should be installed and operated with minimum distance 20cm between the radiator & your body.