

“Hopeway”device Start Guide

Download APP

Method 1: You can scan the QR code and download the “hopeway” .



Register and Login

Support email and third-party registration and login.

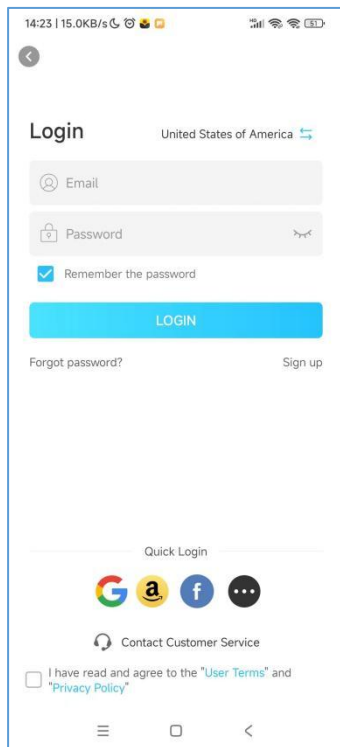

Method 2:

Android:

Search “hopeway” and download from Google Play.

iPhone:

Search “hopeway” and download from App Store.



Add WiFi device

- (1) Power on the camera, and wait for the camera indicator light flashes.
- (2) Log in to the "hopeway" app, enable the Bluetooth function on your phone, click the "+" add button on the interface, and enter the automatic device search interface.
- (3) Find the device you need to add in the search results, click the "Add" button on the right, and follow the interface to add the device.

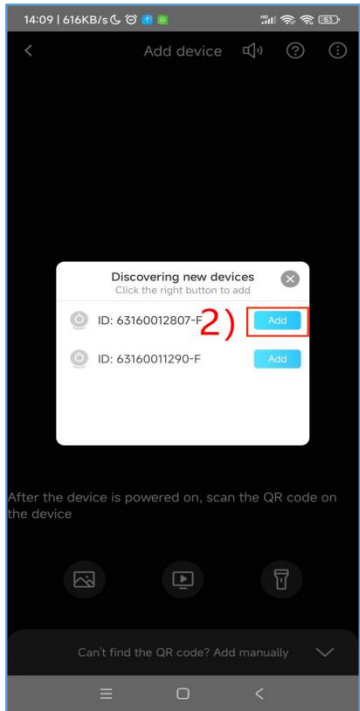
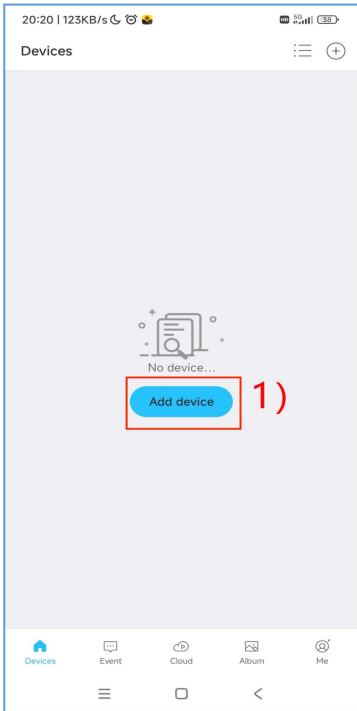

Add 4G device

- (1) Insert the SIM card into the device.
- (2) Turn on the camera and wait for the camera's network indicator to stay on.
- (3) Log in to the "hopeway" app, Scan the QR code on the body of the came to add device.

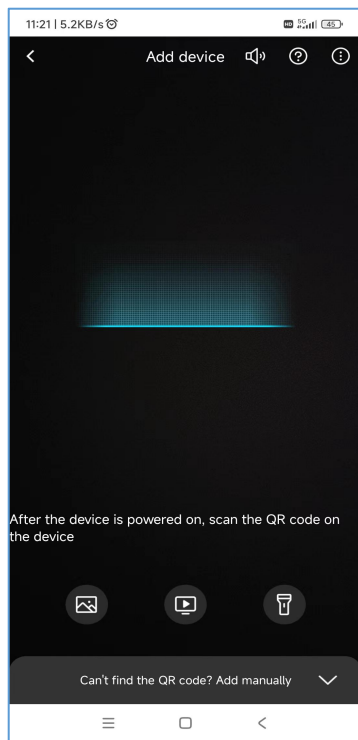
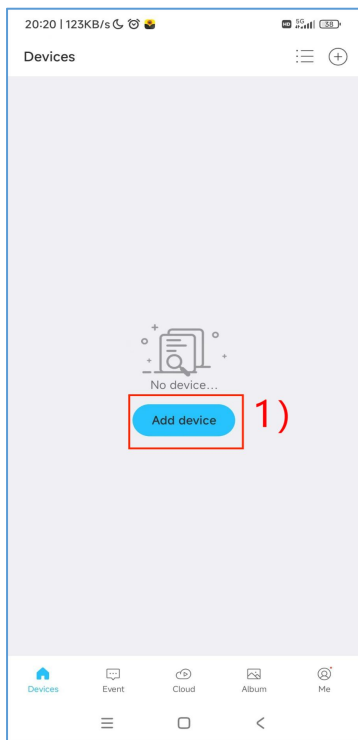

Function introduction

Introduction to the device list function

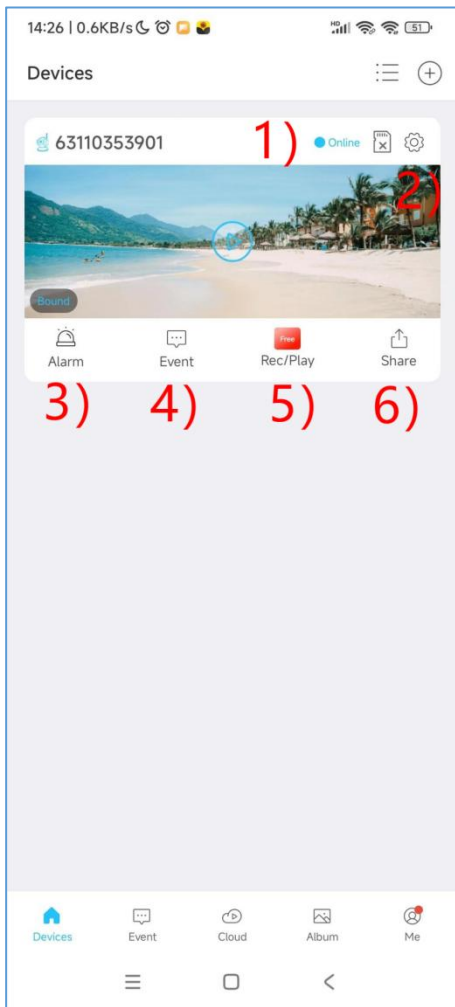

1) Online status:

Online means the device is online.

Offline means the device is offline.

2) Device settings

3) Alarm, open device alarm notification.

4) Event, view the alarm message

5) Rec/Play, tf card recording video and cloud recording.

6) Share, share devices with family or friends.

Introduction to the player interface

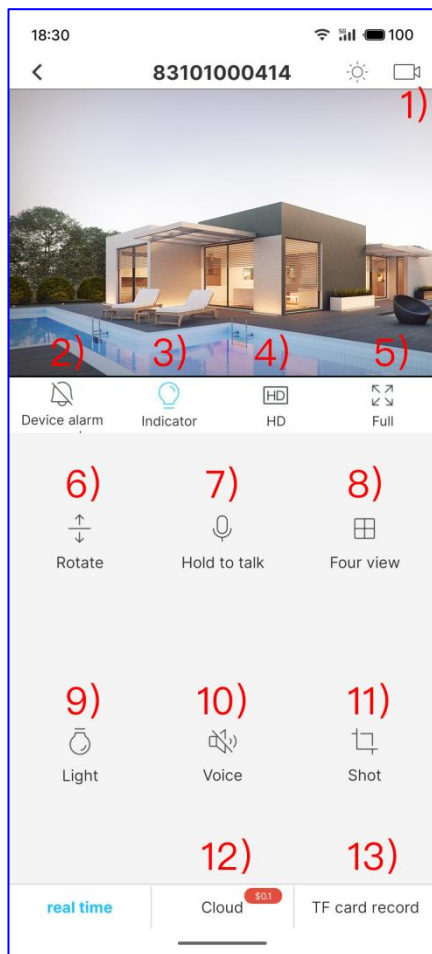

- 1) Record the real-time video and save it to the phone.
- 2) Turn the camera alarm sound on or off.
- 3) Turn the camera indicator on or off.
- 4) Switch video resolution.
- 5) Full screen.
- 6) Set the camera to flip vertically.
- 7) Press and hold the button for intercom.
- 8) 4-screen, single-screen switching.
- 9) Set the night vision light on mode.
- 10) Hear the sound of the camera.
- 11) Take screenshot photos.
- 12) Watch cloud recordings.
- 13) View SD card recordings.

Cloud services

What is cloud storage?

Cloud storage is a safe and reliable cloud video storage service for smart device users.

Why buy cloud storage

(1) Stable and reliable: Cloud recording will not lose data due to damage to the memory card, and there is no need to worry about the leakage of private data due to the memory card being stolen.

(2) Data security: Cloud video will not be lost due to the device being stolen or damaged. When the device is stolen or damaged, the previous video will remain in the cloud within the validity period of the cloud video. The owner can view and download it anytime, anywhere. For "video evidence that cannot be stolen".

Steps to purchase cloud storage

Click the "Rec/Play" button in the device list to enter the cloud storage package interface and then You can buy Cloud storage.

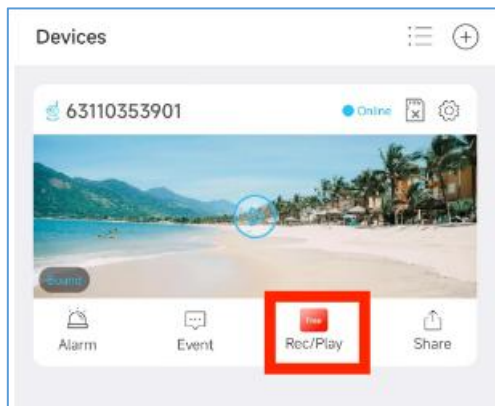

FCC Caution:

This device complies with part 15 of the FCC Rules. Operation is subject to the following two conditions: (1) this device may not cause harmful interference, and (2) this device must accept any interference received, including interference that may cause undesired operation.

Any changes or modifications not expressly approved by the party responsible for compliance could void the user's authority to operate the equipment.

NOTE: This equipment has been tested and found to comply with the limits for a Class B digital device, pursuant to Part 15 of the FCC Rules. These limits are designed to provide reasonable protection against harmful interference in a residential installation. This equipment generates, uses and can radiate radio frequency energy and, if not installed and used in accordance with the instructions, may cause harmful interference to radio communications. However, there is no guarantee that interference will not occur in a particular installation. If this equipment does cause harmful interference to radio or television reception, which can be determined by turning the equipment off and on, the user is encouraged to try to correct the interference by one or more of the following measures:

- Reorient or relocate the receiving antenna.
 - Increase the separation between the equipment and receiver.
 - Connect the equipment into an outlet on a circuit different from that to which the receiver is connected.
 - Consult the dealer or an experienced radio/TV technician for help.
- To maintain compliance with FCC's RF Exposure guidelines, This equipment should be installed and operated with minimum distance between 20cm the radiator your body: Use only the supplied antenna.