

Quick Start Guide

Solar-powered Security PT Camera

What's in the box



Camera

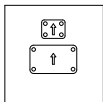

Drill template



USB power cable

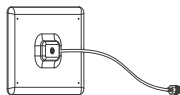

Solar panel
(including USB connector sealing ring)



Bracket



installation drill template

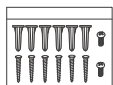

Screws



Extension cable



Warning sticker





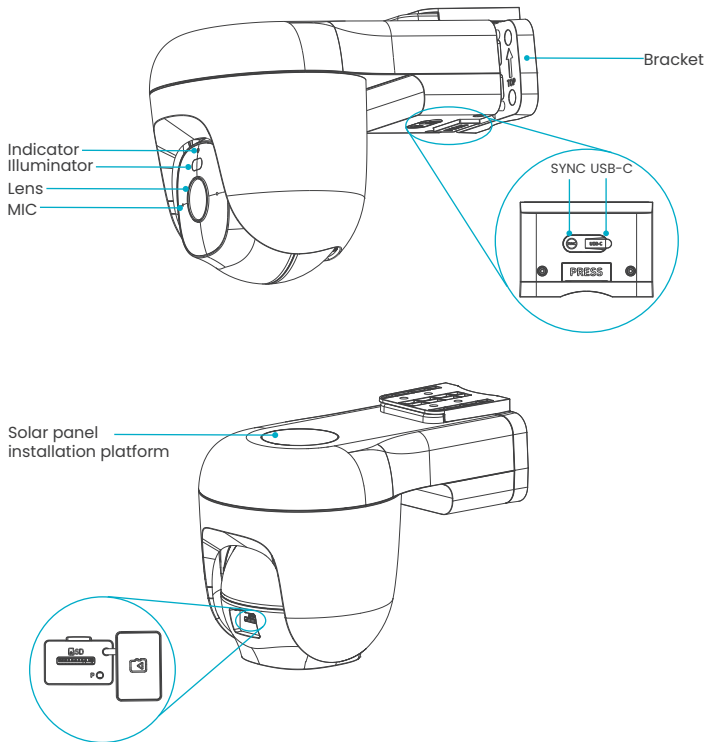

Product documents

Product Overview



**Note:**

- To use the storage function, please prepare a Micro SD card.
- Press and hold the SYNC button for more than 3 seconds to start the device; press and hold the SYNC button for more than 8 seconds to reset the device.

Indicator Light

| Status | Description |
|---|--|
|  Blinking green | Enter network configuration status (press and hold the SYNC button for 3s) Connect to Bluetooth during the network configuration process Network connection successful |
|  Steady green | Connected to the network |
|  Steady red | Device is starting up |
|  Blinking red | The system has started up, but network configuration is not completed, or connection failed during network configuration |

Please fully charge the device before first use (power adapter not supplied).

-  Steady red: Charging
-  Steady green: Fully charged



App installation and set up the system

1. Download and install the app

Option 1: Scan the QR code on the Quick Guide to download and install the app.

Option 2: Search “youkey life” in app stores to download and install the app.

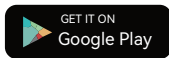

2. Add device

Open the app and sign up for an account. Tap  or Add Device, select the device type, and follow the on-screen instructions to add the device.

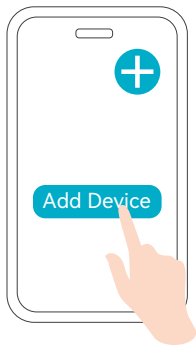

Mount Your Device

1. Choose installation location

For normal device operation, please install the solar panel in direct sunlight; avoid shaded areas.

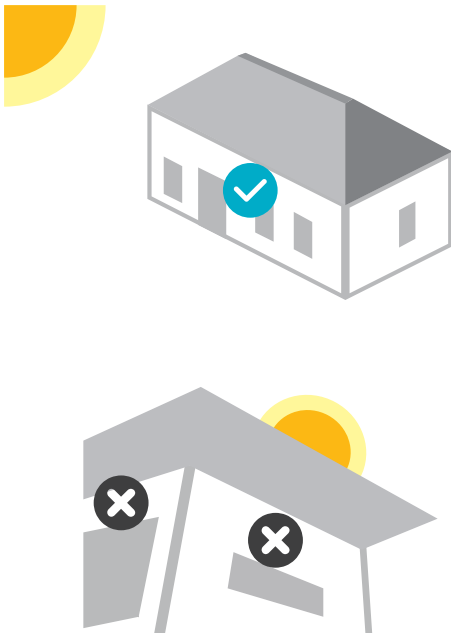

Mount Your Device

2. Mount the device

①

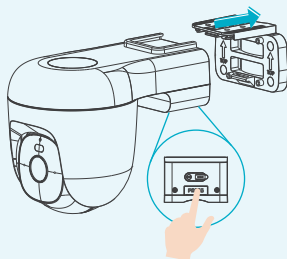

Press the PRESS button to move the bracket in the indicated direction.

②

Wall mount

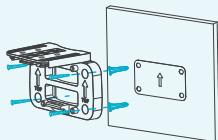

Ceiling mount

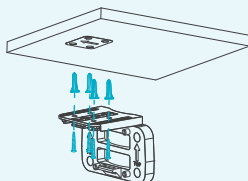

Drill holes using the drill template, and then use plastic expansion tubes and screws to fix the bracket to the wall.

Mount Your Device

Option 1: Integrated installation of camera and solar panel
(suitable for locations with ample unobstructed sunlight)

③

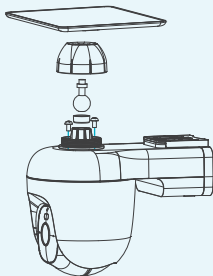

Mount the solar panel onto the camera.

④

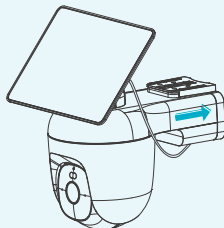

Mount the camera onto the bracket, connect the cables, and use the USB connector sealing ring for waterproofing.

Mount Your Device

Option 1: Integrated installation of camera and solar panel

(suitable for locations with ample unobstructed sunlight)

⑤

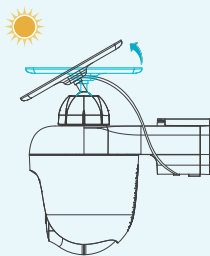

Adjust the solar panel direction for maximum sunlight exposure.

Mount Your Device

Option 2: Separate installation of camera and solar panel

③

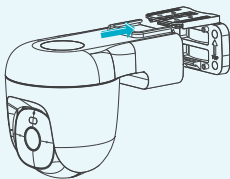

Mount the camera onto the bracket.

④

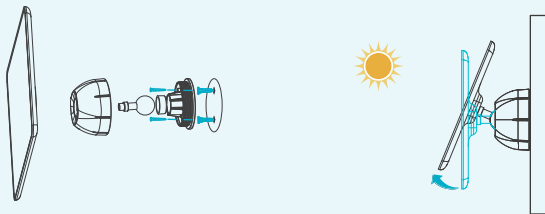

Mount the solar panel onto the wall, adjust the solar panel direction for maximum sunlight exposure.

Mount Your Device

Option 2: Separate installation of camera and solar panel

⑤

Wall mount

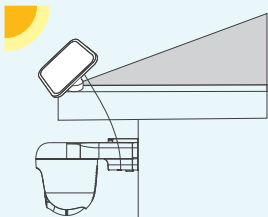

Ceiling mount

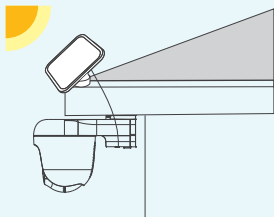

Connect the cables, use the USB connector sealing ring for waterproofing. If the original cable is not long enough, please use the supplied extension cable for connection. Do not pull the cable forcefully.

Disclaimer and Safety Warnings

Copyright Statement

No part of this manual may be copied, reproduced, translated or distributed in any form or by any means without prior consent in writing from our company (referred to as us hereafter).

The product described in this manual may contain proprietary software owned by our company and its possible licensors. Unless permitted, no one is allowed to copy, distribute, modify, abstract, decompile, disassemble, decrypt, reverse engineer, rent, transfer, or sublicense the software in any form or by any means.

EU Authorised Representative

UNV Technology EUROPE B.V. Treubstraat 1, 2288 EG, Rijswijk, Netherlands.

About This Manual

- This manual is intended for multiple product models, and the photos, illustrations, descriptions, etc. in this manual may be different from the actual appearances, functions, features, etc. of the product.
- This manual is intended for multiple software versions, and the illustrations and descriptions in this manual may be different from the actual GUI and functions of the software.
- Despite our best efforts, technical or typographical errors may exist in this manual. Our company cannot be held responsible for any such errors and reserves the right to change the manual without prior notice. Users are fully responsible for the damages and losses that arise due to improper operation.
- Our company reserves the right to change any information in this manual without any prior notice or indication. Due to such reasons as product version upgrade or regulatory requirement of relevant regions, this manual will be periodically updated.

Safety Warnings

The device must be installed, serviced and maintained by a trained professional with necessary safety knowledge and skills. Before you start using the device, please read through this guide carefully and make sure all applicable requirements are met to avoid danger and loss of property.

Storage, Transportation, and Use

- Store or use the device in a proper environment that meets environmental requirements, including and not limited to, temperature, humidity, dust, corrosive gases, electromagnetic radiation, etc.
- Make sure the device is securely installed or placed on a flat surface to prevent falling.
- Unless otherwise specified, do not stack devices.
- Ensure good ventilation in the operating environment. Do not cover the vents on the device. Allow adequate space for ventilation.
- Protect the device from liquid of any kind.
- Make sure the power supply provides a stable voltage that meets the power requirements of the device. Make sure the power supply's output power exceeds the total maximum power of all the connected devices.
- Verify that the device is properly installed before connecting it to power.
- Do not remove the seal from the device body without consulting our company first. Do not attempt to service the product yourself. Contact a trained professional for maintenance.
- Always disconnect the device from power before attempting to move the device.
- Take proper waterproof measures in accordance with requirements before using the device outdoors.

Power Requirements

- Install and use the device in strict accordance with your local electrical safety regulations.
- Use a UL certified power supply that meets LPS requirements if an adapter is used.
- Use the recommended cordset (power cord) in accordance with the specified ratings.
- Only use the power adapter supplied with your device.
- Use a mains socket outlet with a protective earthing (grounding) connection.
- Ground your device properly if the device is intended to be grounded.

Battery Use Caution

•When battery is used, avoid:

High or low extreme temperatures during use, storage and transportation;
Extremely low air pressure, or low air pressure at high altitude.

Battery replacement.

•Use the battery properly. Improper use of the battery such as the following may cause risks of fire, explosion or leakage of flammable liquid or gas.

Replace battery with an incorrect type;

Dispose of a battery into fire or a hot oven, or mechanically crushing or cutting of a battery;

•Dispose the used battery according to your local regulations or the battery manufacturer's instructions

•Personal safety warnings:

Chemical Burn Hazard. This product contains a coin cell battery. Do not ingest battery. If the coin cell battery is swallowed, it can cause severe internal burns in just 2 hours and can lead to death.

Keep new and used batteries away from children.

If the battery compartment does not close securely, stop using the product and keep it away from children.

If you think batteries might have been swallowed or placed inside any part of the body, seek immediate medical attention.

Avertissement de l'utilisation de la batterie

•Lorsque utiliser la batterie, évitez:

Températures extrêmement élevées ou basses pendant l'utilisation, le stockage et le transport;

Pression d'air extrêmement basse, ou pression d'air basse à haute altitude.

Remplacement de la batterie.

•Utilisez la batterie correctement. Mauvaise utilisation de la batterie comme celles mentionnées ici, peut entraîner des risques d'incendie, d'explosion ou de fuite liquide de gaz inflammables.

Remplacer la batterie par un type incorrect;

Disposer d'une batterie dans le feu ou un four chaud, écraser mécaniquement ou couper la batterie;

•Disposer la batterie utilisée conformément à vos règlements locaux ou aux instructions du fabricant de la batterie

•Avertissements de sécurité personnelle:

Risque de brûlure chimique. Ce produit contient une batterie de cellules. N'ingérer pas la batterie. Si la batterie de cellule est avalée, elle peut causer de graves brûlures internes en seulement 2 heures et peut entraîner la mort.

Gardez les batteries nouvelles ou utilisées à l'écart des enfants.

Si le compartiment de la batterie ne se ferme pas en toute sécurité,

cessez d'utiliser le produit et gardez-le à l'écart des enfants.

Si vous pensez que des piles ont pu être avalées ou placées à l'intérieur d'une partie du corps, consultez immédiatement un médecin.

Privacy Protection Reminder

Our company complies with appropriate privacy protection laws and is committed to protecting user privacy. You may want to read our full privacy policy at our website and get to know the ways we process your personal information. Please be aware, using the product described in this manual may involve the collection of personal information such as face, fingerprint, license plate number, email, phone number, GPS. Please abide by your local laws and regulations while using the product.

Regulatory Compliance

FCC Statements

This device complies with Part 15 of the FCC Rules. Operation is subject to the following two conditions: (1) this device may not cause harmful interference, and (2) this device must accept any interference received, including interference that may cause undesired operation. Visit <https://youkey.com/pages/product-installation-declaration> for SDoC.

Caution: The user is cautioned that changes or modifications not expressly approved by the party responsible for compliance could void the user's authority to operate the equipment.

NOTE: This equipment has been tested and found to comply with the limits for a Class B digital device, pursuant to part 15 of the FCC Rules. These limits are designed to provide reasonable protection against harmful interference in a residential installation. This equipment generates, uses and can radiate radio frequency energy and, if not installed and used in accordance with the instructions, may cause harmful interference to radio communications. However, there is no guarantee that interference will not occur in a particular installation. If this equipment does cause harmful interference to radio or television reception, which can be determined by turning the equipment off and on, the user is encouraged to try to correct the interference by one or more of the following measures:

- Reorient or relocate the receiving antenna.
- Increase the separation between the equipment and receiver.
- Connect the equipment into an outlet on a circuit different from that to which the receiver is connected.
- Consult the dealer or an experienced radio/TV technician for help.

RF Radiation Exposure Statement

This equipment complies with FCC radiation exposure limits set forth for an uncontrolled environment. This equipment should be installed and operated with a minimum distance of 20cm between the radiator and any part of your body.

European LV/EMC/RE/RoHS Directive



This product complies with Low Voltage Directive 2014/35/EU, EMC Directive 2014/30/EU, RE Directive 2014/53/EU and RoHS Directive 2011/65/EU and (EU) 2015/863.

WEEE Directive-2012/19/EU



The product this manual refers to is covered by the Waste Electrical & Electronic Equipment (WEEE) Directive and must be disposed of in a responsible manner.

Battery Regulation- (EU) 2023/1542



Battery in the product complies with the European Battery Regulation (EU) 2023/1542. For proper recycling, return the battery to your supplier or to a designated collection point.

Hereby, KeyLife International Technologies Co., Ltd. declares that this device (refer to the label) is in compliance with Directive 2014/53/EU. The EU declaration of conformity is available at the following internet address:

<https://youkey.com/pages/eu-declaration-of-conformity>

The frequency bands and the nominal limits of transmitted power of the device are available at the following internet address:

<https://youkey.com/pages/rf-frequency-and-power>

IC Statement

This device complies with Innovation, Science and Economic Development Canada licence-exempt RSS standard(s). Operation is subject to the following two conditions: (1) this device may not cause interference, and (2) this device must accept any interference, including interference that may cause undesired operation of the device.

Le présent appareil est conforme aux CNR d'Innovation, Sciences et Développement économique Canada applicables aux appareils radio exempts de licence. L'exploitation est autorisée aux deux conditions suivantes : (1) l'appareil ne doit pas produire de brouillage, et (2) l'utilisateur de l'appareil doit accepter tout brouillage radioélectrique subi, même si le brouillage est susceptible d'en compromettre le fonctionnement.

This equipment complies with IC RSS-102 radiation exposure limits set forth for an uncontrolled environment. This equipment should be installed and operated with minimum distance 20cm between the radiator & your body.

Cet équipement est conforme aux limites d'exposition aux rayonnements CNR-102 établies pour un environnement non contrôlé.

Cet équipement doit être installé et utilisé avec une distance minimale de 20 cm entre le radiateur et votre corps.

KeyLife International Technology Limited

Workshop 7, 6th Floor Core 45, No. 43 Tsun Yip Street, Kowloon, Hong Kong

<http://www.youkey.com>