

Specification

Product Name:	HESTIA A1
Dimensions	113mm X 93mm
Operation System	RTOS
IP Coefficient	IP67
Operation Temperature	-30°C (-22°F) to 75°C (167°F)
Voltage	DC 5V~24V
Weight	200g (TBD)
Satellite Module	Compal RMM-T1
Satellite Bands	B23, B24, B255, B256 L Band B24/B255 : UL 1626.5 - 1660.5MHz ; DL 1525 - 1559MHz S Band B23/B256 : UL 1980 - 2010 MHz ; DL 2170 - 2200 MHz GPS: L1
Certifications	Skylo Certification, FCC, NCC

Appearance description:

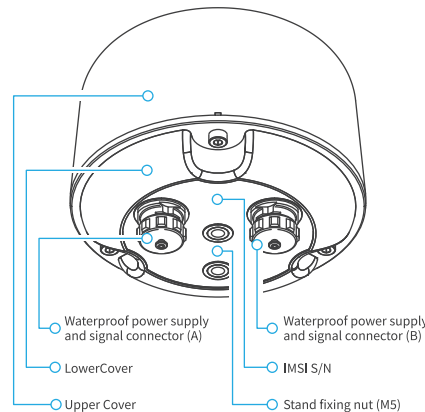

Bottom label description:

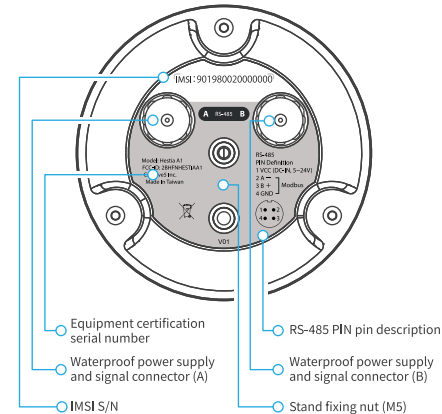

Installation file download instructions:



<https://www.apaltec.com/hestia/>

Dimensions:

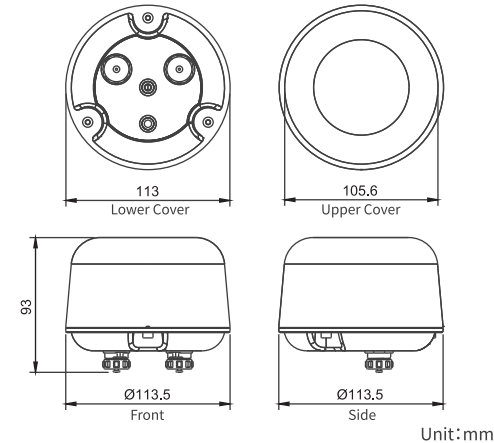

RS-485 Wiring instructions:

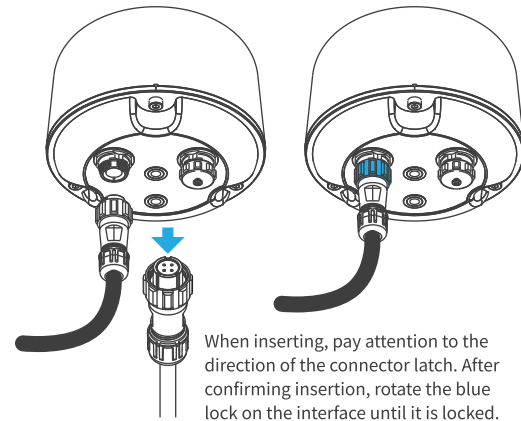

RS-485 Interface definition description:

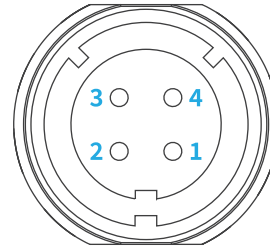

- | | |
|-------|---------------|
| 1 VCC | DC IN, 5V~24V |
| 2 A- | Modbus |
| 3 B+ | Modbus |
| 4 GND | Modbus |

Stand installation instructions:

The stand is an optional accessory. When installing, please place the bracket under the device and lock it with M5X8 stainless steel screws.

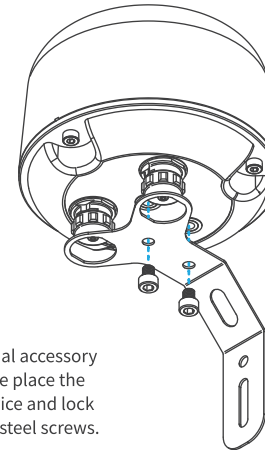

Warnings

This device complies with part 15 of the FCC Rules. Operation is subject to the following two conditions: (1) This device may not cause harmful interference, and (2) this device must accept any interference received, including interference that may cause undesired operation.

Changes or modifications not expressly approved by the party responsible for compliance could void the user's authority to operate the equipment.

This equipment has been tested and found to comply with the limits for a Class B digital device, pursuant to part 15 of the FCC Rules. These limits are designed to provide reasonable protection against harmful interference in a residential installation. This equipment generates, uses and can radiate radio frequency energy and, if not installed and used in accordance with the instructions, may cause harmful interference to radio communications. However, there is no guarantee that interference will not occur in a particular installation. If this equipment does cause harmful interference to radio or television reception, which can be determined by turning the equipment off and on, the user is encouraged to try to correct the interference by one or more of the following measures:

- Reorient or relocate the receiving antenna.
- Increase the separation between the equipment and receiver.
- Connect the equipment into an outlet on a circuit different from that to which the receiver is connected.
- Consult the dealer or an experienced radio/TV technician for help.

This device has been tested and meets applicable limits for Radio Frequency (RF) exposure. This equipment should be installed and operated with minimum distance 20 cm between the radiator & your body.