

LSC-V5 Robot Vacuum Cleaner

Operating Manual

Please read this user manual carefully. If you have any questions, please contact our customer service staff.

Terms of Use

- This product is for indoor use only. Do not place this product or the base station outdoors or in places where it is easily wetted by rain.
- This product involves some precision parts. Please do not let children use it as a toy. When the product is in operation, please keep it away from children as much as possible.
- For this product, please use the fragrance liquid that comes with the box. You can buy a new one in the mall after using it up. Please do not use corrosive liquids as a substitute. It is strictly forbidden to use liquids such as disinfectant.
- Please install this product according to the installation instructions. Do not place the host and base station upside down, and do not lift the laser sensor protection cover and the upper cover of the body by hand.

- Do not use this product to clean burning objects. Do not clean explosive, corrosive or toxic liquids.
- Do not use in an environment where the temperature is above 40°C or below 0°C or there is any liquid or sticky substance on the ground.
- Do not use this product in the room where infants or young children are sleeping.
- Do not put your hands into the gap of the base station or place other debris in front of the base station while the product is running.
- Do not use the main unit to absorb stones, waste paper and other items that may easily clog the air duct. If there is any blockage, please clean it up in time.
- Do not dismantle the body and base station components at will. If necessary, please contact dedicated personnel for repair guidance.
- Please use this product according to the instructions in the manual. Any losses and damages caused by improper use shall be borne by the user.

Battery and Charging

- Do not use any third-party batteries and base stations.
- Do not use any type of third-party power adapter to charge the console.
- Do not disassemble, repair or modify the battery and base station without permission.
- Do not wipe the charging dome with a damp cloth or wet hands.
- Please dispose the battery properly and have them recycled by professional organizations.
- If the battery or power supply is damaged in any way, stop using it immediately and contact after-sales personnel for processing.
- If you need to transport this product, please turn off the host and use the original packaging box for packaging.
- If you do not use this product for a long time, please turn off the host after fully charging it and place it in a cool and dry place. Fully charge it at least once every 3 months to avoid

battery damage.

Parts List

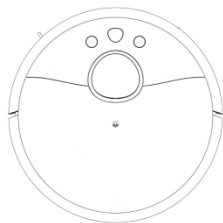

Robot Unit

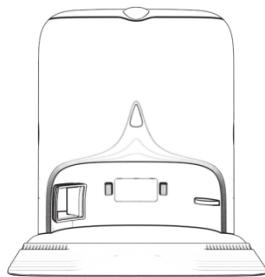

Auto Station



Mopping Pads

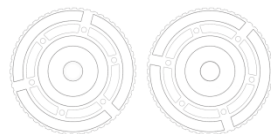

Mopping Pad



Cleaning Tool



Bottle



Filter

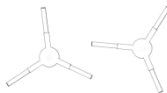

Side Brushes

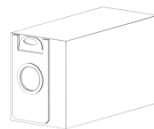

Dust Bag

Note: Figures and illustrations are for reference only and may differ from actual product appearance, Product design and specifications are subject to changes without notice.

Product Description

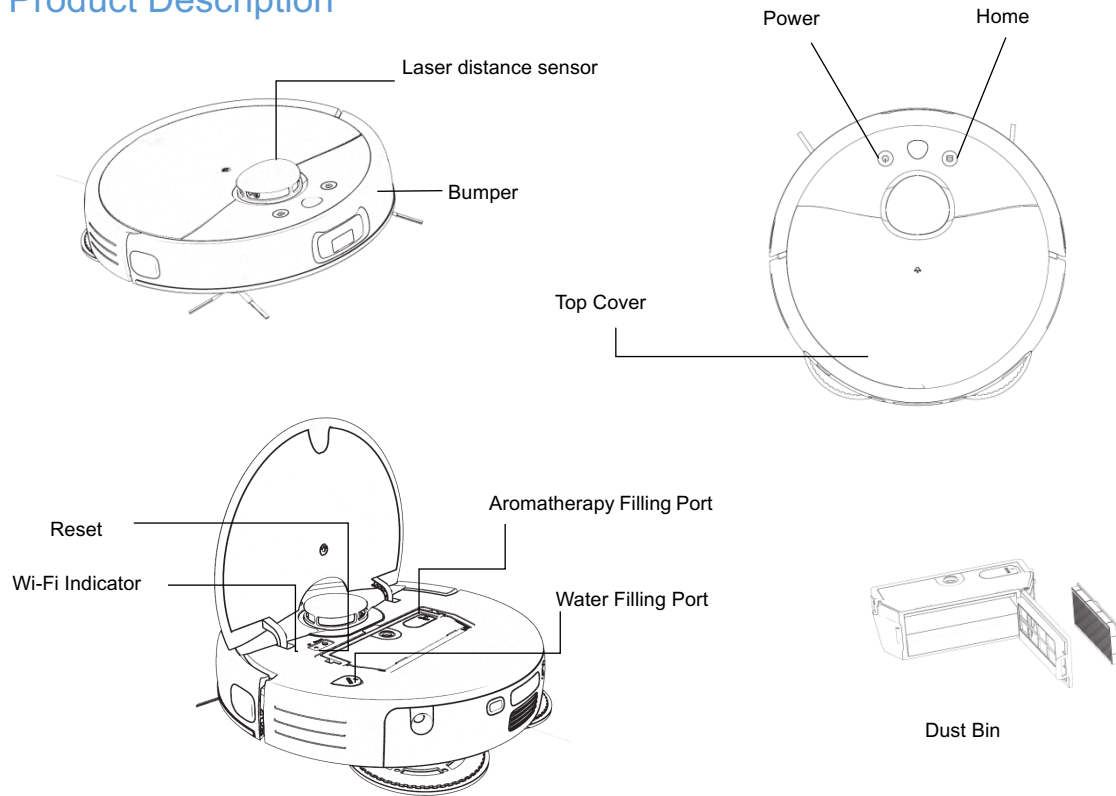

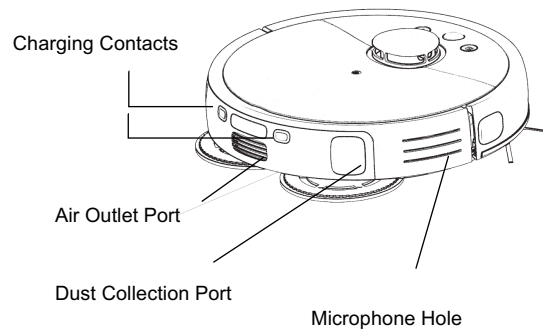
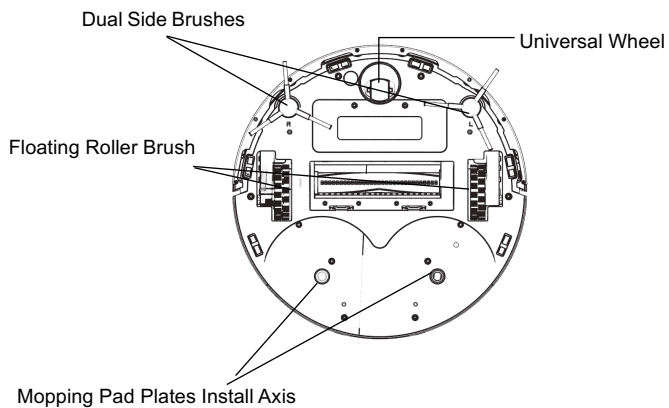

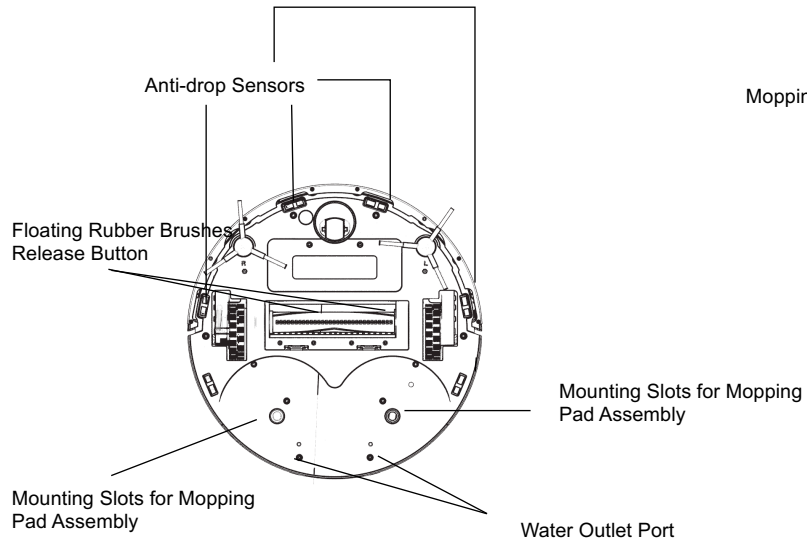

Mopping Pad Plates

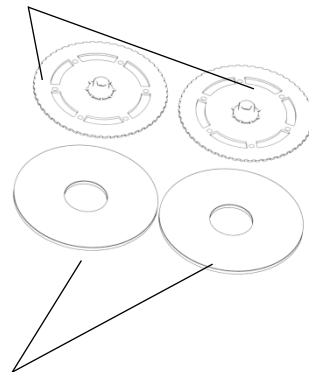

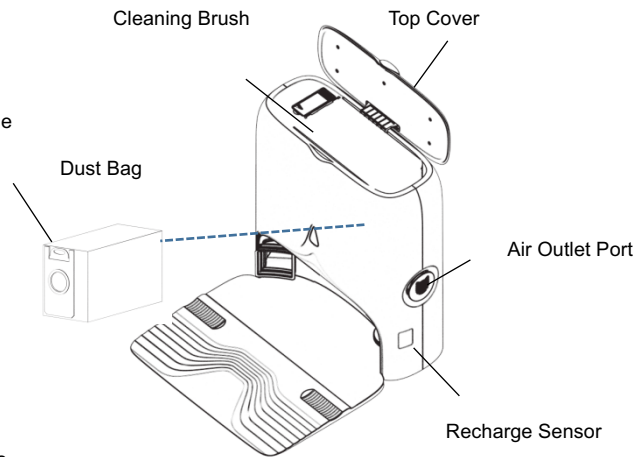
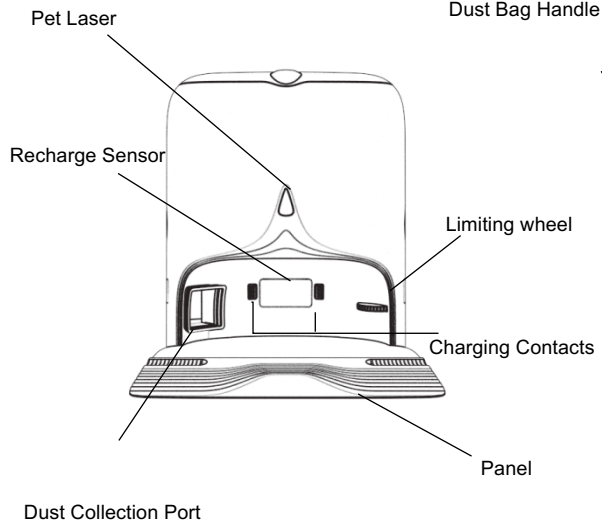

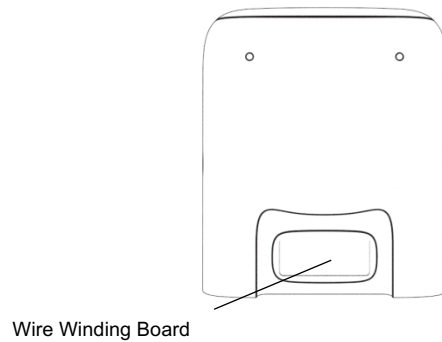
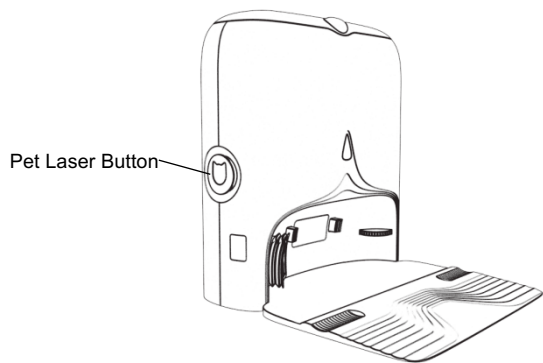

Preparation before use

Place the auto station against a wall and connect it to a power source.

Place the base station against a wall on a flat surface. Do not place objects within 0.5 cm to the left and right and 1.5 cm in front.

Install the side brush: Press the left and right side brushes into the side brush slots respectively. When you hear a "click", they are installed in place.

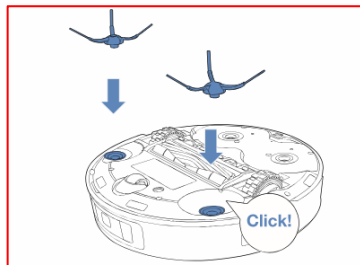

Install the mop: first soak the left and right mops completely, then stick them on the two mop plates, and then press them into the mop slots.

Note: If you use dry mopping, you do not need to soak the mop.

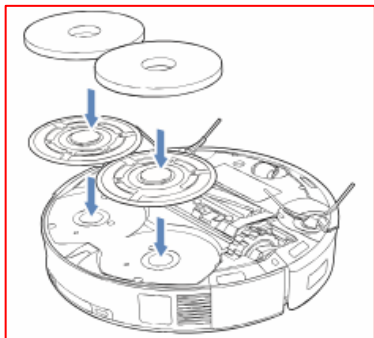

Add water: Fill the matching water bottle with water and pour it into the water tank from the water inlet.

Add aromatherapy liquid: inject the aromatherapy liquid into the aromatherapy box from the aromatherapy injection port .

Remove the anti-collision foam strip: Open the top cover of the main unit and take out the anti-collision foam strip.

Charge

Turn on the robot , with the front bumper facing outwards, align it with the charging spring and push it into the base station to start charging. In daily use, you can start charging by pressing the recharge button on the host or clicking the " recharge " button on the APP, or you can manually place the robot in the base station to charge.

Tips : For the first charge, it is recommended to fully charge before use to protect the battery performance. When the battery is low, it may not be able to start up. Please place the robot on the base station to charge.

Download the app

Search for "Extravis" in the App Store and follow the prompts to download and install the APP; or scan the QR code below to download and install the APP.

After the installation is complete, please follow the instructions on the APP page to complete the registration, login and network configuration.

Add a device

Open the top cover of the host, press and hold the recharge button for 5 seconds, and when you hear "Enter WiFi network configuration mode" , it means the host has entered network

configuration mode . Click Add Device on the APP homepage and complete the connection according to the APP prompts. If the network configuration problem occurs, you can restart the machine by pressing the "reset" button and configure the network again.

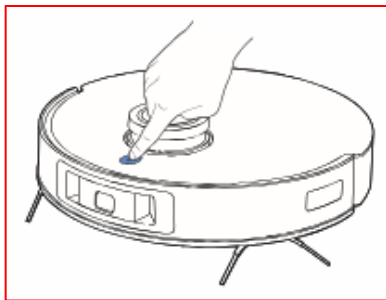

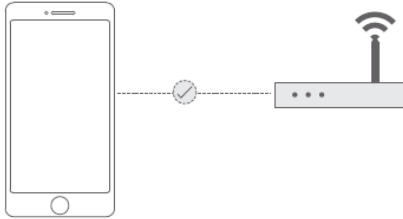

Network configuration reference steps:

- 1、 Enable Bluetooth and Wi-Fi permissions on your phone;

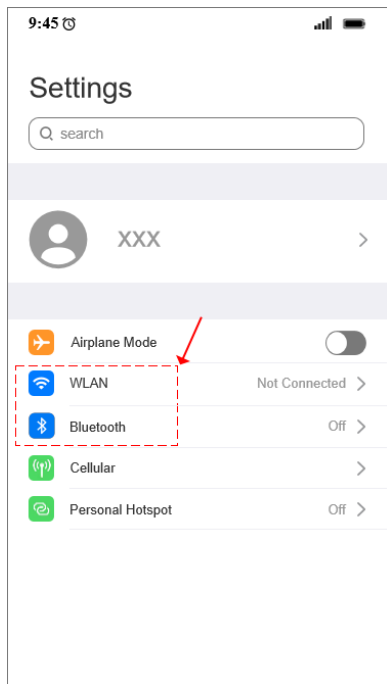

2、Press and hold the host “Home” button for 5 seconds, and hear "Enter WiFi network

configuration mode";

3、 Click "Add Device" in the middle of the homepage , or click "+" in the upper right corner;

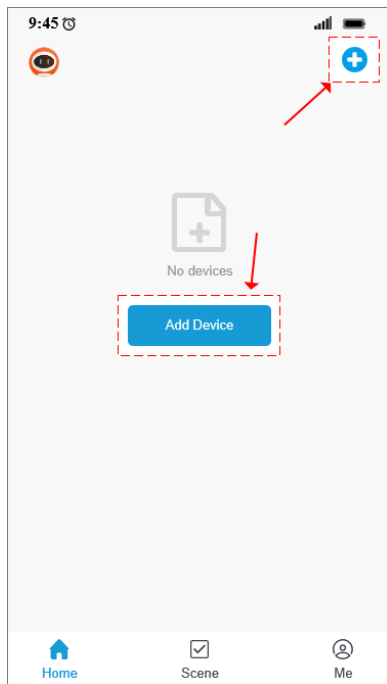

4、 Select "Small Appliances" - "Robot Vacuum Cleaner (Wi - Fi)";

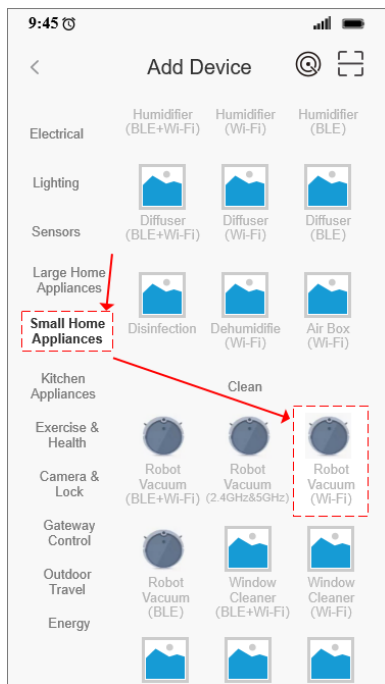

5、 Selecting the 2.4GHz Wi - Fi network and entering the password , click "Next" ;

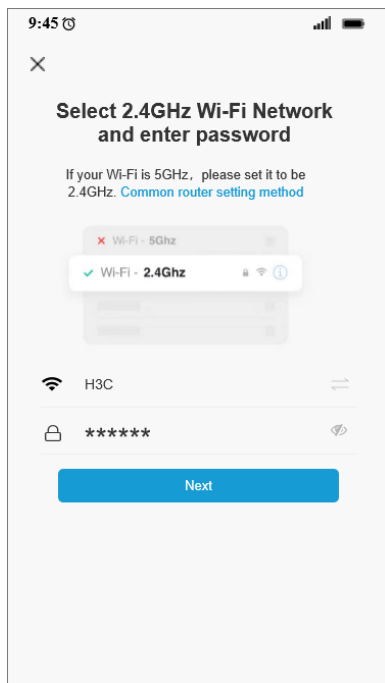

6、Select the "Wi - Fi Fast Connect" method, confirm that the host has reset the device, check

"Confirm indicator light flashes", and click "Next";

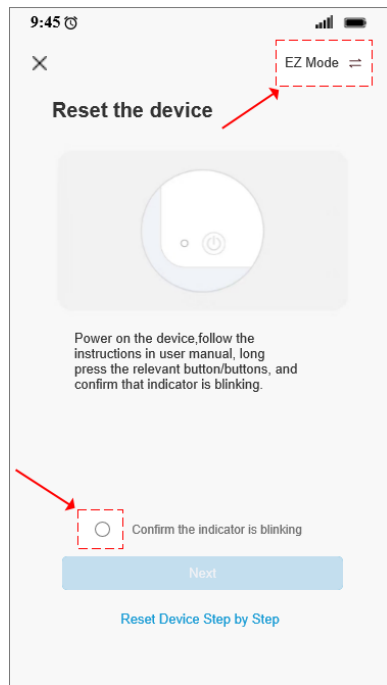

7. Wait for the device to connect until it is added successfully.

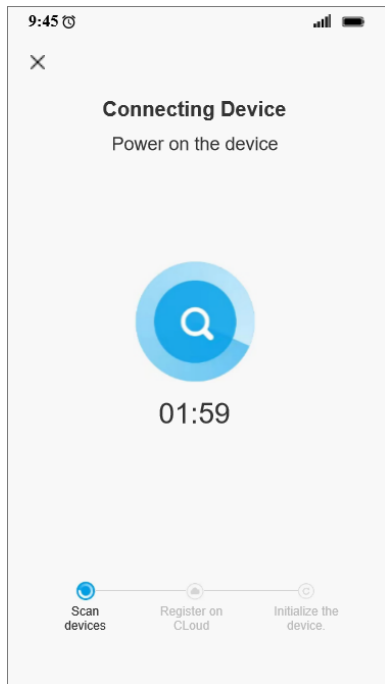

Instructions for use

Power On/Off

Press and hold the power button on robot main unit for 3 seconds to turn on the device. The power indicator light will stay on and the device will enter standby mode. If the device is not charging in the base station, press and hold the power button for 3 seconds to turn it off.

Mapping

When the machine is used for the first time or at a different location, the network configuration is complete and the map is quickly constructed according to the APP instructions. Before quickly constructing the map, the base station needs to be installed and the map is quickly constructed according to the APP operation instructions. During the construction of the map, only the map is constructed without sweeping. After the map is constructed, the machine returns to the base station and automatically saves the map, which can also be saved actively

on the APP.

Cleaning Range

Before performing a clean task, choose whether to clean the entire house, selected areas, or divided areas. During the task, the machine will choose to clean different areas based on different ranges.

Breakpoint Resume

When performing a cleaning task, if the machine's battery is too low to complete the task, the machine will autonomously return to the base station for charging; when the battery reaches a certain value, the machine will return to the breakpoint to continue the unfinished task.

Restricted Area

Use the APP to set restricted areas to prohibit the robot from entering areas that do not need to be cleaned.

Tips: Before using this function, you need to save the map in the APP and the base station screen. Moving the robot or significant changes in the home environment may cause the original map to become invalid, resulting in the loss of the restricted area.

Schedule a Cleaning Task

You can use the APP to set up a scheduled cleaning. The robot will automatically start cleaning at the specified time and automatically return to the base station after the cleaning.

Tip: If the “Do Not Disturb” mode is turned on, scheduled cleaning will not be performed during the Do Not Disturb time period.

Do Not Disturb Mode

Modify the Do Not Disturb time period through the APP to switch it on or off. During the Do Not Disturb time period, the robot will not automatically continue sweeping and will not actively broadcast voice; if the scheduled task is set during the Do Not Disturb mode time period, the machine will not perform the task.

Recharge

When the robot is powered on, press the lower left corner "Charging" icon in the APP. When the robot is outside the station, it will end the current task and return to the base station. When the robot is working outside the station and enters the Do Not Disturb mode, the robot will stop working and return to the station to charge. When the battery of the robot is too low during work, it will automatically recharge. When the battery is sufficient, it will automatically return to the interruption point to continue cleaning. When the robot completes the cleaning task, it automatically returns to the station.

Dust Collection

After the robot completes its cleaning task and returns to the station, the base station will automatically collect dust from the robot. Please note that dust collection can only be triggered if the robot is recharged after cleaning time of more than 2 minutes.

Restart

If the machine fails to respond or malfunctions, press and hold the power button on robot main unit for 10 seconds to turn it off, then press the power button again for 3 seconds to turn it on. If the power button fails to turn off the machine, press and hold the reset button to force restart the machine.

Fragrance Deodorant

Switch on the fragrance deodorization function through the app, and the robot vacuum cleaner

will spray fragrance mist through the mist outlet on the upper cover of the machine when it is working to achieve the deodorization effect. During the cleaning process, the spray is performed for 3 seconds every 5 seconds.

Interactive Pet Laser Toys

Press the switch button on the left side of the base station to turn on the interactive pet laser toy function, and turn the knob to adjust the height of the laser.

Interactive pet laser toy logic: After turning on, the laser will flash clockwise first, then counterclockwise after 30 seconds, and repeat this process. After 15 minutes, stop petting, and turn on the laser petting again after 2 hours, and repeat this process.

Negative ion wind

When the machine is performing a task, the negative ion wind function can be turned on or off through the APP configuration. The negative ion wind can eliminate static electricity.

Product Parameters

Host	Auto Station
Size: Diameter: 350mm Height: 97mm	Dimensions: Length 350mm, Width 145mm, Height 404mm
Weight: 3.9Kg	Weight: 4.2Kg
Battery: 5200mAh/6400mAh	Rated input: 100-240V
Rated voltage: 14.4V	Rated output: 19.4V 1.8A
Rated power: 81W (without mopping) 86.5W (with mopping function)	Rated frequency: 50/60Hz
	Rated power: 1000W

Maintenance and Replacement Parts

The maintenance cycle of the machine can be determined based on the consumables in the APP, or based on the actual sweeping effect of the machine. If the sweeping effect is not good, the machine parts need to be maintained. When maintaining or replacing the parts of the machine, please make sure that the machine is turned off and the charging pile is powered off, but do not change the position of the charging pile; after the maintenance is completed, power on the base station, put the machine into the base station, and restart the machine to continue normal use. The maintenance frequency and replacement cycle are for reference only. If the cleaning effect is not good during specific use, the parts should be maintained immediately.

Parts	Maintenance Cycle	Replace Cycle
Side Brush	It is recommended to clean once every 2 weeks	3--6 months
Dust Box		
Dust Box Filter		

Tangle Cutter Brush		6 –12 months
Drive Wheel	It is recommended to clean once a month	\
Universal Wheel		
Sensor		
Auto Station dust bag		6-8 weeks

Maintenance Method

Clean the side brush

- Remove the side brush and clean the hair off it.
- Rinse other stains on the side brush with water, rinse and dry it, and reinstall the side brush.

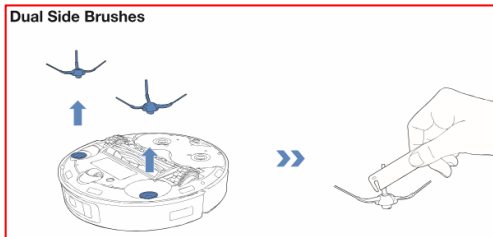

Cleaning the main brush

- Press the rolling brush cover opening button, take out the main brush cover, and then hold the roller brush with your hands and lift it up.
- After cleaning the hair on the roller brush, wipe the roller brush with a paper towel. After cleaning, reinstall the roller brush according to the original steps.

Floating Rubber Brush

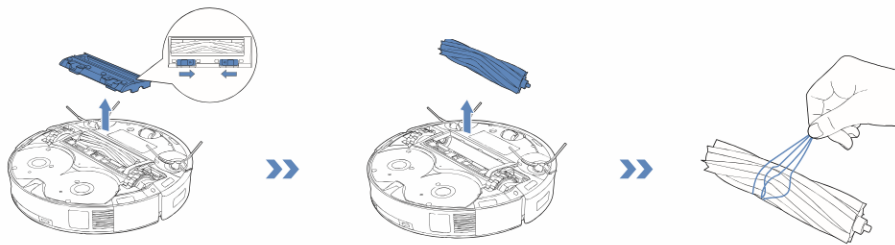

Clean the drive wheel

- Use a dry cloth to clean the hair on the drive wheel and the dirt stuck in the gap between the drive wheels.

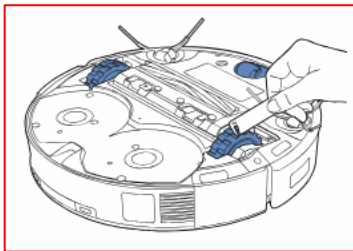

Cleaning the universal wheel

- Take out the universal wheel and clean the hair on it.
- Wipe the stains on the universal wheel with a dry cloth and reinstall the universal wheel according to the original steps.

Clean the sensor

- Use a dry cloth to wipe the radar laser on the machine body, the line laser in front of the machine, the laser sensor on the right side, the drop sensor at the bottom of the machine, and the ultrasonic carpet sensor.

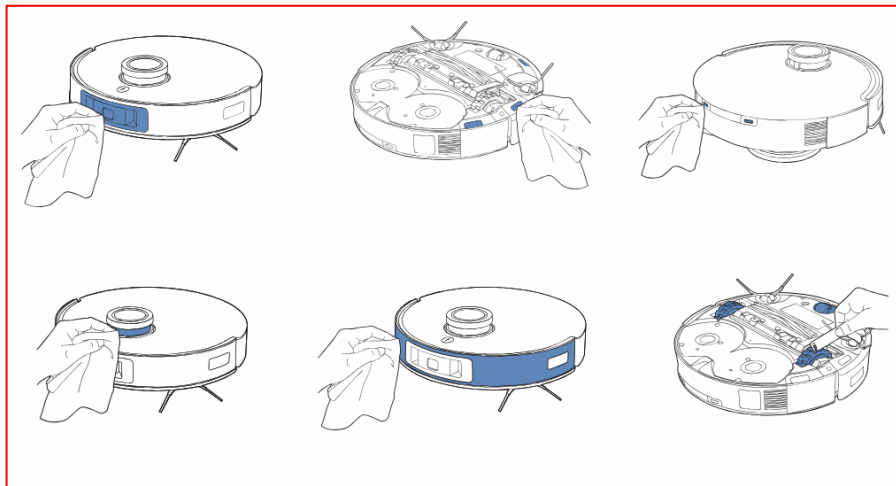

Clean the dust box filter

- Open the top cover of the machine, take out the dust box, pinch the filter handle and take out the filter.
- Use a brush to clean the dust or tap the filter gently, then rinse the filter with clean water, dry it and reinstall it according to the original steps.

Cleaning the base station

- Open the top cover of the base station, lift the dust bag handle by hand, and take out the

dust bag.

- After disposing of the old dust bag, replace it with a new one.
- After taking out the dust bag, wipe the base station cabin clean with a dry cloth.

Cleaning Mop

- Tear off the mop, clean it or replace it with a new one.
- Make sure the mop fits snugly around the edge of the tray.
- Press the mop tightly and reinstall it to the bottom of the machine.

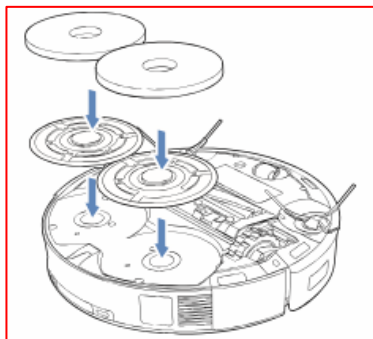

FAQ

The following are some possible problems and solutions for the machine. If you still cannot solve the problem after following these steps during use, you can contact after-sales customer service or the dealer where you purchased the machine.

Problems	Solution
----------	----------

Robot can not start	<p>If the battery is low, please place the machine on the base station to charge;</p> <p>Please use it within the ambient temperature range of 0°C-40°C.</p>
Failed to charge	<p>The machine has not been used for a long time and the battery is over-discharged; please stop operating and contact after-sales customer service;</p> <p>If you do not use the machine for a long time, please turn off the machine and disconnect the base station power supply after fully charging; and make sure to charge the machine every 3 months to avoid over-discharge of the battery.</p>
Robot cannot	<p>The WiFi password is incorrect, enter the correct WiFi password;</p> <p>The machine does not support 5GHz network and router, please switch to 2.4GHz network;</p>

configure the network	<p>The network signal is poor or unstable at the location where the machine is located;</p> <p>Make sure the device is in the configuration waiting state, press and hold the recharge button, and release it after hearing the prompt tone.</p>
Unable to return to the base station to charge autonomously	<p>Make sure the base station power cable is connected;</p> <p>Make sure there is enough space around the base station (1m in front, 5-10cm on the left and right) and no obstacles.</p> <p>Wipe the base station signal area regularly to prevent dust and other obstacles from blocking the charging process;</p> <p>If your base station moves after mapping, you need to fix the base station position, put the machine into the base station to charge and re-map.</p>
There is abnormal	Check whether there are any foreign objects entangled in the main

<p>sound or excessive noise during the cleaning task</p>	<p>brush and side brush;</p> <p>Check whether the dust box has sucked in hard objects;</p> <p>The suction power of the host can be adjusted in the APP. If the cleaning noise of the machine is too loud, the suction power can be lowered appropriately.</p>
<p>Robot cleaning path is messy</p>	<p>Items such as wires and slippers placed on the ground cause the robot to constantly perform obstacle avoidance actions and cannot work normally. Please put away wires, slippers and other debris before cleaning; there are stains on the surface of the laser sensor. Use a dry soft cloth to carefully wipe the surface of the sensor to ensure it is clean and tidy.</p>
<p>The robot often gets stuck and is unable to perform tasks or</p>	<p>When the cleaning environment is complex or there are many obstacles, it is recommended to set up restricted areas or add virtual</p>

return to the base station	walls in areas where the robot often gets stuck or trapped.
The robot cannot clean other rooms	Before the machine performs a task, please open the door of the room to be cleaned, otherwise the machine cannot enter the room to perform the cleaning task.
Robot with poor cleaning performance	Please maintain the machine regularly and clean the side brush, main brush and dust box.
Robot cannot mop the floor	Make sure there is enough water in the water tank. If there is insufficient water, you need to add water manually.

Indicator status

Indicator status	Status Description
------------------	--------------------

Blue light is always on	Power on; Network configuration successful; Cleaning (start/continue/continue cleaning at a breakpoint/schedule cleaning); Firmware upgrade; Start remote control; Recharge
OFF	Shutdown; Standby; Hibernation
Blue light flashing	Reset to factory settings; Pause cleaning; Firmware upgrade completed; Exit remote control; Pause recharging
Blue light flashes + WiFi light is always on	Reset WiFi
Blue light breathing	Charge
Flashing red light	Abnormal reminder (dust box is taken out during cleaning, dust box is full, machine is stuck, main wheel is stuck, main brush is stuck, sensor is abnormal, positioning fails, firmware upgrade fails, network configuration fails, etc.)

After-sales service policy

If your product has any problems during the warranty period, you will receive free warranty service after confirmation by our maintenance team. After the maintenance service is completed, the ownership of the replaced parts or accessories belongs to our company; if our after-sales service center confirms that the product does not meet the warranty scope, our company reserves the right to charge for maintenance fees and accessories.

Warranty Content

Parts	Warranty Content	Warranty time
Host	1. Host (excluding batteries, accessories, and consumables) 2. Base station (excluding dust bag)	2 years
Battery	Lithium battery in the host	6 months
Accessories	Auto Station (excluding dust bag)	1 year
	Mopping module (without mop)	1 year
	Main brush, main brush cover	6 months
Consumables	Mop, side brush, dust box filter, dust bag, deodorant	/

Warranty Card

Username	
Mailing Address	
Contact Number	
Product Name and Model	
Product Serial Number	
Product Purchase Date	

Maintenance Records

No	Fault description and replacement parts	Maintenance Date	Repair Center	Maintenance Engineer
1				
2				
3				

Manufacturer: UNION OPTECH CO., LTD

Official Website: <http://www.union-optech.com/>

Service Email: info@union-optech.com

FCC Warning

This device complies with part 15 of the FCC rules. Operation is subject to the following two conditions: (1) this device may not cause harmful interference, and (2) this device must accept any interference received, including interference that may cause undesired operation.

Changes or modifications not expressly approved by the party responsible for compliance could void the user's authority to operate the equipment.

NOTE: This equipment has been tested and found to comply with the limits for a Class B digital device, pursuant to part 15 of the FCC Rules. These limits are designed to provide reasonable protection against harmful interference in a residential installation. This equipment generates uses and can radiate radio frequency energy and, if not installed and used in accordance with the instructions, may cause harmful interference to radio communications. However, there is no guarantee that interference will not occur in a particular installation. If this equipment does cause harmful interference to radio or television reception, which can be determined by turning the equipment off and on, the user is encouraged to try to correct the interference by one or more of the following measures:

- Reorient or relocate the receiving antenna.
- Increase the separation between the equipment and receiver.
- Connect the equipment into an outlet on a circuit different from that to which the receiver is connected.
- Consult the dealer or an experienced radio/TV technician for help.

Radiation Exposure Statement

This equipment complies with FCC radiation exposure limits set forth for an uncontrolled environment. This equipment should be installed and operated with minimum distance 20cm between the radiator and your body.