

A T E L

Passion for Wireless World

MUGIC 2.0 User Manual

Index

1.	About this Manual.....	3
2.	Product Overview.....	Error! Bookmark not defined.
3.	Buttons Definition	3
4.	LED Definition.....	4
5.	Quick start guide.....	4
	network name and password.....	4
	WIFI mode and USB mode	5
	Basic MUGIC 2.0 Usage	5
	BLE 5.0	5
6.	Revision History.....	6

1. About this Manual

The content of this User Manual has been made as accurate as possible. However, due to continual product improvements, specifications and other information are subject to change without notice.

2. Buttons Definition

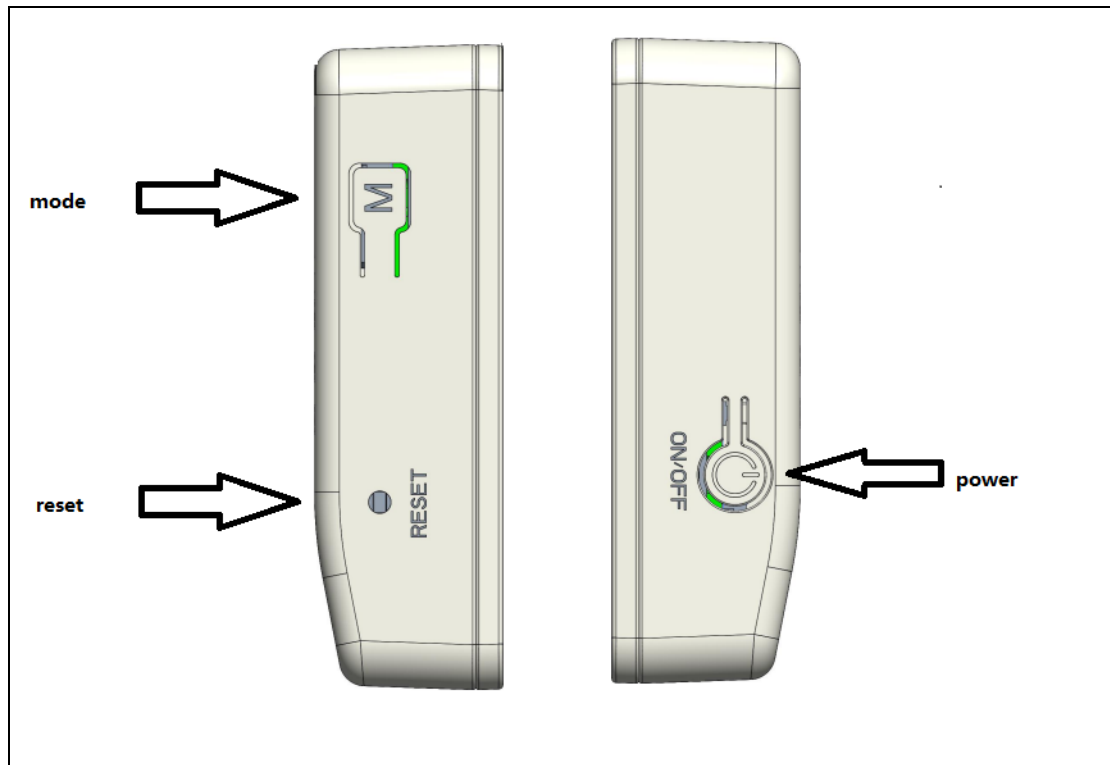

Picture 2 Buttons Definition

Buttons Definition		
Button	Operation	Function
power	Long Press (5S)	Power On/Off
reset	Long Press (5S)	Restore factory default setting
mode	Long Press (5S)	switch between WIFI mode (default) and USB mode

Table 2 Buttons Definition

3. LED Definition



Table 3 LED Definition

Charge: Red light indicates that the device is charging when connected to USB.

Battery: Green/Orange/Red indicates the status of the battery (Green:80+% power remaining, Orange: more than 40%, and Red: less than 40%) (Blinking red: less than 10% power remaining)

Wi-Fi: Blue light blinking every 1 second means MUGIC™ is transmitting data over WIFI. While establishing the WIFI network, the blue light will blink as twice as fast.

4. Quick start guide

network name and password

Every MU218 2.0 comes with its own unique 6-digits numbers. Turn the power on; MU218 2.0 will automatically start in WIFI mode. The blue light will

blink fast, then slows down to blinking every 1 second, which means MU218 2.0 successfully created a WIFI network. Find:

- Network Name: The default network name is “MugicConnectXXXXXX” (‘XXXXXX’ means 6 digits. For example, it will look like “MugicConnect123876”). Join the network.

- Password: Enter the default password “mugicXXXXXX” (case sensitive, followed by the 6 digits in the network name. Using the above example, the password would be mugic123876.)

WIFI mode and USB mode

MU218 2.0 also works in USB mode, connecting to the computer via a USB cable. In case you need to connect to the internet via WIFI, MU218 2.0 can also keep working via USB mode

- WIFI mode: MU218 2.0 is set to WIFI mode as default. You can also charge MUGIC™ connected to an electric outlet via USB cable, so you won’t run out of power while in WIFI mode.
- USB mode: MU218 2.0 also works in USB mode, connecting to the computer via a USB cable. In case you need to connect to the internet via WIFI, MUGIC™ can also keep working via USB mode

Basic MUGIC 2.0 Usage

Troubleshooting:

If you joined the MugicConnectXXXXXX network, but are not receiving any data: Check your local IP (in your computer’s settings or system preferences, network configuration). It should be 192.168.4.2 (the device should have the IP address 192.168.4.1). If this is not the case, you may not be the only computer or device to join the access point.

Over USB

You will need a program such as Minicom, Putty, or the Arduino IDE, to access the port. In that terminal, you can see the configuration state.

Available commands and their arguments include

- “print” to see the state of your device (it is recommended to turn “usb:0” to avoid the print statements to be drowned in MUGIC™Data messages)
- “ap_ssid:NAME OF YOUR NETWORK”
- “ap_pwd:PASSWORD”
- “wifi_ssid:NAME OF YOUR WIFI CLIENT NETWORK”

- “wifi_pwd:WIFI NETWORK PASSWORD”
- “wifi_ip:IP.ADD.RE.SS” (default is 192.168.4.1, but if joining in client mode, you will need to configure to your computer’s IP address on the common network)

BLE function 5.0

This product supports BLE 5.0.

5. Revision History

Author	Revision	Changes	Date
Zhfei	V1.0	Initial Draft	2024-06-27

This device complies with part 15 of the FCC Rules. Operation is subject to the following two conditions: (1) This device may not cause harmful interference, and (2) this device must accept any interference received, including interference that may cause undesired operation.

Changes or modifications not expressly approved by the party responsible for compliance could void the user's authority to operate the equipment.

NOTE: This equipment has been tested and found to comply with the limits for a Class B digital device, pursuant to Part 15 of the FCC Rules. These limits are designed to provide reasonable protection against harmful interference in a residential installation. This equipment generates, uses and can radiate radio frequency energy and, if not installed and used in accordance with the instructions, may cause harmful interference to radio communications. However, there is no guarantee that interference will not occur in a particular installation. If this equipment does cause harmful interference to radio or television reception, which can be determined by turning the equipment off and on, the user is encouraged to try to correct the interference by one or more of the following measures:

- Reorient or relocate the receiving antenna.
- Increase the separation between the equipment and receiver.
- Connect the equipment into an outlet on a circuit different from that to which the receiver is connected.
- Consult the dealer or an experienced radio/TV technician for help.

The MUGIC 2.0 has been tested for body-worn Specific Absorption Rate (SAR) compliance and comply with FCC rules requirement, . The highest reported SAR level for usage near the body (0mm) is 1.35 W/kg.