

How the Lid works

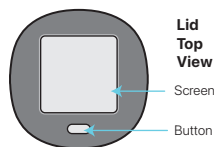

Turning On

Press the lid button **once** to power on.

Frequency Type Selection

1 - Energy

2 - Recovery

3 - LumiVitae

Press **once** to cycle through the frequency options.

Press the button **twice** to activate the selection.

An animation will start when activated.



When an option is chosen, an animation will appear on the screen and will remain throughout the entire process.

The Energy and Recovery cycles last approximately 1 minute each.

The LumiVitae cycle lasts approximately 3 minutes. Only during the LumiVitae cycle does the lid emit a purple light at the bottom.

Shutting Down

When the frequency cycle completes, the lid turns off automatically.

How the Base works

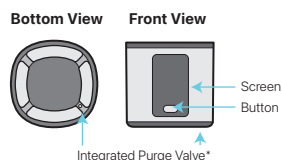

*Please refer to the online manual for further information.

Turning On

Press the base button **once** to power on.

Cycles Selection

The 3-minute cycle starts **automatically**.

To choose a different cycle duration (6-minute or 9-minute), press the button **once**. Note that the 9-minute cycle **should not be used with the original container**.

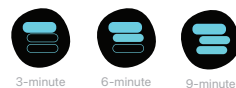

Chromotherapy

Press the button **twice** to access the color menu.

Press **once** to cycle through the color options.



Mute/Unmute



Press the button **three** times to access the sound menu.

Press **once** to turn the sound on or off.

Shutting Down

When the hydrogen cycle completes, the base turns off automatically.

If you wish to interrupt the process and turn off the lid or the base, long-press the respective button when you are on the main menu screen.

Best Charging Practices

- Always use a certified charger with safety standards and an output of 5V 2A.
- Avoid letting the batteries discharge completely by checking the battery level through the icon displayed on the screen.

- The light on the base may flash during the cycle if charging is needed.
- During the charging process, avoid interrupting until the process is complete.
- Ensure that the USB-C ports are dry when connecting the cable.

Activation

Before you start using your bottle, perform an activation cycle.

Bring distilled water to a boil, pour the hot water into the bottle and run the 9-minute cycle without placing the lid on the bottle.

Discard the produced water and rinse with clean water.

Maintenance

Once or twice a week, perform a maintenance cycle.

Bring distilled water to a boil, pour the hot water into the bottle, dissolve 1 tablespoon of food-grade citric acid powder.

Run the 9-minute cycle without placing the lid on the bottle.

Discard the produced water and rinse with clean water. The higher the TDS (total dissolved solids) value of the water you use, the more frequent you should perform the maintenance cycle to ensure optimal performance.

To prevent the membrane from drying out, always leave some water covering the membrane. If you are not going to use the bottle for more than 2 days, add some distilled water to moisten the membrane and close it with the protective cap.

How to Use

Fill the CellPower Bottle with filtered or bottled drinking water up to the lower edge of the aluminum rim. Select the desired programs on both the base and the lid, wait for them to complete, then open the lid and enjoy your water. We recommend **drinking directly from the bottle within 30 minutes**.

What water to choose?

Best: Filtered or bottled drinking water with pH <7 and TDS (total dissolved solids) <100 mg/L.
Ok: Filtered or bottled drinking water outside the parameters mentioned above.
Not allowed: Unfiltered tap water.

CELLPOWER

USER MANUAL

HYDROGEN WATER BOTTLE

Scan the QR code for quick access to the online manual or visit lumivitae.com/getmanual

Do not use the CellPower Bottle without first reading the online manual.



Important Information

This is a sensitive product. It can become irreversibly damaged when subjected to a fall or impact.

Do not put anything in the CellPower Bottle except filtered or bottled drinking water. Do not use tap water. Using anything else but water will harm the bottle.

Strictly follow the maintenance and cleaning processes described in our manual.

Do not drink from the CellPower Bottle while it's charging.

Never place the bottle in environments with extreme temperatures (e.g., **sauna, refrigerator, freezer**, etc.) and **never submerge it in liquid or any other solution** (remember, it's water-resistant but not waterproof).

There are three hydrogen production cycles: When using the original container, **ONLY use the 3 or 6-minute** cycle without repeating. The 9-minute cycle should only be used with a larger capacity plastic bottle (500 mL, 1 L or 1.5 L).

Box Contents

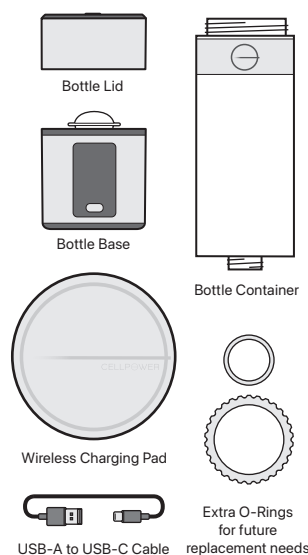

Assembly Instructions

- Remove the protective cap from the top of the base.**

You will notice the presence of distilled water, which is intentionally added to maintain membrane hydration.

- Assemble the cup.**

Position the logo to the back and rotate the cup on the base by 180 degrees so that it faces the front, aligning with the screen on the base.

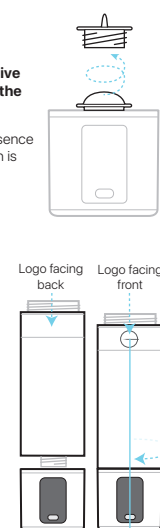

- Attach the lid to the container.**

Securely attach the lid to the container, ensuring it is aligned properly and tighten it firmly.

- Charge your bottle.**

The base can be charged either using the Wireless Charging Pad or by connecting the USB-A to USB-C cable to the port at the back. In both cases, a power source is required.

On the other hand, the **lid can only be charged** using the USB-A to USB-C cable.

Charging points placement

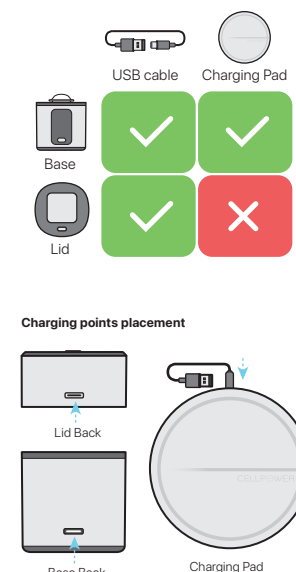

FCC Warning

This device complies with Part 15 of the FCC Rules. Operation is subject to the following two conditions:

(1) This device may not cause harmful interference, and (2) this device must accept any interference received, including interference that may cause undesired operation.

NOTE 1: This equipment has been tested and found to comply with the limits for a Class B digital device, pursuant to part 15 of the FCC Rules. These limits are designed to provide reasonable protection against harmful interference in a residential installation. This equipment generates, uses and can radiate radio frequency energy and, if not installed and used in accordance with the instructions, may cause harmful interference to radio communications. However, there is no guarantee that interference will not occur in a particular installation. If this equipment does cause harmful interference to radio or television reception, which can be determined by turning the equipment off and on, the user is encouraged to try to correct the interference by one or more of the following measures:

- Reorient or relocate the receiving antenna.
- Increase the separation between the equipment and receiver.
- Connect the equipment into an outlet on a circuit different from that to which the receiver is connected.
- Consult the dealer or an experienced radio/TV technician for help.

NOTE 2: Any changes or modifications to this unit not expressly approved by the party responsible for compliance could void the user's authority to operate the equipment.

RF Exposure Statement

To maintain compliance with FCC'S RF Exposure guidelines, This equipment should be installed and operated with minimum 20cm between the radiator and your body. This device and its antenna(s) must not be co-located or operation in conjunction with any other antenna or transmitter.