

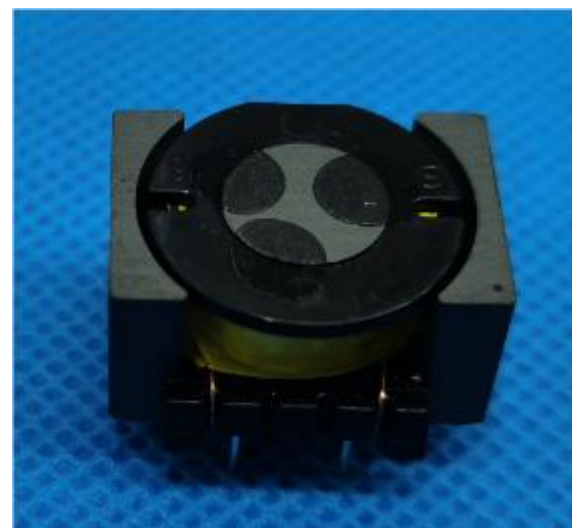
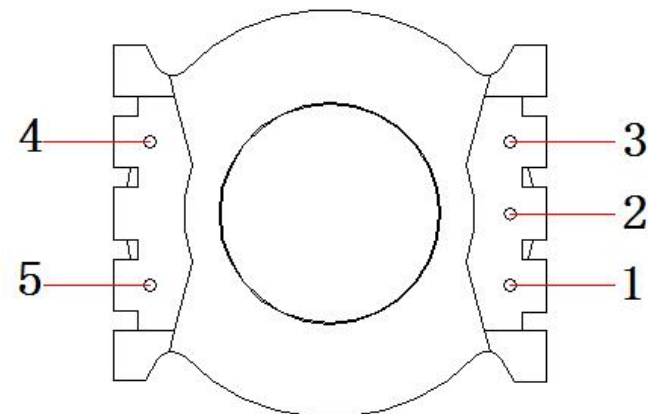

1. The dimensions are as shown in the figure, unmarked tolerance for dimensions: $\pm 0.1\text{mm}$
2. technical requirements:

Winding	Diameter	Start	End	Winding Numbers	Strands Number	Inductance Value
N1	$\Phi 0.31$	1	2	11	one wire close winding	22-32uH
N2	$\Phi 0.31$	2	3	11	one wire close winding	
tape				1		/
N3	$\Phi 0.31$	5	4	4	one wire close winding	/
tape				3		/
Remark: 1.use SG-418 frame 2.The frame is equipped with PQ20/20 manganese zinc magnetic rod and fixed with transformer oil						

3.Inspection requirements:

- 3.1 Puncture Test: At normal temperature, pin 1 and pin 5 are tested with 0.5KV high voltage, no ignition phenomenon
- 3.2 Inductance: refer to the form (1KHZ, serial mode, 1V)



File Name	SG-418 transformer	File No	2. 01. 63. 016	Page	1/2		NINGBO SEAGO ELECTRIC CO., LTD.		
Edition	A/0	Compiled by	Zhuting Dong	Verified by		Reviewed by		Authorized by	
		Date	20240701	Date		Date		Date	

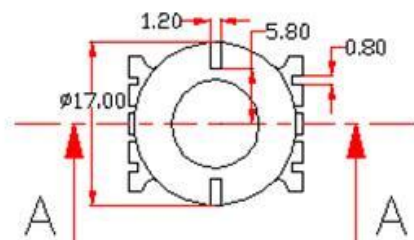
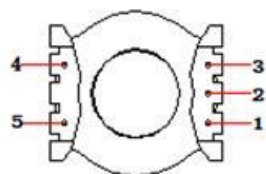
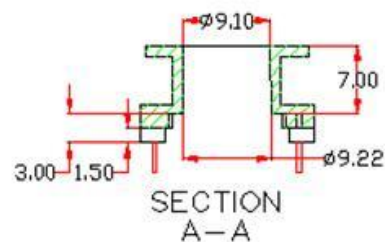
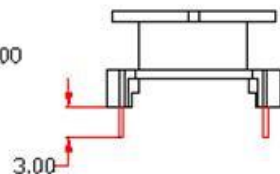
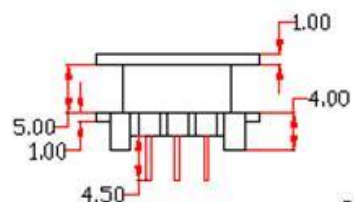
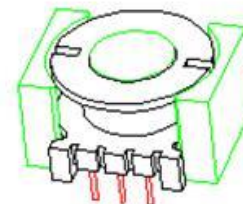
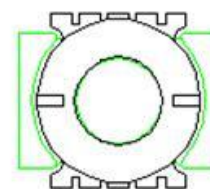
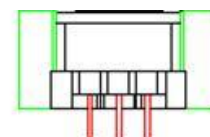
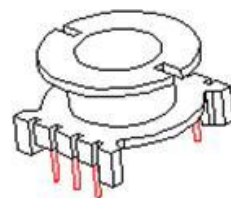
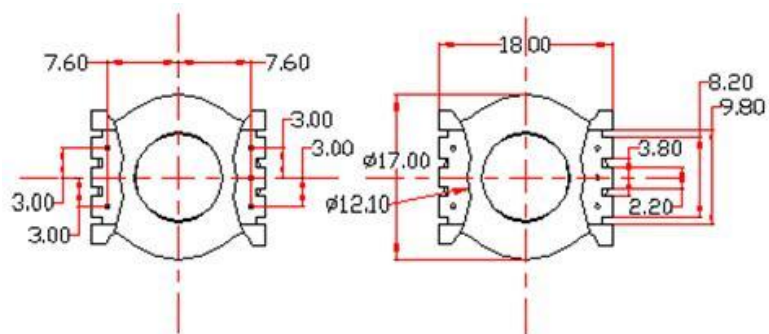

All measurements were performed radiated and therefore additional antenna gain documentation is not required.

File Name	SG-418 transformer	File No	2. 01. 63. 016	Page	2/2	SEAGO	NINGBO SEAGO ELECTRIC CO., LTD.		
Edition	A/0	Made by	Zhuting Dong	Verified by		Reviewed by		Authorized by	
		Date	20240701	Date		Date		Date	