

LED FLOOD LIGHT

Product Manual

MODEL: □ LAB20Z □ LAB50G □ LAB100G

COMPONENTS AND STRUCTURE

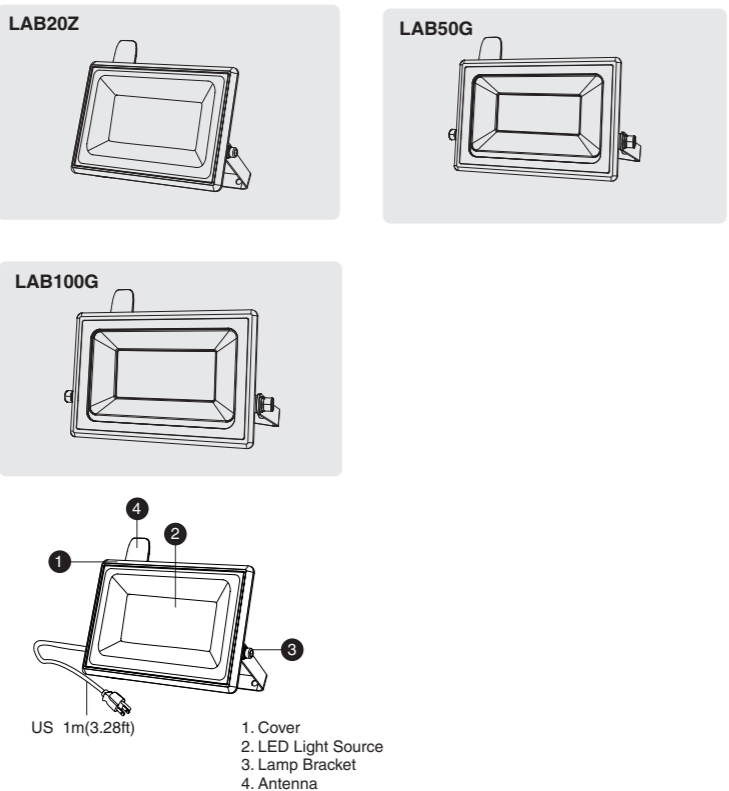

SPECIFICATIONS

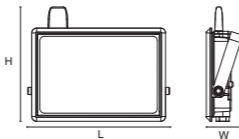
LED FLOOD LIGHT			
Model	LAB20Z	LAB50G	LAB100G
Input Voltage	100-120V ~ 60Hz		
Input Current	0.25A	0.68A	1.17A
Rated Power	30W	50W	100W
Luminous Flux	2400lm	4000lm	8000lm
CCT	2700K		
CRI	≥80		
Color	RGB		
Power Factor	≥0.5		
Beam Angle	120°		
t _a	-20-40°C/-4°F-104°F		
Luminaire Location	SUITABLE FOR WET LOCATIONS		
DIMENSIONS			
Model	LAB20Z	LAB50G	LAB100G
Dimensions (LxWxH)	175x45x140 mm / 6.89x1.77x5.51 in	210x37x157 mm/ 8.26x1.57x6.18 in	250x47x183 mm/ 9.84x1.85x7.2 in
Weight	0.48 kg / 1.06 lb	0.61kg / 1.34 lb	0.94kg / 2.07 lb
			

3



PAIRING LED LIGHT WITH "Smart Life" APP

Step 1: "Smart Life" App Download. There are 2 options for obtaining and downloading the "Smart Life" App on your smart device.

1. Scan the QR code on the right.
2. Search for "Smart Life" in the App Store or Google Play.

Step 2: Enter the "Smart Life" App. Register an account and log in. If you already have an account for Smart Life App, Please select "Log in with existing account".

Note: You will need your "Smart Life" App username and password to pair with Amazon Alexa and/or Google Assistant.

Step 3: Please turn on the Wi-Fi and Bluetooth before connecting LED lights to the "Smart Life" App.

Step 4: How to pair the LED Light

Note: Please understand our access request, our application needs to access your relevant information, and the purpose is only to complete the pairing with the luminaire.

Set the light to the pending pairing state.

1. Power on the LED Light.

2. Turn the light on and off three times, on-off (wait for 2s); on-off (wait for 2s); on-off (wait for 2s); on. The warm white light of the light will flash slowly, indicating that the light is waiting for pairing and the pairing operation can be performed.

Method 1

1. Tap "+" button on top right corner and tap "Add Device" to add device.
2. The app will automatically search for the device. After discovering the device, tap "Add".
3. Wait for the device to register (about 5-10s).
4. The figure shows "o", indicating completion of the connection.
5. You can tap "o" to change the device name. Then tap "Done" to enter the control panel.

Method 2

1. Tap "+" button on top right corner and tap "Add Device" to add device.
2. Tap "Lighting" and then "Light Source(BLE)" to enter next page.
3. Tap the "Next" button to pair the LED Light.
4. Wait for the device to register (about 5-10s).
5. The figure shows "o", indicating completion of the connection.
6. You can tap "o" to change the device name. Then tap "Done" to enter the control panel.

4



Step 4: How to pair the LED Light

Method 2

1. Tap "+" button on top right corner and tap "Add Device" to add device.
2. Tap "Lighting" and then "Light Source(BLE)" to enter next page.
3. Tap the "Next" button to pair the LED Light.
4. Wait for the device to register (about 5-10s).
5. The figure shows "o", indicating completion of the connection.
6. You can tap "o" to change the device name. Then tap "Done" to enter the control panel.



Step 4: How to pair the LED Light

Method 2

1. Tap "+" button on top right corner and tap "Add Device" to add device.
2. Tap "Lighting" and then "Light Source(BLE)" to enter next page.
3. Tap the "Next" button to pair the LED Light.
4. Wait for the device to register (about 5-10s).
5. The figure shows "o", indicating completion of the connection.
6. You can tap "o" to change the device name. Then tap "Done" to enter the control panel.

6



APP OPERATING INSTRUCTIONS

RGB color interface

1. Choose the color you want
2. Adjust the color brightness
3. Presets to save frequently used colors
4. Set the timer

7



APP OPERATING INSTRUCTIONS

White-light mode interface

1. Adjust the color brightness
2. Presets to save common brightness modes
3. Set the timer

DIY mode interface

1. Set the desired color
2. Select the rhythm mode
3. Adjust the brightness and speed

8



APP OPERATING INSTRUCTIONS

Scene mode interface

1. Set color's jump
2. Adjust the brightness and speed

Music mode interface

The light will change its color and brightness following the music collected by the microphone.

9



HOW TO CONTROL LIGHTS IN GROUPS

Note: If the light is offline, it cannot be grouped.

1. Click More in any of the mode screens of any of the lights.
2. Create a group
3. Select the named group and operate the APP.

2.1 Click "+" add Devices

2.2 Save group Customizable name

10



PREPARATION

Check all components for damage, do not use the product if it is damaged.

Estimated Assembly Time:10-30 minutes

TOOLS REQUIRED (not included)

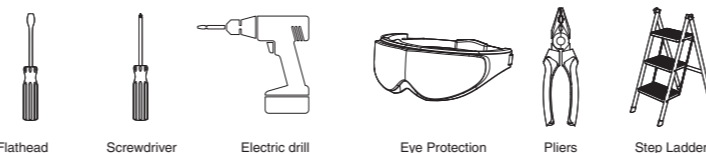

11



PREPARATION

CAUTION: PLEASE MAKE SURE YOUR WALL SWITCH AND POWER AT MAIN CIRCUIT BREAKER BOTH ARE OFF.

IF IN DOUBT ABOUT ELECTRICAL INSTALLATION, CONSULT A LICENSED ELECTRICIAN.

WARNING: INSTALLING THIS LIGHT IN AN UNGROUNDED ELECTRICAL SYSTEM MAY CAUSE THE METAL PARTS OF THE LIGHT TO CARRY CURRENT IF ANY WIRES OR WIRE CONNECTIONS ARE DAMAGED OR LOOSE. IN THIS CASE, ANYONE WHO TOUCHES THE LIGHT WILL RECEIVE AN ELECTRIC SHOCK, RESULTING IN INJURY OR DEATH.

BE CAREFUL NOT TO DAMAGE OR CUT THE WIRE INSULATION (COVERING) DURING INSTALLATION. DO NOT LET THE WIRES TOUCH ANY SHARP EDGES.

WARNING:

THIS PRODUCT MUST BE INSTALLED IN ACCORDANCE WITH THE APPLICABLE INSTALLATION CODE BY A PERSON FAMILIAR WITH THE CONSTRUCTION AND OPERATION OF THE PRODUCT AND THE HAZARDS INVOLVED.

RISK OF SHOCK- BEFORE BEGINNING INSTALLATION,TURN OFF ELECTRICITY AT THE CIRCUIT BREAKER BOX OR THE MAIN FUSE BOX.

12



INSTALLATION STEPS

Step 1: According to the spacing (see the "A" part of the picture) of two screw bits on the LED Light bracket, drill two mounting holes.

Step 2: Put the bracket onto the prepared mounting holes and then screw it on.

Step 3: Adjust the beam direction as you like, Wiring.

Step 4: Adjust the beam direction as you like, and then plug into the main socket.

13



FCC ID: 2BH66-LAB100G

FCC Warning:

Any Changes or modifications not expressly approved by the party responsible for compliance could void the user's authority to operate the equipment.

This device complies with part 15 of the FCC Rules. Operation is subject to the following two conditions:

- (1) This device may not cause harmful interference, and
- (2) this device must accept any interference received, including interference that may cause undesired operation.

Note: This equipment has been tested and found to comply with the limits for a Class B digital device, pursuant to part 15 of the FCC Rules. These limits are designed to provide reasonable protection against harmful interference in a residential installation. This equipment generates uses and can radiate radio frequency energy and, if not installed and used in accordance with the instructions, may cause harmful interference to radio communications. However, there is no guarantee that interference will not occur in a particular installation. If this equipment does cause harmful interference to radio or television reception, which can be determined by turning the equipment off and on, the user is encouraged to try to correct the interference by one or more of the following measures:

- Reorient or relocate the receiving antenna.
- Increase the separation between the equipment and receiver.
- Connect the equipment into an outlet on a circuit different from that to which the receiver is connected.
- Consult the dealer or an experienced radio/TV technician for help.

This equipment complies with FCC radiation exposure limits set forth for an uncontrolled environment. This equipment should be installed and operated with minimum distance 20cm between the radiator & your body.

Manufacturer/Hersteller:
HK JW Illumination Co., Limited
Address/Adresse: Unit 616, 6/F., Kam Teem Industrial Building, 135 Connaught Road West, Sai Wan Hong Kong
Email: support@olafuslife.com

UK Importer: MDH LIGHTING LTD
Address: 69 Aberdeen Avenue, Cambridge CB2 8DL, United Kingdom

MDH LIGHTING LTD
Address/Adresse: Suite 302, 292 Strovilos Avenue, 2048 Strovilos Nicosia, Cyprus
Email: service-MDHEU@hotmail.com



EC REP

Made in China

www.olafuslife.com



14