

目录

PART 1 Safety Precautions	2
PART 2 Component Description	5
PART 3: Feature Overview	6
PART 4: pedals	7
PART 5: Handlebar	8
PART 6: Battery Charging	9
PART 7: Safe riding	10
PART 8: Binding/Activating the Vehicle	13
PART 9: Assisted riding	14
PART 10: Safety Warnings	15
PART 11: Maintenance and Care	16
PART 12: E-Bike Sales (Warranty) Coverage	19
PART 13: Technical Specifications Table	22
PART 14: Warning	23
Appendix 1: After-Sales Warranty Card	25

PART 1 Safety Precautions

Dear Valued User, For your safety and that of your family, and to prevent accidental incidents, please carefully read this "Product User Manual" and practice to master the riding skills.

Safety Instructions

1. You must be familiar with and strictly adhere to local laws, regulations, and traffic rules. Do not exceed speed limits, run red lights, or ride against traffic.
2. It is strictly prohibited for individuals under 16 years of age to operate an electric bicycle on the road.
3. While riding, maintain a safe distance from other vehicles. Slow down and proceed cautiously at intersections. Signal before turning, avoid making sharp turns, towing or being towed by another vehicle, or holding onto other vehicles. Do not ride without both hands on the handlebars or while holding objects. Do not learn to ride on the road.
4. Comply with laws and regulations regarding the carrying of passengers or cargo. Overloading is strictly prohibited. The total load should not exceed 55 kg.
5. Do not lend the electric bicycle to someone who is not proficient in operating it, as this may lead to accidents.
6. It is strictly prohibited to use a high-pressure water gun to clean electronic components and wiring; use a damp cloth instead.
7. Do not park the vehicle in building entrances, evacuation stairways, corridors, or safety exits. The vehicle is prohibited from entering elevators.
8. Charging and parking the electric bicycle inside residential buildings is strictly prohibited. When charging, keep the bicycle away from flammable materials, and avoid prolonged charging.
9. When charging the battery, place the charger in a safe location out of children's reach.
10. Follow the correct methods for using and maintaining the battery. Do not disassemble used batteries on your own; they should be recycled by relevant professional organizations.
11. Follow the safety instructions and warnings when using the charger. Ensure that the replacement charger is compatible with the battery model.
12. Do not disassemble the electric bicycle or modify its performance and configuration without authorization. Any damages resulting from such actions will be your responsibility, and you will lose our warranty commitment. If parts replacement is needed, please contact after-sales service.
13. If you encounter any quality issues, please go to the service station for repairs and maintenance. If performance faults or quality problems arise due to self-repair or repair by non-authorized Bolyga service centers, Bolyga will not provide normal warranty services. Users will be solely responsible for damages to the vehicle, economic losses, and other consequences caused by unauthorized disassembly, modification, or improper use.

User Instructions

1. Ride smoothly on flat surfaces; avoid sudden acceleration, braking, or sharp turns while riding.
2. It is strictly prohibited to brake suddenly when going downhill, over-speeding, or riding at high speeds. Avoid using the front brake first to prevent shifting the center of gravity forward, which may cause danger.
3. ride cautiously, stay focused, and do not answer phone calls or use headphones while riding.
4. When riding at night, turn on the headlights and wear reflective clothing.
Keep all body parts away from moving components while riding or moving the vehicle.
Do not hang objects on the handlebars while riding to prevent loss of control and accidents.
5. If you encounter any issues during the ride, stop immediately and contact after-sales service promptly.
6. Do not use chargers from other brands or specifications for charging, and do not use the charger provided by this company to charge other electric bicycles.
7. When charging, first turn off the vehicle's power, then connect the charger to the battery, and finally connect it to the mains power.
8. When adjusting the handlebars or saddle, ensure that the safety line markings on the stem or saddle are not exposed (if applicable).

riding Safety Instructions

1. Always ride within the non-motorized lane, and do not exceed a maximum speed of 25 km/h; on roads without a non-motorized lane, ride close to the right side of the roadway.
2. In rainy or snowy conditions, the braking distance will increase, so reduce speed and proceed with caution.
3. Do not ride in severe weather conditions such as storms, heavy rain, fog, or icy conditions.
4. Avoid riding on uneven, muddy, gravel surfaces, or stairs to prevent tire blowouts, rim deformation, or damage to your electric bike, which may result in danger.
5. Do not ride through water; the water level should not exceed the lower edge of the rear wheel motor bearing to prevent water from entering the motor and causing damage.

Persons Prohibited from riding

1. Pregnant women, minors, and the elderly;
2. Individuals under the influence of alcohol or other drugs;
3. Persons exceeding the weight limit;
4. Individuals experiencing excessive fatigue;
5. Persons with mobility impairments due to illness.

Pre-riding Precautions

For your safety and the safety of others, please carefully read the following:

1. Wear a safety helmet and other protective gear before riding.
2. Turn on the power switch and check the battery level.
3. Ensure the headlights and turn signals are functioning properly.
4. Check the condition of the power circuit and lighting circuits to ensure they are in good working order.
5. Test the front and rear brakes for proper braking performance and check the braking distance.
6. Inspect the reflectors for any damage or dirt contamination.
7. Ensure that all components are securely fastened.
8. Check tire pressure: ensure normal tire pressure (front wheel 250 KPa; rear wheel 250 KPa) and that the tire tread is intact and undamaged.

PART 2 Component Description

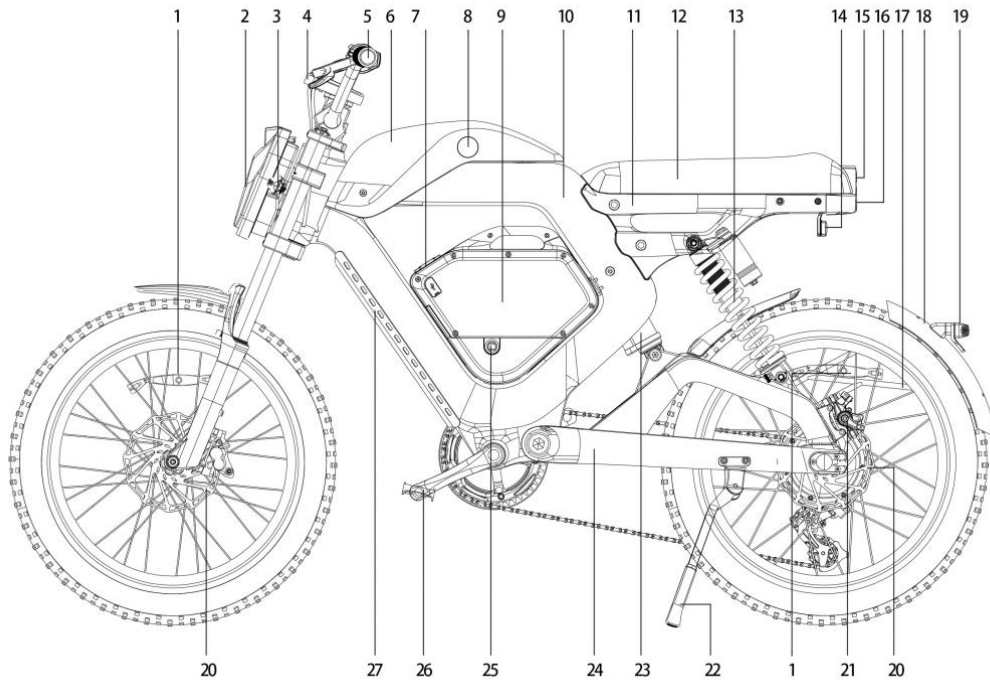

- 1.Side Reflector 2.Intelligent Headlamp Assembly 3.Turn Signal
4.Front Fork 5.Handlebar 6.Tank Cap 7.Battery Compartment Handle
8.Sound Box 9.Battery Compartment 10.Die-cast Frame Body
11.Saddle Bracket 12.Saddle 13.Rear Shock Absorber
14.Rear Camera 15.Rear Radar 16.Taillight 17.Mudguard Stay
18.Mudguard 19.Rear Reflector 20.Disc Brake 21.Transmission
22.Kickstand 23.Central Shock Absorber 24.Rear Swingarm 25.pedal
26.Frame Decorative Cover

PART 3: Feature Overview

Applicable to the Juexing 001 Model:



1. One-click shooting
2. Turning view
3. Blind Spot Detection Warning
4. Cruise Control
5. Find My Vehicle Navigation
6. "Thousand-Mile Eye" Anti-Theft Monitoring
7. Personalized Riding Sound Effects
8. Fitness Mode

PART 4: pedals

Installing the pedals

Please follow the steps below to install the pedals.

Ensure that the pedals are installed on the correct side, as incorrect installation may damage the threads on the pegs. The left pedal is marked with an "L," and the right pedal is marked with an "R."

As shown in the diagram, install the left pedal by rotating it counterclockwise, then use a 15mm wrench to tighten the pedal until it is securely in place.

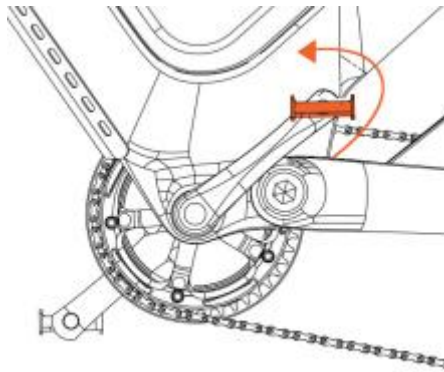

As shown in the diagram, install the right pedal by rotating it clockwise, then use a 15mm wrench to tighten the pedal until it is securely in place.

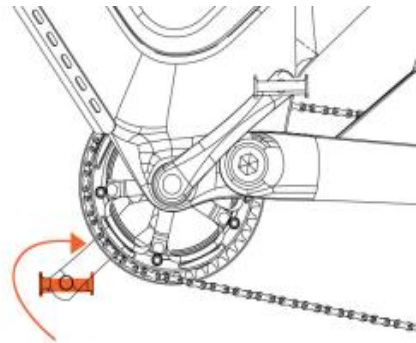

PART 5: Handlebar

Installing the Handlebar

Place the handlebar onto the stem, align the mounting block with the screw holes, and use an Allen wrench to install the four mounting screws.

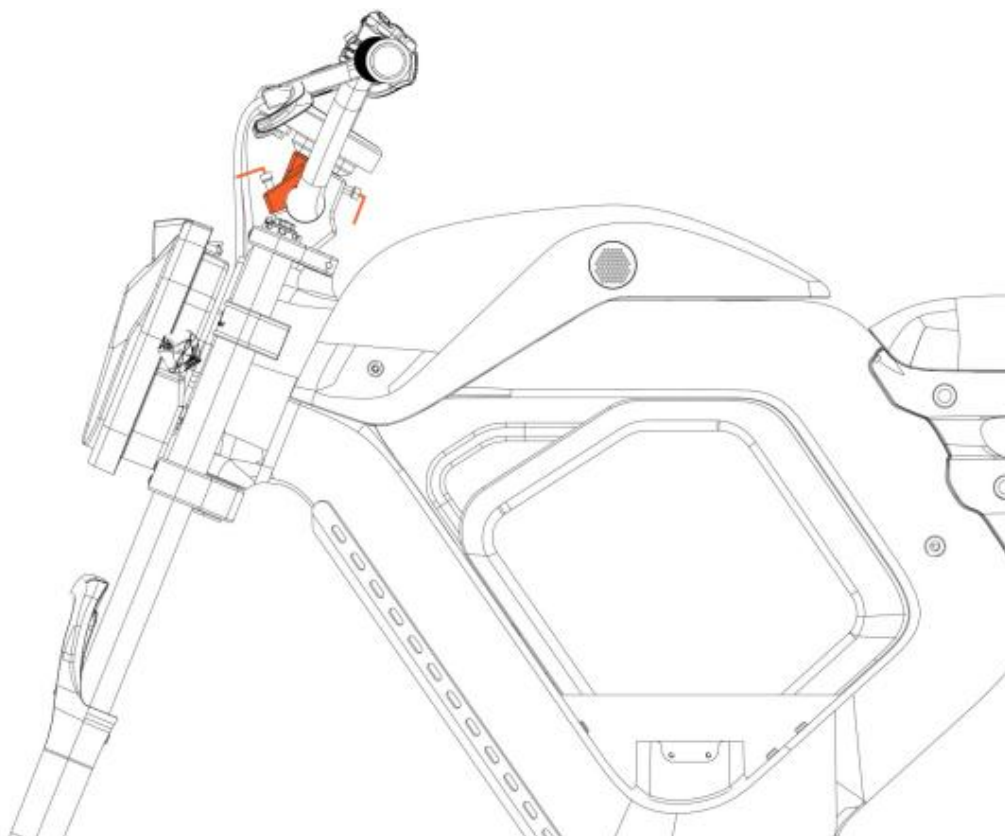

PART 6: Battery Charging

Always use the original Boliga charger to charge the battery. Modifying or disassembling the battery is strictly prohibited.

- When charging, first connect the charger to the battery, then connect it to the power outlet.
- If the vehicle is not used for an extended period, charge the battery once a month, charging it to 100%.

Vehicle Charging

- ① Connect the charger to the battery.

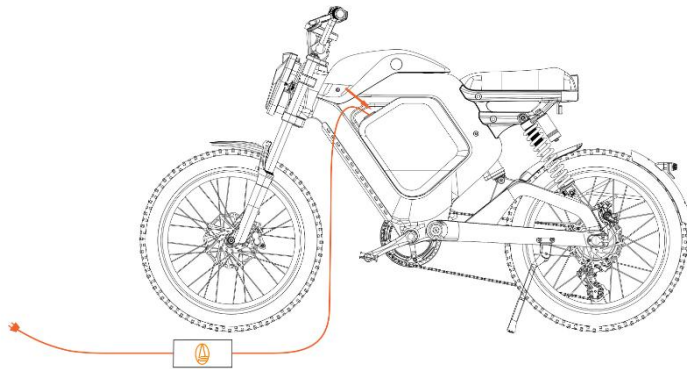

- ② Plug the charger into the power outlet to start charging.

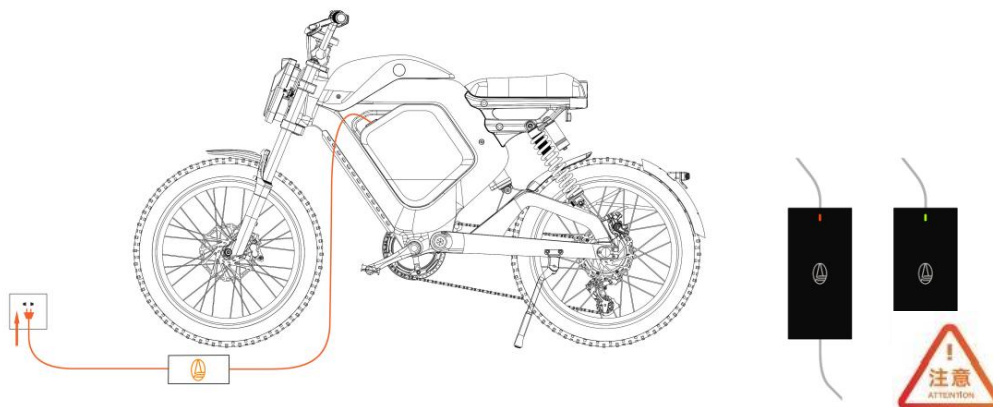

- The red light on the charger indicates that charging is in progress.
- The green light on the charger indicates that the battery is fully charged or the charger is not connected to the battery.

PART 7: Safe riding

For your safety and the safety of your family, please carefully read this product's user manual before learning to ride. Adhere to traffic rules, avoid speeding, running red lights, and riding against traffic. Always wear a certified helmet and other protective gear to minimize potential injuries.

There are two ways to start the vehicle:

Starting with a Card

① Lightly touch the card to the instrument panel screen. After hearing the sound effect, the vehicle will start within approximately 1-2 seconds.

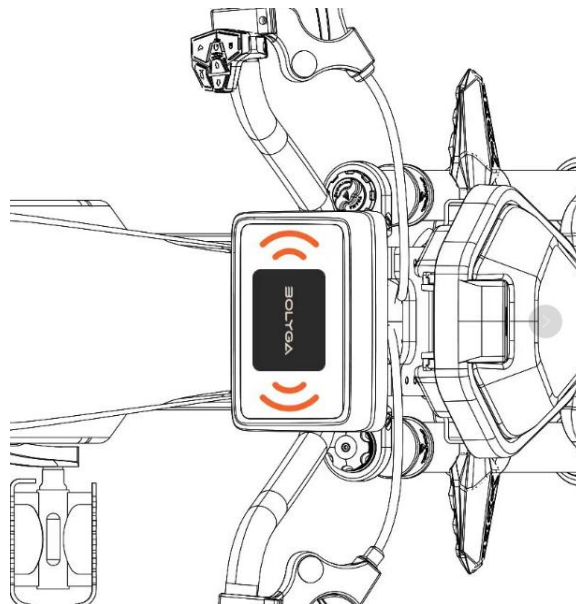

Starting with a Mobile App

② When Bluetooth is connected or the network connection is stable, open the app and tap the unlock button to start the vehicle.



There are three ways to shut down the vehicle:

Shutdown with a Button

① Lightly touch the card to the instrument panel screen. After hearing the sound effect, the vehicle will shut down within approximately 1-2 seconds.

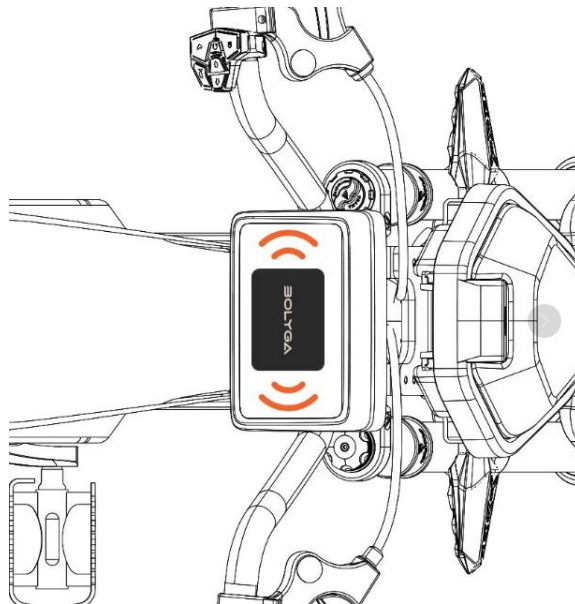

Shutdown with the Mobile App

② When Bluetooth is connected or the network connection is stable, open the app and tap the shutdown button to turn off the vehicle.



PART 8: Binding/Activating the Vehicle

① Search for and download the "_____" app from the app store, or open WeChat and scan the QR code on the left to download the app.



③ The app will automatically enter the vehicle binding mode, displaying the frame number and password. Simply tap the "Bind" button.

④ After binding is complete, you will automatically enter the "My Vehicle" interface.



⑤ You can now start riding your E-BIKE electric-assisted bicycle and use the app to check the vehicle's status. Enjoy your ride!



PART 9: Assisted riding

Before riding, please check the battery indicator. If the battery level is low, recharge it immediately.

Please read the "Pre-ride Preparation" section on pages 10-11 before riding.

Sit on the saddle, grip the handlebars with both hands, stabilize the vehicle, retract the side stand, and place both feet on the ground. Once you start pedaling and reach a certain speed, the electric assist will engage, allowing you to enjoy your ride.

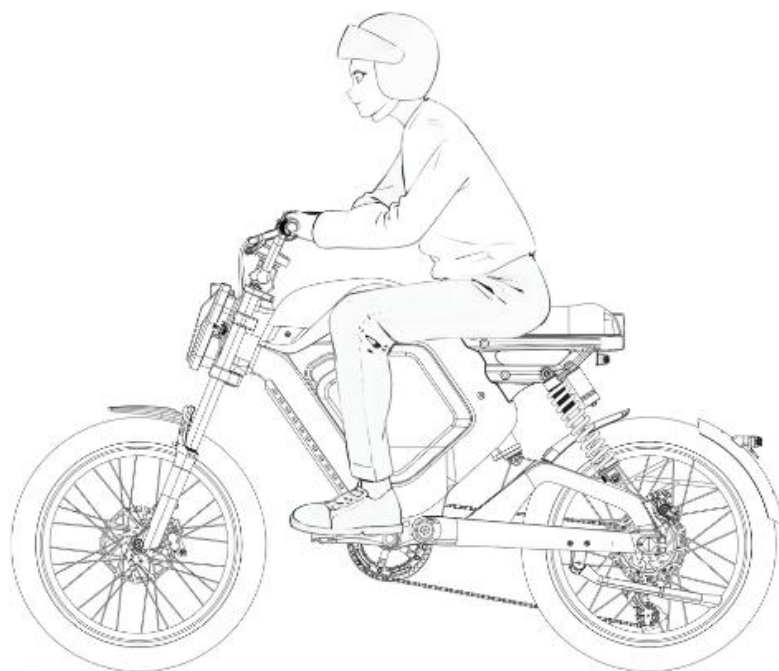

PART 10: Safety Warnings

Warning: Failure to follow the instructions below may result in serious injury.



Do not ride in harsh weather conditions such as rain or snow!

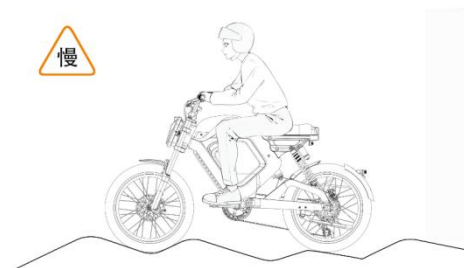

When riding on bumpy roads, speed bumps, or other irregular surfaces, slow down and proceed with caution.



When turning or changing direction, slightly lean your body in the direction of the turn and gently steer the handlebars. Avoid making sharp turns!



Do not use your phone or wear headphones while riding!



Do not release both hands from the handlebars while riding!



It is strictly prohibited to hang objects on the handlebars!

PART 11: Maintenance and Care

Vehicle Cleaning

Water Cleaning Precautions

1. Disconnect the vehicle's power before cleaning. Do not touch any live parts, such as the battery's charging and discharging ports, with wet hands or metal conductors.
2. Do not spray water directly onto electrical components. When cleaning the vehicle, use a damp towel, wrung out, to wipe the exterior. For stubborn dirt, use a toothbrush. After cleaning, dry the vehicle with a soft cloth.
3. Avoid spraying water on the charging port, wire harness connectors, and fuses. Do not pour water directly into storage compartments.
4. Do not spray water directly on the brakes, motor, or front and rear axles to prevent water ingress that could affect the longevity of vehicle components.
5. Do not use steam or high-pressure hoses to wash the vehicle.

Caution!

Do not use alcohol, gasoline, kerosene, or other corrosive or volatile solvents for cleaning. These substances may damage the vehicle's exterior and internal structures. Avoid using high-pressure water guns or hoses to spray the vehicle.

Storage

1. Store the vehicle in a flat, stable, and dry location, preferably in a cool underground garage designated for parking. Avoid exposure to sunlight and rain to prevent rust and aging of components.
2. If the battery is not used for an extended period, it is recommended to store it with a charge level of about 50%, and disconnect the battery plug. Failing to do so may significantly reduce the battery's lifespan, and in severe cases, it could result in the battery being rendered unusable.

Caution!

During maintenance, check all parts for any abnormalities. If any issues are found, contact after-sales support or an authorized service center.

Component Maintenance

Motor

1. The motor does not require adjustment or maintenance during normal use; only surface cleaning, such as dust removal, is necessary. Do not apply lubricant to the transmission parts.
2. When riding through water, the water level should not exceed the lower edge of the rear wheel motor bearing housing to prevent water from entering the motor and causing damage.
3. Regularly check whether the motor connections are loose, the appearance is deformed, or the motor phase wires are damaged.
4. The motor hub must not be subjected to severe impacts, and the motor should not be forced to run under stalled conditions. Overloading the motor is strictly prohibited.
5. Do not ride on uneven surfaces, as this can severely damage the motor and the hub.
6. The vehicle is adjusted to optimal performance before sale. During use, do not disassemble the electrical components or related parts. If abnormal noises from the transmission parts or electrical failures occur, contact after-sales support or an authorized service center.
7. **Controller** The controller is adjusted to the optimal setting at the time of manufacture. If electrical faults or loss of control occur during riding, non-professional personnel should only inspect the cables and connectors. If the issue cannot be resolved, contact after-sales support or an authorized service center immediately.

Caution!

During maintenance, inspect all parts for abnormalities. If any issues are found, contact after-sales support or an authorized service center.

Battery

1. Before use, ensure that the battery model matches the original battery supplied with the vehicle. Do not use batteries of other brands or models.
2. The individual user manual provided in the battery and charger packaging is part of the product. Please read and understand it carefully before use.
3. Fully charge the battery before first use. If the battery level is low during riding, recharge it promptly to extend the battery's lifespan.
4. When the battery is depleted, to charge it, open the battery port cover, connect the charging plug, and charge as usual. It is recommended to use either external or built-in charging methods directly.
5. Charge the battery when its level drops below 20%. Regular charging after use will help extend the battery's lifespan. Failing to recharge the battery immediately after riding can significantly reduce its lifespan, and in severe cases, render the battery unusable.
6. If the electric vehicle will not be used for an extended period, disconnect the battery plug and recharge the battery at least once a month to prolong its life. This will prevent battery depletion, which is not covered by the warranty. Users and dealers are strictly prohibited from modifying the battery configuration or other vehicle components.
7. Regular maintenance checks at a professional Boliga service center are recommended.

Warning: Do not dispose of old batteries irresponsibly to avoid environmental pollution. This product's used batteries should be recycled by the company, dealer, or a government-designated facility.
Keep the battery charging area away from children.

Charger

1. Users must follow the instructions in the manual when charging and must use the original charger provided. Failure to do so may result in consequences that the user will be responsible for.
2. Only charge batteries that match the charger's specified type and voltage. Do not mix different battery types, and do not attempt to charge non-rechargeable or incompatible batteries.
3. Do not carry the charger with the vehicle to avoid damage to the internal electronic components caused by bumps.
4. The charger should be placed in a well-ventilated area while charging. Do not charge in enclosed spaces or under direct sunlight or high temperatures.
5. Charge the vehicle in a well-ventilated area, away from fire sources, and protect it from rain and sunlight.
6. If the indicator light behaves abnormally, or if you notice unusual odors or excessive heat from the charger casing during charging, stop charging immediately and have the charger inspected or replaced.
7. After charging, disconnect the power supply before unplugging the battery.
8. Keep your hands dry when plugging or unplugging the charger. Do not allow conductive objects to touch both ends of the battery box charging port or the connection cable charging port.
9. When the green light turns on, disconnect the power supply promptly. Do not leave the charger connected to an AC power source without charging for an extended period.
10. Do not disassemble or replace components inside the charger yourself. For any malfunctions, contact after-sales support or an authorized service center.

Warning: Ensure adequate ventilation during charging to avoid fire hazards. Keep the charger away from explosive gases.

Charging should be done in a dry, well-ventilated environment, away from moisture, and far from flammable and explosive materials. The recommended ambient temperature for charging is 10-30°C.

PART 12: E-Bike Sales (Warranty) Coverage

★ Scope of Free Repair Warranty:

If any malfunctions occur during the warranty period while the customer is using the product according to this manual, free repairs can be obtained at authorized dealer stores.

Component Name	Warranty Period	Warranty Coverage
Frame	24 months	<ol style="list-style-type: none">1. Damage caused by impact, unauthorized modifications, or other human factors is not covered by after-sales service.2. Performance failures caused by product defects that result in irreparable open welds, broken welds, fractures, or distortion.
Front Fork	24 months	<ol style="list-style-type: none">1. Damage caused by impact, unauthorized modifications, or other human factors is not covered by after-sales service.2. Irreparable open welds, broken welds, or fractures that lead to performance failures.
Battery Pack	24 months	<ol style="list-style-type: none">1. Damage caused by impact, unauthorized disassembly, or other human factors is not covered by after-sales service.2. Use of non-original chargers.3. Accessories such as the battery lock, battery case, charging port, and battery case handle are excluded.
Motor	24 months	Performance failures caused by product defects that result in irreparable issues such as phase coil failures, burnout, demagnetization, or detachment of magnetic steel, as well as axle deformation or fracture, warrant a motor replacement.
Controller	12 months	<ol style="list-style-type: none">1. Performance failures caused by product defects that cannot be repaired.2. Damage caused by impact or unauthorized modifications is not covered by after-sales service.
Combination Switch, Throttle	12 months	<ol style="list-style-type: none">1. Damage caused by unauthorized disassembly of the casing, or modifications made by users, is not covered by after-sales service.2. Damage caused by impact or other human factors is not covered.3. Performance failures caused by manufacturing defects that cannot be repaired.
Front Light	12 months	<ol style="list-style-type: none">1. Damage caused by unauthorized disassembly of the casing, or modifications made by users, is not covered by after-sales service.2. Damage caused by impact or other human factors is not covered.3. Performance failures caused by manufacturing defects that cannot be repaired.
Instrument Panel	12 months	<ol style="list-style-type: none">1. Damage caused by unauthorized disassembly of the casing, or modifications made by users, is not covered by after-sales service.2. Damage caused by impact or other human factors is not covered.3. Performance failures caused by manufacturing defects that cannot be

		repaired.
Charger	12 months	1. Damage caused by impact or other human factors is not covered by after-sales service. 2. Damage caused by unauthorized disassembly. 3. Performance failures caused by manufacturing defects that cannot be repaired.

Component Name	Warranty Period	Warranty Coverage									
Main Wiring Harness	12 months	<ul style="list-style-type: none"> Damage caused by unauthorized disassembly of the casing or modifications made by users is not covered by after-sales service. Performance failures caused by manufacturing defects that cannot be repaired. 									
Brake Lever (including disc brake)	12 months	<ul style="list-style-type: none"> Damage caused by impact or other human factors is not covered by after-sales service. Performance failures caused by product defects, such as irreparable open welds, broken welds, fractures, or deformation. 									
Handlebar, Parking Stand, Chainring, Crank, Freewheel, Headset Assembly, pedals, Wheel Rims, Front Hub, Painted Parts, Saddle	12 months	<ul style="list-style-type: none"> Damage caused by impact or other human factors is not covered by after-sales service. Damage caused by unauthorized modifications is not covered by after-sales service. Performance failures caused by product defects or functional loss that cannot be repaired. Irreparable fractures, cracks, broken welds, or deformation that cannot be corrected warrant replacement. Plastic parts or painted parts with paint quality issues such as cracking or natural cracks larger than 1 square centimeter may be replaced. <table border="1"> <tr> <td>Warranty Period Distinction</td><td>12 months</td><td>6 months</td></tr> <tr> <td>Saddle</td><td>Plastic Shell, Bow</td><td>Cover, Foam</td></tr> <tr> <td>pedals</td><td>Axle,</td><td>Plastic Parts</td></tr> </table>	Warranty Period Distinction	12 months	6 months	Saddle	Plastic Shell, Bow	Cover, Foam	pedals	Axle,	Plastic Parts
Warranty Period Distinction	12 months	6 months									
Saddle	Plastic Shell, Bow	Cover, Foam									
pedals	Axle,	Plastic Parts									

			Bearings	
		<p>Note:</p> <p>Apart from the warranty-covered components listed above, other consumable parts are not included in the warranty coverage. This includes items such as inner and outer tires, grips, spokes, chains, pedals, mudguards, reflectors, plastic parts, and any tools or accessories provided as gifts.</p> <p>The following circumstances are not covered under the warranty, but authorized dealers may offer repair services for a fee:</p> <ol style="list-style-type: none"> 1.Failure to use or maintain the electric bicycle according to the user manual. 2.Using the electric bicycle for purposes other than its intended use or performing dangerous actions. 3.Damage caused by unauthorized disassembly of the casing or user modifications. 4.Use of non-original parts. 5.Damage from traffic accidents or other collisions. 6.Riding on non-standard roads. 7.Commercial rental use or other commercial purposes. 8.Damage caused by force majeure events. 9.Repairs performed by non-authorized service centers. 		

PART 13: Technical Specifications Table

Main Technical Specifications of the Vehicle	Awaken-01
Overall Dimensions (L×W×H)	1740mm×730mm×1080mm
Wheelbase (front to rear wheel center distance)	1100mm
Vehicle Weight	54kg
Maximum Designed Speed	45km/h
Range	100km
Load Capacity	100kg

Main Technical Specifications of the Battery	Awaken-001
Battery Type	Lithium Iron Phosphate Battery Pack
Capacity	25Ah
Nominal Voltage	48V

Main Technical Specifications of the Motor	Awaken-001
Motor Type	Permanent Magnet
Rated Power	750W
Rated Speed	480r/min
Rated Voltage	48V

Main Technical Specifications of the Controller	Awaken-001
Undervoltage Protection Value	41±0.5V
Overcurrent Protection Value	25±1A

PART 14: Warning

FCC STATEMENT:

This device complies with part 15 of the FCC Rules. Operation is subject to the following two conditions:

(1) This device may not cause harmful interference, and (2) this device must accept any interference received, including interference that may cause undesired operation.

Any Changes or modifications not expressly approved by the party responsible for compliance could void the user's authority to operate the equipment.

Note: This equipment has been tested and found to comply with the limits for a Class B digital device, pursuant to part 15 of the FCC Rules. These limits are designed to provide reasonable protection against harmful interference in a residential installation. This equipment generates uses and can radiate radio frequency energy and, if not installed and used in accordance with the instructions, may cause harmful interference to radio communications. However, there is no guarantee that interference will not occur in a particular installation. If this equipment does cause harmful interference to radio or television reception, which can be determined by turning the equipment off and on, the user is encouraged to try to correct the interference by one or more of the following measures:

- Reorient or relocate the receiving antenna.
- Increase the separation between the equipment and receiver.
- Connect the equipment into an outlet on a circuit different from that to which the receiver is connected.
- Consult the dealer or an experienced radio/TV technician for help.

This equipment complies with FCC radiation exposure limits set forth for an uncontrolled environment. This equipment should be installed and operated with minimum distance 20cm between the radiator & your body.

INDUSTEY CANADA STATEMENT:

This device complies with Industry Canada licence-exempt RSS standard(s). Operation is subject to the following two conditions: (1) This device may not cause harmful interference, and (2) this device must accept any interference received, including interference that may cause undesired operation of the device. In additional, this device complies with ICES-003 of the Industry Canada (IC) Rules.

Any Changes or modifications not expressly approved by the party responsible for compliance could void the user's authority to operate the equipment.

Note: This equipment has been tested and found to comply with the limits for a Class B digital device, pursuant to Industry Canada licence-exempt RSS standard(s). These limits are designed to provide reasonable protection against harmful interference in a residential installation. This equipment generates uses and can radiate radio frequency energy and, if not installed and used in accordance with the instructions, may cause harmful interference to radio communications. However, there is no guarantee that interference will not occur in a particular installation. If this equipment does cause harmful interference to radio or television reception, which can be determined by turning the equipment off and on, the user is encouraged to try to correct the interference by one or more of the following measures:

- Reorient or relocate the receiving antenna.

- Increase the separation between the equipment and receiver.
- Connect the equipment into an outlet on a circuit different from that to which the receiver is connected.
- Consult the dealer or an experienced radio/TV technician for help.

This equipment complies with RSS-102 radiation exposure limits set forth for an uncontrolled environment. This equipment should be installed and operated with minimum distance 20cm between the radiator & your body.

INDUSTEY CANADA STATEMENT(French):

Cet appareil est conforme aux normes RSS exemptes de licence d'Industrie Canada. Son fonctionnement est soumis aux deux conditions suivantes : (1) Cet appareil ne doit pas causer d'interférences nuisibles et (2) cet appareil doit accepter toute interférence reçue, y compris les interférences susceptibles de provoquer un fonctionnement indésirable de l'appareil. De plus, cet appareil est conforme à la norme ICES-003 des règles d'Industrie Canada (IC).

Tout changement ou modification non expressément approuvé par la partie responsable de la conformité pourrait annuler l'autorité de l'utilisateur à faire fonctionner l'équipement.

Remarque : cet équipement a été testé et déclaré conforme aux limites d'un appareil numérique de classe B, conformément aux normes RSS exemptes de licence d'Industrie Canada. Ces limites sont conçues pour fournir une protection raisonnable contre les interférences nuisibles dans une installation résidentielle. Cet équipement génère des utilisations et peut émettre de l'énergie de radiofréquence et, s'il n'est pas installé et utilisé conformément aux instructions, peut causer des interférences nuisibles aux communications radio. Cependant, il n'y a aucune garantie que des interférences ne se produiront pas dans une installation particulière. Si cet équipement cause des interférences nuisibles à la réception radio ou télévision, ce qui peut être déterminé en éteignant et en rallumant l'équipement, l'utilisateur est encouragé à essayer de corriger l'interférence par une ou plusieurs des mesures suivantes :

- Réorientez ou déplacez l'antenne de réception.
- Augmenter la distance entre l'équipement et le récepteur.
- Connectez l'équipement à une prise sur un circuit différent de celui auquel le récepteur est connecté.
- Consultez le revendeur ou un technicien radio/TV expérimenté pour obtenir de l'aide.

Cet équipement est conforme aux limites d'exposition aux rayonnements RSS-102 établies pour un environnement non contrôlé. Cet équipement doit être installé et utilisé avec une distance minimale de 20 cm entre le radiateur et votre corps.

Appendix 1: After-Sales Warranty Card

User Name:

User Phone:

User Address:

Product Name:

Product Model:

Motor Number:

Frame Number:

Instrument Device Number:

Date of Sale:

Dealer: