



# USER MANUAL



G810S Plus

**After-sales: +(1) 866-788-8775**  
(PST 8: 00 am-5:00 pm, Mon-Fri)



**Call us directly with any issues**

Mirror Dash Cam

# CUSTOMER SUPPORT

Your experience is our focus.

Any feedback or suggestions from you are very important to us.

We are very happy to listen to the voices from customers.

## After-sales Support E-mail

[jomise-us@jomise-cam.com](mailto:jomise-us@jomise-cam.com)

### Facebook



### WhatsApp



**After-sales: +(1) 866-788-8775**

(PST 8: 00 am-5:00 pm, Mon-Fri)



**Call us directly with any issues**



<https://www.facebook.com/Jomiseofficial>



Made in China

# INDEX

|                         |       |
|-------------------------|-------|
| PRECAUTIONS             | 1     |
| SPECIFICATION           | 2     |
| PACKAGE CONTENTS        | 3     |
| PRODUCT APPEARANCE      | 4     |
| ABOUT MEMORY CARD       | 5     |
| INSTALLATION            | 6-10  |
| HOMEPAGE OPERATION      | 11-12 |
| CAR DVR OPERATION GUIDE | 13-14 |
| VIDEO PLAYBACK          | 15    |
| GPS INFORMATION         | 16    |
| ANDROID AUTO CONNECTION | 17-19 |
| CARPLAY CONNECTION      | 20-21 |
| FM TRANSMIT             | 22    |
| SETTINGS INTRODUCTION   | 23-25 |
| FAQ                     | 26-27 |

# PRECAUTIONS

- Please read this manual carefully before operation and keep it for future reference. It will be helpful should you encounter any operational problem.
- Improper installation will void the manufacturer's warranty. The installation instructions do not apply to all types of vehicles and are written as guidelines to assist in installing the system.
- Consult an experienced technician if you are not comfortable installing the product.
- Please make sure to read and understand all local laws and regulations regarding cameras and their use in a vehicle. Laws vary by state.
- Do not obscure the view of the road ahead or impede the deployment of any airbags in the event of an accident.
- When not in use, please disconnect the car adaptor from both the 12/24V DC outlet in your vehicle and the device itself.
- Only clean the device with a soft dry cloth, for tough dirt, apply some neutral detergent diluted in 5 to 6 parts water to a soft cloth.
- Note that alcohol, thinner, benzene, etc could cause damage to the paint or coatings.
- Avoid making contact with the Lens as damage may be caused.
- The video recordings made by this Digital Video Recorder are intended for personal use only.
- Whilst driving, do not adjust the controls of your device as this is a distraction to driving.

# SPECIFICATION

|                              |                                   |
|------------------------------|-----------------------------------|
| <b>Item Name</b>             | 9.88" Mirror Dash Camera          |
| <b>Model</b>                 | JOMISE C810                       |
| <b>Screen Size</b>           | 9.88" High-definition IPS Display |
| <b>Display Resolution</b>    | 1600 x 400P                       |
| <b>Recording Resolution</b>  | Front: 2560*1440P/1920*1080P      |
|                              | Rear: 1920*1080P                  |
| <b>Lens</b>                  | Front Camera: F1.8 170°           |
|                              | Rear Camera: F2.0 150°            |
| <b>Recording Format</b>      | TS                                |
| <b>Photo Format</b>          | JPG                               |
| <b>Memory Card</b>           | 32G~256G U1 Memory Card           |
| <b>Storage Temperature</b>   | -40°F~176°F                       |
| <b>Operating Temperature</b> | -4°F~158°F                        |
| <b>Mainboby Weight</b>       | 0.74lb                            |
| <b>Item Dimension</b>        | 10×2.7×1.6(in)                    |
| <b>Power Interface</b>       | Type-C 5V/3A                      |

# PACKAGE CONTENTS



JOMISE C810 Mirror Dash Cam



Backup Camera \*1



GPS \*1



Backup camera cable (21ft) \*1



Car Charger \*1



User Manual \*1



Straps \*4



Mount Bracket\*1  
(Inside of Vehicle)



Mount Bracket\*1  
(Outside of Vehicle)



Cleaning Cloth \*1

# PRODUCT APPEARANCE

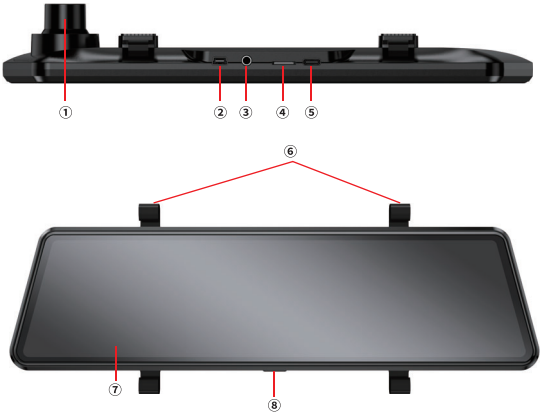

| NO. | Name             | Overview  |
|-----|------------------|---|
| 1   | Front Camera     | Record the front view of the vehicle.                                       |
| 2   | Rear Camera Port | Connect the rear view camera.   |
| 3   | GPS Port         | Connect the GPS receiver.   |
| 4   | Memory Card Slot | Insert a Memory card (maximum support 256G).                                |
| 5   | Power Supply     | Connect the car charger.  |
| 6   | Fasteners        | Please use the silicone strap that comes with the package.                  |
| 7   | Screen           | 10 inch IPS touch screen.   |
| 8   | Power Button     | Short press to turn on/off the screen, long press to turn on/off the power. |

# ABOUT MEMORY CARD

## 1. Installation

Make sure the product is turned off or disconnected from the power supply, prevent incorrect insertion. If there is obstruction when inserting the card, please switch the direction of the Memory card.

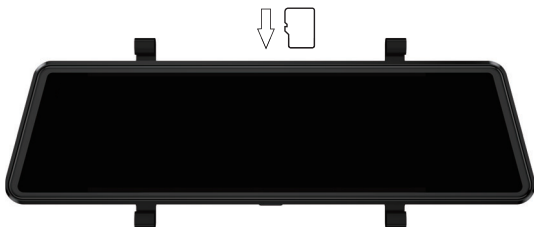

## 2. Remove

To remove the Memory card, gently push its edges inward until a clicking sound is heard, then eject and pull it out of the slot.

### NOTE

- The Memory card cannot be removed or inserted when the product is turned on, which can easily cause product malfunctions.
- Regularly format Memory card once a month to extend its lifespan.
- Formatting the Memory card will delete all data inside the card. Please **save important video files in advance.**



# INSTALLATION

## ■ Mount the Main Body

Step 1: Attach the upper end of the straps to the retaining hooks on the top of the rear-view mirror.



Step 2: Pull out the front lens of the JOMISE C810 to match the rearview mirror of the vehicle.



Step 3: Extend the straps around the back of the rear-view mirror and attach them to the bottom retaining hooks.



# INSTALLATION

## ■ Selection of mounting brackets

### Interior mounting

Please use the interior bracket on the picture



Mounted on the rear glass. Attach to the camera's mounting bracket with double-sided tape.

### Outside mounting

Please use the outside bracket on the picture



Install it above the license plate or in the upper middle of the rear glass

# INSTALLATION

## ■ How to install the rear camera

We recommend installing the rear camera above the license plate.

1. Fix the rear camera with adhesive  
Find the best location, tear off the adhesive on the rear camera, and fix the rear camera near by the car license plate lamp (If you need to adjust the angle, please attach the rear camera bracket to the rear camera first and tighten it with screws).



### 2. Remove the Panel

Remove your trunk's interior panel to expose the car's rear wiring chambers. Pop open your trunk and look for a solid interior panel covering the opposite side of your license plate mounting area. Then, insert a trim removal tool or other slender tools behind the panel and pry it off.



### 3. Snake the cable

Use a trim removal tool to pop out the tailgate trim, then run the cable from the outside of the car into the trunk of your car.



\* The red wire on the rear camera cable does not need to be connected (It is designed for another model of our products).

# INSTALLATION

4. Connect the rear camera's power cable to the extension cable

After snaking your rear camera extension cable, connect the power cable to your rear camera's extension cord.



5. Route your rear camera's extension cable to the front of the car

If you'd like, use a trim removal to pop out the headlining panel directly above your windshield. Then run your cable through the exposed chamber.



6. Power on the C810 with box included car charger, don't charge it with your own chargers.



## NOTE

- Make sure to remove the Plastic Lens Screen Protector from the lens before recording videos. Otherwise, your videos will look blurry and blocked.
- Do not remove the Memory Card while the C810 is TURNED ON. Otherwise, it may cause the Memory Card to be write-protected and possibly lose data or damage your Memory Card.
- Always remove/insert the Memory Card while the product is POWERED OFF.
- Do not use a socket distributor.
- Do not connect or disconnect the rear camera cable while the power is ON. It will be the cause of the product failure.
- The rear camera has a 180° Flip Function, you can flip the rear camera according to your needs.

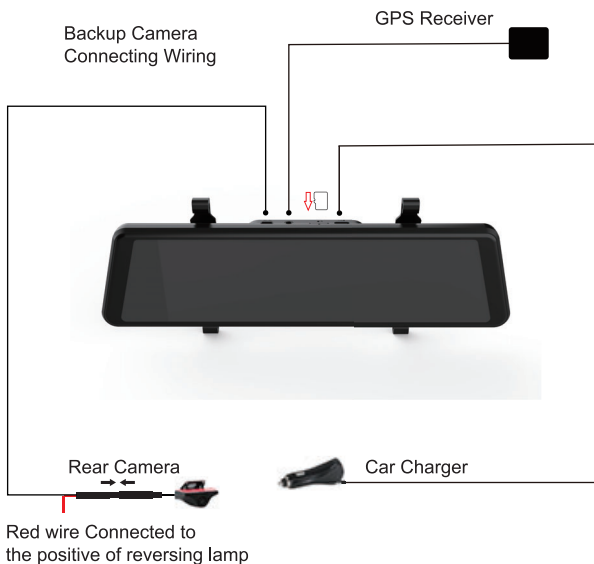

# INSTALLATION

## ■ Wiring Images



# HOMEPAGE OPERATION



- ① **Home Button:** Click to return to the Homepage of the product
- ② **Car DVR:** Click to enter the video recording interface
- ③ **Settings:** Click to enter the function setting interface
- ④ **DVR:** 1. Click on [  ] to start or pause the recording  
2. Click on [  ] to switch between front/rear cameras  
3. Click [  ] to enter the recording interface
- ⑤ **Android Auto:** Dedicated car screen projection program for Android phones
- ⑥ **CarPlay:** Dedicated car screen projection program for iPhone
- ⑦ **FM Transmit:** Click to enter the FM Transmit interface

# HOMEPAGE OPERATION

## Shortcut Settings

On the home page, drop down from the top to access the shortcut Settings

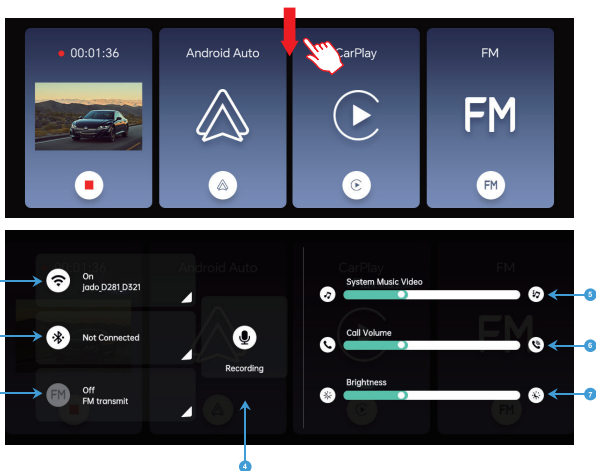





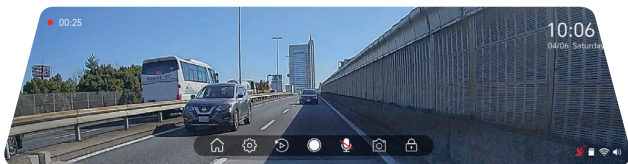

- ① Turn On/Off WIFI
- ② Turn On/Off Bluetooth
- ③ Turn On/Off FM
- ④ Turn On/Off audio recording
- ⑤ Adjust the system volume
- ⑥ Adjust the call volume
- ⑦ Adjust the screen brightness

# CAR DVR OPERATION GUIDE

1. Click on the DVR icon [  ] on the homepage to enter.
2. After the Memory Card is inserted into the host and effectively recognized, the system will automatically enter recording mode.
3. While recording, swipe the screen left or right to switch between front view, rear view, or split-screen view.



## 4. Icon Instructions:

| Icon  | Instructions  |
|---|---|
|    | Click to return to the homepage   |
|    | Click to enter the [Settings] interface   |
|   | Click to enter the [Video Playback] interface                                     |
|  | Start / Stop Recording  |
|  | Turn recording sound on or off  |
|  | Snapshot  |
|  | Click to lock the recorded video and it will not be looped overwritten or deleted |



# CAR DVR OPERATION GUIDE

## 5. Lock Video Function Description:

The number of videos that can be locked depends on the capacity of the Memory Card.

The Memory Card supports a minimum of 32GB and a maximum of 256GB.

General video files will automatically be overwritten in a circular manner, favoring the oldest files first. Locked videos cannot be overwritten automatically. It is advisable to periodically format the memory card to ensure the device operates smoothly.



▲ While recording, swiping the screen up and down adjusts the angle of view.



▲ While recording, swipe the screen left or right to switch between front view, rear view, or split-screen view.

# VIDEO PLAYBACK INTRODUCTION

1. Click the icon [  ] on recording page to enter the Video Playback interface.

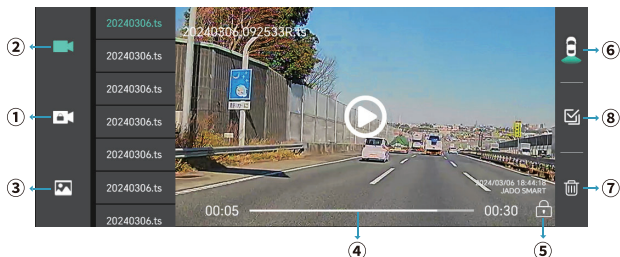

1. Locked Video Folder
2. Loop Recording Video Folder
3. Picture Folder
4. Playing Progress Bar(draggable)
5. Lock Button
6. Switch Front / Rear Camera Folder
7. Delete Button
8. Choose Multiple File

File name ("F" for front, "R" for rear)

# GPS INFORMATION

## View GPS Data with Software [CAR DVR Player]

If you need to track GPS information, please download the dedicated player, the download link(Compatible with Windows) is as follows:

<https://bit.ly/3oaH9Dp>

For Mac, please search "CAR DVR Player" in App Store.

By using the file playback software [CAR DVR Player], you can check

all drive information such as Time, Location, Speed, and so on



Scan to download

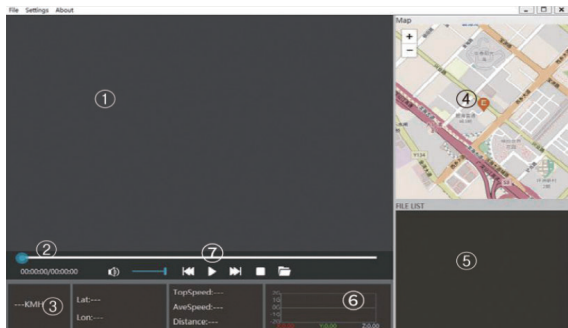

- ① Playback Screen :Playback screen display
- ② Scroll Bar :Click ,can speed forward or back
- ③ GPS Information :Including Latitude , Longitude , Speed
- ④ Map Display :Show the location of the car on the map
- ⑤ Playlist :The data list for playback
- ⑥ G-sensor Data
- ⑦ Play / Pause

# ANDROID AUTO CONNECTION GUIDE

C810 supports Android Auto, please follow the instructions on the host screen to connect your Android phone. After the first successful connection of Android Auto, the host will automatically connect to the phone every time it starts, no need to set it up again.

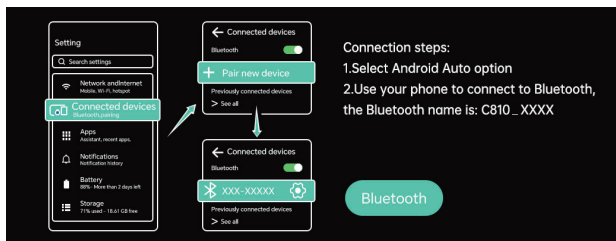

1. Click on the [  ] icon on the Homepage to enter the Android Auto option and confirm your selection.
2. Keep your Android phone' Wi-Fi on.
3. Turn on the Connection steps: of your Android phone and connect based on the device name(when searching for the first time, it will be displayed in "Other Devices").
4. The Android phone pops up the pairing information, click "Pair". In the pop-up pairing interface, you can allow your phone to access your contacts and call history according to your needs. Check "Allow" and contacts and favorites will be synchronized to the product. Not check, the incoming calls will be displayed as phone numbers instead of contact list names.

# ANDROID AUTO CONNECTION GUIDE

Pair with C810 XXXX

Bluetooth pairing code

821543

☐ Allow access to your contacts and call history

Cancel

Pair

5. After the BT connection is successful, the host will automatically switch to the Android Auto display interface.

6. The [  ] icon will appear on the Android Auto tab of the Homepage.



## NOTE

- Android Auto only supports Android phones.
- Wireless Android Auto screen projection requires smartphone version Android 11 and above, and the smartphone supports 5G Wi-Fi.
- Wired Android Auto screen projection requires smartphone version Android 6.0 and above.
- When the host is powered on, it will try to connect to the last connected Android phone device automatically. If you use a new Android phone to connect to the host, you need to turn off the Wi-Fi and BT of the relevant Android phone that was last connected to the host, or the new Android phone will not be connected successfully. If you need to disconnect Android Auto, please turn off both Wi-Fi and
- BT on your Android phone to disconnect. Turning off Wi-Fi only or BT only, the Android phone will keep trying to reconnect to the host.

# ANDROID AUTO CONNECTION GUIDE

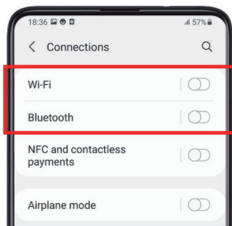

Disconnect it through the shortcut icon in the phone control center, You need to turn off BT and Wi-Fi icons together.

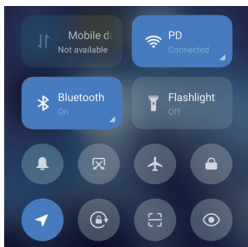

Connected

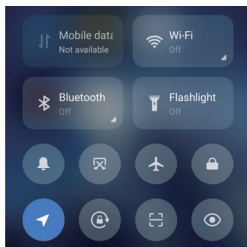

Disconnected

# CARPLAY CONNECTION GUIDE

C810 supports CarPlay, please follow the instructions on the host screen to connect your iPhone. After the first successful connection of CarPlay, the host will automatically connect to the iPhone every time it starts, no need to set up again.

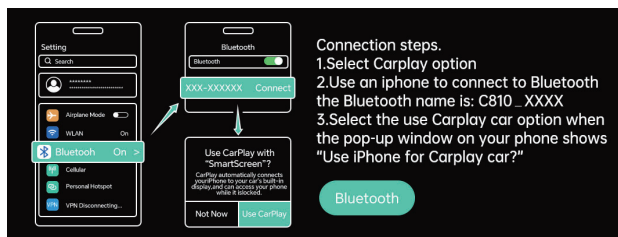

1. Click on the [📺] icon on the Homepage to enter the CarPlay option and confirm your selection.
2. Keep your iPhone' Wi-Fi on.
3. Turn on the BT of your iPhone and connect based on the device name (when searching for the first time, it will be displayed in "Other Devices").
4. The iPhone pops up the pairing information, click **"Pair"**.

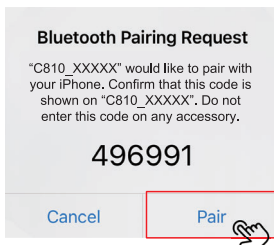

# CARPLAY CONNECTION GUIDE

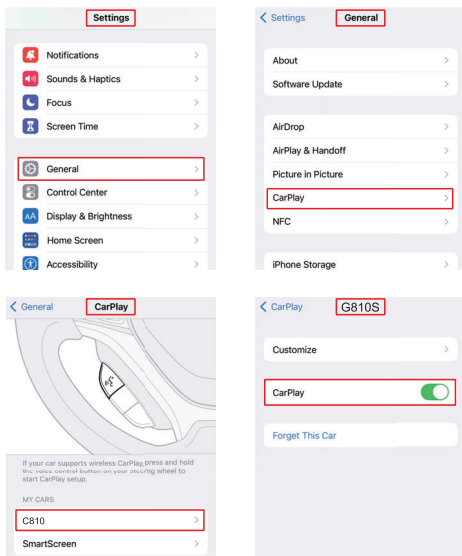

7. After the BT connection is successful, the host will automatically switch to the CarPlay display interface. The [📶] icon will appear on the CarPlay tab of the Homepage.

## ⚠ NOTE

CarPlay only supports iPhones (the iPhone requirement is iPhone5 and above, IOS system version requirement is IOS13 and above). When the host is powered on, it will try to connect to the last



# FM TRANSMIT GUIDE

C810 supports FM Transmit, please follow the instructions on the host screen to connect.

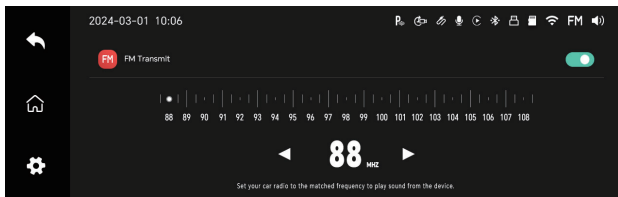



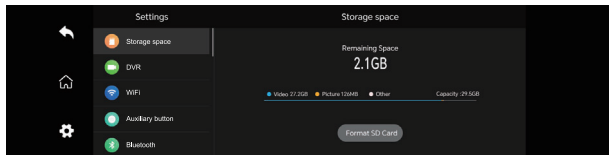

Connection steps:

1. Select FM Transmit option
2. Turn on the FM button
3. Set your car radio to the matched frequency to play sound from the device.





# SETTINGS INTRODUCTION

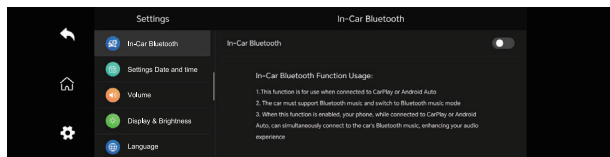

| Icon   | Instructions  |   |
|--|---|---|
|    | Check the storage occupancy of the card   |   |
|    | Image Size  | 1080/2.5K                                   |
|  | Recording duration  | Adjust the loop recording duration.         |
|  | Recording   | Turn On/Off audio recording                 |
|  | Gravity sensing   | Adjust the sensitivity of G- Sensor         |
|  | Pull back 180° to flip  | Vertically flip the view of the rear camera |
|    | Access Wi-Fi settings to connect to a network   |   |
|  | Click to enter the [Auxiliary button] setting, it's a hover window button in your phone's screen casting mode, you can choose to turn it off or on. |   |
|  | Access Bluetooth settings to pair and connect devices   |   |







# SETTINGS INTRODUCTION



| Icon   | Instructions  |  |
|--|---|--|
|    | Enables phone to connect to car's Bluetooth music when with CarPlay or Android Auto |  |
|    | GPS auto time   | Automatic time and date correction after GPS recognition           |
|  | Set date Time   | Set the date and time manually                                     |
|  | 24-hour system  | Turn On/Off the 24-hour time format                                |
|  | Time zone   | Set the current time zone  |
|  | Daylight Saving Time  | Turn on daylight saving time , and add 1 hour to the original time |
|   | System Music Video  | Set the system volume  |
|  | Calls   | Set the call volume  |
|  | Carplay/ Auto screen mode   | Turn on for split-screen display, turn off for full-screen display |
|  | Brightness settings   | Adjust screen brightness settings                                  |
|  | Night Mode  | You can set the required time after turning on this function       |
|  | Screen display  | Set the time to automatically turn off the screen                  |
|  | Set the common language, the default is English                                     |  |

# SETTINGS INTRODUCTION



| Icon   | Instructions  |   |
|--|---|---|
|    | Show the Longitude, Latitude, and other GPS information                                     |   |
|    | Turn On/Off the parking mode, including 24-hour parking monitoring and time-lapse recording |   |
|    | Choose left drive and right drive here  |   |
|   | Video Format  | Choose between PAL and NTSC formats         |
|  | Backup Assist Lines   | Turn On / Off the reversingguidelines       |
|  | Parking aid line adjustment   | Adjust the angle of the auxiliary line here |
|  | Restore the initial settings  |   |
|  | Check the product model and firmware version  |   |

# FAQ

## 1. For a Frozen or Unresponsive Device?

- ① Attempt a reboot to see if the device can be restarted.
- ② If a reboot doesn't work, perform a system reset.
- ③ If the issue persists, contact the manufacturer's customer support or after-sales service for assistance.

## 2. The rear camera has no image?

- ① Please use the rear camera provided by the manufacturer.
- ② Whether the AvIN interface is inserted to the bottom.
- ③ Check if the camera format matches.

## 3. FM does not receive the radio station?

Search channel, on the FM menu page, perform a channel scan search.

## 4. Apple CarPlay cannot connect?

- ① The first connection takes a long time, expect 1-3 minutes.
- ② Only iPhones can use CarPlay function.
- ③ The iPhone is required to be iPhone 5 and above, and IOS system version is required to be IOS13 and above.
- ④ Check whether the Wi-Fi and Bluetooth functions of the iPhone are normal and open.
- ⑤ Enter the Settings-General-CarPlay interface of the iPhone, delete all the records in this interface and reconnect.
- ⑥ Restart the iPhone and device and reconnect.

# FAQ

## 5. Android Auto cannot connect?

- ① The first connection takes a long time, expect 1-3 minutes.
- ② Only Android phones can use Android Auto function.
- ③ Update Auto and relevant Apps on your Android phone to the latest version.
- ④ Do not enable VPN on your Android phone.
- ⑤ Check whether the Wi-Fi and Bluetooth functions of the Android phone are normal and turned on.
- ⑥ Restart the Android phone and device and reconnect

## 6. Unable to start?

(Player supports 7V-32V car use, high voltage cannot be used)

- ① Check whether the DC head of the cigarette lighter power cord is damaged or aging
- ② Check whether the fuse of the power plug is disconnected or burned

## 7. The Bluetooth music cannot use?

Please set the player mode to Bluetooth music. Other modes do not support Bluetooth music.

## 8. How to contact SERVICE SUPPORT?

If the above FAQs fail to solve your problem, you can scan the following QR code to contact the service support team.

EMAIL



WhatsApp





## EXPERIENCING PROBLEMS?

- ▶ How to use?
- ▶ Can not turn on?
- ▶ Missing items?
- ▶ Damaged or defective?

**Please contact us before returning the item,  
WE WILL HELP YOU RESOLVE ANY ISSUES ASAP.**

## CUSTOMER SERVICE

7\*24Hours

E-mail



[jomise-US@jomise-cam.com](mailto:jomise-US@jomise-cam.com)

Your experience is our focus.

Any feedback or suggestions from you are very important to us.

We are very happy to listen to the voices from customers.

### After-sales Support E-mail

**North America**

[jomise-US@jomise-cam.com](mailto:jomise-US@jomise-cam.com)

### After-sales Support Phone

**North America**

+(1) 866-788-8775

(PST 8:00 am-5:00 pm, Mon-Fri)



**Call us directly with any issues**



**MADE IN CHINA**

**FCC Warning:**

This equipment has been tested and found to comply with the limits for a Class B digital device, pursuant to part 15 of the FCC Rules. These limits are designed to provide reasonable protection against harmful interference in a residential installation. This equipment generates, uses and can radiate radio frequency energy and, if not installed and used in accordance with the instructions, may cause harmful interference to radio communications. However, there is no guarantee that interference will not occur in a particular installation. If this equipment does cause harmful interference to radio or television reception, which can be determined by turning the equipment off and on, the user is encouraged to try to correct the interference by one or more of the following measures:

- Reorient or relocate the receiving antenna.
- Increase the separation between the equipment and receiver.
- Connect the equipment into an outlet on a circuit different from that to which the receiver is connected.
- Consult the dealer or an experienced radio/TV technician for help.

**Caution:** Any changes or modifications to this device not explicitly approved by manufacturer could void your authority to operate this equipment.

This device complies with part 15 of the FCC Rules. Operation is subject to the following two conditions:

(1) This device may not cause harmful interference, and (2) this device must accept any interference received, including interference that may cause undesired operation.

This equipment complies with FCC radiation exposure limits set forth for an uncontrolled environment. This equipment should be installed and operated with minimum distance 20cm between the radiator and your body.