

Vinyl Ambience Speaker

PLEASE READ THE MANUAL CAREFULLY BEFORE USE
AND KEEP IT FOR FUTURE REFERENCE

Appearance description

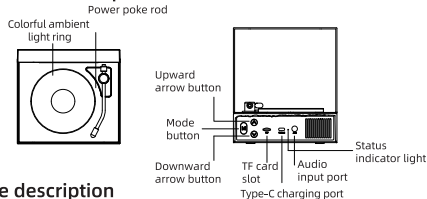

Feature description

Power on/Off:

Move this power poke rod to turn on/off.

Last/Next song:

Single-click the upward arrow button for the last song, single-click the downward arrow button for the next song.

Volume adjustment :

Long press the upward arrow button to increase volume, long press the downward arrow button to decrease volume.

Play and pause:

Long press the mode button to play/pause songs.

Mode switching:

Press the mode button to toggle the playback mode, supporting Bluetooth mode/ White noise mode/TF card mode/Audio line mode.

Colorful ambient light switching:

Double-click either the upward or downward arrow button to switch the colorful effects of the light ring.

Ambient light effect switching:

Double-click the mode button to switch the ambient light modes.

Bluetooth pairing:

Adjust the mode button to Bluetooth mode upon turning on the device, then open Bluetooth Search in the phone, make a single click on the Bluetooth pairing: Round-X08 to realize connection.

Safety Guidelines

Please read this product carefully before use and keep it for future reference.

·Keep away from heat, fire and sun exposure.

·Do not insert sharp objects and metal into this product to avoid short circuit.

·This product could not be repaired by itself, but should be repaired by professionals or returned to the factory.

·If this product is overheated or damaged and falls into the liquid, please stop using it.

·If customers want to use the power adapter to charge with the product, it should purchase a power adapter that has obtained CCC certification and meets this standard requirements.

Product Parameters

Product name: Vinyl Ambience Speaker

Product Model: XKM-011

Bluetooth Range: 10 meters

Product Size: 175*145*72mm

Rated Input: 5V=1A

Loudspeaker: 40mm 4Ω-5W

Executive Standard: GB 4943.1-2022

Bluetooth Version: 5.3

Product Weight: about 630 g

Audio Input Options: Bluetooth, AUX, TF Card

Rated Power: 5 W

Battery : 18650 lithium battery, 3.7V, 1800 mAh

Manufacturer: Starry Sky Dream Design (Shenzhen) Co., LTD

Internal Battery Care

·Before using, Please charge this product , and it could be used when fully charged.

·Do not charge for too long. Generally, please charge it about 2-3 hours. Do not charge too full, which will affect this cycle times of this battery.

·If this product is not used for a long time, this full load power may be lost generally.

·When charging, please use this standard 5V DC adapter. Using other types of adapters might damage or destroy this product.

·This indicator light is red when this audio is charged and blue when is full.

·Charge and use this product according to this instruction.

Packaging Accessories

Bluetooth Speaker* 1

Type-C charge line * 1

Instruction * 1

Certificate * 1

Audio Line * 1

The circumstances listed below are not eligible for free maintenance.

Our products are guaranteed within one year.

The failure or damage of equipment which falls within the following circumstances is not covered by the limited warranty. The Company shall not assume the duty of free warranty:

1. Equipment components have exceeded the warranty period;
2. Equipment failure or damage caused by incorrect storage and use by the customer not in accordance with the instructions;
3. Equipment failure or damage caused by disassembly of non-authorized organizations and personnel of the company;
4. Equipment failure or damage caused by intentional or artificial factors (including operation errors, scratches, bumping, improper voltage or current input and the like); failure or damage of products due to force majeure such as natural disasters.

XKM-011 Starry Sky Dream Design (Shenzhen) Co., LTD				
Product Model				Date of production
User Name		Tel		Fuselage No.
User Address		City (County), Province		Zip code
Commodity purchased		Date of purchase		Year Month Day
Detailed troubleshooting				
	Note: Please make sure the failure phenomenon, the time and the environment of that and the working state of the machine when the fault occurs			
Maintenance record	Date	Failure phenomenon	Processing method	Signature of maintainers

This device complies with part 15 of the FCC Rules. Operation is subject to the following two conditions: (1) This device may not cause harmful interference, and (2) this device must accept any interference received, including interference that may cause undesired operation.

Any Changes or modifications not expressly approved by the party responsible for compliance could void the user's authority to operate the equipment.

Note: This equipment has been tested and found to comply with the limits for a Class B digital device, pursuant to part 15 of the FCC Rules. These limits are designed to provide reasonable protection against harmful interference in a residential installation. This equipment generates uses and can radiate radio frequency energy and, if not installed and used in accordance with the instructions, may cause harmful interference to radio communications. However, there is no guarantee that interference will not occur in a particular installation. If this equipment does cause harmful interference to radio or television reception, which can be determined by turning the equipment off and on, the user is encouraged to try to correct the interference by one or more of the following measures:

- Reorient or relocate the receiving antenna.
- Increase the separation between the equipment and receiver.
- Connect the equipment into an outlet on a circuit different from that to which the receiver is connected.
- Consult the dealer or an experienced radio/TV technician for help.

FCC Radiation Exposure statement

The device has been evaluatec to meel general RF exposure requirement. The device can be used in portable exposure condition without restriction.