

S3PRO Low-power Smart Camera

User Manual

Thank you for purchasing the smart camera. The device adopts a unique ultra portable design, so that it can be applied in various fields and bring you convenient, safe and colorful daily life. Please set up your camera correctly according to the steps in the instructions.

DIRECTORY

I. Appearance Introduction

II. App Download

III. Registered User

IV. AP Mode Connection Settings

V. WiFi Remote Monitoring Settings

VI. AP Mode And P2P Mode Device List Distinction

VII. FAQ

I. Appearance Introduction



RESET: Turn the switch button to "On", press and hold the RESET button for about 5s until the red and blue lights are all on, then the blue light flashes slowly, and hear a beep, reset is successful.

II. App Download

Scanning the QR Code to download "Botslab" APP;



Android phone can search "Botslab" on Google Play or other application markets to download APP;
iPhone/iPad can downloaded "Botslab" on App Store.

III. Registered User

Open the APP and click "Sign up", enter your phone number or email to register, receive the verification code, and set the password to complete the registration.
Note: When logging in to your account, the location should be selected your current area. E.G:

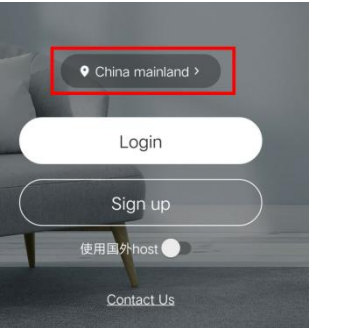

IV. AP Mode Connection Settings

Preparation: Switch OFF/ON to turn on camera;

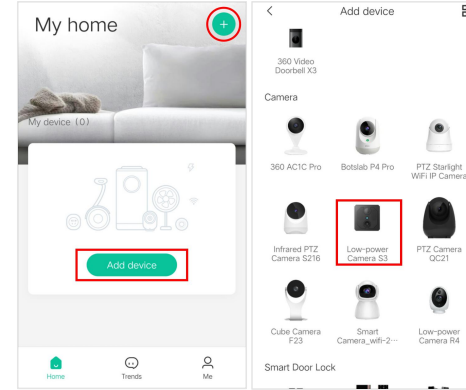

(1) Add device

(2) Choose low-power Camera S3PRO

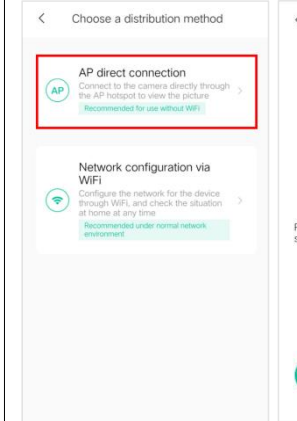

(3) Click AP direct connection



(4) Click Next step after the camera is reset



(5) Connect device hotspot

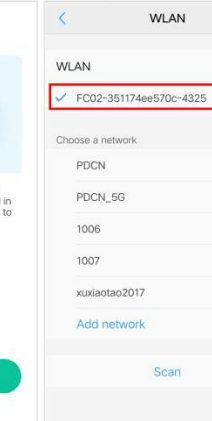

(6) Connect to the hotspots "FC02-*****"

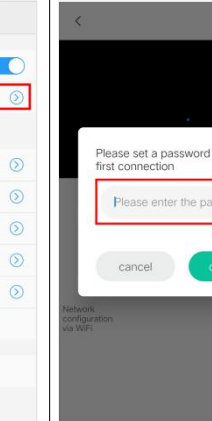

(7) Set password

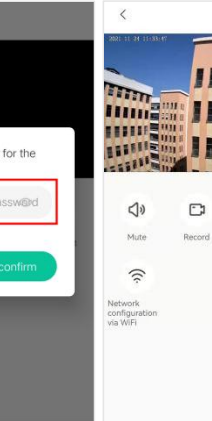

(8) AP mode device is added successfully

V. WiFi Remote Monitoring Settings

Note: The phone needs to connect a 2.4G WiFi.

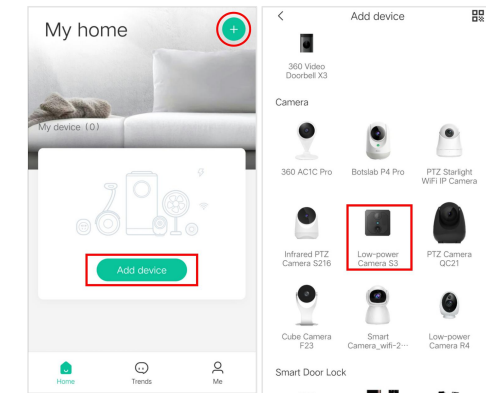

(1) Add device

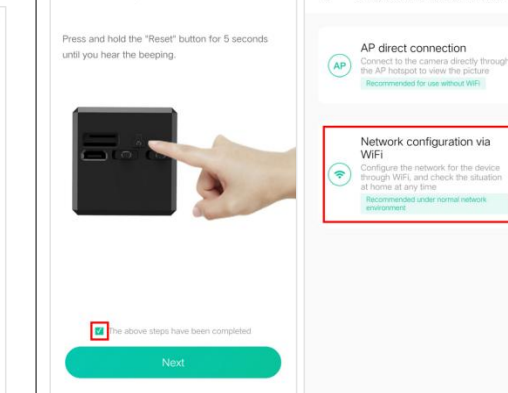

(2) Choose low-power Camera S3PRO

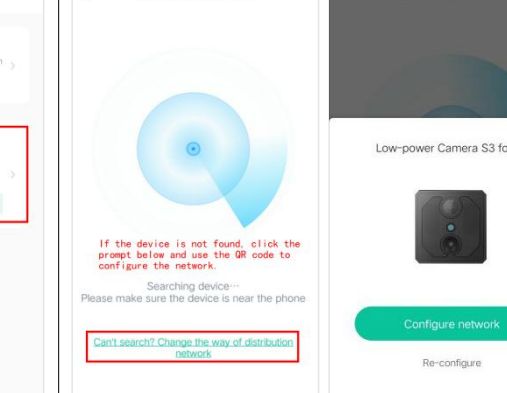

(3) Check and click Next step after camera is reset

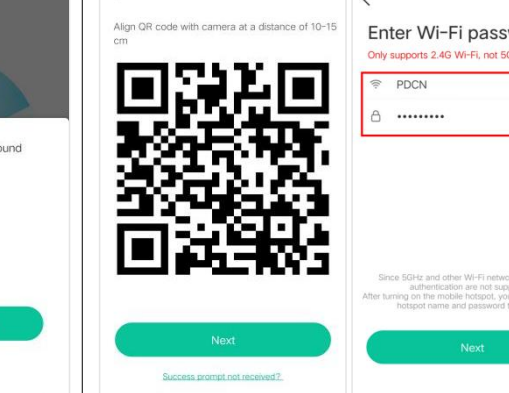

(4) Choose Network configuration via WiFi

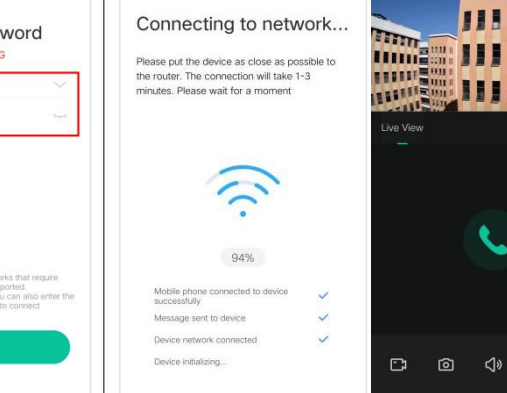

(5) Searching device Method 2: QR Code Configure Network

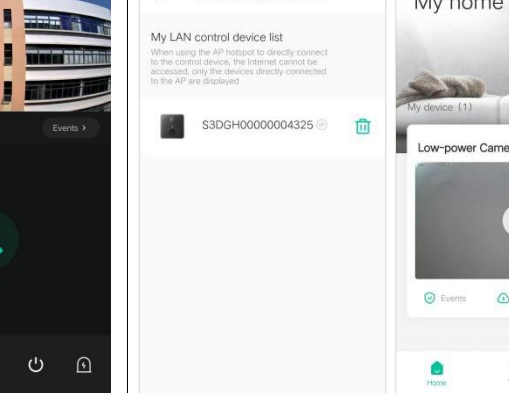

(6-1) When the device is found, click Configure network to connect

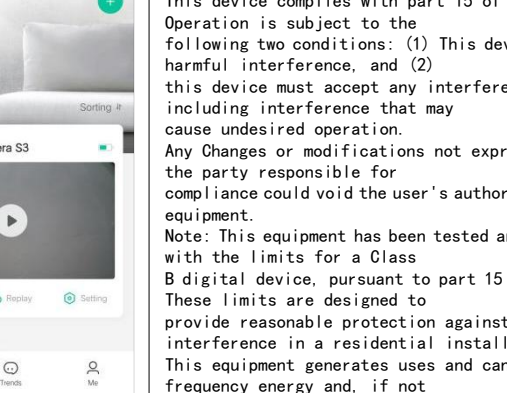

(6-2) Method 2: Aim the QR code at the camera, 10-15cm is better distance

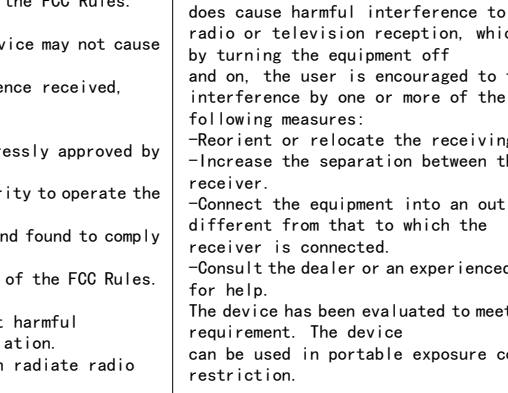

(7) Enter WiFi password The device only supports 2.4G network

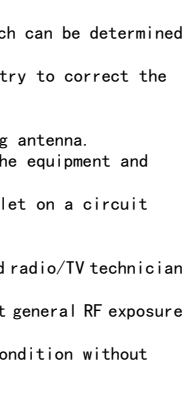

(8) Connecting to network —Successfully added

(9) Remote real-time monitoring

VI. AP Mode And P2P Mode Device List Distinction

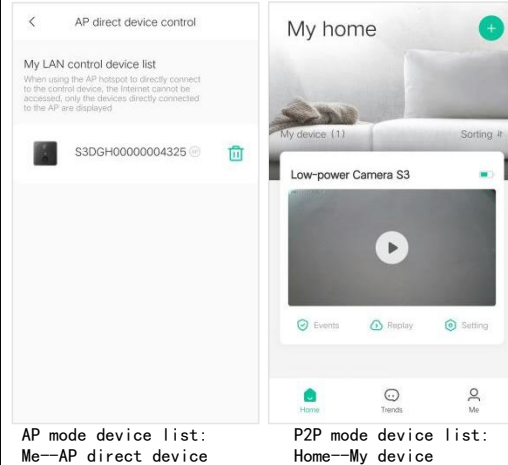

AP mode device list: Me—AP direct device control

VII. FQA

FCC Caution:
This device complies with part 15 of the FCC Rules. Operation is subject to the following two conditions: (1) This device may not cause harmful interference, and (2) this device must accept any interference received, including interference that may cause undesired operation. Any Changes or modifications not expressly approved by the party responsible for compliance could void the user's authority to operate the equipment.
Note: This equipment has been tested and found to comply with the limits for a Class B digital device, pursuant to part 15 of the FCC Rules. These limits are designed to provide reasonable protection against harmful interference in a residential installation. This equipment generates uses and can radiate radio frequency energy and, if not installed and used in accordance with the instructions, may cause harmful interference

to radio communications. However, there is no guarantee that interference will not occur in a particular installation. If this equipment does cause harmful interference to radio or television reception, which can be determined by turning the equipment off and on, the user is encouraged to try to correct the interference by one or more of the following measures:
—Reorient or relocate the receiving antenna.
—Increase the separation between the equipment and receiver.
—Connect the equipment into an outlet on a circuit different from that to which the receiver is connected.
—Consult the dealer or an experienced radio/TV technician for help.
The device has been evaluated to meet general RF exposure requirement. The device can be used in portable exposure condition without restriction.