

1:43 FULL PROPORTION FOUR-WHEEL
DRIVE DRIFT MODEL HIGH-SPEED CAR
Instruction manual

Product configuration:

- 1 x Model car
- 1 x Remote control
- 1 x Instruction manual
- 1 x Type-c Charging cable
- 8 x Scene barricade pile bucket
- 4 x Racing soft rubber tire
- 4 x Drift hard rubber tire
- (*one set is pre-installed before delivery)

Need to buy:

- 4 x AAA 1.5V Dry battery

Remote control battery assembly:

- Loosen the fixing screws.
- Open the battery compartment and install four 1.5V AAA batteries with the correct polarity (+/-).
- Close the battery cover and tighten the screws.

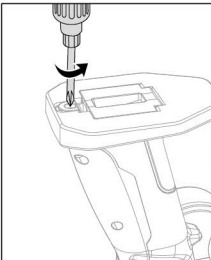

Step1

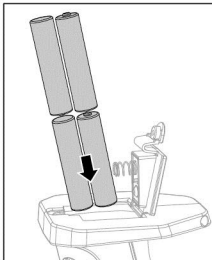

Step2

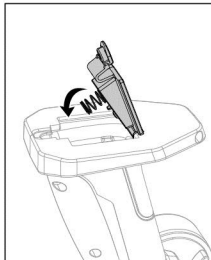

Step3

Battery precautions:

- It is recommended to use 1.5V AAA alkaline battery in the remote control.
- Do not mix alkaline batteries or rechargeable batteries.
- The charging time of the mobile phone charger for the vehicle is about 30 minutes, and it will be automatically powered off after it is full, but it can not be connected for a long time, and it should be pulled out in time after it is fully charged.
- Children should charge under adult supervision.
- Ensure that the battery is inserted with the correct polarity.
- Do not short circuit the power terminal.
- Battery replacement can only be done by adults.

Care and maintenance:

- Avoid long-term exposure or heat in the sun.
- Check whether all screws are loose.
- When not in use for a long time, please take out the battery in the remote control and place it separately.

Remote control car function and remote control button description:

- The switch position of the vehicle and remote control is toggle to the ON position, and the frequency is automatically adjusted. When preparing to open the switch frequency of the remote control, ensure that the throttle trigger and steering handwheel are not involved in the middle position.
- The vehicle speed has 3 gears, adjust the gear through the remote control button, the remote control indicator is red for high-speed gear 100%, yellow for medium speed gear 50%, green for low speed gear 20%, adjust the speed according to different tracks.
- If the vehicle is not running in a straight line, you can fine-tune the left and right through the TRIM button on the side of the remote control.
- The 7 button on the remote control panel can achieve the control effect of the lamp switch, and the a 1 button can control the remote control car to open or close the double flashing light mode.
- Remote control car tires have two configurations: racing tires and drifting tires.

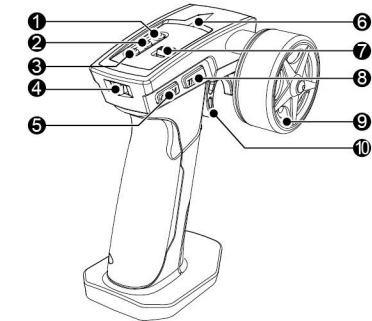

- Switch the dual-blinking mode
- Speed gear plus
- Speed gear reduction
- Power switch
- TRIM Left-trim
- Speed indicator
- Light switch
- TRIM Right-trim
- Direction wheel
- Throttle

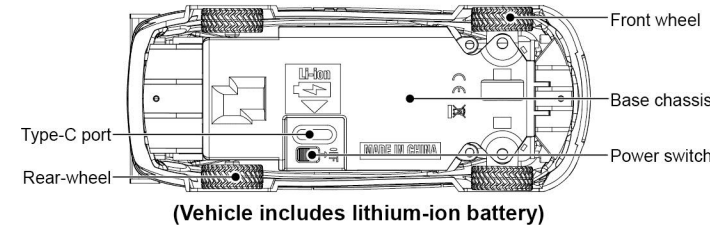

(Vehicle includes lithium-ion battery)

Warm reminder:

If you need more grip to achieve high-speed corners, you need to change to racing soft tire.
If you need to continuously drift around the pile practice, you need to change the drift hard tire.

Operation method:

- The maximum remote control distance is about 20 meters, beyond this range will affect the sensitivity of the operation.
- Under full charge state, the vehicle can be used for about 30 minutes.

How to drive a remote control car:

- Pull the throttle trigger back, the remote control car forward, the throttle trigger angle can control the speed of the remote control car forward, to achieve full ratio control.
- Push the throttle trigger forward for the first time, the remote control car activate the brake function, and then push forward after returning to the center, the remote control car reverses, the angle of the throttle trigger can control the remote control car reverse speed.
- The steering wheel can control the steering of the remote control car by turning left and right, and the steering wheel Angle can control the steering angle of the remote control car to achieve full ratio control.

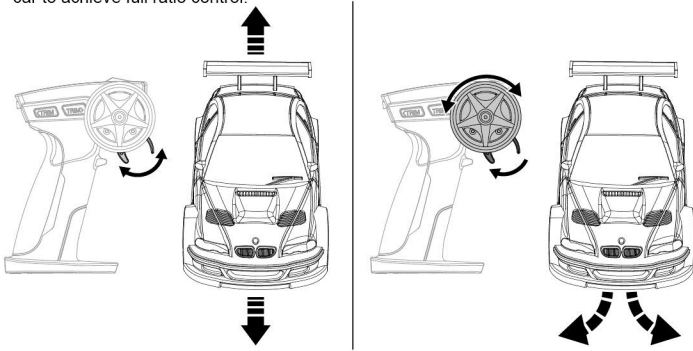

Vehicle charging precautions:

Use the conventional mobile phone charging head to charge the vehicle through the matching Type-C charging line. The charging time is 30 minutes, and the vehicle charging indicator is off, indicating that the vehicle battery is charged.

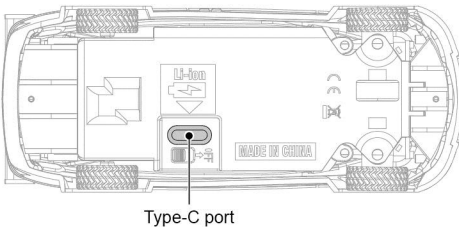

Attention:

Mobile phone charging head power can not be greater than 25 watts, such as using high power mobile phone charging head to charge the vehicle, it is very likely to damage the vehicle circuit board and battery.

Attention:

- Charging must be operated by adults, do not let children charge themselves.
- This product is only suitable for use by players over 14 years old. Use under 14 years old may cause security risks or abnormal damage to the product.
- The product has no waterproof function, and the parts should be kept dry.
- Keep all chemicals, small parts and other electronic accessories out of reach of children.
- The battery in the car is 3.7V lithium battery, please do not puncture the battery and remove it violently to avoid the risk of fire.
- Do not use high-power mobile phone charger to charge the vehicle, otherwise there will be fire and other safety hazards.
- Check whether the wires, plugs, shells and other parts are damaged before charging, and stop using them until they are repaired.
- Pay attention to the polarity of the battery when installing the remote control.
- The remote control car battery is 200mAh 3.7V high-performance lithium battery, and the remote control uses 4 No.7 batteries.

Driving skills:

- Piles can be arranged indoors for fixed-point drift practice or 8-figure cyclic drift practice.
- The racing track can be arranged to realize the racing competition.

Common problems and failures	Fault cause and troubleshooting method
The battery power indicator is off when the remote control is installed	1. Take out battery No. 7 and check whether the positive and negative terminals are correctly connected 2. Check whether the battery is charged 3. If the battery cover is not properly installed, check whether the battery cover is properly installed and tighten the screws on the battery cover
The vehicle cannot drive in a straight line	1. Use the remote control to turn the fine-tuning button to fine-tune until the vehicle can normally go straight 2. Check whether the four wheels are stuck and clean up the foreign bodies in time
After the vehicle is connected to the remote control, the remote control does not operate, and the wheels are still running	Turn off the remote control and make sure the throttle trigger and steering wheel turn on the remote control in the middle position
Vehicle steering failure or vehicle power failure, the light is not bright	The vehicle is out of power, charge the vehicle in time
The vehicle has no reverse function	1. Turn off the remote control and reset the frequency 2. The first forward push of the throttle trigger is the brake function, and the second forward push of the throttle trigger after the throttle returns to the middle position is the reverse function
When the vehicle is driving, the resistance is very strong or it cannot drive at all	1. Check whether the four outer tires are displaced and stuck under the car 2. Check whether the four wheels are stuck and clean up the foreign bodies in time
There is no response to the vehicle remote control or there is a delay in steering the throttle	1. The remote control battery is out of power, replace the remote control battery in time 2. The vehicle is beyond the remote control range, ensure that the vehicle is controlled within 20 meters 3. There may be strong signal interference sources nearby, it is recommended to change the location to control the remote control car

FCC Compliance Statements

This device complies with Part 15 of the FCC Rules. Operation is subject to the following two conditions: (1) this device may not cause harmful interference, and (2) this device must accept any interference received, including interference that may cause undesired operation.

Note: This equipment has been tested and found to comply with the limits for a Class B digital device, pursuant to Part 15 of the FCC Rules. These limits are designed to provide reasonable protection against harmful interference in a residential installation. This equipment generates, uses and can radiate radio frequency energy and, if not installed and used in accordance with the instructions, may cause harmful interference to radio communications. However, there is no guarantee that interference will not occur in a particular installation. If this equipment does cause harmful interference to radio or television reception, which can be determined by turning the equipment off and on, the user is encouraged to try to correct the interference by one or more of the following measures:

- Reorient or relocate the receiving antenna.
- Increase the separation between the equipment and receiver.
- Connect the equipment into an outlet on a circuit different from that to which the receiver is connected.
- Consult the dealer or an experienced radio/TV technician for help.

Caution: Changes or modifications not expressly approved by the party responsible for compliance could void the user's authority to operate the equipment.

This equipment complies with FCC radiation exposure limits set forth for an uncontrolled environment. This transmitter must not be co-located or operating in conjunction with any other antenna or transmitter.