

**KEMI  
MOTO**

# **PRODUCT MANUAL**

## **U-SHAPED SPEAKER**

**B** HVIN: B0117-03017-BK6.5

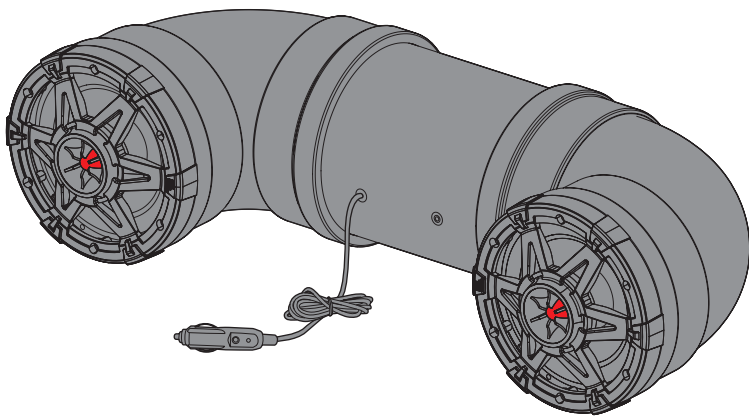

**Complete journey of dreams**

## TABLE OF CONTENTS

<b>PRODUCT INFORMATION</b>	-----Page1
<b>BEFORE YOU START</b>	-----Page2
<b>GETTING TO KNOW YOUR SPEAKER</b>	-----Page3
<b>BLUETOOTH OPERATION</b>	-----Page4
<b>BLUETOOTH OPERATION</b>	-----Page5
<b>STREAMING MUSIC</b>	-----Page6
<b>AUX INPUT</b>	-----Page7
<b>INSTALLATION</b>	-----Page8
<b>GETTING STARTED</b>	-----Page9
<b>TROUBLESHOOTING</b>	-----Page10
<b>DIMENSIONS</b>	-----Page11
<b>WIRE DIAGRAM</b>	-----Page11
<b>SPECIFICATIONS</b>	-----Page12
<b>INFORMATION TO THE USER</b>	-----Page13

### CUSTOMER SUPPORT:



Contact us by email: [service@kemimoto.com](mailto:service@kemimoto.com)

Help center:



## PRODUCT INFORMATION

### THIS PACKAGE CONTAINS:

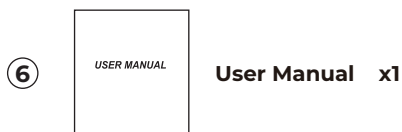
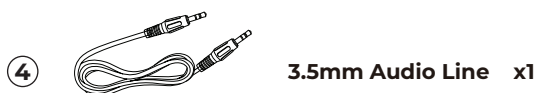
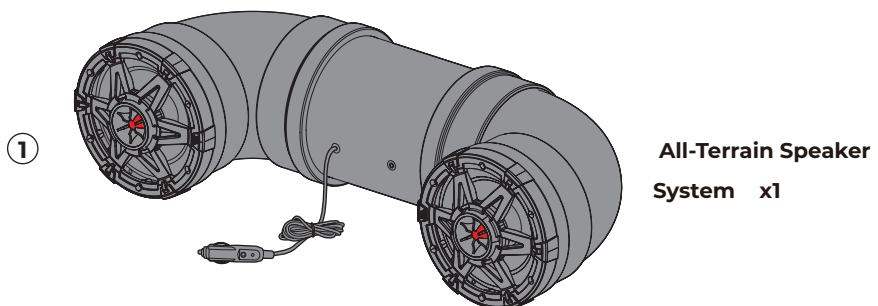

## BEFORE YOU START

### IMPORTANT INFORMATION:

- 1. Fitment Test Required:** Before removing the protective film (if any), please test the item to ensure it fits your setup properly.
- 2. Maintain Packaging:** Do not discard the packaging until the product has been successfully installed.

### BEFORE YOU BEGIN:

1. Please read the instructions carefully and verify that each item is in the list.
2. Please retain these installation instructions for further reference and parts ordering information.
3. If the vehicle is clean and free of other debris, it will be easy to install.
4. For your safety and to ensure a satisfactory installation, please complete all the installation steps in the order shown below.

### IMPORTANT SAFETY PRECAUTIONS:

- Do not operate mobile equipment while driving a motorized vehicle - safe driving and safety consideration of others should always be your highest priority.
- In the event you should notice smoke, strange noises or odor from this product, or any other abnormal signs, immediately turn off the power and consult your dealer or the nearest authorized **SOUND STORM LABS** Service Center. Using this product in this condition may result in permanent damage to the system.
- Set your volume control at a low setting, then slowly increase the sound until you can hear it comfortably without distortion, or ear discomfort.
- **BE SURE TO OBSERVE THE FOLLOWING GUIDELINES:**
  - Do not turn up the volume so high that you can't hear what's around you.
  - Use caution or temporarily discontinue use in potentially hazardous situations.

### INSTALLATION PRECAUTIONS:

#### ***WARNING - Always consult a professional installer***

- Professional installation recommended. Do not attempt to service this product by yourself.
- Servicing of this product by persons without professional training and experience in electronic equipment and motorized vehicle accessories may be dangerous and could expose you to the risk of electric shock, injury or other hazards.
- Contact SSL for any installation, service questions or requests.
- The speaker can be powered from a vehicle's cigarette lighter / auxiliary power port, or hard wired directly to the battery through an optional relay / accessory switch
- When wiring directly to the vehicle's battery, be sure to disconnect the battery's negative terminal wire before starting any wiring procedures, it is suggested that an optional fuse and fuse holder (not included) with minimum rating of 15 Amps be in line with the positive battery terminal
- The ground cable length should not exceed 18-inches (See wiring diagram)
- The speaker has a weather resistant design, it should not be submerged in or under water under any circumstances
- Use only the installation parts provided with the speaker
- Wash with a mild soap or detergent and lukewarm water using a clean sponge or a soft cloth. Rinse well with clean water.

#### ***"Don'ts" - Very Important***

- DON'T clean in hot sun or on very hot days.
- DON'T use abrasive or highly alkaline cleaners on the main body
- DON'T scrape the main body with razor blades, or other sharp instruments
- DON'T ever use, gasoline, acetone or carbon tetrachloride



### CAUTION!!

Using other mounting methods may void this warranty

## GETTING TO KNOW YOUR SPEAKER

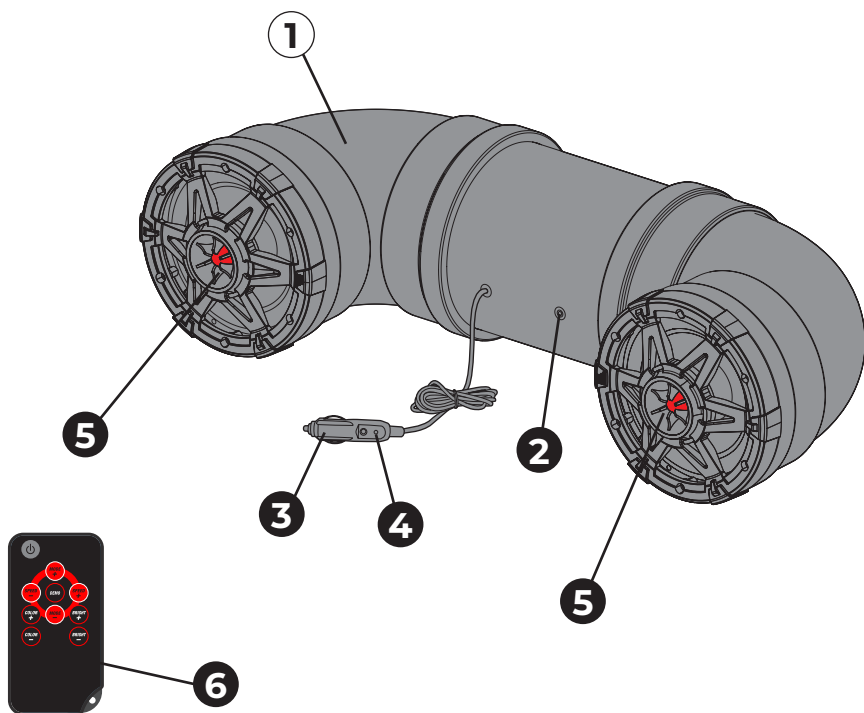

**1** BOOMTUBE

**2** 3.5mm AUX-INPUT

**3** CIGARETTE POWER CABLE ADAPTOR

**4** LED POWER INDICATOR

**5** RGB LED LIGHTS

**6** RGB REMOTE

## BLUETOOTH OPERATION

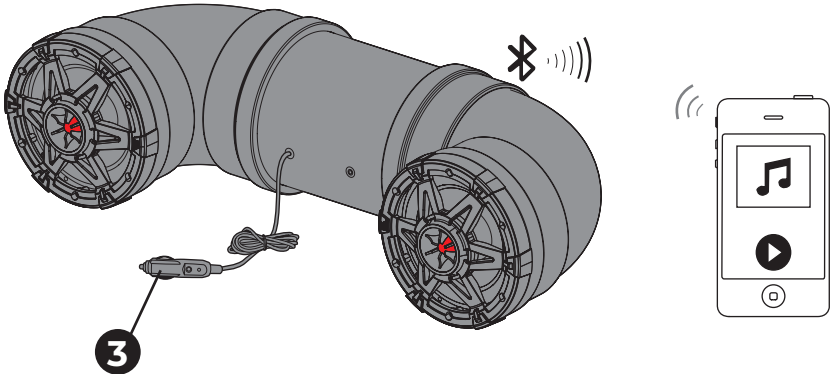

### PAIRING & DISCOVERING A NEW BLUETOOTH CONNECTION

- 1) Power on the speaker by plugging in the male cigarette lighter adaptor into **3** a female cigarette lighter receptacle.
- 2) The speaker will automatically go in to pairing mode:

#### ANDROID users:

- a. Go into the **Settings Menu** of your device
- b. Enter the **Bluetooth Menu**
- c. **TURN ON Bluetooth** and press **SCAN**
- d. "**KM-U6 OR KM-U8**" will now be displayed under **AVAILABLE DEVICES**
- e. If prompted, enter passcode: "**0000**"

#### iOS users:

- a. Go into the **Settings Menu** of your **iOS** device
- b. Enter the **Bluetooth Menu**
- c. **TURN ON Bluetooth**
- d. "**KM-U6 OR KM-U8**" will now be displayed
- e. If prompted, enter passcode: "**0000**"

**NOTE:** You have 2 minutes before you must restart this procedure over again.

- 3) If **KM-U6 OR KM-U8** is not seen, repeat the above steps to refresh the "**Device List**"
- 4) When the connection is successful, you are now ready to stream music from your favorite media player to the speaker

## BLUETOOTH OPERATION

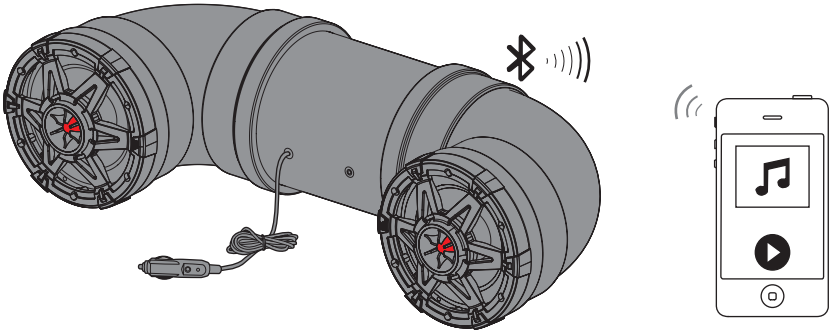

### RECONNECTION

- 1) Power on the speaker and your last paired **Bluetooth device**.
- 2) The unit will now automatically reconnect
- 3) If your device was previously paired with the speaker , but it wasn't the last paired **device**:
  - a. Ensure no other **devices** are currently paired
  - b. Enter the **Bluetooth Menu** on your device being paired
  - c. "**KM-U6 OR U8**" will display under **AVAILABLE DEVICES**
  - d. Choose the "**KM-U6 OR U8**" to reconnect
- 4) If the device is out of range from the speaker, it will disconnect automatically:
  - a. The speaker will automatically reconnect to the device once back in range



#### Tips:

To avoid battery exhaustion, be sure to occasionally run the vehicles engine while using this product. Using this product without running the engine can drain the battery.

## STREAMING MUSIC

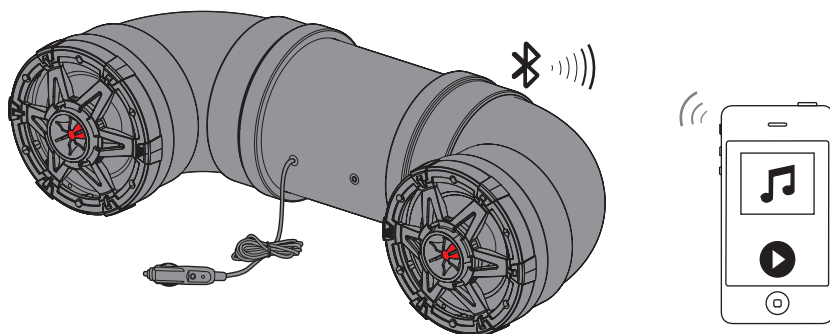

### BLUETOOTH OPERATION

1) Press the **PLAY/PAUSE** from your devices touch screen

### VOLUME CONTROL

2) To **raise or lower** the **volume** use your device volume controls



#### Tips:

For maximum performance, ensure your device Bluetooth volume is set to a minimum 75% level before stowing



## AUX INPUT

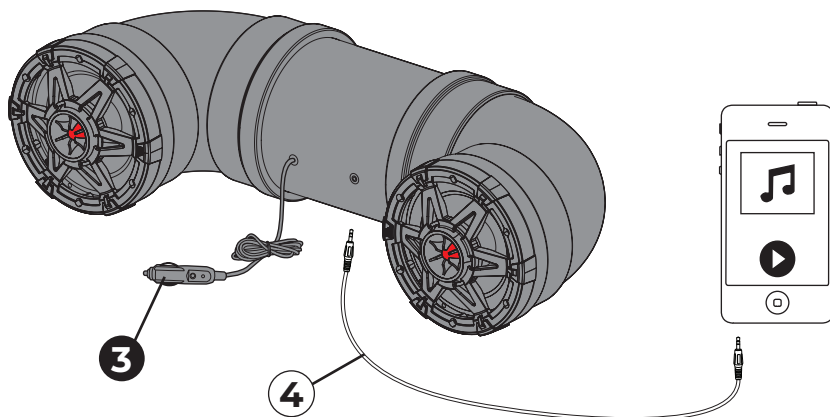

The speaker can play audio from any device that has a 3.5mm headphone audio jack.

## AUX-IN OPERATION

- 1) Power on the speaker by plugging in the male cigarette lighter adaptor into **3** a female cigarette lighter receptacle.
- 2) Connect the integrated 3.5mm **AUX-IN** cable **4** one end of to speaker jack and one end to your devices headphone jack
- 3) Route the wire back to the speaker, and secure your device

## VOLUME CONTROL

- 4) To **raise or lower** the **volume** use your device volume controls



### Tips:

For maximum performance, ensure your device Bluetooth volume is set to a minimum 75% level before stowing

## INSTALLATION

- 1) Use the supplied adjustable straps to secure to rails or roll bars
- 2) Always recheck straps before every ride

Step 1

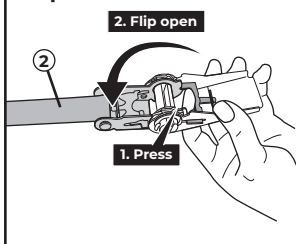

Step 2

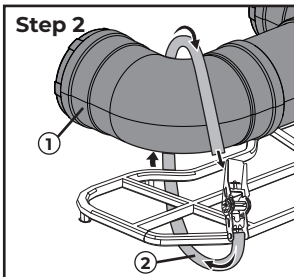

Step 3

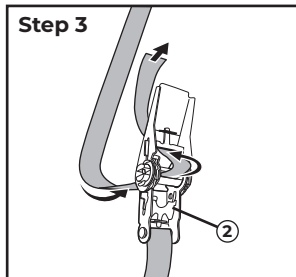

Step 4

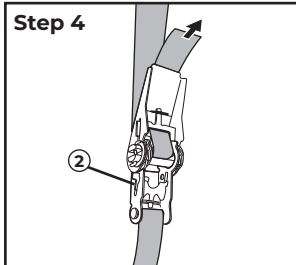

Step 5

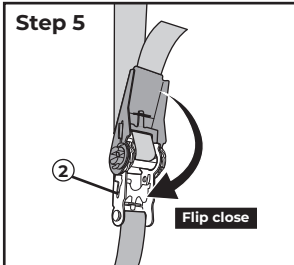

Step 6

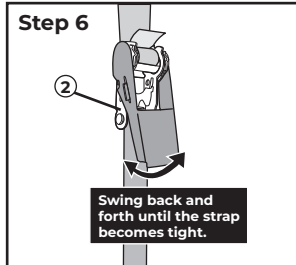

FOR ILLUSTRATION PURPOSES YOUR VEHICLE MAY VARY

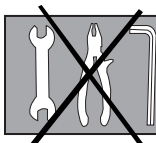
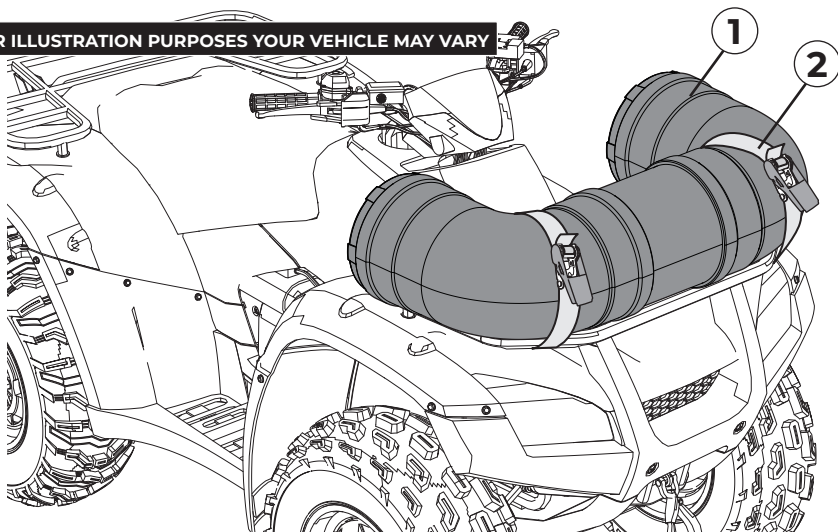

**NO SPECIAL TOOLS REQUIRED**

## GETTING STARTED

### GETTING TO KNOW YOUR RGB REMOTE

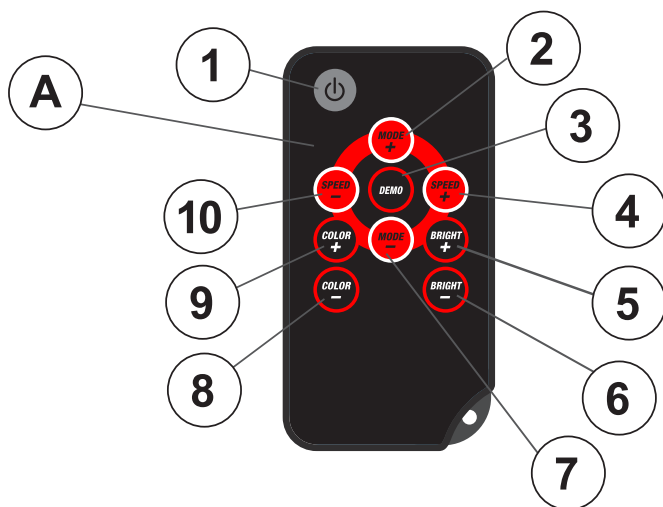

- A** RGB REMOTE
- 1** POWER ON / OFF
- 2** MODE UP
- 3** AUTO DEMO
- 4** SPEED UP
- 5** BRIGHTNESS UP
- 6** BRIGHTNESS DOWN
- 7** MODE DOWN
- 8** COLOR DOWN
- 9** COLOR UP
- 10** SPEED DOWN

1) RF controller range: Up to 25ft (LoS)

2) Do not obstruct the RF remote with metal

3) Always keep away from small children

4) Do not store in direct sunlight

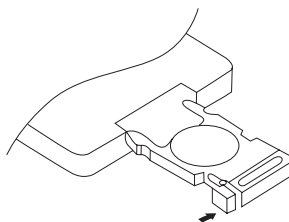

**REPLACEMENT BATTERY-CR2025**

## TROUBLESHOOTING

TROUBLE	CAUSE	SOLUTION
Unit will not turn on	The fuse is blown	Check / replace the fuse
	Main acc switch not engaged	Turn switch to on position
No sound is heard	Device volume is low / muted	Turn the volume level up
	Device is paused or muted	Check your devices playing / volume status
Cannot pair Bluetooth	The Bluetooth function of the device is not enabled	Refer to the user manual of the device for how to enable the Bluetooth function
The audio quality is poor after connection with a Bluetooth enabled device	The Bluetooth reception is poor	Move the device closer to the audio system or remove any obstacle between the device
Unit has become unresponsive	Power glitch or interference	Disconnect power for 10 seconds to reset

### CUSTOMER SUPPORT:



Contact us by email: [service@kemimoto.com](mailto:service@kemimoto.com)

Help center:



## DIMENSIONS

### KM-U6:

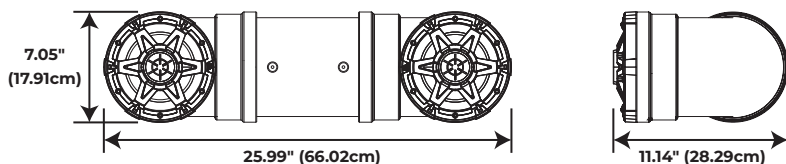

### KM-U8:

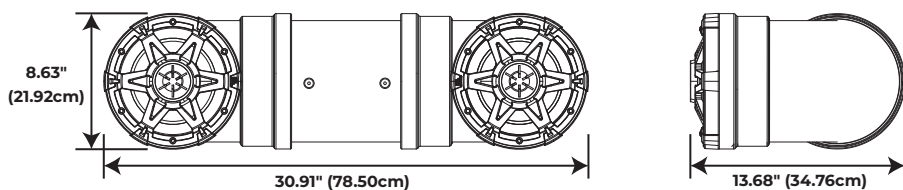

## WIRE DIAGRAM

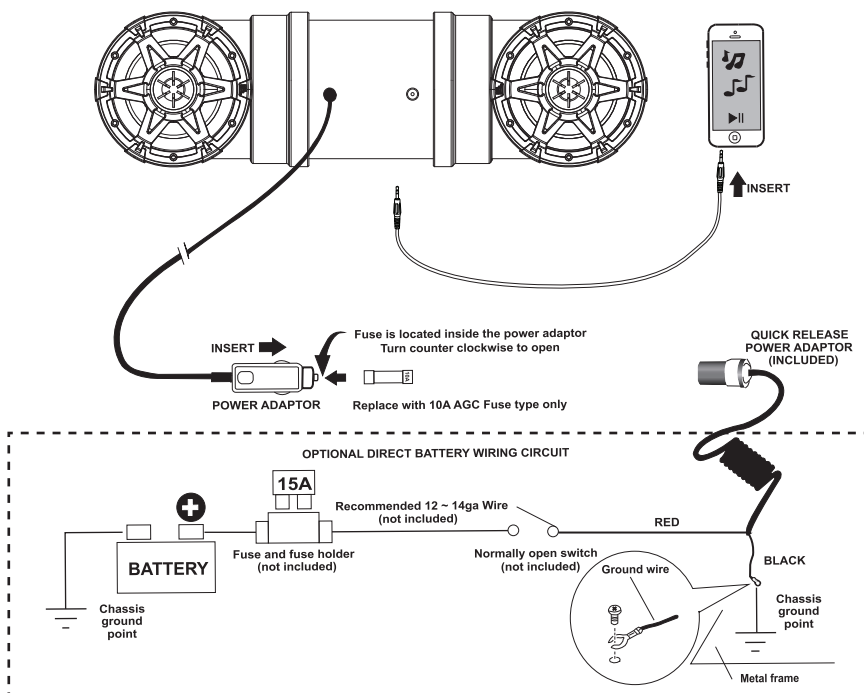

## SPECIFICATIONS

### KM-U6:

#### **BLUETOOTH**

- Version: 5.3 / EDR
- A2DP
- Range: 33ft(10m)

#### **SPEAKERS**

- Dimensions: 6.5" / 165.1mm
- Cone Type: PP CARBON + RUBBER SURROUND
- Tweeter Size: 1" Aluminum Diaphragm

#### **AMPLIFIER**

- Class A/B
- Maximum Output Power: 450 Watts
- Input impedance: 10k
- Frequency Response: 45Hz-22kHz

#### **GENERAL**

- Operational Power: 12VDC (10-16V allowable)
- MAX Current Draw: 10A
- Replacement Fuse: 10A AGC TYPE
- Color: Black
- Weight: 10lbs / 4.54Kg
- Dimensions cm WxHxD: 66.02 x 17.91 x 28.29
- Dimensions Inches WxHxD: 25.99 x 7.05 x 11.14

### KM-U8:

#### **BLUETOOTH**

- Version: 5.3 / EDR
- A2DP
- Range: 33ft(10m)

#### **SPEAKERS**

- Dimensions: 8" / 203.3mm
- Cone Type: PP CARBON + RUBBER SURROUND
- Tweeter Size: 1" Aluminum Diaphragm

#### **AMPLIFIER**

- Class A/B
- Maximum Output Power: 700 Watts
- Input impedance: 10k
- Frequency Response: 45Hz-22kHz

#### **GENERAL**

- Operational Power: 12VDC (10-16V allowable)
- MAX Current Draw: 10A
- Replacement Fuse: 10A AGC TYPE
- Color: Black
- Weight: 12.7lbs / 5.75Kg
- Dimensions cm WxHxD: 78.50 x 21.92 x 34.76
- Dimensions Inches WxHxD: 30.91 x 8.63 x 13.68

**SPECIFICATIONS SUBJECT TO CHANGE WITHOUT NOTICE**

## INFORMATION TO THE USER

### FCC STATEMENT:

This device complies with Part 15 of the FCC Rules. Operation is subject to the following two conditions:

- (1) This device may not cause harmful interference, and
- (2) This device must accept any interference received, including interference that may cause undesired operation.

**Warning:** Changes or modifications not expressly approved by the party responsible for compliance could void the user's authority to operate the equipment.

NOTE: This equipment has been tested and found to comply with the limits for a Class B digital device, pursuant to Part 15 of the FCC Rules. These limits are designed to provide reasonable protection against harmful interference in a residential installation.

This equipment generates uses and can radiate radio frequency energy and, if not installed and used in accordance with the instructions, may cause harmful interference to radio communications. However, there is no guarantee that interference will not occur in a particular installation. If this equipment does cause harmful interference to radio or television reception, which can be determined by turning the equipment off and on, the user is encouraged to try to correct the interference by one or more of the following measures:

- Reorient or relocate the receiving antenna.

- Increase the separation between the equipment and receiver.

- Connect the equipment into an outlet on a circuit different from that to which the receiver is connected.

- Consult the dealer or an experienced radio/TV technician for help.

### FCC and ISED Radiation Exposure Statement

This equipment complies with FCC and ISED radiation exposure limits set forth for an uncontrolled environment. This equipment should be installed and operated with minimum distance 20cm between the radiator & your body.

Cet équipement est conforme aux limites d'exposition au rayonnement FCC et ISED établies pour un environnement non contrôlé, cet équipement devrait être installé et exploité avec une distance minimale de 20cm entre le radiateur et votre corps.

- English: "

This device complies with Innovation, Science and Economic Development Canada licence-exempt RSS standard(s). Operation is subject to the following two conditions:

- (1) this device may not cause interference, and
- (2) this device must accept any interference, including interference that may cause undesired operation of the device."

- French: "

Cet appareil est conforme aux normes RSS exemptées de licence d'innovation, sciences et développement économique Canada. Le fonctionnement est soumis aux deux conditions suivantes:

- (1) l'appareil ne doit pas produire de brouillage, et
- (2) l'utilisateur de l'appareil doit accepter tout brouillage radioélectrique subi, même si le brouillage est susceptible d'en compromettre le fonctionnement."

### CAUTION!!



ADJUSTMENT OR ALTERATIONS OF THIS DEVICE MAY RESULT IN  
HAZARDOUS RADIATION EXPOSURE.

# KEMI MOTO



FCC ID:

Designed and engineered by Kemimoto in  
California,U.S.A , assembled in China

**Complete journey of dreams**