



Wireless Mechanical Keyboard

FEEL FREE TO CONTACT OUR YUNZII TEAM IF YOU HAVE ANY QUESTIONS!

FEEL FREE TO CONTACT OUR YUNZII TEAM IF YOU HAVE ANY QUESTIONS!

Information:

Model: B87
Battery: 4000mAh
Layout: 87-Key,80% Layout
Structure: Gasket
Backlight: South-Facing RGB
Size of Product: 373*147*46mm/14.68*5.78*1.81inch
Weight of Product: 1128g/2.49lb
Software: QMK&VIA
Connection: Bluetooth3.0/5.0&2.4G&Wired Type-C
Keycap: Dye Sublimation PBT Keycaps
System: Windows/Mac/Linux/Android/iOS
Hot Swappable: Full-Key Hot Swappable,
Support 3/5 Pins Hot Swappable Switches

Switch and Indicator Instruction:

Switch&Indicator



- 1 2.4G Slot
- 2 Tri-Mode Switch Bluetooth/Wired/2.4G
- 3 Type-C Port

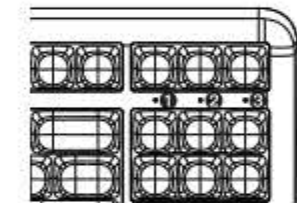

- 1 Caps Lock
- 2 Scroll Lock
- 3 Power Indicator

Bluetooth Connection: Fn+1/2/3

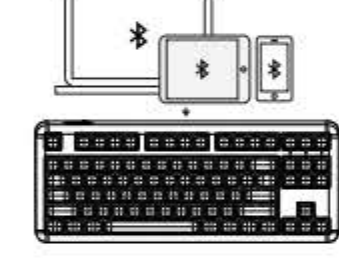

1. Toggle up the switch to the BT Bluetooth Mode.
2. Short press Fn+1/2/3 to choose a Bluetooth channel, and the 1/2/3 key will flash blue slowly.
3. Long press the Fn+1/2/3 to the Bluetooth pairing mode, and the 1/2/3 key will flash blue fast.
4. Choose the YUNZII B87 BT1/BT2/BT3 for pairing, and the RGB backlights will restore to the normal mode when paired successfully.

Note: If pairing fails, the 1/2/3 key will flash slowly, please reconnect it. If there is no operation for 60 seconds, the 1/2/3 key will light off, please awaken the keyboard first if you need to reconnect it.

2.4G Connection: Fn+4

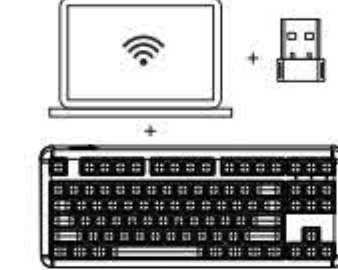

1. Switch the mode button to the 2.4G position, and the keyboard enters 2.4G Wireless Mode.
2. Long press Fn+4 to the 2.4G wireless pairing mode, and the 4 key will fast flash Green.
3. Plug the 2.4 G dongle into an empty USB port in your device, after successful pairing with YUNZII B87 2.4G, then restore to the normal lighting mode after pairing is successful.

Note: If pairing fails, the 4 key will flash slowly, please reconnect it. If there is no operation for 60 seconds, the 4 key will light off, please awaken the keyboard first if you need to reconnect it.

Wired Type-C Connection:

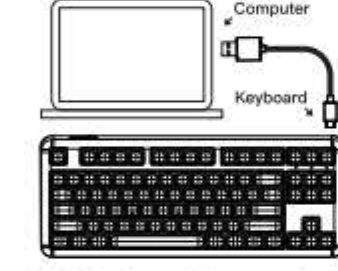

1. Switch the mode button to the Wired Mode.
2. Plug the cable that comes with the package to connect your computer.
3. The connection is successful.

Note: If pairing fails, please try a new cable/port/device to check where the problem is.

Backlights:

- Fn+Backspace=Backlight Effect ON/OFF
- Fn+|=Change Backlight Effect
- Fn+Enter=Change Backlight Color
- Fn+↑=Brightness ↑
- Fn+↓=Brightness ↓
- Fn+→=Blinking Speed ↑
- Fn+←=Blinking Speed ↓

Fn Shortcuts:

Windows	Fn+S
Fn+F1= Screen Brightness ↓	Fn+F2= Screen Brightness ↑
Fn+F4= Computer	Fn+F5= Email
Fn+F7= Previous Song	Fn+F8= Play/Pause
Fn+F10= Mute	Fn+F11= Volume ↓
Fn+F3= Choose a window or desktop (Win+Tab)	Fn+F6= Homepage
Fn+F9= Next Song	Fn+F12= Volume ↑

MacOS	Fn+A
Fn+F1= Screen Brightness ↓	Fn+F2= Screen Brightness ↑
Fn+F4= Launchpad	Fn+F5= F5
Fn+F7= Previous Song	Fn+F8= Play/Pause
Fn+F10= Mute	Fn+F11= Volume ↓
Fn+F3= Mission Control	Fn+F6= F6
Fn+F9= Next Song	Fn+F12= Volume ↑

Note: Please do not lock Win when you switch the keyboard system to the MacOS, the function of the Win/Alt keys will be exchanged.

Win&Mac		
FN+A= MacOS	FN+S= Windows	FN+1= BT1
FN+2= BT2	FN+3= BT3	FN+4= 2.4G
FN+Left Win= Lock Win	FN+ Spacebar= Reset	FN+Right Ctrl= Check Battery Level

Battery:

Low Power Mode&Charging
When the battery is charging, the power indicator light is red constant state; when the battery is full, the power indicator light is green, long light 5S and then off.
When the battery voltage is 3.45V, the indicator light prompts red fast flash, below 3.2V, keyboard directly shutdown.

Note: The charging time of the keyboard will vary slightly depending on the power difference during charging.

Battery Query

When the keyboard is in 2.4G/Bluetooth mode, press the Fn+Right Ctrl to check the battery level, the power indicator shows the power percentage, with 1-30% in red, 31%-70% in yellow, and 71% or more in green.

Power Saving Mode

When connected wirelessly (Bluetooth/2.4G), if there is no operation within 3 minutes, the keyboard enters sleep mode, the light will turn off and the keyboard in the connected state. When the keys are awakened, characters are output at the same time. After 30 minutes of no operation, the keyboard enters deep sleep mode, the keyboard will disconnect and the keyboard will awaken by pressing a key. The keyboard automatically reconnects after waking up. After connecting, the characters' output is normal.

How to customize your B87 keyboard?

1. Connect your keyboard to your computer in wired mode, and download the json file from the YUNZII official website.
2. Open the VIA Website: <https://usevia.app/>, and click "Authorize device" to pair the keyboard.
3. Click "SETTINGS" to turn on the "Show Design Tab".
4. Open the DESIGN page on the VIA website, and upload the json file that you downloaded from the YUNZII official website.
5. After the connection is complete, you can customize your keyboard now.

ATTENTION:

1. The B87 Mechanical Keyboard is Tri-Mode Bluetooth 3.0/5.0&2.4G Wireless&TYPE-C Wired connection, the keyboard accessories are in the accessory box, and the 2.4G dongle is in the storage slot.
2. When the keyboard is connected to the device, but cannot be recognized or connected by the device, please check if the connection steps/mode switch correctly, or try a new cable/USB port/new device to check where the problem is.
3. When the keyboard backlight dims or the product is used abnormally (some delays when typing or repeating characters), please press Fn+Right Ctrl to check the battery level in wireless mode, or check if the pin of the switch is bent or the socket was broken. If it indicates the battery is low, please charge the keyboard; if it's a pin problem, please try a new switch, if it's a socket problem, please contact our YUNZII after-sale team.
4. When the Win-Key is used abnormally, please check if the Win-Key lights up in white, if so, please press Fn+Left Win to unlock the Win-Key; if it is not solved, please check if the operating system has been changed to the MacOS (the Win and Alt function are exchanged), if so, please press Fn+S to switch the system to the Windows.
5. YUNZII B87 is designed with a built-in 4000mAh lithium battery, for the safety of the users, the product can only be used indoors at room temperature, please do not use it at high temperatures or near fire sources.
6. If the product is damaged beyond repair, please don't disassemble it or throw it into a fire. It should be sent to a professional scrap station or special recycling box for disposal to avoid accidental risks.
7. If you have any questions about the product or use, please contact the YUNZII after-sales team, we will get back to you in 48 hours!

Content List:

1. B87 Keyboard*1
2. USB Cable for TYPE-C*1
3. Switch and Keycap Puller*1
4. Function Card&Manual*1
5. 2.4G Dongle*1
6. Dust Cover*1
7. Extra Keycaps and Switches
8. Wrist Rest

Installation:

Switch

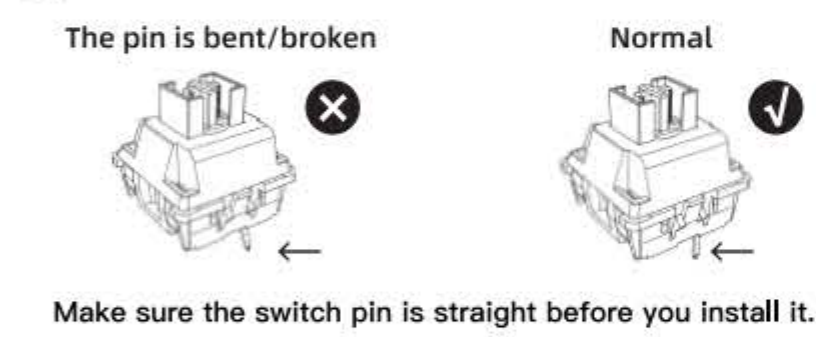

Make sure the switch pin is straight before you install it.

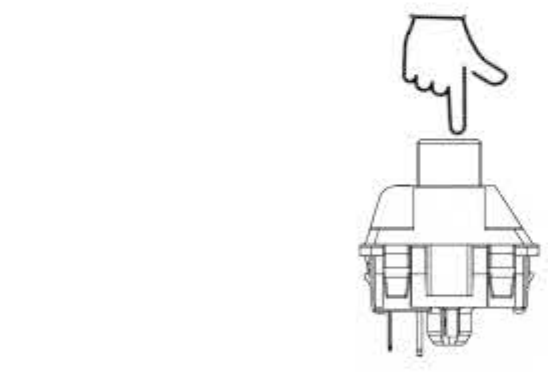

Please be gentle and make sure to align and insert the pins with the socket properly.

Keycap

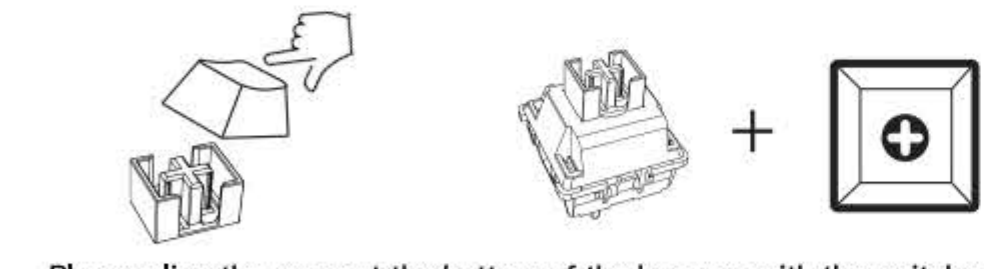

Please align the cross at the bottom of the keycaps with the switches and install it properly.

Package Included:

1. B87 Mechanical Keyboard
2. Wrist Rest
3. USB Cable for Type-C
4. Switch&Keycap Puller
5. Manual
6. 2.4G Dongle
7. Extra Switches
8. Extra Keycaps

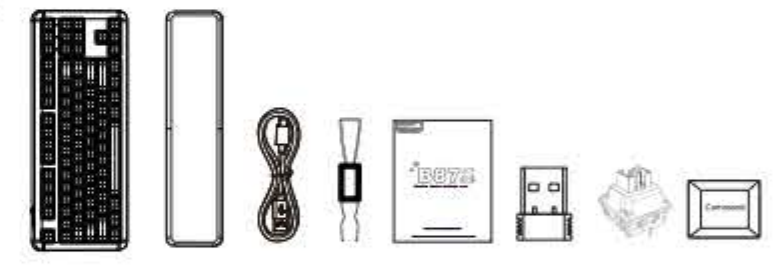

VIA Customization:

Please visit the <https://usevia.app/> to customize your keyboard online.
If the VIA cannot recognize your keyboard, please download the JSON file from our official website or contact our support team.



- * The online VIA customization can only run on the latest version of Chrome, Edge, and Opera browsers.
- * VIA can only work when the keyboard is connected in wired mode to the computer.

WARRANTY

The keyboard offers a high degree of customization, allowing users to tailor it to their preferences and needs. It has been designed with ease of rebuilding in mind, making it simple to swap out or upgrade components as desired. If any part of the keyboard malfunctions or fails within the warranty period, we cannot provide the entire keyboard to be returned or replaced. Instead, we will offer replacement parts for the specific defective components, ensuring a quick and efficient resolution while minimizing waste and inconvenience for the user.

FCC WARNING

This device complies with part 15 of the FCC Rules. Operation is subject to the following two conditions: (1) this device may not cause harmful interference, and (2) this device must accept any interference received, including interference that may cause undesired operation.

Any changes or modifications not expressly approved by the party responsible for compliance could void the user's authority to operate the equipment.

NOTE: This equipment has been tested and found to comply with the limits for a Class B digital device, pursuant to Part 15 of the FCC Rules. These limits are designed to provide reasonable protection against harmful interference in a residential installation. This equipment generates, uses and can radiate radio frequency energy and, if not installed and used in accordance with the instructions, may cause harmful interference to radio communications.

However, there is no guarantee that interference will not occur in a particular installation. If this equipment does cause harmful interference to radio or television reception, which can be determined by turning the equipment off and on, the user is encouraged to try to correct the interference by one or more of the following measures:

- Reorient or relocate the receiving antenna.
- Increase the separation between the equipment and receiver.
- Connect the equipment into an outlet on a circuit different from that to which the receiver is connected.
- Consult the dealer or an experienced radio/TV technician for help.

The device has been evaluated to meet general RF exposure requirement. The device can be used in portable exposure condition without restriction.