

Instructions for Use

Power on method for robot/remote control

Robot: Press and hold the power button for 0.5 seconds until the base lights up.

Remote control: Press and hold the power button for 0.5 seconds until the remote control lights up.

Robot/remote control enters pairing mode

In the shutdown state, press and hold the power button for 5 seconds until the indicator light flashes alternately red and blue. The robot/remote control will automatically search for nearby devices in alignment and connect them.

* There is no matching sequence requirement for the robot/remote control, and devices that enter the matching mode later will be automatically connected.

Shutdown method for robot/remote control

Robot: Press and hold the power button for 0.5 seconds until the base indicator light goes out.

Remote control: Press and hold the power button for 0.5 seconds until the remote control indicator light turns off.

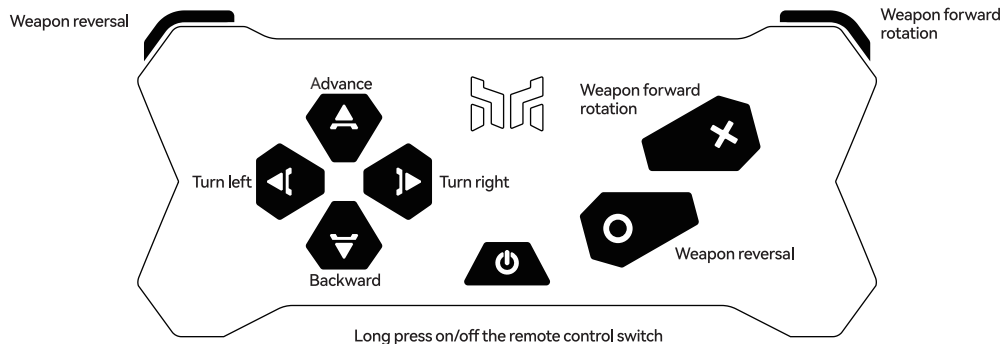
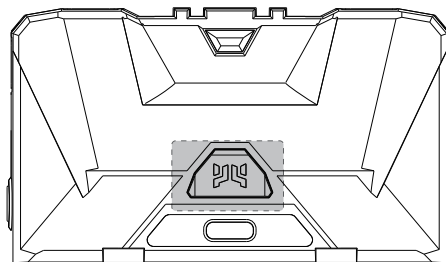
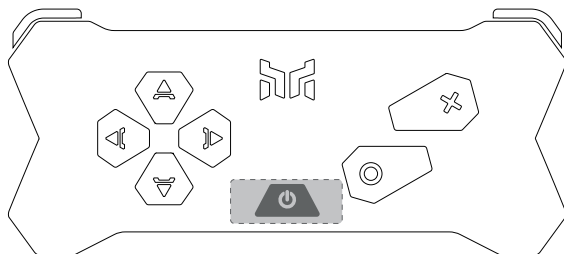

Tip: If your combat robot is walking backwards, you can press and hold the up and down buttons on the remote control for 5 seconds to modify the direction of the machine's movement

Charging operation

Use the standard charging cable to connect the USB Type-C interface to the USB charger (provided by the user) for charging. During the shutdown charging process, the indicator light is always red, and when fully charged, the green light is always on. It takes about 40 minutes for the robot to fully charge, and about 70 minutes for the remote control to fully charge.

* The charging time is determined through laboratory testing and is for reference only

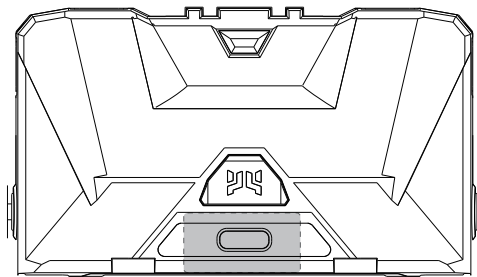
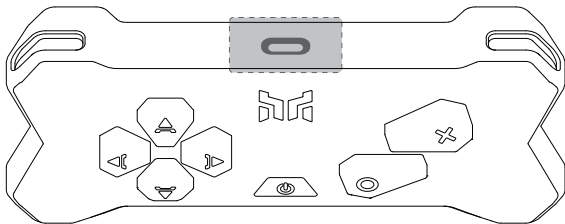

Light effect description

Robot Light Effect Description	
Lamp effect	Explain
Blue light flashing	Waiting for connection
Blue light always on	Connection is normal
Flashing red and blue alternately	Code matching mode
Flashing red light	Low battery reminder
Red light always on	Charging
Green light always on	Charging completed

Remote Control Light Effect Description	
Lamp effect	Explain
Blue light flashing	Waiting for connection
Blue light always on	Safe mode connection is normal
Flashing red and blue alternately	Code matching mode
Flashing red light	Low battery reminder
Red light always on	Charging
Green light always on	Charging completed

Technical Specifications

Weight	
Drum robot	290g
Vertical rotation robot	290.6g
Remote control	76g
Robot Battery	
Battery capacity	360mAh
Battery nominal voltage	7.4V
Charging limit voltage	8.4V
Battery type	Polymer lithium-ion battery
Maximum charging current	1.08A
Maximum discharge current	3.6A
Charging ambient temperature	10~50℃
Remote Control Battery	
Battery capacity	400mAh
Battery nominal voltage	3.7V
Charging limit voltage	4.2V
Battery type	Polymer lithium-ion batteries
Maximum discharge current	4A
Maximum charging current	0.8A
Charging ambient temperature	10~50℃
Motion Module	
Total reduction ratio	50.5: 1
No-load speed	420rpm±10% (7.4V)
No-load current	≤160mA (7.4V)
Maximum movement speed of the robot	650mm/s±10%

Size	
Drum robot	124.5mm*127.2mm*45.8mm
Vertical rotation robot	124.5mm*127.2mm*45.8mm
Remote control	130*59*27mm
Remote Control	
Working frequency band	2.4GHz ISM frequency band
Maximum signal effective distance	> 15m
Delayed	< 20ms
Transmitting power	20dBm
Endurance	
Robots:	
Full power output	20min
Standby	11.25h
Remote control:	
Standby	8h
Vertical Rotation Robot Weapon Motor	
Rated voltage	8.4V
No-load speed	≥2000rpm±10%
No-load current	≤320mA
Locked rotor torque	≥37mN·m
Maximum speed of robot weapon	690rpm±10%
Drum Robot Weapon Motor	
Rated voltage	8.4V
No-load speed	22000rpm±10%
No-load current	≤320mA
Locked rotor torque	≥37mN·m
Maximum speed of robot weapon	1800rpm±10%

FCC Warning

This device complies with part 15 of the FCC rules. Operation is subject to the following two conditions: (1) this device may not cause harmful interference, and (2) this device must accept any interference received, including interference that may cause undesired operation.

Changes or modifications not expressly approved by the party responsible for compliance could void the user's authority to operate the equipment.

NOTE: This equipment has been tested and found to comply with the limits for a Class B digital device, pursuant to part 15 of the FCC Rules. These limits are designed to provide reasonable protection against harmful

interference in a residential installation. This equipment generates uses and can radiate radio frequency energy and, if not installed and used in accordance with the instructions, may cause harmful interference to radio communications. However, there is no guarantee that interference will not occur in a particular installation. If this equipment does cause harmful interferenceto radio or television reception, which can be

determined by turning the equipment off and on, the user is encouraged to try to correct the interference by one or more of the following measures:

- Reorient or relocate the receiving antenna.
- Increase the separation between the equipment and receiver.
- Connect the equipment into an outlet on a circuit different from that to which the receiver is connected.

Consult the dealer or an experienced radio/TV technician for help.

Radiation Exposure Statement

The device has been evaluated to meet general RF exposure requirement. The device can be used in portable exposure condition without restriction.