



**Please read all instructions
Before assembling and using your new product.**

Please do not return the product to the store if you have any problems or questions during assembly and installation. Please email us at info@fourseasonsimport.com or call at 1-866-931-9635 and we will assist you.

SKU#286-2099 / MODEL# 23SYM-QY0818

5' LED SMART CONE TREE

FOR INDOOR & OUTDOOR USE

READ AND FOLLOW ALL SAFETY INSTRUCTIONS

- This is a seasonal decoration and is not intended for permanent installation or year round use. It is recommended not to use for more than 90 consecutive days.
- This is an electric product – NOT A TOY! Keep the product out of the reach of children and pets, to avoid the risk of fire, burns, electrical shock, or serious personal injury. Extra caution is necessary when using this product near children. Do not allow children or pets to play near the product.
- THIS PRODUCT CONTAINS SMALL PARTS, WHICH COULD CAUSE CHOKING IF SWALLOWED.
- TO PREVENT FIRE OR SHOCK HAZARD, DO NOT REMOVE COVER. NO USER SERVICEABLE PARTS INSIDE. IF SERVICING IS NEEDED, SEND TO A QUALIFIED SERVICE PERSONNEL. PLEASE ADHERE TO THE FOLLOWING:
 1. Read Instructions - All safety and operating instructions should be read before the product is operated. Please adhere to the instructions and warnings for your safety.
 2. Heat - The product should be situated away from heat sources such as radiators, hairdryers, heat registers, stoves or other products that produce heat.

g) SAVE THESE INSTRUCTIONS.

▲ WARNING: Risk of Fire, shock, or personal injury.

- Use only with enclosed Class 2 adaptor model: TS-5V2A provided.
- Not for use on outlets controlled by a dimmer.
- Do not attempt to replace bulbs, they are not replaceable.
- It's highly recommended to use the provided plastic ties to secure the function controller box to the upper metal frame. This precaution prevents the controller box from being buried under snow accumulation, thereby ensuring the best connection with the remote control.



Use and Care Instructions

- Before using or reusing, inspect product carefully. Discard any products that have cut, damaged, or frayed wire insulation or cords, cracks in the lamp holders or enclosures, loose connections, or exposed copper wire.
- When storing the product, carefully remove the product from wherever it is placed, including trees, branches, or bushes, to avoid any undue strain or stress on the product conductors, connections, and wires.
- When not used, store neatly in a cool, dry location protected from sunlight.
- Do not impact or drop the adaptor, if enclosure is broken, discard product.
- The product and the adaptor shall not be installed within 10 feet of a pool, spa, fountain, or other areas of standing water.

PART	DESCRIPTION	ILLUSTRATION	QTY
A	STAR		1
B	TOP		1
C	MIDDLE		1
D	BOTTOM		1
E	PLASTIC TIES		5

PART	DESCRIPTION	ILLUSTRATION	QTY
F	GROUND STAKES		4
G	FUNCTION CONTROLLER BOX		1
H	ADAPTOR		1
I	REMOTE CONTROL		1

TO ASSEMBLE

- Gently Remove all the parts from the box carefully and lay out the components.

NOTE: A. Some parts are connected by a string of lights and should NOT be separated. Any separation or disconnection of the light set may cause the unit to malfunction or not light completely.

B. Due to the nature of the materials of this product, gentle assembly is required.

- Connect the BOTTOM (D) and MIDDLE (C) sections of the cone tree and firmly secure them in position with the PLASTIC TIES provided. **(Fig. 1)**
- Connect the TOP (B) and MIDDLE (C) sections of the cone tree and firmly secure them in position with the PLASTIC TIES provided. **(Fig. 2)**

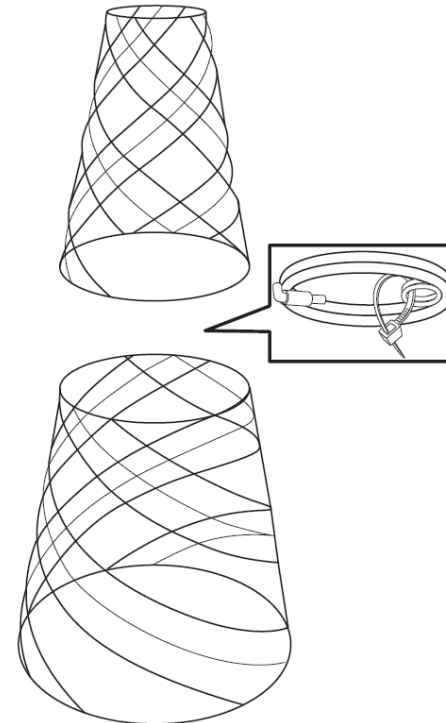

Fig 1

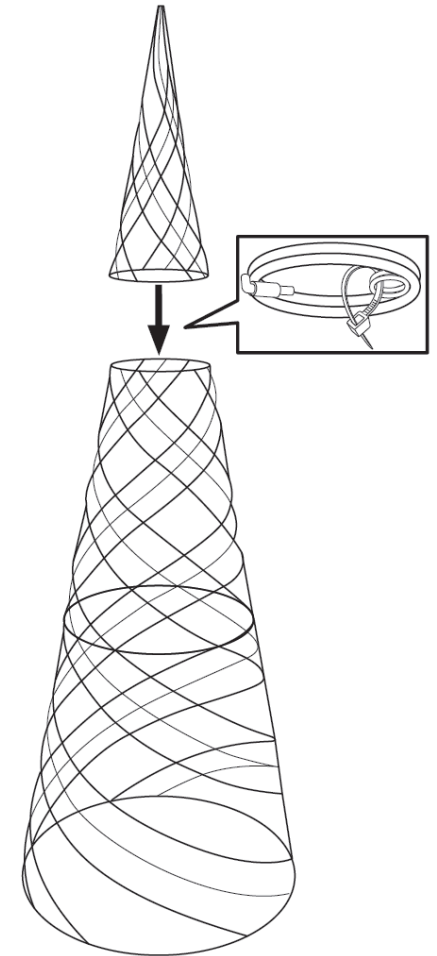

Fig 2

- Insert the STAR (A) into the top of the cone tree. **(Fig. 3)** NOTE: It is recommended to firmly secure the STAR (A) with a PLASTIC TIE provided.

- If you are using this item outdoors on a lawn, secure the product to the soft ground by fully inserting all the GROUND STAKES (F) provided into the ground. **(Fig. 4)**

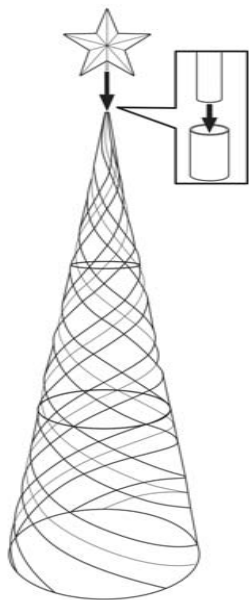

Fig 3

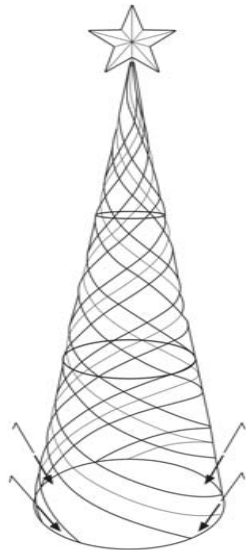

Fig 4

OPERATION

1. To illuminate, plug the adaptor into a standard 120-volt AC electrical outlet.
2. To switch functions, use the REMOTE CONTROL (I) or FUNCTION CONTROLLER BOX (G) attached to the tree to achieve the 27 functions.

NOTE: Pull out the transparent tab at the bottom of the REMOTE CONTROL (I) before using.

3. The FUNCTION CONTROLLER BOX (G) should not be obstructed and the remote control should align with the FUNCTION CONTROLLER BOX (G) when using it. The remote control maximum distance is 9.8ft (3m).

WARNING: The REMOTE CONTROL (I) uses a button cell battery – CR2025. (Included)

WARNING

- **INGESTION HAZARD:** This product contains a button cell or coin battery.
- **DEATH** or serious injury can occur if ingested.
- A swallowed button cell or coin battery can cause **Internal Chemical Burns** in as little as **2 hours**.
- **KEEP** new and used batteries **OUT OF REACH OF CHILDREN**.
- **Seek immediate medical attention** if a battery is suspected to be swallowed or inserted inside any part of the body.



- Remove and immediately recycle or dispose of used batteries according to local regulations and keep away from children. **DO NOT** dispose of batteries in household trash or incinerate.
- Even used batteries may cause severe injury or death.
- Call a local poison control center for treatment information.
- The battery type is CR2025
- The battery voltage is 3.0V.
- Non-rechargeable batteries are not to be recharged.
- Do not force discharge, recharge, disassemble, heat above 140° F/60°C or incinerate. Doing so may result in injury due to venting, leakage or explosion resulting in chemical burns.
- Ensure the battery is installed correctly according to polarity (+ and -).
- Remove and immediately recycle or dispose of batteries from equipment not used for an extended period of time according to local regulations.
- Always completely secure the battery compartment. If the battery compartment does not close securely, stop using the product, remove the batteries and keep them away from children.

REMOTE CONTROL FUNCTIONS

- 1.ON/OFF (ON WITH MEMORY)
- 2.SINGLE COLOR GRADIENT CHANGING
- 3~9. SINGLE COLOR (7 COLORS) STEADY ON
10. MULTICOLOR SEQUENTIAL CHASING
11. MULTICOLOR CHANGING STACK UP
12. SINGLE COLOR SLOW CHANGING
13. BLUE FAST CHASING
14. MULTICOLOR CHASING CLOSED
15. MULTICOLOR CHASING OPENED
- 16.MULTICOLOR FAST CHASING UP
17. MULTICOLOR FAST FALLING DOWN
18. MULTICOLOR FLASHING
19. WHITE FLICKERING IN SINGLE COLOR
20. MULTICOLOR FADE IN & FADE OUT
21. MULTICOLOR CLOSED CHASINGSYNCS WITH THE SOUND
22. MULTICOLOR FLASH CHASING SYNCS WITH THE SOUND
23. MULTICOLOR FLASH FALLING SYNCS WITH THE SOUND
24. CONBINATION (AUTO)
25. BRIGHTNESS ADJUSTMENT (+/-)
26. SPEED ADJUSTING (QUICK/SLOW)
27. SOUND SENSITIVITY ADJUSTMENT (+/-)
28. TIMER (4 HOURS / 6 HOURS)

MAGIC LANTERN APP

1. OVERVIEW

The Magic Lantern is a mobile app that controls the LED lights through an iOS or Android mobile phone. Through the mobile app, you can easily and quickly control the color, brightness and color temperature of the LED lights. You can also set various flashing modes, and make the LED lights move with the music rhythm. Just keep the LED string light powered on, turn on the mobile phone "Magic Lantern" APP intelligent control software, connect the product through Bluetooth, so as to realize various settings and control of the smart RGB lights.

2.OPERATING ENVIRONMENT

This APP program requires phones of system above Android 4.3 and iOS 8.0 Mobile phone configuration is not limited.

3.INSTUCTIONS

Note: Android version and iOS version download and use the same method, here in the iOS version as an example.

3.1 APP Download

iOS and Android systems can download the "Magic-Lantern"APP by scanning the QR code. Open the browser or other tools with "Scan QR code" function, scan the Magic Lantern " QR code. The QR Code can also be found on the Product Box and FUCNTION CONTROLLER BOX (G)

3.2 After the "Magic-Lantern"APP is installed and downloaded successfully, click to start. After entering the APP interface, if Bluetooth is not enabled, Allow "Magic Lantern" to use Bluetooth function.

3.3 Now you can control the Smart Cone Tree with your smart phone!



DOWNLOAD APP
SCAN HERE

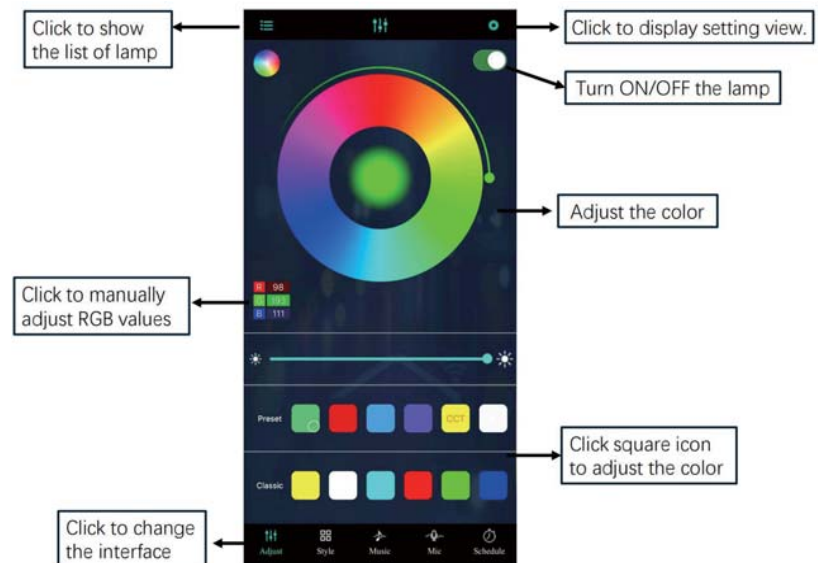

FCC Warning

This device complies with part 15 of the FCC Rules. Operation is subject to the following two conditions: (1) This device may not cause harmful interference, and (2) this device must accept any interference received, including interference that may cause undesired operation.

Any Changes or modifications not expressly approved by the party responsible for compliance could void the user's authority to operate the equipment.

Note: This equipment has been tested and found to comply with the limits for a Class B digital device, pursuant to part 15 of the FCC Rules. These limits are designed to provide reasonable protection against harmful interference in a residential installation. This equipment generates uses and can radiate radio frequency energy and, if not installed and used in accordance with the instructions, may cause harmful interference to radio communications. However, there is no guarantee that interference will not occur in a particular installation. If this equipment does cause harmful interference to radio or television reception, which can be determined by turning the equipment off and on, the user is encouraged to try to correct the interference by one or more of the following measures:

- Reorient or relocate the receiving antenna.
- Increase the separation between the equipment and receiver.
- Connect the equipment into an outlet on a circuit different from that to which the receiver is connected.
- Consult the dealer or an experienced radio/TV technician for help.

The device has been evaluated to meet general RF exposure requirement. The device can be used in portable exposure condition without restriction.