



**Intelligent Cat Litter Box M10**  
**Auto-Pack & Odor-Free**  
User manual

Please read the user manual carefully before using the product and keep it properly

# Contents

---

Before You Use	1
Product Introduction	2
How To Use	6
Maintenance	7
Product Specifications	11
Warranty Description	12

## Before You Use

---

### Precautions

Please read the user manual carefully before using the product.

Once you use this product, it indicates that you have carefully read and accepted the following precautions.

The company is not responsible for and legally liable for any accidents or losses resulting from improper use of the product.

- This appliance is not intended for use by persons (including children) with reduced physical, sensory or mental capabilities, or lack of experience and knowledge, unless they have been given supervision or instruction concerning use of the appliance by a person responsible for their safety.
- Children should be supervised to ensure that they do not play with the appliance.
- This appliance can be used by children aged from 8 years and above and persons with reduced physical, sensory or mental capabilities or lack of experience and knowledge if they have been given supervision or instruction concerning use of the appliance in a safe way and understand the hazards involved.
- Cleaning and user maintenance shall not be made by children without supervision.
- The appliance is only to be used with the power supply unit provided with the appliance.
- If you do not use this product for a long time, please disconnect the power supply.
- To ensure cat safety, kittens under four months of age and cats weighing less than 1.5 kg are not recommended to use this product.
- Place the product on a flat, hard ground and ensure that there are no foreign objects at the bottom.
- Do not place the product along the edge or in a high place to avoid the risk of falls and damages.
- Do not place any other objects on the upper cover of the product.
- This product is only suitable for the cat litter with a length of less than 5 mm, and we recommend that you buy 3i brand cat litter.
- Do not open the upper cover, litter addition box, waste drawer, and litter collection drawer during the operation of the product.
- When replacing the packing box, make sure that you push the packing drawer into the original position after it is installed in place.
- When adding the cat litter, ensure that the amount of cat litter does not exceed the MAX line and that the cat litter is leveled off.
- Do not expose the product to high temperature and humidity.
- Children should use this product under the supervision and guidance of adults. Otherwise, you must enable the child safety lock.
- If you encounter any issues with the product, please contact our customer service for assistance.

Hope you are happy using this product!

# Product Introduction

---

## Packing list

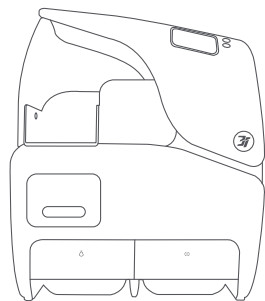

Main unit

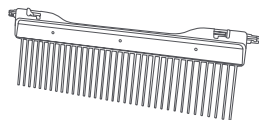

Litter shovel  
(A litter shovel has been installed  
in the main unit)



Six packing boxes  
(A packing box has been installed  
in the main unit)

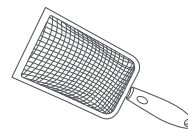

Cat litter scoop



Power adapter

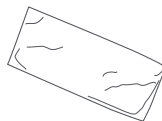

32 trash bags  
(Two trash bags have been  
installed in the main unit)

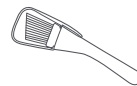

Brush



User manual

Note: The illustrations of the product, accessories, and user interface in the manual are all schematic diagrams and are for reference only.

Due to the update and upgrade of the product, the actual product may be slightly different from the schematic diagram. Please refer to the actual product.

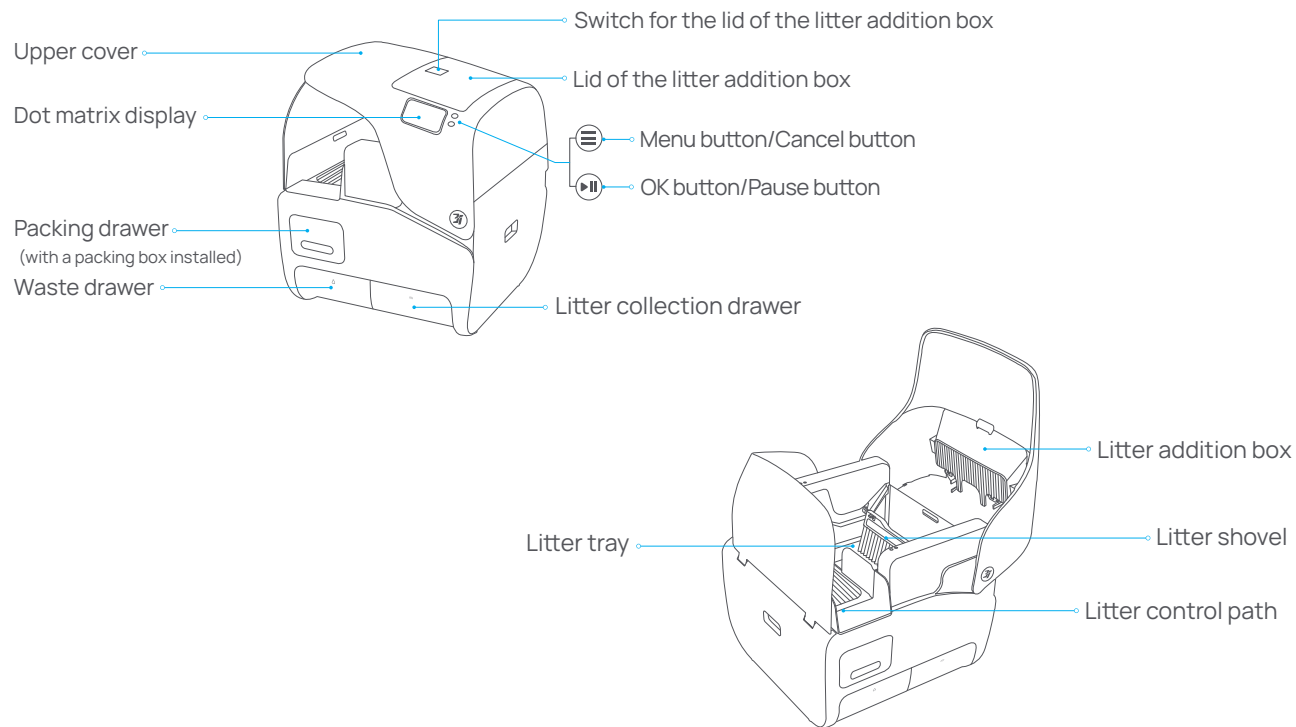

# Product Introduction

## Product structure



# Product Introduction

## Button usage

Button	Operation	Button Function	Function Description
 Menu button	Short press	Switch functions	Switch functions (Clean now, Level cat litter, Empty cat litter, Add cat litter, or Deodorize)
		Cancel the selected function	Short press the menu button to cancel the selected function (Clean now, Level cat litter, Empty cat litter, or Adding cat litter)
 OK button	Short press	OK/Start/Pause	(1) Start by default: Clean now (2) Start a specific function (Clean now, Level cat litter, Empty cat litter, Add cat litter, or Deodorize)
	Short press 3 times	Child safety lock	Enable or disable the child safety lock
	Long press for 3 seconds	Configure the network	Connect the device to Wi-Fi
Menu button + OK button	Long press for 10 seconds	Restore to factory settings	Restore the product to factory settings (all Product specifications you configured are deleted)

## Dot matrix display and light status description

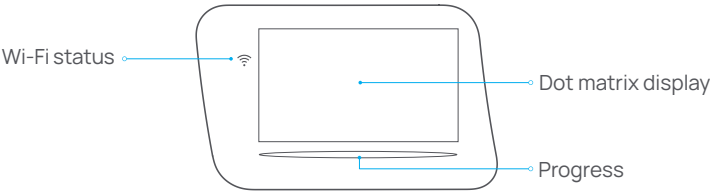









# Product Introduction

## Light status description

Icon	Light status	Status
	Steady yellow	The product is not connected to Wi-Fi.
	Flashing white	The network is being configured.
	Steady white	The product is already connected to Wi-Fi.

## Dot matrix display status description

Status type	Product status	Icon	Display time description
Switch functions	Clean		The Clean icon is displayed by default when you switch functions.
	Pack		The Clean icon is displayed when you switch functions and a timeout occurs.
	Add cat litter		
	Level cat litter		
	Empty cat litter		
	Deodorize		
Child safety lock	Enable child safety lock		The indicator light is always on after the child safety lock is enabled.
	Disable child safety lock		The indicator light is on when you disable the child safety lock and will be off after 3 seconds.
	Press any button		When the child safety lock is disabled, the indicator light flashes and resumes after 3 seconds if you trigger any button again.

## How to Use

### Connect the power supply

Take out the power adapter, connect the main unit and power supply, and wait for it to turn on.

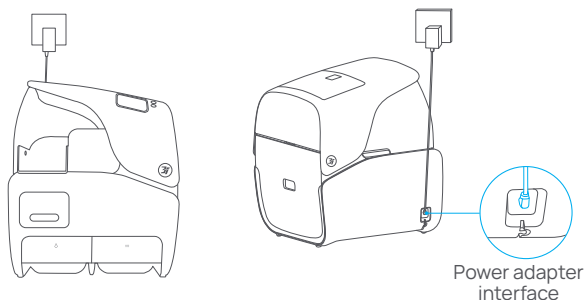

Note: When you power on or the firmware is upgraded and automatically restarts, you need to wait for the main unit to complete the self-test before you can perform operations.

### Configure the network

1. Scan the QR code below to download and install the app, and create an account on the app or sign in to the account.
2. After you sign in, click "Add device" in the app of your mobile phone and bind the device to the app according to the prompts.



### Add the cat litter

1. Open the upper cover of the cat litter box.
2. Add an appropriate amount of cat litter to the litter tray, and ensure that the amount of cat litter does not exceed the MAX line.
3. Use the cat litter scoop to level the cat litter to avoid a hill pile.
4. Close the upper cover of the cat litter box.

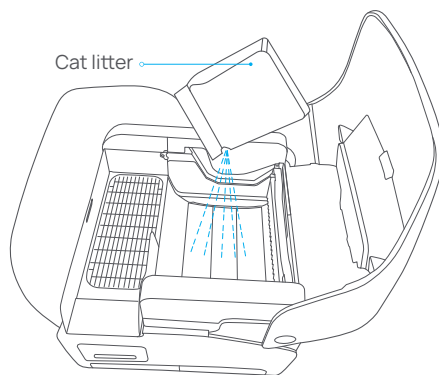

Note:

1. Make sure that no cat is in the cat litter box before closing the upper cover.
2. Buy cat litter additionally. We recommend that you buy 3i brand cat litter.



## How to Use

### Store the cat litter

1. Press and hold the switch for the litter addition box lid to open the lid.
2. Add an appropriate amount of cat litter to the litter tray and ensure that the amount of cat litter does not exceed the MAX line.
3. Use the cat litter scoop to level the cat litter to avoid a hill pile.
4. Firmly close the lid of the litter addition box.

Attention: Do not touch when litter refilling to avoid pinching hands.

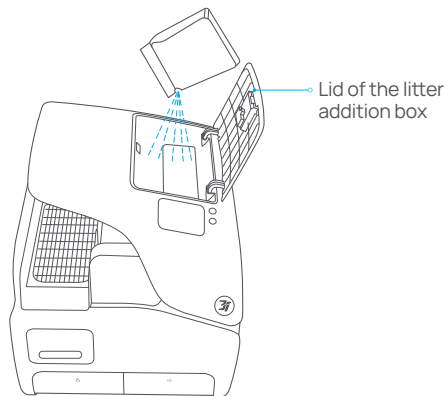

Note: You must ensure that there is always cat litter in the litter addition box so that the cat litter will be automatically refilled into the litter tray when the device is short of cat litter.

## Maintenance

### Replace a packing box

1. Pull open the packing drawer when the app prompts that the packing bag is used up and the device is in standby mode.
2. Take out the used packing box and discard it directly.
3. Install a new packing box into the packing drawer.
4. Pull the packing bag down slightly at the bottom of the packing box to ensure that it can be identified by sensors successfully.
5. Push the packing drawer back to the original position to make sure it is firmly closed, and click the Start/Pause button to reset the number of packing times.

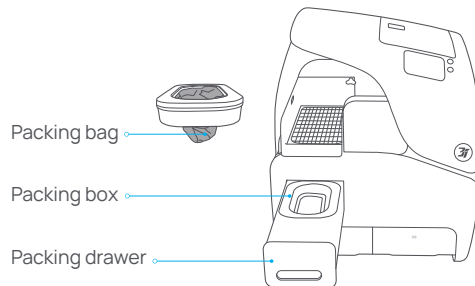

Note:

1. When you replace the packing box, you need to pull the packing bag down slightly at the bottom of the packing box to ensure that it can be identified by sensors successfully.
2. After the packing bags in the packing box are used up, the packing box cannot be reused and needs to be replaced with a new one.

### Caution, hot surface



Please do not pull out the packaging drawer or touch the packaging bag during packaging.

## Maintenance

### Clean the waste drawer

1. When you get a voice message saying "The waste drawer is full. Please clean it up in time", pull out the waste drawer, pack the trash bags, and throw them into the trash bin.

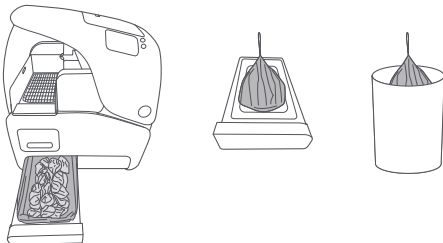

2. Put new trash bags into the waste drawer.

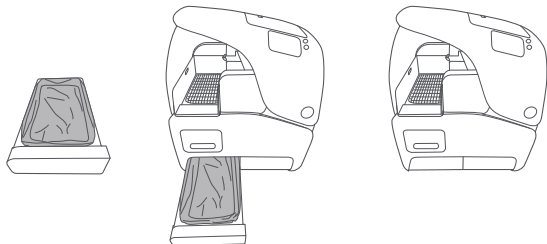

Note: When you replace a trash bag, you must snap its edge on the buckle of the waste drawer or litter collection drawer to ensure that it is installed in place.

### Change the cat litter

1. Select "Empty cat litter" from the menu of the main unit to empty the cat litter in the litter tray.
2. After emptying the cat litter, use the brush to remove the remaining cat litter in the gaps of the litter board.
3. Shortly press the "Start" button to reset the litter board to the original position.
4. Add the cat litter and close the upper cover of the cat litter box.

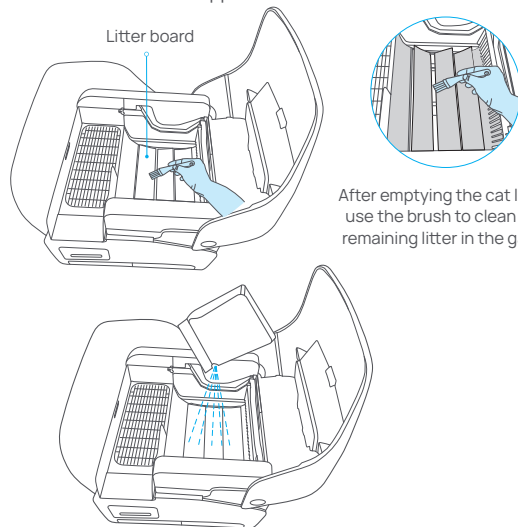

After emptying the cat litter, use the brush to clean the remaining litter in the gaps.

Note:

1. Make sure that no cat is in the cat litter box before closing the upper cover.
2. Clean the litter collection drawer every time you empty the cat litter.

## Maintenance

### Clean the litter collection drawer

1. When you get a voice message saying "The litter collection drawer is full. Please clean it up in time"; pull out the litter collection drawer, pack the trash bags, and throw them into the trash bin.

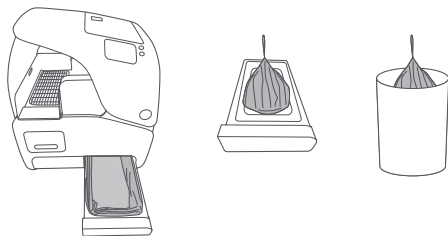

2. Put new trash bags into the litter collection drawer.

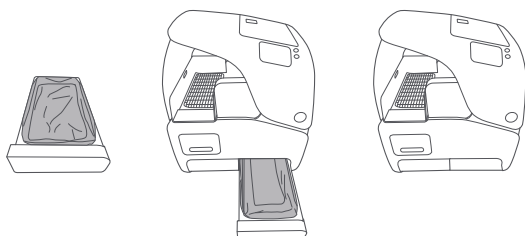

### Clean other components

1. Empty the cat litter in the litter tray remotely on the app or choose "Empty cat litter" > "Pause" > "Return" from the menu of the main unit to empty the cat litter in the litter tray.
2. Open the upper cover and take out the litter control path, litter shovel, and litter tray in turn.

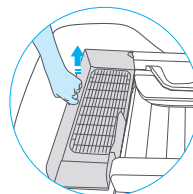
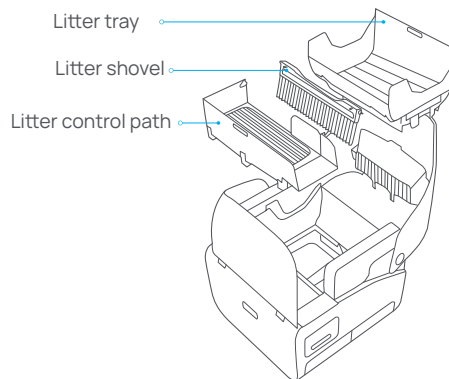

Litter control path

Take out the litter control path as shown in the figure

## Maintenance

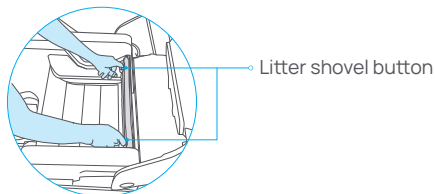

Litter shovel button

### Litter shovel

Take out the litter shovel:

Press and hold the litter shovel button with both hands and push it to the middle to the marker position to take out the litter shovel

Install the litter shovel:

Align one side of the litter shovel with the card slot, press and hold the litter shovel button with your hand, push the metal buckle into the card slot, and repeat this operation on the other side



### Litter tray

As shown in the figure, hold the handle on the right side of the litter tray, pull it inward, and then take it out with both hands

3. Rinse the litter control path, litter shovel, and litter tray directly with clean water.

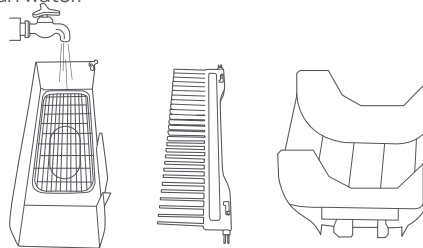

4. After cleaning them, put the litter tray, litter shovel, and litter control path back to their original positions in turn (the order is reversed from that of taking out them).

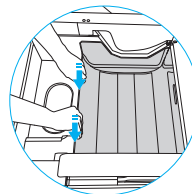

When installing the litter tray, press the edge downward to ensure that it is installed in place

Note:

1. Do not wash other areas inside the device with water. You can only use a wet towel to wipe them clean.
2. After washing the litter control path, litter shovel, and litter tray, wipe off the water stains with a rag or let them dry before installing them into the main unit.

## Product Specifications

Product name	3i Intelligent Cat Litter Box M10
Product model	HOME-M10
Rated input voltage	20V <sup>---</sup>
Maximum input current	2.4A
Net weight	About 24.5kg
Product dimensions	585 × 584 × 710mm

This device includes a radio transmission module with the type approval code: CMIIT ID: 2020AP1232.

Usage environment: indoor use only

Contains FCC ID: 2AHMR-BW16  
Contains IC: 23236-BW16  
FCC ID: 2BGN6-SCZN0527  
IC: 32482-SCZN0527

This device complies with part 15 of the FCC Rules. Operation is subject to the following two conditions: (1) This device may not cause harmful interference, and (2) this device must accept any interference received, including interference that may cause undesired operation.

## FCC Statement

Warning: Changes or modifications to this unit not expressly approved by the party responsible for compliance could void the user's authority to operate the equipment.

NOTE: This equipment has been tested and found to comply with the limits for a Class B digital device, pursuant to Part 15 of the FCC Rules. These limits are designed to provide reasonable protection against harmful interference in a residential installation. This equipment generates, uses and can radiate radio frequency energy and, if not installed and used in accordance with the instructions, may cause harmful interference to radio communications. However, there is no guarantee that interference will not occur in a particular installation. If this equipment does cause harmful interference to radio or television reception, which can be determined by turning the equipment off and on, the user is encouraged to try to correct the interference by one or more of the following measures:

- Reorient or relocate the receiving antenna.
- Increase the separation between the equipment and receiver.
- Connect the equipment into an outlet on a circuit different from that to which the receiver is connected.
- Consult the dealer or an experienced radio/TV technician for help.

The device must not be co-located or operating in conjunction with any other antenna or transmitter.

FCC RF Radiation Exposure Statement Caution: To maintain compliance with the FCC's RF exposure guidelines, place the product at least 20cm from nearby persons.

This equipment should be installed and operated with a minimum distance of 20 cm between the radiator and your body.

## Warranty Description

---

### Warranty service

The after-sales service of this product is strictly followed by the relevant laws and regulations of the countries and regions where it is sold to provide the "repair, replacement, and return" (3Rs-warranty) warranties, which is as follows:

1. Within 7 days of the date of the purchase, if the product has a non-man-made damage or performance failure, the consumer can choose to refund and return it at a time or replace the product of the same model according to the invoice price.
2. Within 15 days of the date of the purchase, if the product has a non-man-made damage or performance failure, the consumer can choose to replace the product of the same model.
3. Within 1 years of the date of the purchase, if the product has a non-man-made damage or performance failure, the consumer can enjoy free maintenance services.
4. When returning and exchanging this product, the consumer must guarantee that the accessories of the whole product are complete, the appearance is not damaged, and the packaging is complete.

### Non-warranty service

The warranty service is only valid under normal use, and man-made damages and the following terms are not covered by the free warranty:

1. Damages to the product caused by the user's negligence, fault, misuse, or disaster (such as food stains, water ingress, cracks under external force, or scratches and damages to peripheral parts);
2. Repairs and modifications that are not authorized by the manufacturer because users disassemble the device by themselves (such as color changes, additions, or any damages caused by unauthorized modifications);
3. Damages to the product caused by improper connection of accessories, transportation, and other accidents;
4. No 3Rs-warranty certificate (except for those that can prove that the product is within the validity period of the 3Rs-warranty service) or beyond the validity period of the 3Rs-warranty service;
5. Inconsistency between the content on the 3Rs-warranty certificate and the actual product identification or later alterations on the 3Rs-warranty certificate;
6. Damages caused by force majeure;
7. Free accessories that are given as gifts in promotional activities;
8. Normal wear and tear and consumables (packing boxes, trash bags, and cat litter);
9. We recommend that you keep the original packaging of the product for 7 days, including the user manuals and gifts. If the packaging is lost, you need to bear the cost of packaging materials;
10. This product is a sanitary product. To avoid cross-infection of cats, we do not support returns for non-quality problems once the product is used (the product is deemed to be used so long as you have added the cat litter).

## Warranty Card

The card is required for warranty

Product model		
Warranty period	Cat litter box	YY/MM/DD
Owner's name	Name Address	
Where purchased	Name Address	Stamp

Thank you for purchasing the Intelligent Cat Litter Box!

To ensure your legitimate interests, the customer center makes a standard service commitment to you, and will wholeheartedly provide you with relevant services when you need them!

1. Please keep your product warranty card properly;
2. When you need to maintain the product, please fill in the warranty information completely and ensure that the font is neat and clear and easy to read;
3. When you enjoy the after-sales service, please show the product warranty card and related purchase information. If it is an online purchase, you can also enjoy the relevant after-sales service after you provide the platform account for purchasing the product;
4. You can call our after-sales service hotline: 400-606-3131.

## Warranty principles

1. If the purchased product has quality problems, you can replace it at the purchasing location within 7 days so long as it has no man-made damage or has not been dismantled.
2. You can enjoy free maintenance services as long as the product you purchased is within the warranty period;
3. In the following cases, the free warranty will be invalid. However, maintenance services will be provided, and the corresponding accessories and labor costs will be charged during maintenance.
  - (1) Damages caused by human factors, including damage caused by use in an abnormal working environment or not followed by the user manual;
  - (2) Damages due to the user's unauthorized disassembly, self-maintenance, modification, or maintenance not by the company's maintenance department;
  - (3) Damages caused by force majeure (such as fire, earthquake, or lightning strike);
  - (4) No product warranty card and valid proof of purchase, and failure to find out the user information;
  - (5) Failure to verify the date of purchase.

## Warranty period

Product series	Warranty period
Main unit	1 years
Power adapter	6 months
Consumables including packing boxes, trash bags, and cat litter	No warranty

Note: This policy guarantees basic maintenance services, but the warranty card period of a promotional product is subject to the actual situation.

Manufacturer: Shenzhen PICEA Intelligent Technology Co., Ltd.  
Address: Floor 10, Block A, Han's Innovation Building, No. 9018, Beihuan  
Avenue, North District, High-tech Park, Nanshan District, Shenzhen,  
Guangdong, P.R. China  
Website: <https://www.3itech.com>  
Made in China