

128G铜版纸 尺寸:85x62mm

CarPlay Adapter



User Manuals

Overview

This product is suitable for models with original wired CarPlay or Android Auto. Through the car's USB interface, the original car's wired CarPlay or Android Auto can be upgraded to wireless CarPlay or Android Auto. Provide users with a more convenient driving experience.

Feature

1. Plug and play, senseless connection, say goodbye to wired constraints.
2. 2.4GHz+5.8GHz, faster data transmission speed and lower latency.
3. Support OTA upgrade, online feedback, and quick problem solving.
4. Continue the original car buttons, knobs and other operations.
5. Compatible with the original car microphone, continuing the original car sound quality.

Parameter

Power input: DC 5V±0.2V ≈ 1.0A
Power output: DC 5V±0.2V≈ 1.0A
Power consumption: 0.75W
Color: silver
Material: tempered glass + zinc alloy shell
Compatible Phones: Requires iPhone 6 or later iPhone model and iOS 10 or later to use wireless Carplay functionality. Or need an Android smartphone that supports the latest Android Auto features and comes with Android 11 or higher for wireless Android Auto functionality.
Compatible models: Cars with original wired CarPlay or Android Auto.
Resolution: adaptive (maintain original protocol resolution)
Language: Automatically switches according to the vehicle language environment.

CarPlay connection diagram (wireless connection)



Android Auto connection diagram (wireless connection)



Product indicator light description

- Green status: power indicator
- Blue status: successful connection

Connection instructions

1. Insert the product into the USB port of the car;
2. Turn on the WiFi and Bluetooth of the iPhone and search for the product Bluetooth connection;
3. Wait for the car to prompt for CarPlay connection, click Use CarPlay and enter the product UI interface;
4. When a reminder pops up on your iPhone, please click CarPlay;

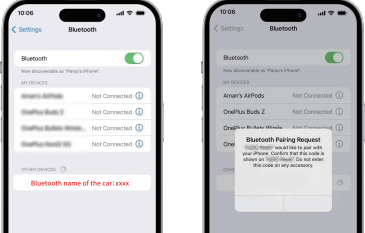

Wireless Android Auto connection instructions (no UI displayed)

1. Insert the product into the USB port of the car;
2. Turn on the WiFi and Bluetooth of the Android phone, and connect the Bluetooth of the product;
3. After the Android phone is connected, click the Android Auto option to enter wireless Android Auto;

Note: The car may pop up an Android Auto or Bluetooth connection prompt. Click to connect or enable. When wireless Android Auto is running, the phone will continue to establish a connection with the car's Bluetooth.

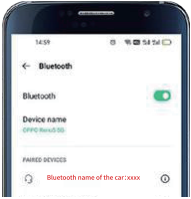

Android Auto considerations

1. Download and install the Android Auto application software in Google Play on your Android phone;
2. Check whether your Android phone is equipped with wireless Android Auto function;

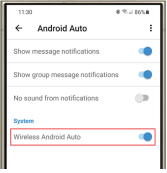

Online update version/problem feedback instructions

Steps to enter the background

- 1.Insert the product into the car USB port
- 2.Connect your iPhone to the product WiFi and enter the password "88888888" to join.
- 3.Use the browser that comes with your iPhone to enter 192.168.1.101 to enter the background.

(Note: Make sure your cell phone has mobile data before entering the browser)

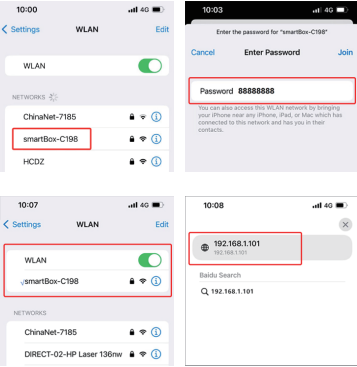

Click "Check for updates" (Figure 1)

- 1.You can check whether it is the latest version
- 2.You can update the latest version online.

(Note: If the product can be used normally, there is no need to update the version)

FCC Warning

This device complies with part 15 of the FCC Rules. Operation is subject to the following two conditions:(1) This device may not cause harmful interference, and (2) this device must accept any interference received, including interference that may cause undesired operation.

Any Changes or modifications not expressly approved by the party responsible for compliance could void the user's authority to operate the equipment. This equipment has been tested and found to comply with the limits for a Class B digital device, pursuant to part 15 of the FCC Rules. These limits are designed to provide reasonable protection against harmful interference in a residential installation. This equipment generates uses and can radiate radio frequency energy and, if not installed and used in accordance with the instructions, may cause harmful interference to radio communications. However, there is no guarantee that interference will not occur in a particular installation. If this equipment does cause harmful interference to radio or television reception, which can be determined by turning the equipment off and on, the user is encouraged to try to correct the interference by one or more of the following measures:

- Reorient or relocate the receiving antenna.
- Increase the separation between the equipment and receiver.
- Connect the equipment into an outlet on a circuit different from that to which the receiver is connected.
- Consult the dealer or an experienced radio/TV technician for help.

FCC RF exposure statement:

The equipment complies with FCC radiation exposure limits set forth for an uncontrolled environment. This equipment should be installed and operated with minimum distance between 20cm the radiator your body.