

说明书保护套 90\*90  
158g铜版纸 覆哑光膜

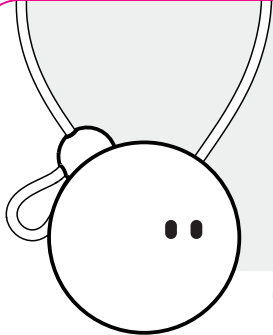

# BubblePal

## USER GUIDE



**WELCOME !!**  
to the wondrous world  
of Haivivi.

BubblePal can't wait to meet you!

Follow this magical bubble and embark on a  
journey filled with joy and surprises!



Scan the QR code with your mobile phone to  
download the HAIVIVI PAL App and start chatting  
with me following its instructions.

The conversation is entirely created by AI. Although fictional, it  
is full of fun and imagination.

## WARNING & CAUTIONS



Children under the age of 3 should not use this product  
unsupervised.



Do not use, store, or charge the product in direct sunlight,  
near heat sources, or in high-temperature environments.  
Instead, keep the product in a cool, dry place.



This product is not waterproof; do not wash it with water or  
immerse it in water.



The product contains a pure cobalt battery. Please keep it  
away from fire or heat sources.



Please dispose of the product's packaging properly to  
prevent infants and toddlers from accessing it and  
potentially suffocating.

Please read this entire document before you begin and keep it for  
future reference.

## GET STARTED WITH BUBBLEPAL

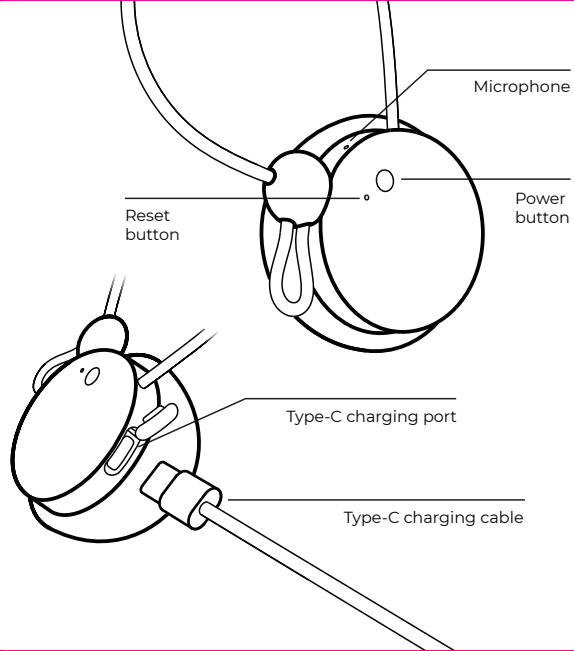
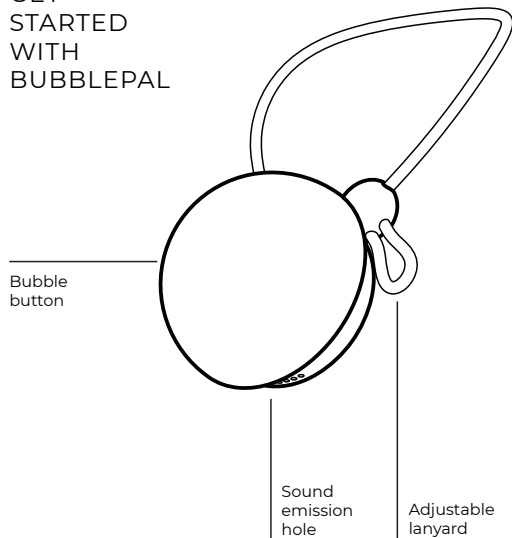

### 1 Power on

Press and hold the "Power Button" on the back of the device for 3 seconds while it is turned off. The device is successfully powered on when the bubble light turns on.

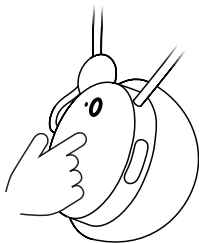

### 2 Download the App

Scan the QR code or use the Mobile App Store to search for and download the HAIVIVI PAL App.



### 3 Connect to the Device

Follow the instructions to connect to the BubblePal.

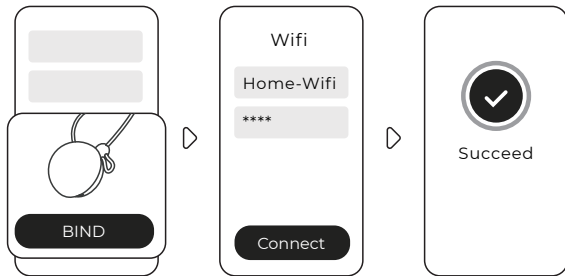

#### 4 Start the Conversation!

Attach BubblePal to the designated toy and press, hold the bubble button to start talking; release to send the message.

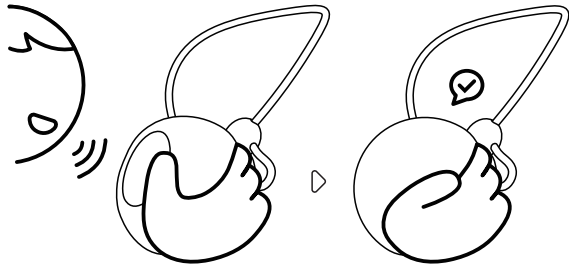

Hold to Talk

Release to Send

#### Volume Adjustment

Rotate the dial to adjust the volume. Turn clockwise to increase the volume and counterclockwise to decrease it.

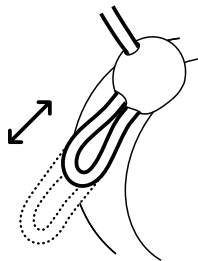
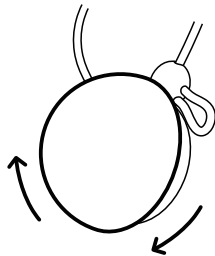

#### Lanyard Length Adjustment

Adjust the length of the lanyard by pulling it up or down to accommodate toy of different sizes.

## CHARGING & BATTERY

Connect the charging cable to the charging port of this product and use it with a regular charger marked with a 5V=1A rating and compliant with the national CCC certification (to be purchased separately) to charge this product.

The product cannot be turned on when the battery is low. It can be turned on once the charging is complete.

It takes approximately 120 minutes\* to fully charge the battery.

### Caution

- The BubblePal contains a pure cobalt battery. Keep it away from fire.
- Do not charge for more than 6 hours continuously. Ensure supervision during charging and avoid charging when leaving for extended periods.
- Regularly inspect the charging cable for abnormalities. Stop use immediately if any are found to prevent electric shock, short-circuiting, or fire.

- Avoid using, storing, or charging BubblePal in direct sunlight, near heat sources, or in high-temperature environments. Keep it in a cool, dry place.

\* Note: Charging time may vary depending on the charger and the device's battery level.

\* The 120-minute full charge time is based on HAIVIVI laboratory data and may vary due to various factors.

## SAFETY INSTRUCTIONS

- Adult supervision and guidance are required when children use BubblePal.
- Before use, check for any damage, ensure proper installation, and verify normal operation. Contact after-sales service for any issues.
- Avoid colliding, impacting, compressing, or puncturing the BubblePal.
- Do not disassemble, repair, or modify BubblePal yourself.
- Do not use BubblePal or its accessories if damaged or broken.
- Do not charge for more than 6 hours continuously. Ensure supervision during charging and avoid charging when leaving for extended periods.
- Regularly inspect the charging cable. Stop use immediately if any abnormalities are found to prevent electric shock, short-circuiting, or fire.
- Do not clean the BubblePal while it is turned on or charging.
- Do not clean with saltwater, hot water, compressed air, steel wool, abrasive cleaners, or corrosive liquids (e.g., gasoline or acetone).

## CLEANING

- Turn off the BubblePal before cleaning. For routine cleaning, use a soft cloth dampened with tap water to clean the device's body. After cleaning, thoroughly dry the device.
- Do not clean the BubblePal while it is turned on or charging.
- Do not clean with saltwater, hot water, compressed air, steel wool, abrasive cleaners, or corrosive liquids (e.g., gasoline or acetone).

## ENVIRONMENTAL CARE

When disposing of the BubblePal, do not mix it with general household waste. Instead, bring it to a government-designated recycling center to help protect the environment.



# PRODUCT INTRODUCTION

Product Name	BubblePal AI Companion Toy
Product Model	H-100
Product Material	Food-grade silicone, ABS
Dimensions	53*57*40mm
Charging Input	5V ---1A
Rated Voltage	3.85V
Rated Power	5W
Battery Type	Pure Cobalt Battery
Battery Capacity	720mAH
Country of Origin	China

# PRODUCT CONTENTS

BubblePal	1 unit
Type-C Charging Cable	1 unit
Product Manual	1 unit

## DISCLAIMER & IMPORTANT INFORMATION

Congratulations on purchasing your BubblePal. This document sets out important information about using the product safely as well as information about the HAIVIVI warranty.

You must ensure that anyone you allow to use your BubblePal is aware of the health and safety warnings set out in this document. For the latest product information and updates, please go to <https://www.haivivi.com> and visit the official page of this product.

You and your guest users agree to use this product only for purposes that are in accordance with all applicable local laws, rules, and regulations as well as all the terms, precautions, practices, policies and guidelines HAIVIVI has notified to you.

HAIVIVI is not responsible for your use of third-party content, or any content or functions contained in third-party content accessed by you when using BubblePal. You must comply with all recommendations and guidance relating to such third-party software. Your obligations and rights when using and accessing third party content are solely governed by your agreements between yourself and those providers.

You must also comply with any mobile phone use warnings and guides notified to you by the manufacturer of your mobile phone

when using BubblePal.

HAIVIVI aftersales and warranty information is available at: [support@haivivi.com](mailto:support@haivivi.com)

# THE GLASSES LIMITED WARRANTY

## User Information

User Name:
Address:
Email:
Phone Number: (Including area code)

## Product Information

S/N:
Place of Purchase:
Date of Purchase:

## Warranty

- The BubblePal is manufactured under strict quality control standards.
- Product exchanges and refunds are only available at the original point of purchase.
- Under normal use, non-artificial quality issues during the warranty period will be repaired free of charge.
- Please keep this warranty card in good condition, free from smudges and alterations.

## Exclusions from Warranty

- Expired warranty period.
- Damage caused by human factors, such as physical damage or liquid ingress.
- Disassembly, repair, or unauthorized modifications by personnel not authorized by HAIVIVI.
- Damage caused by fire, flood, lightning, and other force majeure events.

- Resale of BubblePal.
- Use of BubblePal in violation of any law or your agreement with HAIVIVI.
- Failures and damages caused by factors unrelated to the product's design, manufacturing, or quality.
- Other exclusions as specified in the after-sales warranty policy.

Manufacturer: Shenzhen Haivivi Technology Co.,LTD  
 Official Website: [www.haivivi.com](http://www.haivivi.com)  
 Email: [customerservice@haivivi.com](mailto:customerservice@haivivi.com)

This equipment has been tested and found to comply with the limits for a Class B digital device, pursuant to part 15 of the FCC Rules. These limits are designed to provide reasonable protection against harmful interference in a residential installation. This equipment generates, uses and can radiate radio frequency energy and, if not installed and used in accordance with the instructions, may cause harmful interference to radio communications. However, there is no guarantee that interference will not occur in a particular installation. If this equipment does cause harmful interference to radio or television reception, which can be determined by turning the equipment off and on, the user is encouraged to try to correct the interference by one or more of the following measures:

- Reorient or relocate the receiving antenna.
- Increase the separation between the equipment and receiver.
- Connect the equipment into an outlet on a circuit different from that to which the receiver is connected.
- Consult the dealer or an experienced radio/TV technician for help.

Caution: Any changes or modifications to this device not explicitly approved by manufacturer could void your authority to operate this equipment.

This device complies with part 15 of the FCC Rules. Operation is subject to the following two conditions:

(1) This device may not cause harmful interference, and (2) this device must accept any interference received, including interference that may cause undesired operation.

This equipment complies with FCC radiation exposure limits set forth for an uncontrolled environment. This equipment should be installed and operated with minimum distance 0cm between the radiator and your body.