

USER MANUAL

Drmpry



CUSTOMER SUPPORT:

service@drmpry.com

Model: L1

Open-Ear Headphones

Product Features

Under charge, the red light is steady on

In the fully charged state, blue light on

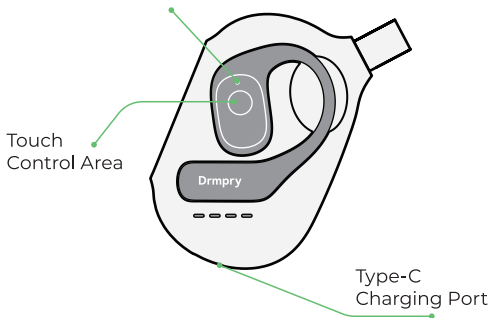

How To Connect

Notes:

1. Turn on Bluetooth on your phone.

Bluetooth



2. Ensure that your phone/computer or other devices are not connected to other audio devices and that the earphones are not connected to other devices.
3. Ensure the earphones' status lights are flashing and have sufficient battery.
4. Placing both earphones back into the charging case and reopening it can solve 90% of pairing problems.

First-time Connection

1. Open the charging case. This will power on the earphones and activate pairing mode automatically. Take the earphones out of the charging case to begin using them.
2. Wear earphones.

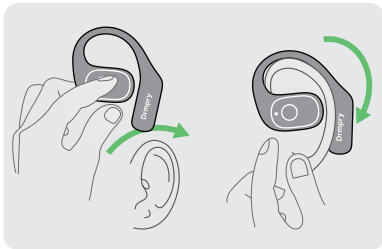
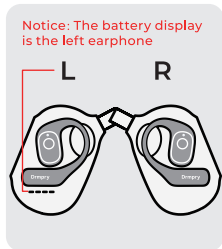

3. Turn on Bluetooth on your phone. Find the name "**L1-OPEN**" on the Bluetooth device list. Select to initiate active pairing.
4. When you hear the voice prompt "**Connected**," it means the connection is successful.

Note:

If the earphones have been connected to your device before, they will automatically reconnect when you use them again with the Bluetooth setting turned on. This saves time and hassle of having to manually connect the earphones each time you use them.

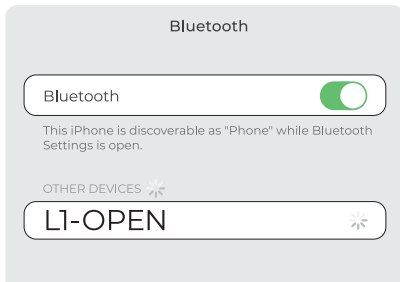

Specifications

Brand Name: Drmpy

Model: L1

Bluetooth Device Name: L1-OPEN

Input Interface: USB-A male/equipped with USB-A TYPE-C external adapter

Input Voltage: 5 V

Bluetooth Module Frequency: Bluetooth V5.3

Support Bluetooth Version: Bluetooth HSP, HFP, A2DP, AVRCP

Driver Unit Size: 14.2x14.2mm

Charging Case Battery Capacity: 300mAh

Single Earphone Battery Capacity: 50mAh

Warranty Period: 12 Months

 CUSTOMER SUPPORT: service@drmpy.com

What's In The Box?

- | | |
|-----------------------------|-----------------------------|
| 1. Open-Ear Headphones × 2 | 4. Product Carrying Bag × 1 |
| 2. Charging Case × 1 | 5. Quick Guide × 1 |
| 3. USB-C Charging Cable × 1 | 6. User Manual × 1 |

Customer Support

Hello, Our Valued Customer,

Thank you for choosing Drmpy. We are honored to be a part of your audio experience and look forward to serving you for many years to come.

As a token of our appreciation, we pledge to provide you "VIP" customer service throughout your journey with our product. Should you have any questions or concerns, please do not hesitate to reach out to our dedicated support team. If you encounter any of the issues listed below, we are here to help you immediately.

Such As

1. Unable to connect to the device.
2. The charging case's battery does not last long enough.
3. Touch control malfunction/insensitivity.
4. The headphones don't feel comfortable or secure when you wear them.
5. Other issues...

CONTACT US

1. Email: service@drmpry.com
2. By scanning the QR code below, you can enjoy the following VIP benefits:
 - a. Extend the warranty period to 2 years
 - b. Promotional activities and VIP discounts
 - c. View Product Deals
 - d. Get Drmpry's latest product offerings



Contact us to extend after-sales
E-mail: service@drmpry.com

Function	Operating Instructions	Beep
Power on	Automatic: The earphones automatically turn on and enter pairing mode when taken out from the charging case.	Power on
Pairing mode	Open the charging case cover and the earphones will automatically enter pairing mode. The earphones are waiting for the device to pair.	
Paired successfully (with phone)		Connected
Switching Bluetooth pairing devices	Disconnect the original connected device. Open the charging case cover, and the earphones will automatically enter pairing mode to pair with the new device again.	Connected
Disconnect	The earphones go beyond the Bluetooth range and are disconnected. Enter the reconnection mode (automatically reconnected when entering Bluetooth range). If not reconnected within 10 minutes, the earphones will automatically power off.	Disconnected

Disconnect	Manually turn off the Bluetooth device, enter search pairing mode, enable device Bluetooth automatic reconnection (enable phone reconnection, it needs to be done with the phone's built-in reconnection, and the earphones will not initiate reconnection). If not paired successfully within 10 minutes, the earphones will automatically power off	Disconnected
Automatic reconnection	Within 5 seconds of powering on, the earphones automatically enter the reconnection mode. When entering the reconnection mode, the pairing status can be detected. If the reconnection fails within 10 seconds, the Bluetooth device will no longer be reconnected.	Pairing
		Connected
Failed to reconnect	If the reconnection fails, immediately enter search pairing mode 10 minutes of unsuccessful Bluetooth pairing, automatic (synchronized) shutdown	
Shutdown	Automatic: Automatically shut down when placed in the charging case (left and right earphones will not power off synchronously).	
Activate Siri	Release the activation touch button after 5 clicks on the left and right ear buttons.	"Dong"
Close Siri	Press the left and right earphone touch button 5 times and release to close Siri.	"Dong"

Clear phone Bluetooth pairing records	Continuous fast 8 clicks on left/right earphones.	"Dong"
Switching between primary and secondary headphones	When the left and right earphones are paired, the right ear is the main ear (the right ear LED indicates Pairing/right ear MIC pickup). Insert/remove any earphone, and the other earphone will not disconnect the phone link	"Dong"
DUT mode	Press the multifunction key 6 times in a row while turning on the device	"Dong"
Play/Pause	Double click the left or right earphone touch button.	"Dong"
Previous Track	Three clicks on the left earphone touch button.	"Dong"
Next Track	Three clicks on the right earphone touch button.	"Dong"
Increase volume	Long press the right earphone touch button.	"Dong"
Reduce volume	Long press the left earphone touch button.	"Dong"
Switching between primary and secondary headphones	When the left and right earphones are paired, the right ear is the main ear (the right ear LED indicates Pairing/right ear MIC pickup). Insert/remove any earphone, and the other earphone will not disconnect the phone link	"Dong"

Incoming call	The iOS system comes with a built-in prompt tone, and the Android system specifies a call prompt tone for customers.	
Answer phone calls	Click on the left or right earphone touch button.	"Dong"
Call rejection	Long press the left or right earphone touch button for 2 seconds.	"Dong"
Hang up call	Double click the left or right earphone touch button.	"Dong"
Keep the first call and connect the second call	Double click the left or right earphone touch button.	"Dong"
Swap calls	Long press the touch button on the left or right earphones for 2 seconds and release the prompt sound "dong".	"Dong"
Hang up the current call and connect to another call	Click on the left or right earphone touch button.	"Dong"
Reject second call	Long press the touch button on the left or right earphones for 2 seconds and release the prompt sound "dong".	"Dong"

FCC Caution

This device complies with part 15 of the FCC Rules. Operation is subject to the following two conditions:

- (1) This device may not cause harmful interference, and
- (2) this device must accept any interference received, including interference that may cause undesired operation.

Any Changes or modifications not expressly approved by the party responsible for compliance could void the user's authority to operate the equipment.

Note: This equipment has been tested and found to comply with the limits for a Class B digital device, pursuant to part 15 of the FCC Rules. These limits are designed to provide reasonable protection against harmful interference in a residential installation. This equipment generates uses and can radiate radio frequency energy and, if not installed and used in accordance with the instructions, may cause harmful interference to radio communications. However, there is no guarantee that interference will not occur in a particular installation. If this equipment does cause harmful interference to radio or television reception, which can be determined by turning the equipment off and on, the user is encouraged to try to correct the interference by one or more of the following measures:

- Reorient or relocate the receiving antenna.
- Increase the separation between the equipment and receiver.
- Connect the equipment into an outlet on a circuit different from that to which the receiver is connected.
- Consult the dealer or an experienced radio/TV technician for help.

The device has been evaluated to meet general RF exposure requirement. This equipment should be installed and operated with minimum distance 0mm between the radiator & your body.



V1.0

Made in China