

特斯拉线圈 10 Mini 使用指南

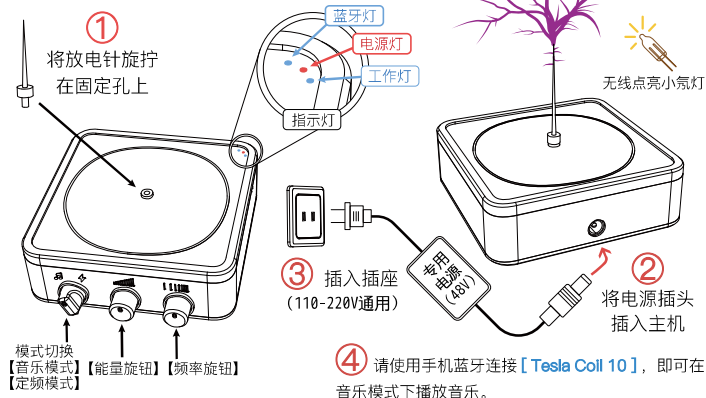

注意

- 1、未成年人请在监护人陪同下使用。
- 2、放电针比较尖，不要戳到自己。
- 3、闪电有热量，请勿靠近易燃易爆品。
- 4、勿在顶面放置东西，可能导致外壳烧坏。

苹果手机播放音乐前需先打开【设置】→【声音与触感】→【耳机安全】→禁用【降低高音量】选项。
播放普通音乐不会损坏设备，只是效果不佳，建议使用方波音乐，扫码获取方波音乐。



方波音乐二维码

特斯拉线圈 10 Mini 产品清单

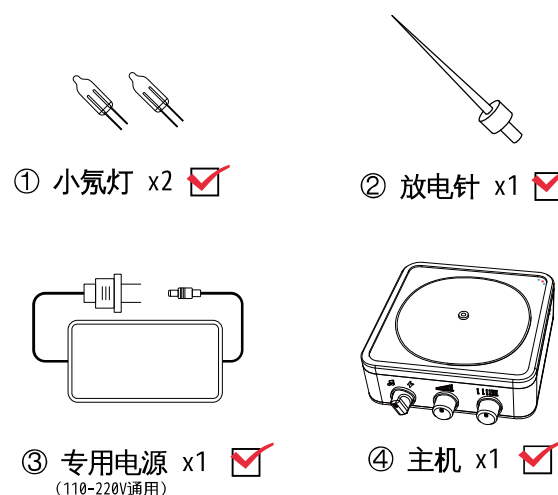

Tesla coil 10 Mini Instructions

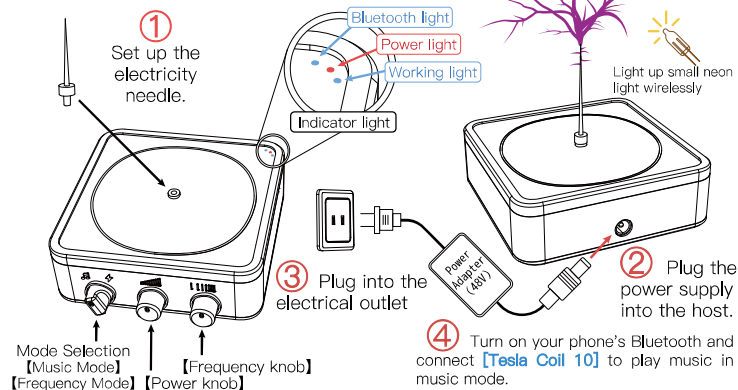

Attention

- 1、Minors should be accompanied by parents.
- 2、Electricity needle is very pointed, be careful.
- 3、Keep away from flammable and explosive items.
- 4、Do not place objects on the coil, which may cause the coil to blacken.

Use iPhone to playing music, need to open 【Settings】→【Sound & Haptics】→【Headphone Security】→ Disable 【Reduce Loud Sounds】.
Play ordinary music does not damage the device, just the effect is not good, we recommend using square wave music, scan the code to get square wave music.
(QR code is on the next page)

Tesla coil 10 Mini Product List

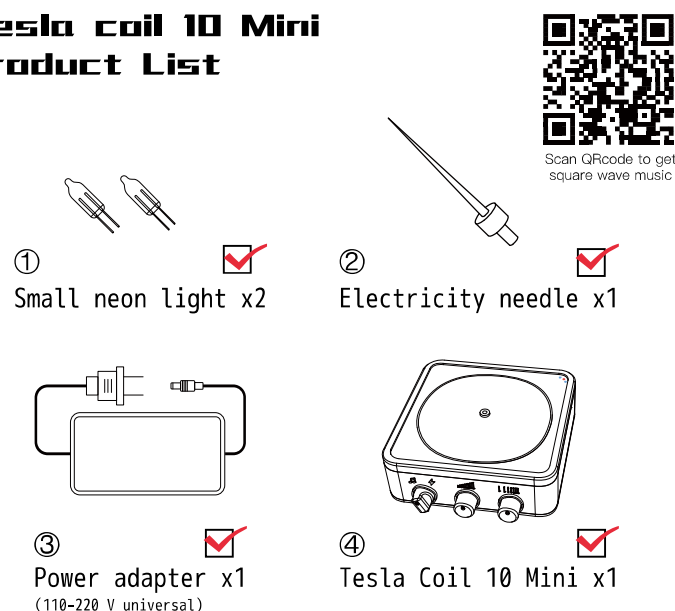

FCC Warning:

This equipment has been tested and found to comply with the limits for a Class B digital device, pursuant to part 15 of the FCC Rules. These limits are designed to provide reasonable protection against harmful interference in a residential installation. This equipment generates, uses and can radiate radio frequency energy and, if not installed and used in accordance with the instructions, may cause harmful interference to radio communications. However, there is no guarantee that interference will not occur in a particular installation. If this equipment does cause harmful interference to radio or television reception, which can be determined by turning the equipment off and on, the user is encouraged to try to correct the interference by one or more of the following measures:

- Reorient or relocate the receiving antenna.
- Increase the separation between the equipment and receiver.
- Connect the equipment into an outlet on a circuit different from that to which the receiver is connected.
- Consult the dealer or an experienced radio/TV technician for help.

Caution: Any changes or modifications to this device not explicitly approved by manufacturer could void your authority to operate this equipment.

This device complies with part 15 of the FCC Rules. Operation is subject to the following two conditions:

(1) This device may not cause harmful interference, and (2) this device must accept any interference received, including interference that may cause undesired operation.

This equipment complies with FCC radiation exposure limits set forth for an uncontrolled environment. This equipment should be installed and operated with minimum distance 0cm between the radiator and your body.