

User's Guide



Android technology platform



SAR tests are conducted using standard operating positions accepted by the FCC with the phone transmitting at its highest certified power level in all tested frequency bands, although the SAR is determined at the highest certified power level, the actual SAR level of the phone while operating can be well below the maximum value, in general, the closer you are to a wireless base station antenna, the lower the power output.

Before a new tablet is available for sales to the public, it must be tested and certified to the FCC that it does not exceed the exposure limit established by the FCC.

Tests for each tablet are performed in positions and locations (e.g. at the ear and worn on the body) as required by the FCC.

For body worn operation, this model tablet has been tested and meets the FCC RF exposure guidelines when used with an accessory designated for this product or when used with an accessory that contains no metal and that positions the handset a minimum of 1.0cm from the body.

Non-compliance with the above restrictions may result in violation of RF exposure guidelines.

EC	REP	eVatmaster Consulting GmbH Bettinastr.30 60325 Frankfurt am Main, Germany contact@evatmaster.com
----	-----	---



Made in China

SAFETY INFORMATION

Transportation Safety

Please observe all transportation laws and regulations

Hospital Safety

The Tablet PC must be turned off when you are in a hospital.

You have to abide by the relevant regulations of hospital and turn your device off when you are near medical equipment. Any wireless transmission device will interfere that equipment not fully-protected.

Airport Safety

Remember to follow all airport and flight safety regulations.

Water Hazard

Your tablet is not waterproof. Keep your tablet away from water or liquid to avoid damage.

Emergency Calls

Make sure your tablet is switched on and in a service area. In home screen, tap the phone key and dial the emergency number.

Battery Usage

For better performance and longer battery life, it is recommended that you charge the battery fully 7 hours before using the tablet for the first time and that you initially complete two to three charge cycles. Battery life will vary based on device settings, usage, and others. Certain apps may reduce battery life.

KEY FUNCTIONS

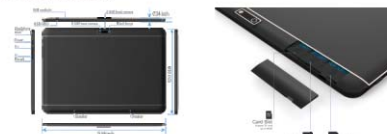

Model 1: 3G/WIFI Tablet (2 SIM Card Slot +1 SD Card Slot)



Model 2: WIFI Tablet (Only One TF Card Slot)



Model 3: WIFI Tablet (Only One TF Card Slot)

Recovery Mode means restore the factory settings, press the power button to confirm, the system will automatically complete this process, automatically restart. (ALL DATA WILL BE LOST)
Fastboot Mode means development mode, not recommended.
Normal Boot means normal restart, no data loss.

WARNING:

Any changes or modifications without permission which operated by unauthorized user will result in internal failure, system halted.

This device complies with parts 15 of the FCC Rules.

Operation is subject to the following two conditions: (1) This device may not cause harmful interference, and (2) this device must accept any interference that may cause undesired operation.

Note: This equipment has been tested and found to comply with the limits for a Class B digital device, pursuant to Part 15 of the FCC Rules. These limits are designed to provide reasonable protection against harmful interference in a residential installation. This equipment generates, uses and can radiate radio frequency energy and, if not installed and used in accordance with the instructions, may cause harmful interference to radio communications. However, there is no guarantee that interference will not occur in a particular installation. If this equipment does cause harmful interference to radio or television reception, which can be determined by turning the equipment off and on, the user is encouraged to try to correct the interference by one or more of the following measures:

- Reorient or relocate the receiving antenna.
- Increase the separation between the equipment and receiver.
- Connect the equipment into an outlet on a circuit different from that to which the receiver is connected.
- Consult the dealer or an experienced radio/TV technician for help.

To insert SIM / SD card

1. Push the SIM card slot cover out and insert the SIM card into SIM card slot.
2. Insert the SD card (For additional storage capacity)
3. Put back the card cover and power on the Tablet.

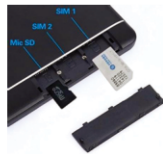

RESET OPERATION

If you forgot your password or need to clear your password, please follow the below steps to do it.

1. Please turn off the tablet
2. Press the power button and the volume down button simultaneously
3. Press the volume down button to select Clear eMMC
4. Power on button confirms reset (you will see the follow picture)

Select Boot Mode :
[VOLUME_UP to Select. VOLUME_DOWN is OK]
[Recovery Mode]
[Fastboot Mode]
[Normal Boot]

INTRODUCTION

When you initially power on your tablet, there will be a series of steps to set up basic features.

SELECT LANGUAGE

While on the welcome screen, please scroll to select your language.

SELECT WI-FI

This process allows the device to connect to the internet.

Click on the Wi-Fi name you need to link and enter the WiFi password, that the device will be connected to. Please note that any

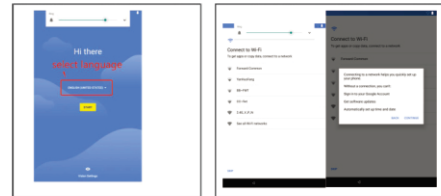

unsecured Wi-Fi network can be connected to directly and any secured Wi-Fi network require a password for credentials prior to connect, it's recommended that you connect to a Wi-Fi network to check for software update prior to startup.

SET DATE & TIME

Adjust the date and time to local time if needed

ADD YOUR ACCOUNT

Sign in to your Google account in order to keep accounts streamlined with Google services. Your Gmail account will be used for some Google programs. If you don't have a Google account, click to create a new account. In this step you can also setup payment info if needed.



SET SCREEN LOCK

Please choose to skip screen lock or be sure to use the password you can remember.

And If you forgot the password or need to clear your password, please see the **RESET OPERATION**.

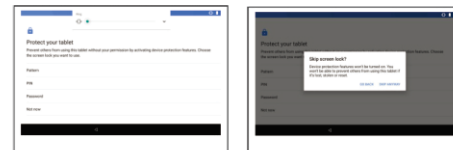

RESTORE APPS & DATA

You can restore your previous applications and data that have been backed up from another device. You may also setup the tablet as a new device.

GOOGLE SERVICES

Click to add or remove Google services which include backup, Location Service, and Google Now.

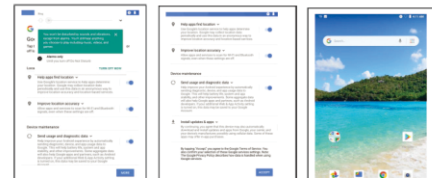

Installation of the SIM Card (Notice:3G/WiFi tablet can connect internet via WIFI, Bluetooth or sim card. If you would like to make calls, you have to put sim card into the slot, otherwise, you can only use WIFI)

Warning: Please keep the SIM card out of the reach of children, the SIM card and its contact are easily damaged due to scratching or bending. Please use cautiously when carrying, installing or taking out the SIM card.

Note: Please contact your cellular phone service provider directly to obtain your SIM card.