

# VERTU

ENGLAND

## INSTRUCTIONS FOR USING THE SMART LUGGAGE FINGERPRINT LOCK



Click to turn page



# PRODUCT INTRODUCTION

## PRODUCT INFO

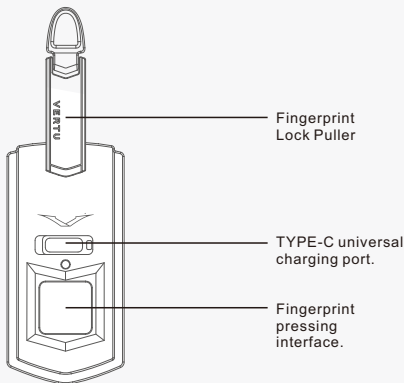

Front of fingerprint lock

## SPECIFICATIONS

Charging current	DC5V
Battery capacity	260MAH
Fingerprint capacity	10 Groups
Fingerprint collection time	$\leq 500\text{mS}$
Fingerprint matching time	$\leq 1000\text{mS}$
False rejection rate	$\leq 1\%$
False acceptance rate	$\leq 0.02\%$
Bluetooth connection distance	$\leq 15\text{m}$
Operating temperature	-20-55 °C
Working humidity	40%RH-90%RH

# WARM REMINDER

## IMPORTANT NOTICE

Please charge the product first before fingerprint enrollment.

Before fingerprint enrollment, any fingerprint can unlock the lock. After fingerprint enrollment, only the enrolled fingerprints can unlock the lock.

## OPERARTIONAL INSTRUCTIONS

Turn on your phone's Bluetooth, open WeChat, search for the Mini programs vertu smart and open it, follow the prompts to register your account and log in (Figure 1).

### 1、ADD DEVICE

Turn on your phone's Bluetooth, open WeChat, search for the Mini programs vertu smart and open it, follow the prompts to register your account and log in (Figure 1).

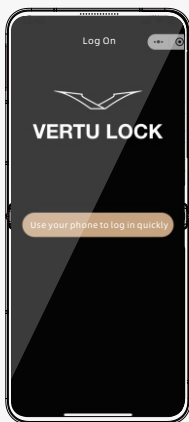

(Figure 1 )

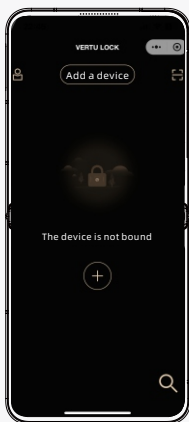

(Figure 2 )

Click to turn the page



Click on the next page



## 2 、 Binding device

(Figure 3) After clicking “ BLE-Lock ” to bind, the interface jumps to the add device interface (Figure 4).

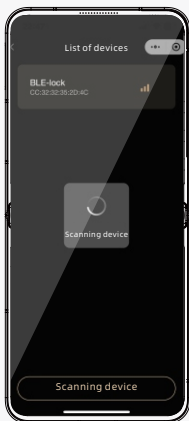

(Figure 3 )

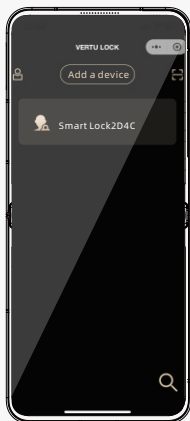

(Figure 4 )

## 2、Binding device

select the “ smart lock \*\*\*\* ” to enter the main interface (Figure 5), and connect the Bluetooth (showing the power, Bluetooth connection icon), the lock emits a beep sound and the green light lights up for a second.

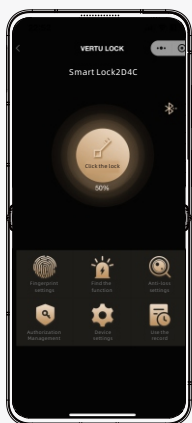

(Figure 5 )

### 3、ADD USER FINGERPRINT

Figure 5) Click "Fingerprint Settings" to enter "Fingerprint Management" interface (Figure 6). Click "Add Fingerprint", enter the desired name (Figure 7)

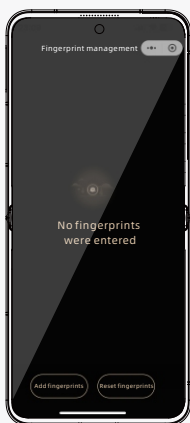

(Figure 6 )

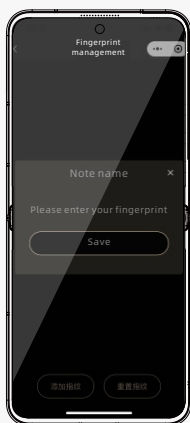

(Figure 7 )

### 3、ADD USER FINGERPRINT

and click “ Save ” to jump to the next interface (Figure 8). Press your finger on the fingerprint identification area, the blue light will turn on and a beep will sound, then enter the fingerprint recording interface (Figure 9). Press the same finger with different position for 5 times, the program will pop up the interface of “ Fingerprint added successfully ” (Figure 10)

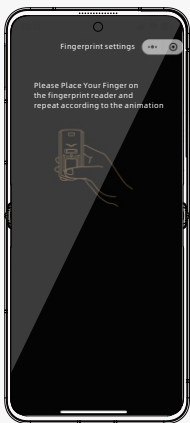

(Figure 8 )



(Figure 9 )

### 3、ADD USER FINGERPRINT

click “ OK ” to jump to the fingerprint management interface (Figure 11), and display the fingerprints that have just been recorded, and you can record 10 sets of fingerprints.

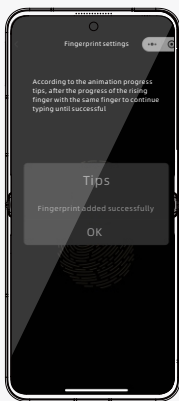

(Figure 10 )



(Figure 11 )



## 4、UNLOCKING

- 4.1 Bluetooth unlocking: (Figure 5) you can click on the “unlock” icon, the interface pops up “unlocking” pops up “unlocked” (Figure 22), while the lock beeps! The green light will be on for a while, and the lock will be opened at the same time.
- 4.2 Fingerprint unlocking: Press the finger that has been recorded fingerprints on the fingerprint identification area to unlock, accompanied by a green light as well as a beeping sound, otherwise the red light flashes.

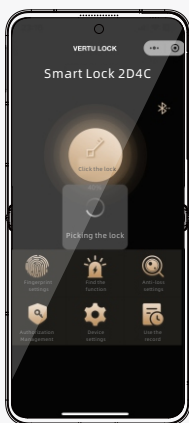

(Figure 21 )

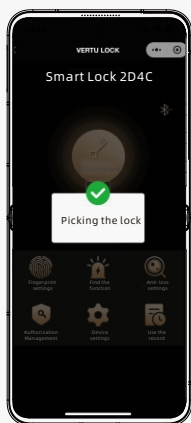

(Figure 22 )

## 5、DELETE FINGERPRINTS

5.1 Delete individual fingerprints: (Figure 5) Click “Fingerprint Settings” to enter “Fingerprint Management” interface (Figure 11), and a message “Cannot be recovered after deletion” pops up (Figure 12). After confirming, the current fingerprint will be deleted

5.2 Delete all fingerprints: (Figure 11) Click “Reset Fingerprints”, it will pop up “This operation will clear the fingerprints, do you want to confirm?” (Figure 13), after confirming, all fingerprints will be deleted.

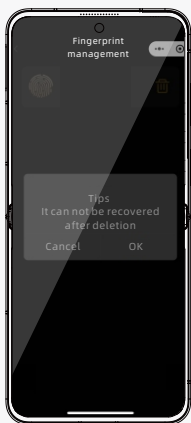

(Figure 12 )

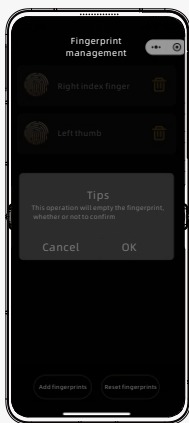

(Figure 13 )

## 6、SEARCH FUNCTIONS

(Fig. 5) Click “Search Function” to pop up the search setting interface (Fig.14)

6.1 Select “10 seconds alarm” , the lock will emit a long beep sound, accompanied by blue light flashing, and stop after 10 seconds.

6.2. Select “Continuous Alarm” , the lock will keep on beeping and flashing with blue light until the point of “Turn off Alarm” to stop.

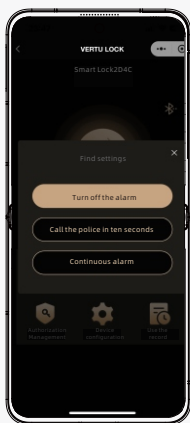

(Figure 14 )

## 7 、 ANTI-LOSS FUNCTION

(Figure 5) Click “ Anti-Loss Settings ” to enter the device settings interface (Figure 15), open the “ Bluetooth Disconnect Alarm ” (Figure 16),

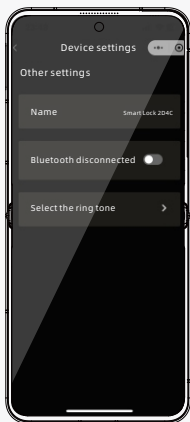

(Figure 15 )

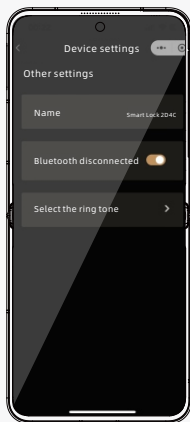

(Figure 16 )

## 7、ANTI-LOSS FUNCTION

exit back to the main interface (Figure 5). At this time, if the lock is far away from the Bluetooth connection range, the phone will emit a corresponding alarm sound, when reconnecting or exiting the main interface, the alarm ringing will stop.

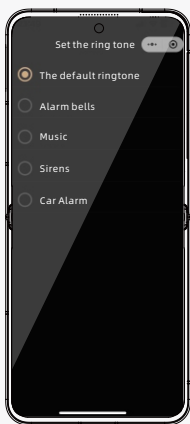

(Figure 17 )



(Figure 18 )

## 8、AUTHORIZATION MANAGEMENT

(Figure 5) Click “ Authorization Management ” to enter the authorization management interface (Figure 18).

8.1 Permanent Authorization: (Figure 18) Click “ Permanent Authorization ” to enter the interface, enter the user account and name you want to authorize (Figure 20), and then click “ Send ” , the authorized user has the right to connect to Bluetooth and unlock always.

8.2 One-time authorization: (Figure 19) Click “ One-time authorization ” to enter the interface, enter the user account and name you want to authorize (Figure 20), then click “ Send ” , the authorized user can only connect to Bluetooth and unlock once.

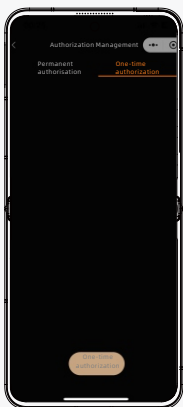

(Figure 19 )

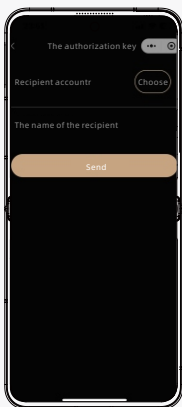

(Figure 20 )

## 9、USAGE RECORD

(Figure 5) Click “ Usage Records ” to enter the usage records interface (Figure 23), you can view all the Bluetooth unlocking fingerprint unlocking and disconnection records, Click the corresponding records to find the location of the time (Figure 24) 。

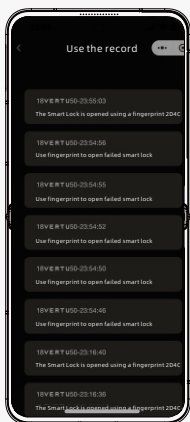

(Figure 23 )



(Figure 24 )

## 10、EQUIPMENT SETTINGS

(Figure 5) Click “ Device Settings ” to pop up the device settings interface (Figure 25).10.1 Modify the setting name:  
(Figure 25) Click “ Modify Name ” , enter the device name  
(Figure 26) and click “ Submit ”

10.2. Unbind administrator: (Figure 25) Click “ Unbind administrator ” , a prompt “ Do you want to unbind? ” will pop up. (Figure 27) If you click “ Confirm ” , the lock will be unbound successfully, and restored to factory settings, any finger can unlock the lock..



(Figure 25 )

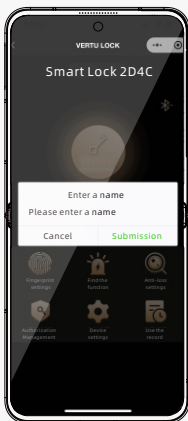

(Figure 26 )



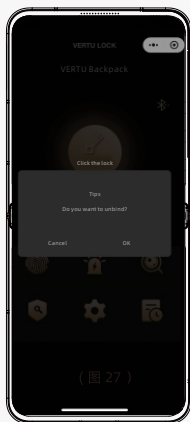

(Figure 27 )

## LOW VOLTAGE PROMPT

When the voltage is lower than 3.5V, the relight will flash after unlocking, and you can't record fingerprints at this time , please charge it in time.

## 12 、 RECHARGE

DC5V charging, the red light is long on when charging, the light is off when fully charged.

## **FCC Caution**

This device complies with part 15 of the FCC Rules. Operation is subject to the following two conditions:

- (1) This device may not cause harmful interference, and
- (2) this device must accept any interference received, including interference that may cause undesired operation.

Any Changes or modifications not expressly approved by the party responsible for compliance could void the user's authority to operate the equipment.

Note: This equipment has been tested and found to comply with the limits for a Class B digital device, pursuant to part 15 of the FCC Rules. These limits are designed to provide reasonable protection against harmful interference in a residential installation. This equipment generates uses and can radiate radio frequency energy and, if not installed and used in accordance with the instructions, may cause harmful interference to radio communications. However, there is no guarantee that interference will not occur in a particular installation. If this equipment does cause harmful interference to radio or television reception, which can be determined by turning the equipment off and on, the user is encouraged to try to correct the interference by one or more of the following measures:

- Reorient or relocate the receiving antenna.
- Increase the separation between the equipment and receiver.
- Connect the equipment into an outlet on a circuit different from that to which the receiver is connected.
- Consult the dealer or an experienced radio/TV technician for help.

The device has been evaluated to meet general RF exposure requirement. The device can be used in portable exposure condition without restriction.