

FCC Warning

This device complies with part 15 of the FCC Rules. Operation is subject to the following two conditions: (1) This device may not cause harmful interference, and (2) this device must accept any interference received, including interference that may cause undesired operation.

Any Changes or modifications not expressly approved by the party responsible for compliance could void the user's authority to operate the equipment.

Note: This equipment has been tested and found to comply with the limits for a Class B digital device, pursuant to part 15 of the FCC Rules. These limits are designed to provide reasonable protection against harmful interference in a residential installation. This equipment generates uses and can radiate radio frequency energy and, if not installed and used in accordance with the instructions, may cause harmful interference to radio communications. However, there is no guarantee that interference will not occur in a particular installation. If this equipment does cause harmful interference to radio or television reception, which can be determined by turning the equipment off and on, the user is encouraged to try to correct the interference by one or more of the following measures:

- Reorient or relocate the receiving antenna.
- Increase the separation between the equipment and receiver.
- Connect the equipment into an outlet on a circuit different from that to which the receiver is connected.
- Consult the dealer or an experienced radio/TV technician for help.

This equipment complies with FCC radiation exposure limits set forth for an uncontrolled environment. This equipment should be installed and operated with minimum distance 20cm between the radiator & your body.



tonepie

Ti⁺M

Smart cat litter box

User Manual

Contents



User notification & Safe Use Guidelines 02

- User notification
- Safe Use Guidelines

Components and accessories list 03

Panel and Keys 04

Use instructions 05-08

- Inspect litter box and accessories
- Proper placement of litter box
- Power on & self-check
- Networking settings
- Add cat litter
- Ionic deodorization
- Installation and replacement of garbage bags

Litter box Cleaning 09

- One key for replacing litter
- Cleaning

Parameters and Specifications 10



User notification

1. Thank you for using the Tonepie smart cat litter box. Tonepie is committed to creating a beautiful experience of "carefree pet care and clean life" for you.
2. Before use, please carefully read the manual. Once installed and used, it means that you have carefully read and accepted the following safety instructions.
3. Our company is not responsible for any accidents or losses caused by abnormal operations.
4. The explanation and modification rights of this manual belong to Hefei Jiqu Network Technology Co., Ltd.

Safe Use Guidelines

 Failure to comply with the following terms may result in the litter box being unable to function properly or other unexpected losses.

1. Please strictly follow the instructions for installing and using the litter box.
2. Litter box placement requirements: Please place the litter box on a firm and flat ground, do not rely on objects or walls, to avoid affecting the weighing. Please do not place anything on the top of the litter box.
3. Litter box movement requirements: This litter box has four weight sensors at the bottom. Please do not drag when moving it to avoid damage.
4. Cat litter selection: This litter box is suitable for small diameter tofu cat litter, mixed cat litter, bentonite cat litter, and mineral cat litter, which can be clumped. Not suitable for tofu and mixed cat litter with diameter > 3mm or length > 15mm, as it can cause waste of cat litter. Do not use non clumping cat litter.
5. Kittens weighing less than 1kg and nursing cats are strictly prohibited from using the Auto cleaning & Timing cleaning.
6. The host (base) of this litter box is strictly prohibited from soaking in water. If accidentally getting wet during the cleaning process, please wipe it dry to avoid damaging electrical components.
7. Please use the original power adapter to avoid litter box damage or safety hazards.
8. Please use this litter box indoors and avoid high temperatures, humidity, and direct sunlight.
9. Please repair under the guidance of professional personnel to avoid product damage or other accidents.
10. If you face any problem about litter box, please contact customer service.

Components and accessories list

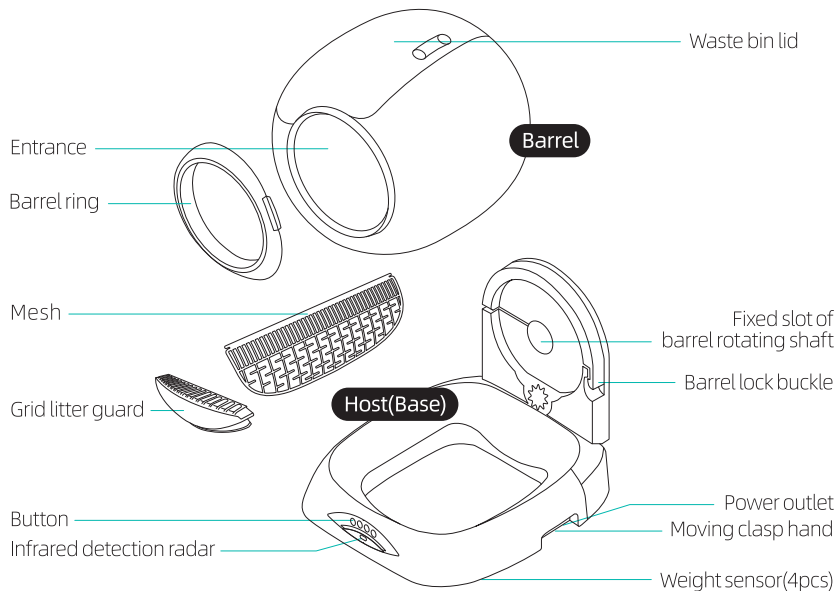

Accessories



Panel and Keys



Fault lamp

Lights up: the barrel is not installed or cannot rotate normally

WIFI lamp

Lights up: In WIFI
Flashes: Connecting Network
Dark: Not in WIFI

Full lamp

Lights up: The waste bin is almost full, please replace the garbage bag

Power lamp

Lights up: power on



Keys

Clean	Click "Clean"	Begin to clean
Replace litter	Press "Replace litter" for 2s	Empty the rest litter in the barrel
Auto Clean	Click "Auto"	Auto clean is turned on
Remove Odor	Click "Remove odor"	Removing odor for 30 minutes
Connecting	Press "Auto" or 2s	Connecting APP
Leveling	Press "Clean" for 2s	Smoothing litter
Replace bag	Press "Remove odor" for 2s	Adjust the waste bin to the bag changing angle
Child lock	Press + for 2s	On/Off the Child lock
Infrared Sensor	Press + for 2s	On/Off Infrared sensor (Off by default)

Use instructions



Inspect litter box and accessories

1. Take out the litter box, remove all fixing tapes, open the waste bin lid, and check if the litter box and accessories are complete (see product list for details).
2. Check whether the litter box itself is complete, whether the barrel is installed correctly, and whether the barrel lock buckle and the waste bin lid are properly closed.

Proper placement of litter box

1. Ensure that the litter box is placed on a firm and flat ground, without anything at the bottom.
2. Ensure that there are no walls or objects around the litter box, and nothing are placed on the top.
3. Ensure that the litter box is close to the WiFi signal source and away from other interfering household appliances.

Power on & self-check

1. After the litter box is powered on and makes a beep sound, white Clean light flashes, and the litter box starts self checking (the duration is between 30 seconds and 180 seconds depending on the position of the barrel).
2. After self check is completed, the litter box defaults to Auto cleaning mode, with white Clean light is on and blue WiFi light is flashing. Users need to wait for the self check to complete before proceeding to the next step.
3. If the self check is not successful, please check if the barrel is installed correctly. After powering on again, perform the self check again. If it is not successful, please contact customer service.

Use instructions



Networking settings

1. Scan the code or enter the App store to download and install "Smart Life".
2. Open the App to register and log in. The homepage will automatically search for the Ti+ Smart cat litter box, select Add, and follow the instructions for online operation.
3. The phone needs to be connected to 2.4GHz WiFi, and currently does not support WiFi in the 5GHz frequency band, hotels, airports, and other areas that require special authentication. And open the Bluetooth and Location on the phone.
4. If the litter box cannot be automatically searched, you need to manually add. Press the WiFi button  for 5 seconds, and a long beep will sound. The blue WiFi light will change from slow flashing to fast flashing. Release the button and follow the App's instructions to start connecting.
5. After successful networking, the blue WiFi light will remain on.
6. If there is a network failure, please check if the WiFi frequency band, password, etc. are correct, the WiFi signal strength, and try to reconnect. If there are multiple failures, please contact customer service.



Download The App

Use instructions



Add cat litter

1. This litter box can use tofu litter, mixed litter, bentonite litter, and mineral litter.
2. Please connect to the App and follow the prompts to set the litter type and other information to ensure a better user experience.
3. Add cat litter from the entrance of the barrel, and do not exceed the Max line to avoid waste of cat litter.
4. After adding cat litter, please press the Cleaning button  for 2 seconds to level the cat litter.
5. In daily use, please add sufficient cat litter timely to ensure a good user experience.

Ionic deodorization

1. Click the key of Remove odor, on or off the deodorization, one time deodorization lasts for 30 minutes.
2. One deodorization will be executed after Auto Clean.

Use instructions



Installation and replacement of garbage bags

- 1.If you need to replace the used garbage bag first, please press and hold the WiFi button  for 2 seconds to adjust the waste bin to the bag changing angle and open the waste bin lid. The duration time for bag changing angle is 60 seconds. After 60 seconds, the litter box will automatically reset. If the installation of the new garbage bag is not completed within 60 seconds, it can be operated again.
2. Align the new garbage bag drawstring with the tie pile, and clip the lower edge of the bag mouth under the positioning clip. **① ②**
3. Wrap the opening of the new garbage bag around the outside frame of the flip cover of the waste bin, and pull out the drawstring. **③**
4. Press the drawstring into the tie pile, tighten it and wrap it around. Confirm that the garbage bag opening is securely fastened. **④**
5. After installation, confirm that the waste bin door is not obstructed by the garbage bag and can open and close normally. Organize the back of the garbage bag and close the waste bin lid.

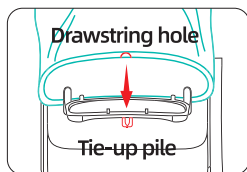

①

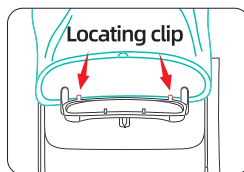

②

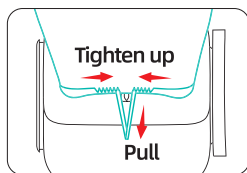

③

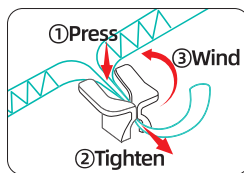

④

*The litter box is installed with a garbage bag at the factory for demonstration purposes.

Litter box Cleaning



One key for replacing litter

1. Before emptying the litter, please replace a new garbage bag to ensure there is enough space.
2. Press the Clean button  for 5 seconds, and after a long beep, the red Clean light will flash, and the litter box will start emptying litter. Click the Clean button  again can stop.
3. After replacing litter is completed, open the waste bin lid, remove the garbage bag.

Cleaning

1. After emptying the waste bin, disconnect the power, remove the grid litter guard, open the barrel lock buckle on the base, take out the barrel, and remove the mesh.
2. The whole barrel can be washed with water. After cleaning is completed, drain the water, air dry/wipe all components, and install the mesh.
3. The base has electrical components, which are strictly prohibited from washing with water. They can be wiped with a damp cloth.
4. Place the barrel back on the base, lock the barrel lock buckle, install the grid litter guard, connect the power, wait for the self check, add cat litter, and start using.
5. Users can clean the litter box according to the specific usage habits. It is recommended to replace the garbage bag every 3 days in hot weather (one cat as an example), and wash the barrel with water once every 1-3 months.

Parameters and Specifications

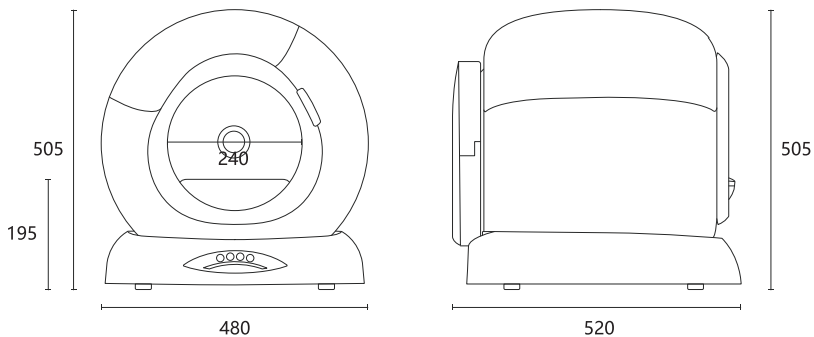

Product Name	Product model	Litter box Dimension	
Ti+ M Smart cat litter box	TPCBTA-01	480(W)×520(D)×505(H)mm	
Execution standards	Rated voltage	Rated power	Suggested pet type
GB4706.1-2005	DC12V	≤24W	Cat