

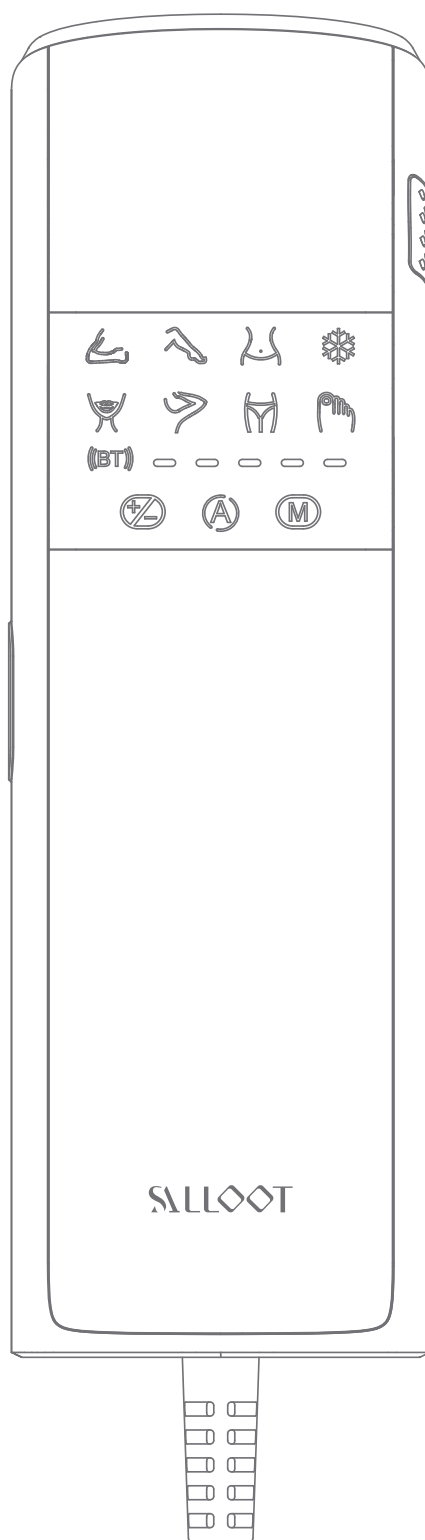

User Manual
IPL Home Use Hair Removal Device
Model: DT015



Email: support@isalloot.com

CATALOG

Product Structure	01
Specifications	04
Preparation before Use	05
How to Use	05
How to Download CTONE App	08
Safety Precautions	09
Tips after Usage	12
Cleaning&Maintenance	13
Troubleshooting	14
Package List	15
FCC Statement	16

Product Structure

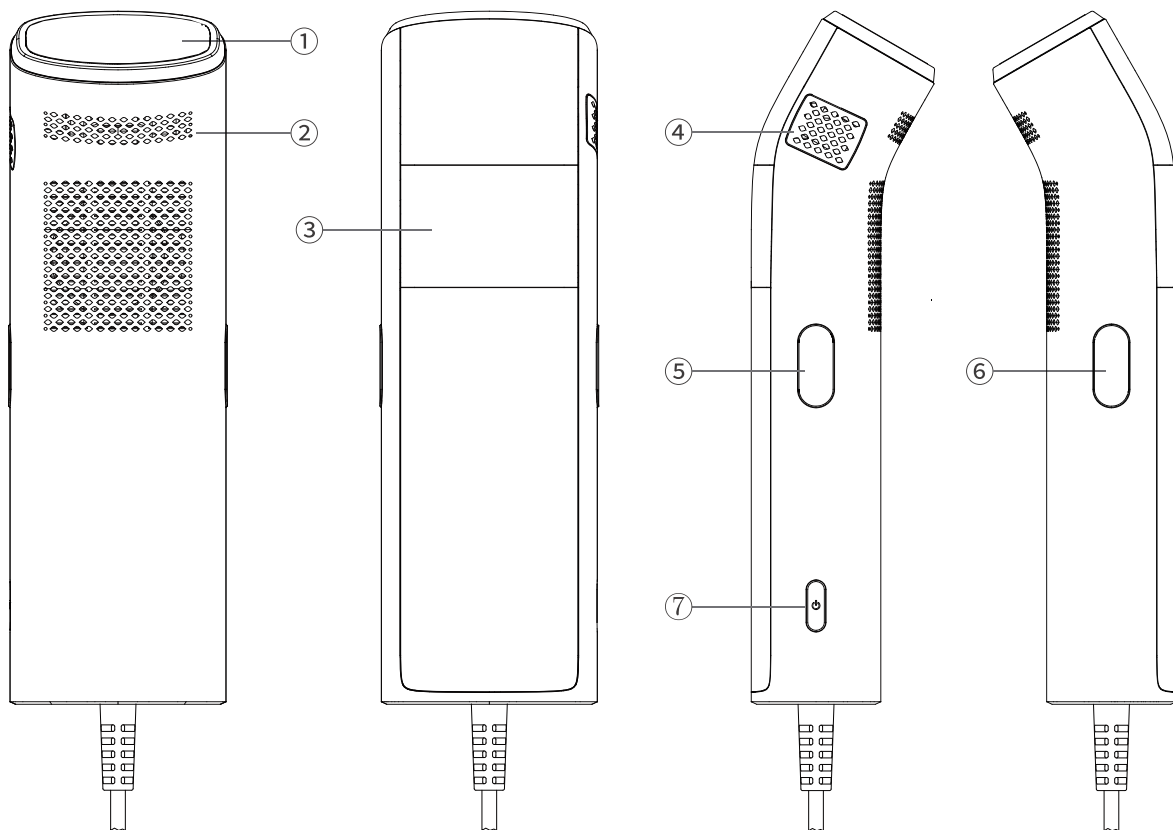

【 Components 】

- ① Light outlet ② Air inlet ③ LED function panel ④ Air outlet
⑤ Right Flashing button ⑥ Left Flashing button ⑦ Power button

Power button: Long press for 2 seconds to power on/off; Short press to adjust the intensity level in the order of 1-2-3-4-5-4-3-2-1.

Flashing button: Short press left or right button to start flashing; Long press for 2S activate auto-glide flashing mode .

※ Do not block the air inlet/outlet with foreign objects, as it may cause serious damage to the device.

[Function Panel Overview]

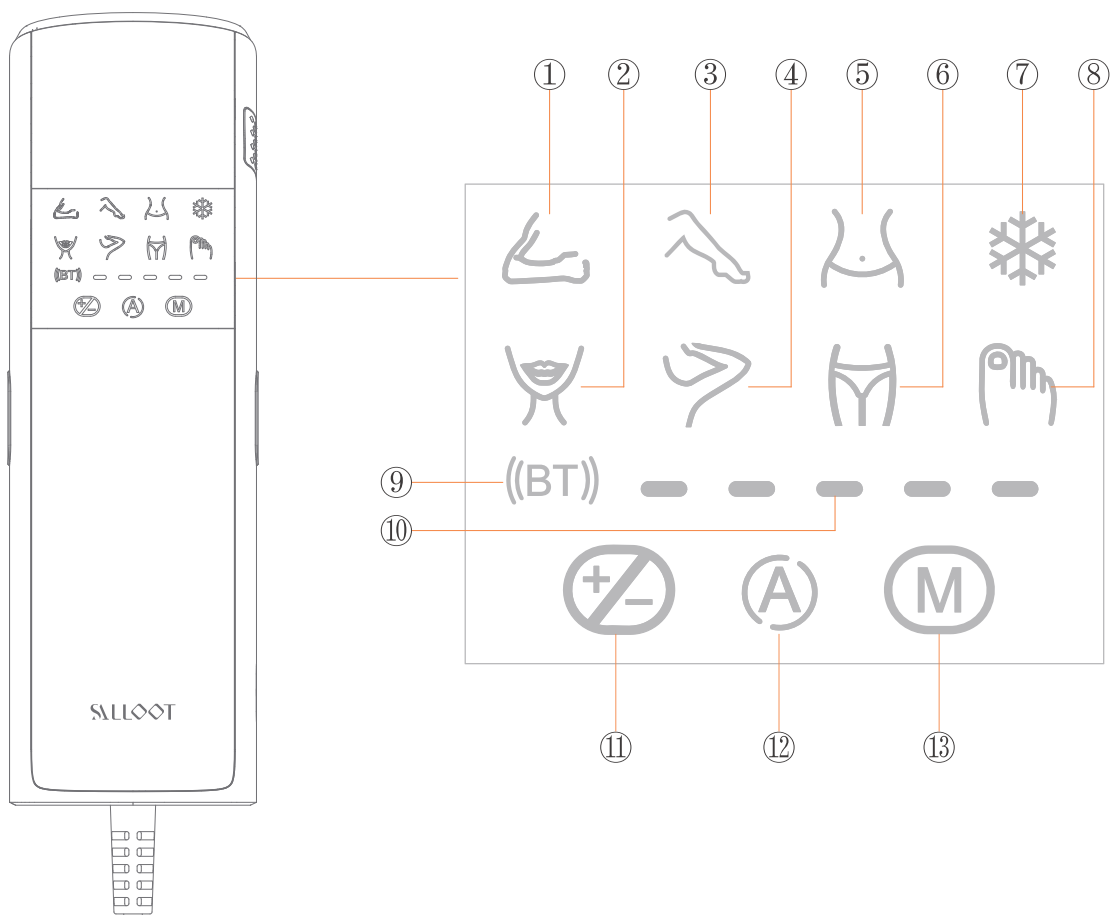

① Arm-area icon	Arm hair removal mode
② Face-area icon	Face hair removal mode
③ Leg-area icon	Leg hair removal mode
④ Armpit -area icon	Armpit hair removal mode
⑤ Upper body -area icon	Upper body hair removal mode
⑥ Bikini -area icon	Bikini hair removal mode
⑦ Ice cooling icon	Painless hair removal
⑧ Finger/toe-area icon	Finger/toe hair removal mode
⑨ Bluetooth indicator light	Blinking light:Bluetooth Pairing Status Light on:Successfully paired with APP
⑩ Treatment level	Hair removal energy levels
⑪ Level button	Short press to adjust the level in the order of 1-2-3-4-5-4-3-2-1
⑫ Auto flash icon	"A" means Automatic flashing mode in which the indicator "A" lights on. When "A" lights off, it means Manual flashing mode.
⑬ Mode button	Touch to select hair removal area

[NOTES]

1) Press the power button over 2 seconds to turn on the device. The defaulted arm-area icon, ice cooling icon and intensity treatment level will light up, the Bluetooth indicator icon will keep flashing. (Bluetooth connection instructions see page 8. After Bluetooth successfully paired with APP, Bluetooth indicator icon will remain light on.)

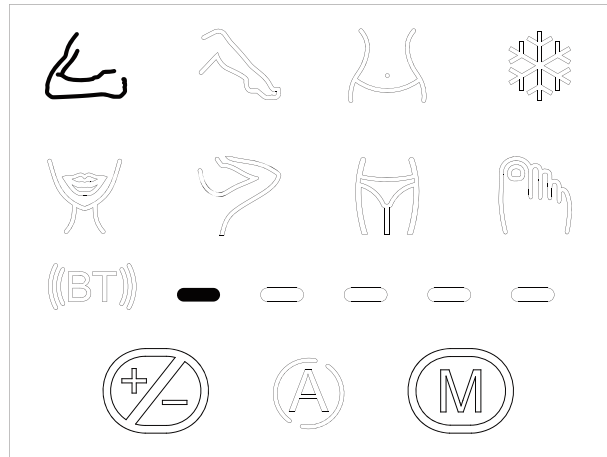

2) There are 7 body mode icons in the LED Panel.

The first row represents frequently-used body areas. You can switch the body-area icons by short pressing “ M ” button to switch between “ Arm, Leg, Body, Face, Armpit, Bikini, Toes/Fingers ”.

3) Once powered on, it enters manual flashing mode, long press the flashing button for 2 seconds to enter automatic flashing mode, with the “ A ” icon lights up; long press the flashing button for 2 seconds, the “ A ” icon lights off to enter manual flashing mode.

Specifications

DT015 has 7 hair removal modes, which precisely control energy by adjusting each mode and applicable to all parts of the body hair removal.

Sapphire crystal has various invaluable physical properties including high intensity, high temperature resistance, high light transmittance and high thermal conductivity. The combination with the semi conduction refrigeration technology makes the hair removal experience safe, comfy, icy and painless. During the process of hair removal the sapphire can effectively cool the cuticle of the skin and reduce the damage of burning heating, making the whole process comfy and painless. And the sapphire crystal is extremely high transmittance, can avoid hair removal instrument in the flash during the light energy loss, the hair follicle can absorb the light energy will be more, so that hair removal will be more rapid and thorough.

Parameters	
Area of light outlet	3cm ²
Energy level	5 levels Adjustable
Wavelength	550-1100nm
Sapphire area	12cm ²
Working temperature	Suggestion: 10 to 30 degrees Celsius
Input	100-240V~ 50/60Hz
Power	80W
Product size	254*154*112mm

Preparation before Use

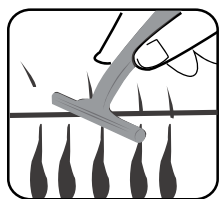

- Thoroughly clean the skin to ensure it is free of hair, completely dry and free of oily residues (perfumes, lotions, deodorants, sunscreens, etc.).
- Make sure the light outlet is free of dust, hair and other residue, and that it is not damaged or abnormal. If there is dirt, please clean it to avoid failure, deterioration and skin problems.

Tips for Hair Removal

Hair removal tips for each body part

1/ Hair removal in the armpits

- Before hair removal, wipe off the antiperspirant, perfume, cream or other cosmetics applied in the armpits.
- For areas with loose skin, stretch the skin with your fingers and then remove hair.
The slight burning sensation is normal when the skin is at the light outlet.

2/ Hair removal in the bikini zone

- For deeply pigmented and dark areas, please use the low level, and always use the level 1 before adapting.

3/ Hair removal of hands and feet

- Bones and uneven areas are more prone to pain than other areas.

How to Use

Steps

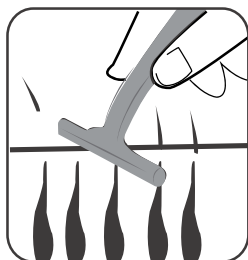

- 01/
- Shave off the hair on the area to be depilated with the shaver and clean this area.

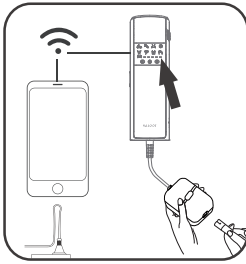

02/

Connect the device to the power supply and turn on your phone's Bluetooth to connect to the device with the app. After the device detects power, the energy indicator will flash in sequence.



03/

Wear the attached goggles to avoid eye damage from flash.

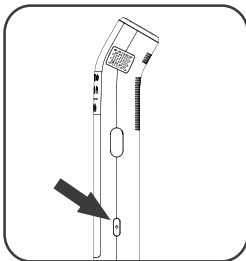

04/

Press the Power button over 2 seconds or use the app to turn on the device.



05/

Do not use the device if your skin tone is "X" in the skin tone card. But it is recommended to start with level 1 for the first use.

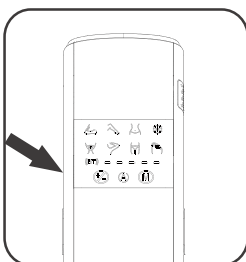

06/

Adjust the level according to your skin tone by pressing the intensive level button or app. You can select between level 1 and 5 according to your skin tone. It is recommended to start with level 1 for the first use.

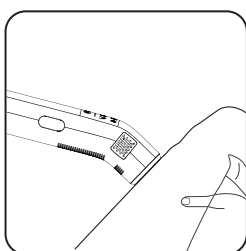

07/

Place the device vertically on the area to be depilated and fit the light outlet tightly to the skin, the indicator light will flash.

(Note: If the light outlet does not fit to the skin, the indicator light will not flash.)

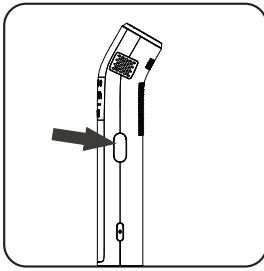

08/

The default setting of the hair removal device is manual mode. Press the flash button once to flash once. Press and hold the flash button for 2 seconds or use app to switch to auto mode. The hair removal device will flash continuously. (When the A icon light on, it means that it is in auto mode. When the A icon is light off, it means that it is in manual mode).

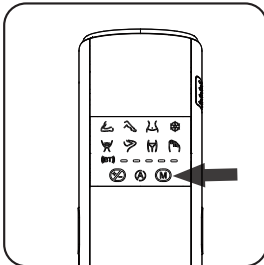

09/

Short press the mode button or use app to switch the mode according to the different parts.

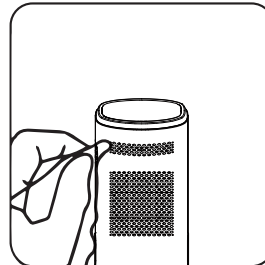

10/

Please clean the light outlet after using it and keep it free of debris and residue.

Skin tone Energy Level Hair color						
	white	beige	light brown	brown	dark brown	brown-black and darker color
white/grey	×	×	×	×	×	×
red	×	×	×	×	×	×
light gold	×	×	×	×	×	×
dark gold/light brown	4/5	4/5	4/5	1/2/3	×	×
brown	4/5	4/5	4/5	1/2/3	×	×
dark brown	4/5	4/5	4/5	1/2/3	×	×
black	4/5	4/5	4/5	1/2/3	×	×

Light intensity setting

This product is specially designed for home hair removal, so it has softer light energy in 5 different levels. You can adjust the light energy according to your skin tone and hair color to make you feel comfortable.

1/ Please refer to the table below to see which light energy is suitable for your skin tone and hair color.

2/ If you feel any pain or discomfort, please select a lower level.

(Note:X means that it is not applicable).

Note: For various reasons, your skin may react differently depending on the exposure time and environment.

How to Download CTONE App

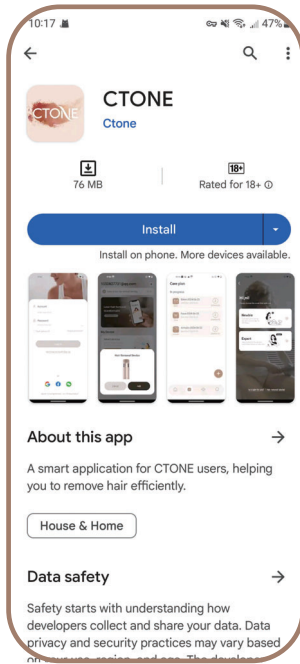

Google Play

- 1 Open Google Play, search for "CTONE" and find CTONE APP to download.
- 2 Scan the QR code below to jump to the CTONE page on Google Play to download.

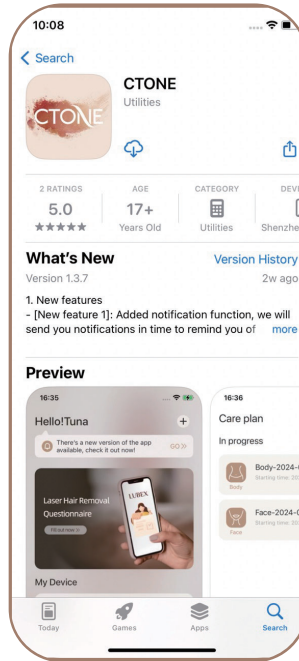

App Store

- 1 Open the App Store, search for "CTONE" and find CTONE APP to download.
- 2 Scan the QR code below to jump to the CTONE page on App Store to download.



How to connect the hair removal device

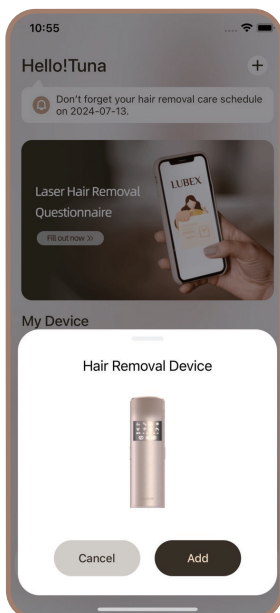

Method I: Auto-discovery

- 1 Open the APP homepage, authorize and enable Bluetooth and positioning functions
- 2 Connect to the power supply
- 3 Wait for the APP to automatically search and discover the hair removal device

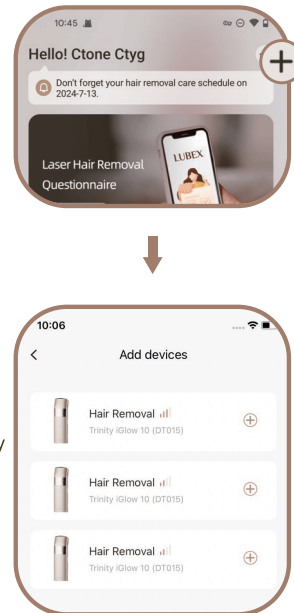

Method II: Manual-discovery

- 1 Open the APP homepage, authorize and enable Bluetooth and positioning functions
- 2 Connect to the power supply
- 3 Click the "+" button on the homepage to enter the device addition page
- 4 Wait for the APP to discover the hair removal device

Safety Precautions

Please be sure to assemble and use the product in accordance with the instructions described in this manual.







Please read this manual carefully and keep it properly for future reference.

If you have any questions during use, please contact online customer service.

 **Danger:** Contents related to personal injury due to miss operation.

 **Caution:** Contents related to personal injury or property damage due to miss operation.

Danger

-  **Warning:** Do not use the device near bathtubs, shower tubs, washbasins, or other utensils with water, and keep this device and power adapter dry.
-  If the device is damaged, stop using it and do not touch any internal components to avoid electric shock.
-  Do not insert objects into the device or do not place it at will.
-  Do not use this device near your eyes. Goggles can protect you during normal operation, but if you use it close to your eyes, goggles may not completely avoid the absorption of energy by the melanin of the iris in your eyes.
-  Before use, please wear goggles. Although the light does not directly affect your eyes, the high-frequency flashing light may affect your vision.
-  Due to the lack of data on the use of the device by children under the age of 15, please be careful to prevent children under the age of 15 from touching the device.



The following people should not use this device and in the following cases it should not be used:

- Pregnant women, lactating women, women in menstrual period, people with scars on the body, diabetes, sensitive skin and photosensitive skin;
- People with severe heart diseases, moderate/severe hypertension, malignant tumors, folliculitis, infectious skin diseases, burns and coagulation disorders;
- People with abnormal collagen metabolism, including a history of ecchymosis and poor wound healing;
- People with vascular diseases, such as varicose veins and vasodilation in the flash area;
- People with photosensitive skin and tendency to skin rashes or allergies;
- People with infection in the flash area, such as herpes simplex, skin lesions, hematomas, etc.;
- People with immune system diseases (including AIDS, lupus erythematosus, porphyria, etc.);
- People with hemorrhagic disease and those who are using isotretinoin, alpha hydroxyl acid (AHA), beta-hydroxy acid (BHA) or azelaic acid;
- People who use chemical methods for hair removal within 30 days, and those who have used whitening products or cosmetic products containing vitamin A in the past few days;
- People who are using essential oils. Please make sure the skin in the flash area is clean, dry and free from creams, lubricants and other cosmetics; If the skin surface is not clean and dry, it may affect the experience of use and damage the device.
- People who are taking aspirin, immunosuppressants, isotretinoin, etc. Currently not recommended for people who have recently taken photosensitive drugs (e.g. tetracycline, sulfonamides, etc.);
- People with light damage (sunburn), please wait for the skin to repair, and do not use it on the sensitive areas such as mucous membrane;
- People with unhealed wounds, hypertrichosis and hirsutism caused by other diseases;
- People who are taking painkillers, as it will reduce the skin's sensitivity to heat, and it is recommended to use it after drug elimination;
- People with unsuitable skin tone or hair color.
(If necessary, please consult your doctor before use.)

Please do not use it on the following body parts or in the following cases:

- | | |
|---|----------------------------|
| 1/ Intraoral, genitals, mucous membrane, etc. | 7/ Eyebrows, hair |
| 2/ Plastic and surgical sites | 8/ Ears |
| 3/ Adam's apple | 9/ Nipples, areola |
| 4/ Eyes, around the eyes | 10/ Inside the navel |
| 5/ Pimples | 11/ Vena cava |
| 6/ Spots, nevus | 12/ Tattoos, body-painting |

(Note: This list is not exhaustive, if you are not sure whether you can use this product, please consult online customer service.)

Cautions



Do not expose to sunlight before/after hair removal.

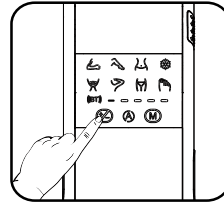

For the first use, please start with level 1.

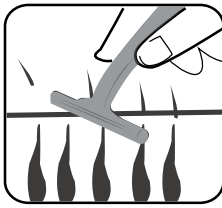

Before hair removal, shave the hair and clean your skin (do not use chemical hair removal methods).



Please wear goggles before using.



Do not use it in a dark environment.

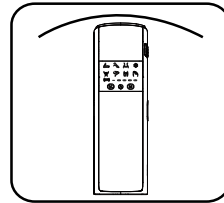

Do not hit or shake it with force.

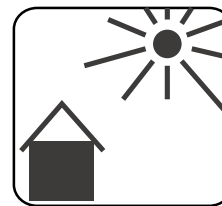

Do not use it in direct sunlight to avoid failure.

Tips After Usage

- It is recommended not to touch water within 2 hours after hair removal. After that, you can moisten the depilated area with moisturizing water.
- Do not use perfumes, masks or scrub creams after hair removal.
- Avoid direct exposure to UV light within 48 hours after hair removal and apply sunscreen if necessary.
- If you feel unwell, please consult online customer service.
- Sunbathing is likely to cause tanning of the skin or sunburn, and hair removal at this time may cause redness, swelling and inflammation. Therefore, do not expose to the sunlight while using this product and wait at least 1 week for sunburn relief.
- Do not expose the depilated areas to the sunlight within 48 hours after hair removal, and if this is unavoidable after 48 hours, always pay attention to your skin and apply a sunscreen with SPF30+ after 72 hours.
- Sunbathing during hair removal is prohibited.
- If plastic surgery is required after hair removal (only in the depilated area), please consult your doctor.

Frequency of use

Weeks 1-4

3-4 times / week

Weeks 5-8

2-3 times / week

After week 8

1-2 times / month

Please use the device several times depending on hair growth and increase the level and frequency appropriately for thick hair, but this varies from person to person.

Cleaning & Maintenance

Care

To ensure the best effect and longest service life of the device, please clean it before and after each hair removal to prevent hair residues and dust, otherwise the expected effect will not be achieved.



- Check the device, especially the light outlet and the components. And make sure they are clean.
- Do not wash the device and its accessories under the faucet or in the dishwasher.
- Do not use steel wool, abrasives (toothpaste, etc.) or corrosive liquids (gasoline, engine oil, acetone, etc.) to clean the device.

Note: If the light outlet cannot be cleaned any more, do not continue to use this device.

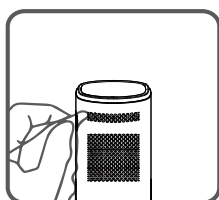

- Power off the device, unplug the power plug, and let it cool down. The light outlet will heat up during use, make sure it cools down before cleaning.
- If necessary, clean the shell with a clean, soft cloth.
- Dampen the soft cloth with a few drops of water and then use it to clean the following components:
 - Light outlet
 - Skin sensing area

Note: If the above components cannot be cleaned well with water, you can use a few drops of alcohol with high concentration (not more than 75%) for cleaning.

Environment protection



When disposing of this device, do not throw it away with normal household waste, please take it to a designated recycling center to protect our environment.

Troubleshooting

Problems encountered with this product are described below. If you cannot solve your problem with the following information, please contact our customer service for help.

Problem	Possible cause	Solution
Unable to be powered on.	The power supply is not connected properly.	Check if the power adapter is plugged in correctly.
Unable to flash.	The head of the device and the device body are too hot. The head of the device is not close to the skin.	Let the device to cool down naturally before use. Hold the device close to the skin and wait for the indicator light to flash.
The indicator light does not light up.	The device is defective.	Check if the power supply works properly. Repair or replace it immediately.
It smells not good when flashing.	The filter is dirty. There is some hair on the body surface.	Wipe off the filter. Shave off the hair and reduce the light intensity.
The pain during hair removal is unbearable.	The area to be depilated is not shaved.	Before use, please shave off the hair on the flash area. If shaving causes skin irritation, use the device at a comfortable level after skin regeneration.
	The area to be depilated is not suitable for the use of this product.	Do not use the device on labia, vagina, anus, nipples and areola. Men should not use it around the eyes or on the scrotum.
	The light intensity is too high.	Reduce the light intensity to a comfortable level.
	The light outlet is damaged.	Repair or replace it immediately.
The depilated area blushes after hair removal.	Mild redness is normal, which is harmless and will subside quickly.	No action required.

If a fault occurs and it is not solved, please contact our after-sales customer service in your language in time.

Please keep your purchase invoice and warranty card, as you will need to bring these receipts with you in the event of a fault with your product.

Problem	Possible cause	Solution
The hair removal effect is unsatisfactory.	You have set a light intensity that is too low for you.	Next time, please select a higher level, or flash 2 times in the same area, as the energy of the 2 flashes can be stacked.
	There is no flash near the previously flash areas.	Additional flashing is required on adjacent areas and there should be some overlap between the flash areas.
	This device has no effect your hair color.	If your hair is light blonde, gray, red or white, the light will not have any effect.
	You do not use the device frequently.	To successfully remove all hair, it is recommended to follow the recommended flashing program or consult our customer service.
	Your reaction to the light is relatively slow.	You should use this device continuously for at least 6 months, as it can still inhibit hair regrowth during this period.
The device becomes damp and hot during use.	This is normal.	No action required.

Manufacturer:Shenzhen Beauty Every Moment intelligent electric Co.,Ltd.

Add:Bldg.4,Haoer Jiashitai Technology Park, Zhancheng Community,Fuhai Street,Bao'an District,Shenzhen,Guangdong,China

Package List

Device*1

AC power cord*1

Razor*1

Goggles*1

User's Manual*1

Packaging Box 1

FAQ Guide Card*1

Cleaning Cloth*1

FCC Statement

This device complies with part 15 of the FCC Rules. Operation is subject to the following two conditions: (1) this device may not cause harmful interference, and (2) this device must accept any interference received, including interference that may cause undesired operation.

Any changes or modifications not expressly approved by the party responsible for compliance could void the user's authority to operate the equipment.

NOTE: This equipment has been tested and found to comply with the limits for a Class B digital device, pursuant to Part 15 of the FCC Rules. These limits are designed to provide reasonable protection against harmful interference in a residential installation. This equipment generates, uses and can radiate radio frequency energy and, if not installed and used in accordance with the instructions, may cause harmful interference to radio communications. However, there is no guarantee that interference will not occur in a particular installation.

If this equipment does cause harmful interference to radio or television reception, which can be determined by turning the equipment off and on, the user is encouraged to try to correct the interference by one or more of the following measures:

- Reorient or relocate the receiving antenna.
- Increase the separation between the equipment and receiver.
- Connect the equipment into an outlet on a circuit different from that to which the receiver is connected.
- Consult the dealer or an experienced radio/TV technician for help.

The device has been evaluated to meet general RF exposure requirement. The device can be used in portable exposure condition without restriction