

Instaiiation and Use Manual

1、Install 2 casing brackets

Insert the long tube into the short tube clamp and reinforce it with an Allen wrench.



2、Host and tube bracket assembly

Loosen the pipe clamp and insert it into the bracket, then lock it in place

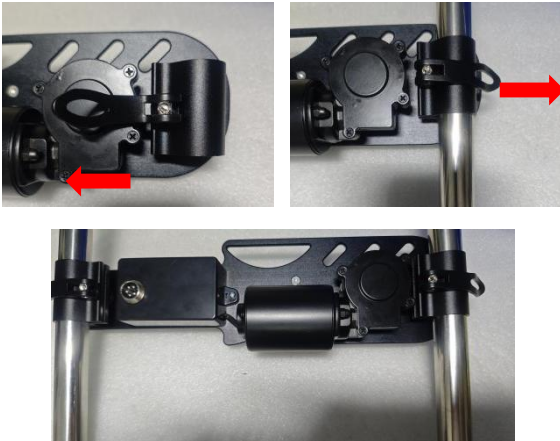

The small screw can adjust the tightness of the quick tube clamp



3、Install the telescopic rod onto the host

The pole is connected to the slider inside the host and fixed clockwise.

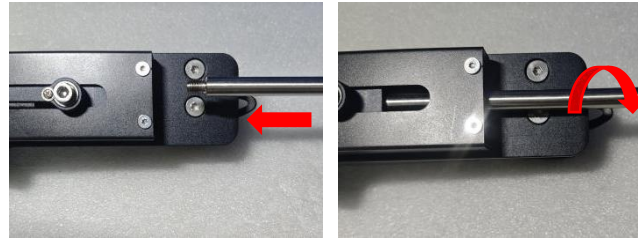

4、Install power supply

Insert the power plug into the machine's power hole and power it on for use

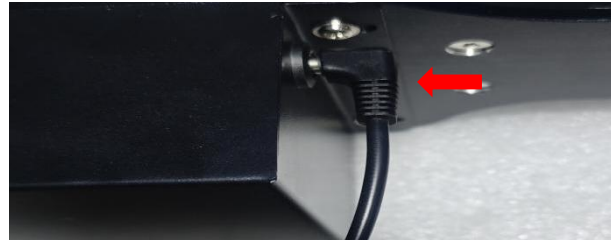

5、Installation of connectors and appliances

Insert the connector into the circular hole and open the ring to remove it.

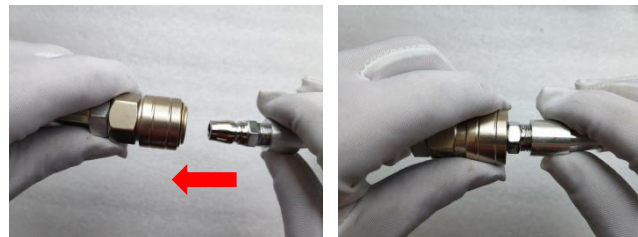

6、Adjustment method for telescopic distance

Loosen the screw counterclockwise by hand, and tighten it clockwise by dragging the screw.



7、Complete the diagram



precautions:

- 1, During use, it is strictly prohibited to place hands or limbs on the rotating rocker arm to prevent mechanical bites.
- 2, Unable to use, hold down the top and bottom two buttons on the remote control for more than 5 seconds simultaneously.

FCC Warning:

This equipment has been tested and found to comply with the limits for a Class B digital device, pursuant to part 15 of the FCC Rules. These limits are designed to provide reasonable protection against harmful interference in a residential installation. This equipment generates, uses and can radiate radio frequency energy and, if not installed and used in accordance with the instructions, may cause harmful interference to radio communications. However, there is no guarantee that interference will not occur in a particular installation. If this equipment does cause harmful interference to radio or television reception, which can be determined by turning the equipment off and on, the user is encouraged to try to correct the interference by one or more of the following measures:

- Reorient or relocate the receiving antenna.
- Increase the separation between the equipment and receiver.
- Connect the equipment into an outlet on a circuit different from that to which the receiver is connected.
- Consult the dealer or an experienced radio/TV technician for help.

Caution: Any changes or modifications to this device not explicitly approved by manufacturer could void your authority to operate this equipment.

This device complies with part 15 of the FCC Rules. Operation is subject to the following two conditions:

(1) This device may not cause harmful interference, and (2) this device must accept any interference received, including interference that may cause undesired operation.

This equipment complies with FCC radiation exposure limits set forth for an uncontrolled environment. This equipment should be installed and operated with minimum distance 0cm between the radiator and your body.