

INSTRUCTIONS AND PRECAUTIONS

■

YX-218-N

(Read all instructions and precautions before use)

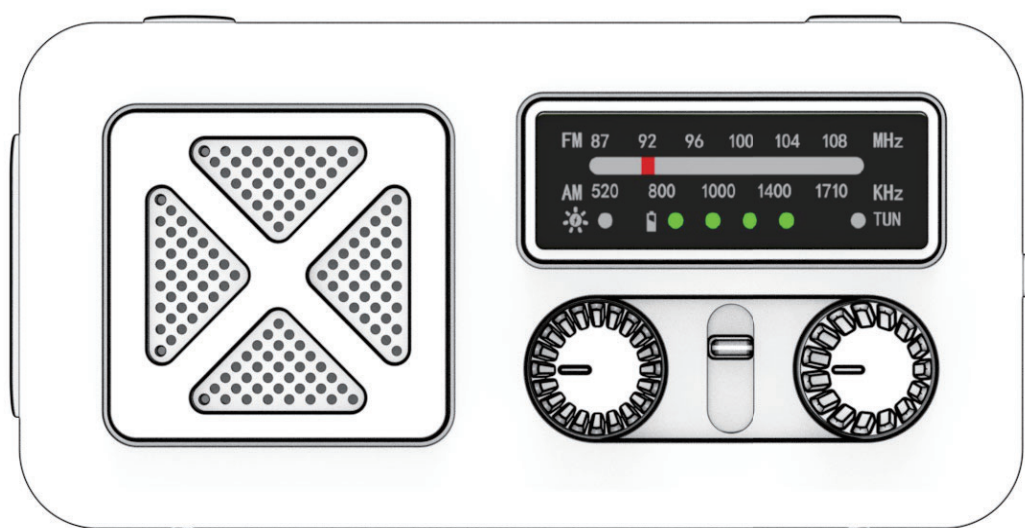

<https://nitigo.com/>



support@nitigo.com



MADE IN CHINA

V2 2024-12-25

Warning

EN WARNING

Keep small parts and plastic bags away from children to avoid choking
Keep away from fire or flames

DE WARNUNG

Halten Sie Kleinteile und Plastiktüten von Kindern fern, um ein Erstickten zu vermeiden.

Von Feuer oder Flammen fernhalten

FR AVERTISSEMENT

Tenir les petites pièces et les sacs en plastique hors de portée des enfants pour éviter tout risque d'étouffement. Garder loin du feu et des flammes

ES ADVERTENCIA

Mantenga las piezas pequeñas y las bolsas de plástico fuera del alcance de los niños para evitar que se atraganten. Mantener alejado del fuego o las llamas.

IT AVVERTENZA

Tenere le parti piccole e i sacchetti di plastica lontano dalla portata dei bambini per evitare il soffocamento. Tenere lontano dal fuoco o dalle fiamme.

NL WAARSCHUWING

Houd kleine onderdelen en plastic zakken uit de buurt van kinderen om verstikking te voorkomen

Verwijderd houden van vuur of vlammen

PL OSTRZEŻENIE

Przechowywać małe części i plastikowe torebki z dala od dzieci, aby uniknąć zadławienia.

Przechowywać z dala od ognia lub płomieni

TR UYARI

Boğulmayı önlemek için küçük parçaları ve plastik torbaları çocuklardan uzak tutun

Ateş veya alevlerden uzak tutun

CZ VAROVÁNÍ

Malé části a plastové sáčky uchovávejte mimo dosah dětí, aby nedošlo k udušení.

Uchovávejte mimo dosah ohně nebo plamenů

SAFETY INSTRUCTIONS:

1. When using this machine, please do not over discharge, so as not to reduce the service life of the battery in the machine, or even damage the rechargeable battery.
2. Dropping this radio can cause injury or damage. The unit will not resist strong impact or contact with corrosive liquids.
3. To clean radio surface use a soft, damp cloth. Do not use alcohol or other liquids containing corrosive ingredients to clean this product.
4. The device shall not be exposed to dripping or splashing, and objects filled with liquids should not be placed on the device.
5. Please keep the device dry to avoid damage from moisture and liquids
6. Avoid flashlight directly into the eyes, or it will hurt the eyes.

Names of Parts

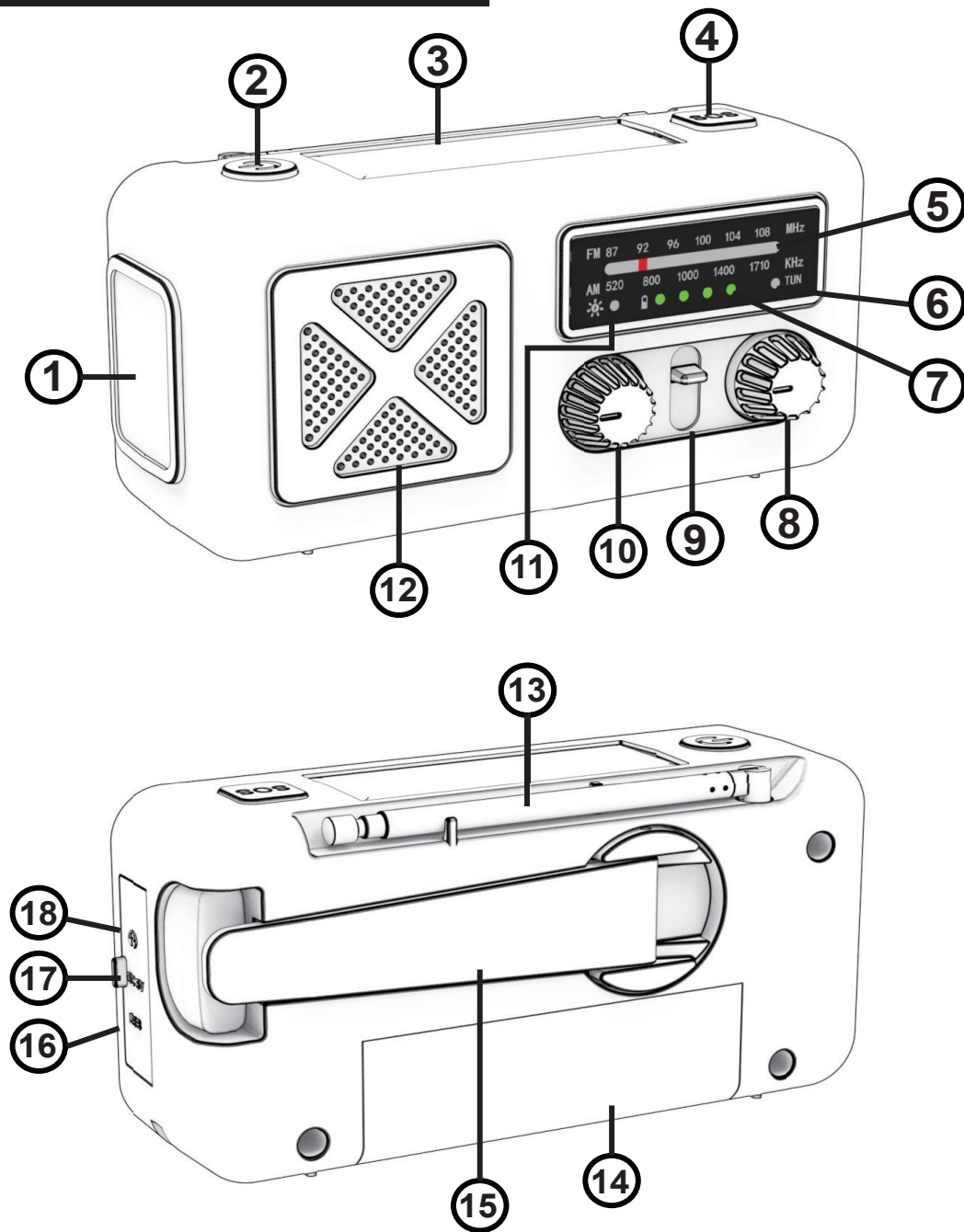

1	Flashlight	10	Tuning Knob
2	Flashlight Switch	11	Radio Signal Light
3	Solar Panel	12	Speaker
4	SOS Alarm	13	Antenna
5	Frequency Dial	14	Battery Container
6	Hand Cranked Charging Indicator	15	Hand crank
7	Battery Indicator	16	USB Output
8	ON/OFF/Volume	17	Type-C Input
9	Band Selector	18	Earphone Jack

Specifications

Frequency Range	AM: 520- 1710 KHZ
	FM: 87- 108 MHZ
	WB: 62.400- 162.550
Product Size	137x68x50mm
	5.39"x2.68"x1.97 "
Weight	350g
Product Material	ABS
Battery capacity	3.7V /5000mah 21700 Li-ion
Working Voltage	5V
Output	5V 1A
Input	5V 1A
Flashlight	1W
Waterproof Level	IPX3
Charging Time	6H
Solar panel	5V/ 20mA /0.1W
Full charge usable time	Radio(Max Volume) : 7.5H
	Flashing Light (Brightest):15H
	SOS Alarm(Max Volume):5.5H
Hand cranked for 2 minutes usable time	Radio(Max Volume):3 Min
	Flashing Light(Brightest):16 Min
	SOS Alarm(Max Volume):2 Min
Speaker	2W 8Ω

Packing list

Radio X 1	User Manual X 1
Type-C USB Cable X 1	Lanyard X 1

Directions for Use

SOS ALARM OPERATION

1. Press and hold the SOS button for 3 seconds, the device will activate a loud siren and flashing beam.
2. Press the SOS button again to turn it off.

SOS Button

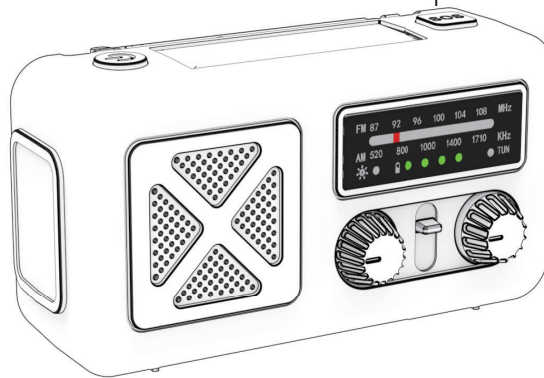

RADIO OPERATION

Please fully charge the machine with a USB cable for the first time use.

1. Turn the 'volume' Dial clockwise to power on the radio and adjust volume.
2. Select WB/FM/AM with band selector.
3. Extend the antenna to get better signal.
4. Rotate the tuning knob to select channel.
5. Green tuning indicator will turn on when a channel is properly selected.

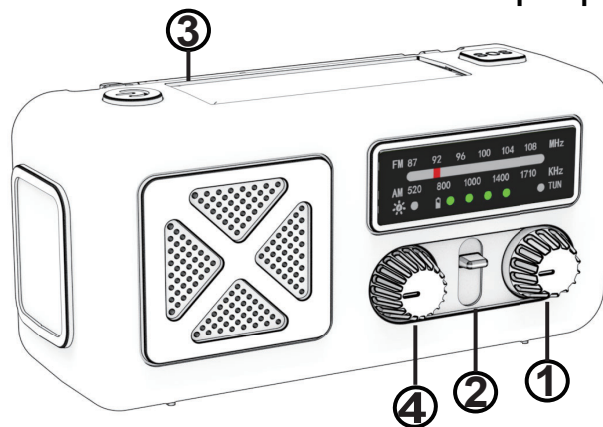

FLASHLIGHT OPERATION

1. Press the flashlight switch to turn it on/off.
2. Press once for first gear, press twice for second gear, press third to close.

Flashlight Switch

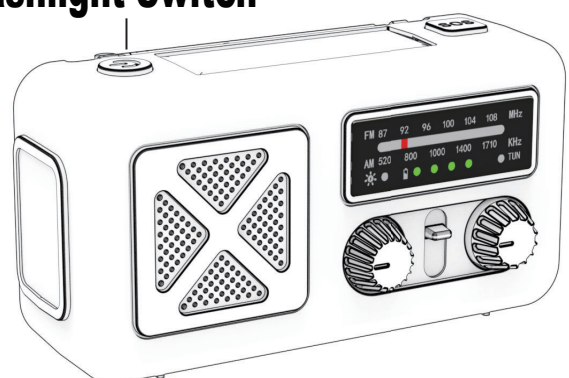

* Avoid flashlight directly into the eyes, or it will hurt the eyes.

POWER SUPPLYING OPERATION

Note:

- Generally, it is recommended to charge the lithium battery via the USB charging cable.
- Due to the low efficiency of manual charging and solar charging, which require too much time, it is only recommended to use them in emergency situations .
- When using it for the first time or when the device is idle for more than 60 days, please manually turn the crank for 1 minute or charge to activate the battery.
- If the machine is not used for a long time, it must be fully charged before using it again.

A. Hand-Cranking

1. Turn the Hand Crank continuously in clockwise or counter clockwise at speed of 130-140RPM to generate power.
2. When the handcrank is turning the charging indicator lights turn red, when stop hand cranking the lights goes out.

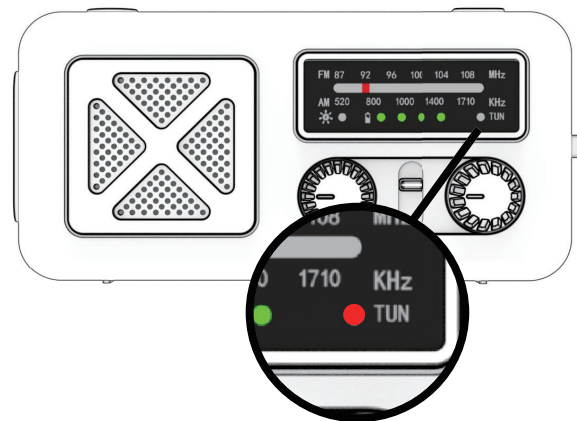
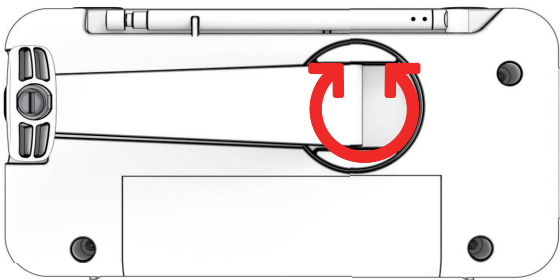

B. Solar Power

1. Expose the radio solar panel in direct sunlight.
2. The solar indicator light will be turn red when the solar panel is charging.
3. When the solar panel is obstructed, the indicator light goes out.

NOTE: It is difficult to fully charge the unit with solar panel, which is mostly used for maintaining the battery.



C. USB Charging

1. Connect the supplied usb cable to the input port on the right side of the unit to charge the built-in lithium battery.
2. When charging, the blue light flashes, and when fully charged, the blue light remains on.

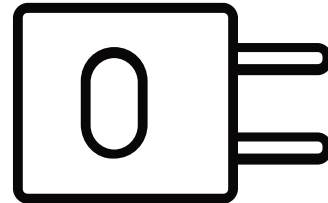
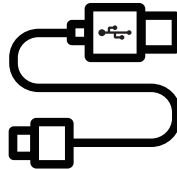

*Adapter Not Included

CHARGE EXTERNAL DEVICES

1. Insert the USB cable into the USB output port on the side of the radio and connect to the devices.
2. When charging the device, the indicator light turns blue.

Note:

◎ When the power of the unit is low, please turn the handcrank continuously in clockwise or counter clockwise at speed of 130-140RPM for 2 minutes to generate power.

◎ Or use a 5V 2A adapter to charge the device and activate the battery first.

◎ For iPhone 15 and later models, please use the original included USB-C cable to connect the device for charging.



Phone



iPhone 15
and
later models

Battery Indicator

◎4 indicator light modes:100%, 75%, 50%, 25%

Input: When charging the device, the power indicator light corresponding to the battery level lights up.

Output: When the radio charges external devices, the remaining battery indicator light comes on.

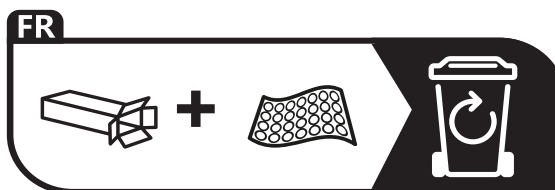
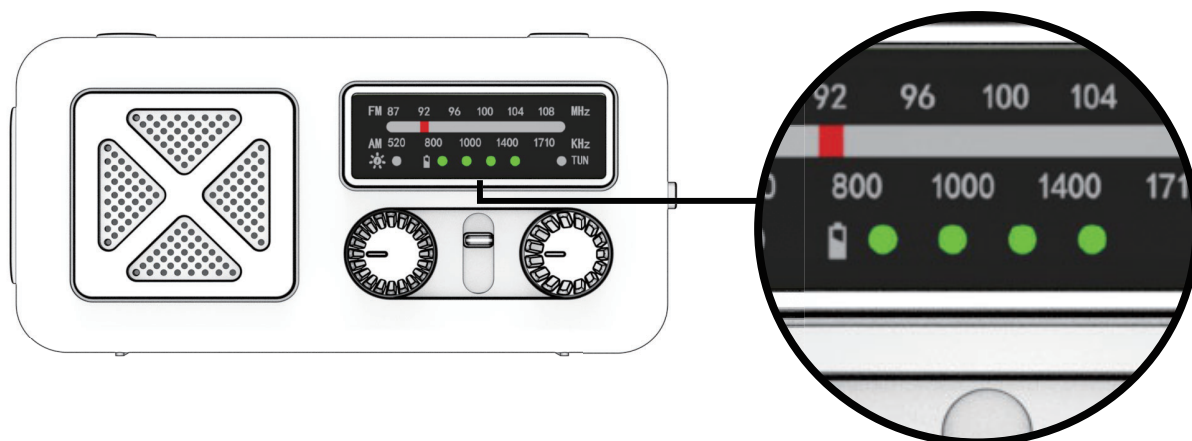

Points de collecte sur www.quefairedemesdechets.fr
Privilégiez la réparation ou le don de votre appareil !

2

Warning

- EN WARNING**
Keep small parts and plastic bags away from children to avoid choking.
Keep away from fire or flames.
- DE WARNUNG**
Halten Sie Kleinteile und Plastiktüten von Kindern fern, um ein Erstickung zu vermeiden.
Von Feuer oder Flammen fernhalten.
- FR AVERTISSEMENT**
Tenir les petites pièces et les sacs en plastique hors de portée des enfants pour éviter tout risque d'étouffement. Garder loin du feu et des flammes.
- ES ADVERTENCIA**
Mantenga las piezas pequeñas y las bolsas de plástico fuera del alcance de los niños para evitar que se asaganten. Mantener alejado del fuego o las llamas.
- IT AVVERTENZA**
Tenere le parti piccole e i sacchetti di plastica lontano dalla portata dei bambini per evitare il soffocamento. Tenere lontano dal fuoco o dalle fiamme.
- NL WAARSCHUWING**
Houd kleine onderdelen en plastic zakken uit de buurt van kinderen om verstikking te voorkomen.
Verreiden houden van vuur of vlammen.
- PL OSTRZEŻENIE**
Przechowywać małe części i plastikowe torebki z dala od dzieci, aby uniknąć zadławienia.
Przechowywać z dala od ognia lub płomieni.
- TR UYARI**
Bogulmayi önlemek için küçük parçaları ve plastik torbaları çocuklardan uzak tutun.
Ateş veya alevlerden uzak tutun.
- CZ VAROVÁNÍ**
Malé části a plastové sáčky uchovávejte mimo dosah dětí, aby nedošlo k udušení.
Uchovávejte mimo dosah ohně nebo plamenů.

SAFETY INSTRUCTIONS:

- When using this machine, please do not over discharge, so as not to reduce the service life of the battery in the machine, or even damage the rechargeable battery.
- Dropping this radio can cause injury or damage. The unit will not resist strong impact or contact with corrosive liquids.
- To clean radio surface use a soft, damp cloth. Do not use alcohol or other liquids containing corrosive ingredients to clean this product.
- The device shall not be exposed to dripping or splashing, and objects filled with liquids should not be placed on the device.
- Please keep the device dry to avoid damage from moisture and liquids.
- Avoid flashlight directly into the eyes, or it will hurt the eyes.

3

Names of Parts

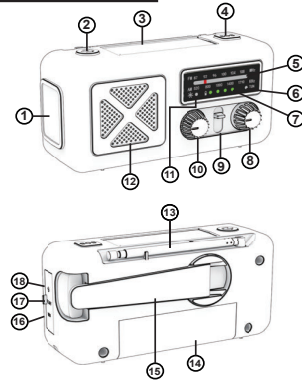

1 Flashlight	10 Tuning Knob
2 Flashlight Switch	11 Radio Signal Light
3 Solar Panel	12 Speaker
4 SOS Alarm	13 Antenna
5 Frequency Dial	14 Battery Container
6 Hand Cranked Charging Indicator	15 Hand crank
7 Battery Indicator	16 USB Output
8 ON/OFF/Volume	17 Type-C Input
9 Band Selector	18 Earphone Jack

4

Specifications

Frequency Range	AM: 520- 1710 KHZ FM: 87- 108 MHZ WB: 62.400- 162.550
Product Size	137x68x50mm 5.39"x2.68"x1.97"
Weight	350g
Product Material	ABS
Battery capacity	3.7V /5000mah 21700 L-Ion
Working Voltage	5V
Output	5V 1A
Input	5V 1A
Flashlight	1W
Waterproof Level	IPX3
Charging Time	6H
Solar panel	5V/ 20mA /0.1W
Full charge usable time	Radio(Max Volume) : 7.5H Flashing Light (Brightest):15H SOS Alarm(Max Volume):5.5H
Hand cranked for 2 minutes usable time	Radio(Max Volume):3 Min Flashing Light(Brightest):16 Min SOS Alarm(Max Volume):2 Min
Speaker	2W 8Ω

Packing list

Radio X 1	User Manual X 1
Type-C USB Cable X 1	Lanyard X 1

5

Directions for Use

SOS ALARM OPERATION

- Press and hold the SOS button for 3 seconds, the device will activate a loud siren and flashing beam.
- Press the SOS button again to turn it off.

SOS Button



RADIO OPERATION

Please fully charge the machine with a USB cable for the first time use.

- Turn the 'volume' Dial clockwise to power on the radio and adjust volume.
- Select WB/FM/AM with band selector.
- Extend the antenna to get better signal.
- Rotate the tuning knob to select channel.
- Green tuning indicator will turn on when a channel is properly selected.



反面

FLASHLIGHT OPERATION

- Press the flashlight switch to turn it on/off.
- Press once for first gear, press twice for second gear, press third to close.

Flashlight Switch



- Avoid flashlight directly into the eyes, or it will hurt the eyes.

8

Battery Indicator

○4 indicator light modes:100%, 75%, 50%, 25%

Input: When charging the device, the power indicator light corresponding to the battery level lights up.

Output: When the radio charges external devices, the remaining battery indicator light comes on.

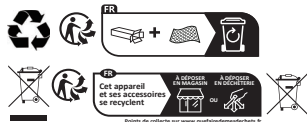
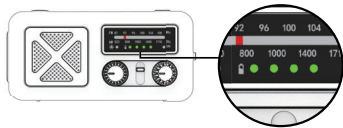

7

C. USB Charging

- Connect the supplied usb cable to the input port on the right side of the unit to charge the built-in lithium battery.
- When charging, the blue light flashes, and when fully charged, the blue light remains on.

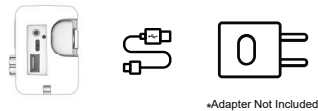

*Adapter Not Included

CHARGE EXTERNAL DEVICES

- Insert the USB cable into the USB output port on the side of the radio and connect to the devices.
- When charging the device, the indicator light turns blue.

Note

- When the power of the unit is low, please turn the handcrank continuously in clockwise or counter clockwise at speed of 130-140RPM for 2 minutes to generate power.
- Or use a 5V 2A adapter to charge the device and activate the battery first.
- For iPhone 15 and later models, please use the original included USB-C cable to connect the device for charging.

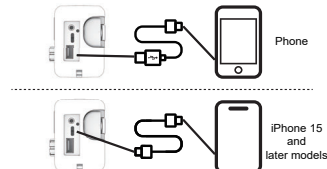

POWER SUPPLYING OPERATION

Note:

- Generally, it is recommended to charge the lithium battery via the USB charging cable.
- Due to the low efficiency of manual charging and solar charging, which require too much time, it is only recommended to use them in emergency situations.
- When using it for the first time or when the device is idle for more than 60 days, please manually turn the crank for 1 minute or charge to activate the battery.
- If the machine is not used for a long time, it must be fully charged before using it again.

A. Hand-Cranking

- Turn the Hand Crank continuously in clockwise or counter clockwise at speed of 130-140RPM to generate power.
- When the handcrank is turning, the charging indicator lights turn red, when stop hand cranking the lights goes out.

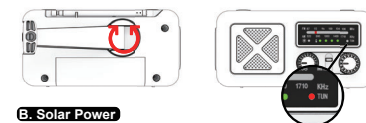

B. Solar Power

- Expose the radio solar panel in direct sunlight.
- The solar indicator light will be turn red when the solar panel is charging.
- When the solar panel is obstructed, the indicator light goes out.

NOTE: It is difficult to fully charge the unit with solar panel, which is mostly used for maintaining the battery.



INSTRUCTIONS AND PRECAUTIONS

YX-218-N

(Read all instructions and precautions before use)

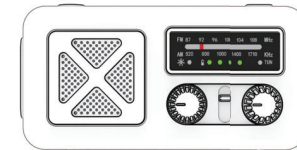

正面

<https://nitigo.com/>
support@nitigo.com



MADE IN CHINA

V2 2024-12-25

6

1

This device complies with part 15 of the FCC Rules. Operation is subject to the following two conditions: (1) this device may not cause harmful interference, and (2) this device must accept any interference received, including interference that may cause undesired operation.

Any changes or modifications not expressly approved by the party responsible for compliance could void the user's authority to operate the equipment.

NOTE: This equipment has been tested and found to comply with the limits for a Class B digital device, pursuant to Part 15 of the FCC Rules. These limits are designed to provide reasonable protection against harmful interference in a residential installation. This equipment generates, uses and can radiate radio frequency energy and, if not installed and used in accordance with the instructions, may cause harmful interference to radio communications. However, there is no guarantee that interference will not occur in a particular installation.

If this equipment does cause harmful interference to radio or television reception, which can be determined by turning the equipment off and on, the user is encouraged to try to correct the interference by one or more of the following measures:

- Reorient or relocate the receiving antenna.
- Increase the separation between the equipment and receiver.
- Connect the equipment into an outlet on a circuit different from that to which the receiver is connected.
- Consult the dealer or an experienced radio/TV technician for help.