



## P20 QUICK MANUAL INSTRUCTION



## Switch on/off

Default English voice announcement at start-up  
(Disconnect Wireless)



Press and hold for 3 seconds  
to switch on/off



boot-up beep



LED flash

## Wireless connection



**Wireless not connected**  
LED light blinks fast



Wireless mode tone



**Wireless connection successful**  
LED light flashes slowly

## Voice assistant / lighting



Voice assistant key  
(under successful  
Wireless connection)



short press



Wake Up AI  
Voice Assistants



RGB  
Illumination



Long press  
(RGB light effect  
off by default)



Long press the mode  
button to turn on RGB  
and switch light effect  
modes to the final mode  
to turn off RGB

## Pairings



Mode key



Short press to switch to Single channel Intercom mode  
(Short press again to switch to music sharing mode)



In conversation mode



Press and hold this button to speak  
Let go to exit the conversation status

**Connection conditions:** the machines need the same model to be paired, unlimited number of people within the effective distance.  
**First connection:** after the two machines are switched on, press the mode key to switch to single channel intercom mode, when one of them needs to speak, press and hold the single channel intercom key without letting go, it can speak and let go to exit; when the other one needs to speak, the same operation can realise the single channel intercom.

## Music function

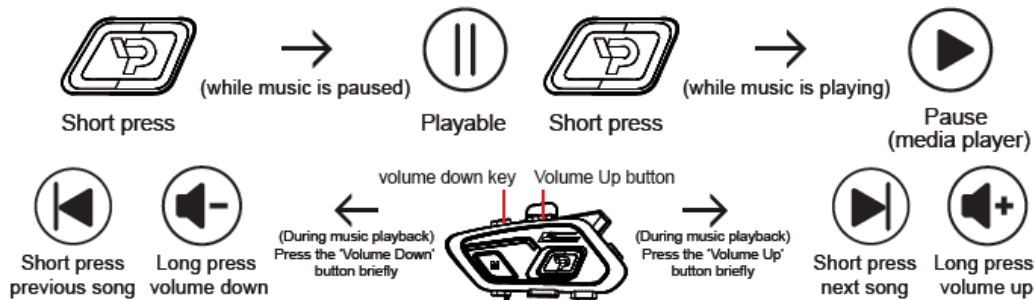

## Matching reset

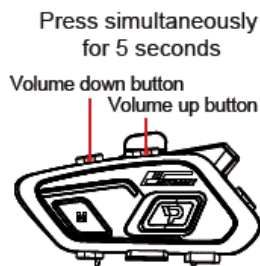

Introduction to Wireless intercom connection operation (Single channel Intercom and music sharing are turned off by default every time you switch on)

### I: Single channel Intercom mode (unlimited number of persons within effective distance)

After the two machines are switched on, both short press the mode key to switch to the single channel intercom mode, when one of them needs to speak, press and hold the single channel intercom key without letting go, you can speak, let go and exit; when the other one needs to speak, press and hold the single channel intercom key without letting go, you can speak, let go and exit, and so on and so on, and repeat the operation, you can realise the single channel intercom.

### II: Restore Factory Settings

Switch on the computer without connecting Wireless and Single channel Intercom, press and hold the volume down and volume up buttons at the same time for 5S, after the indicator light blinks fast, it restores the factory settings and clears all the pairing information.

### III: Music sharing (unlimited number of people within effective distance)

When both devices are switched on, both short press the mode button to switch into music sharing mode. A mobile phone is connected to the device to play music wirelessly, and the prompt tone "Music Sharing Transmit Mode" or "Music sharing Receive Mode" is played. Start the music sharing pairing: one device needs to be in the music sharing transmitting mode and other devices are in the music sharing receiving mode. After the pairing is successful, the music sharing receiving mode terminal will have a successful connection prompt tone accompanied by the "Music sharing connection success" prompt tone, indicating that the music sharing is successful. Please note that the music sharing transmitting terminal will not have a successful connection prompt tone. If two devices are connected to play music wirelessly, they can only be shared by entering the music sharing transmitter.

### IV: Telephone priority

After switching on the machine, the machine is connected to Wireless, no matter which mode the machine is in, when the machine calls or goes to the phone, it will automatically enter the phone mode as a priority, and after hanging up, it will resume the corresponding mode.

# | Product Overview



## Important Reminder:

Before installing the headset, please connect your mobile phone according to the quick manual guide to test the sound effect and volume.

If there is a big difference in sound effect and volume after installing into the helmet, please adjust the position of the speaker inside the helmet.

## Single channel intercom schematic

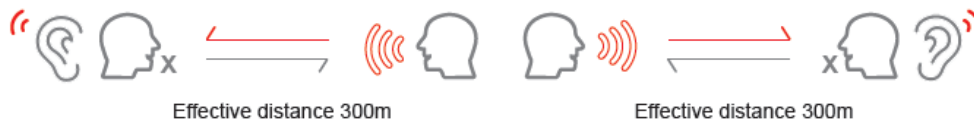

## Music Sharing

Single channel intercom: only one channel can be allowed to enter the speaking state, and the others cannot be in the speaking state

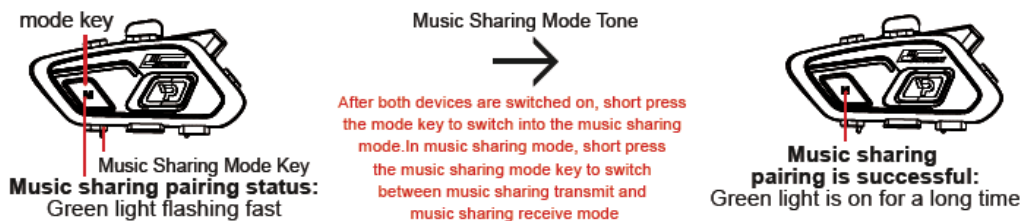

## Telephone function

Double click to switch manual/automatic answer  
(When Wireless is not connected)

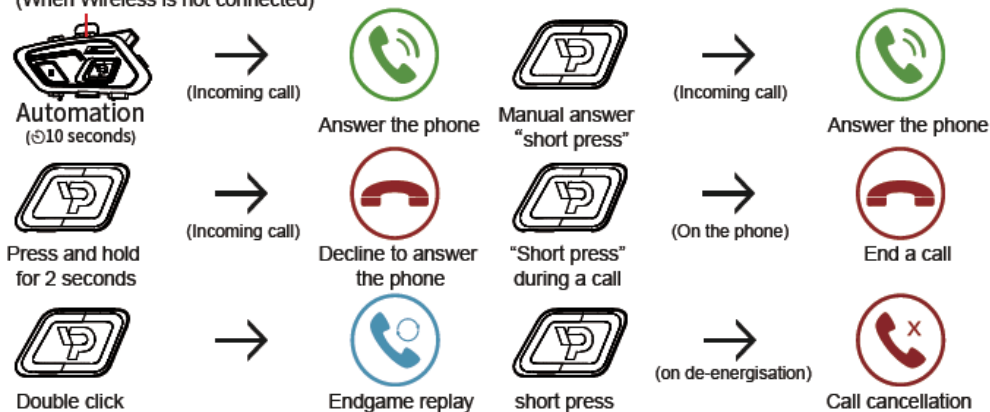

## Product List

P20 host\*1



Hook and loop stickers  
installation package\*1

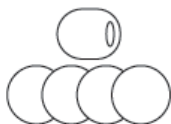

Speaker microphone\*1

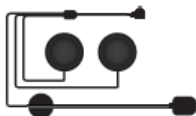

Type-C Charging Cable\*1

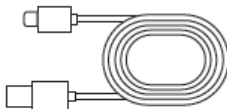

Clip-on base\*1

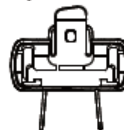

Instruction manual\*1

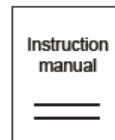

## Caveat

1. Please do not put the product into the open fire to avoid explosion;
2. Please do not disassemble the product to avoid damage to the electronic devices;
3. Please do not close to sharp objects to cause damage to the product;
4. Long time no use, please place in a dry place;
5. Before using the Wireless device, please fully charge it;
6. If the red light does not come on when charging, it may be the voltage is too low;
7. To extend the life of the built-in polymer battery, please charge the device at least once a month.

## FCC Information and Copyright

This equipment has been tested and found to comply with the limits for a Class B digital device, pursuant to part 15 of the FCC Rules.

These limits are designed to provide reasonable protection against harmful interference in a residential installation. This equipment generates,

uses and can radiate radio frequency energy and, if not installed and used in accordance with the instructions, may cause harmful interference

to radio communications. However, there is no guarantee that interference will not occur in a particular installation. If this equipment does

cause harmful interference to radio or television reception, which can be determined by turning the equipment off and on, the user is

encouraged to try to correct the interference by one or more of the following measures:

- Reorient or relocate the receiving antenna.
- Increase the separation between the equipment and receiver.
- Connect the equipment into an outlet on a circuit different from that to which the receiver is connected.
- Consult the dealer or an experienced radio/TV technician for help.

### 15.19 Labelling requirements.

This device complies with part 15 of the FCC Rules. Operation is subject to the following two conditions:

- (1) This device may not cause harmful interference, and
- (2) this device must accept any interference received, including interference that may cause undesired operation.

changes or modifications not expressly approved by the party responsible for compliance could void the user's authority to operate the equipment.

**FCC RF warning** statement: the device has been evaluated to meet general RF exposure requirement , The device can be used in portable exposure condition without restriction.