

# Use Instruction

- Thank you for purchasing our remote control car with colorful headlight and wheel lights. Please read the following use instruction carefully and know our product better before use to ensure correct and enjoyable use experience.

## ⚠ CAUTION:

### ■ BATTERY SUPPLIED PRODUCT

Suitable for ages 6+. Like all electric products, precautions should be observed during operation and use to prevent electric shock.

### How To Insert the Battery

1. Turn off the switches on the car and press the ON-OFF button one the remote controller to turn off the remote control. (if has switch)
2. Open the battery cover by a crosshead screwdriver. (Include in the package)
3. Insert the batteries follow the way shows on picture below. (Car battery and remote controller battery)
4. Close the battery compartment cover.

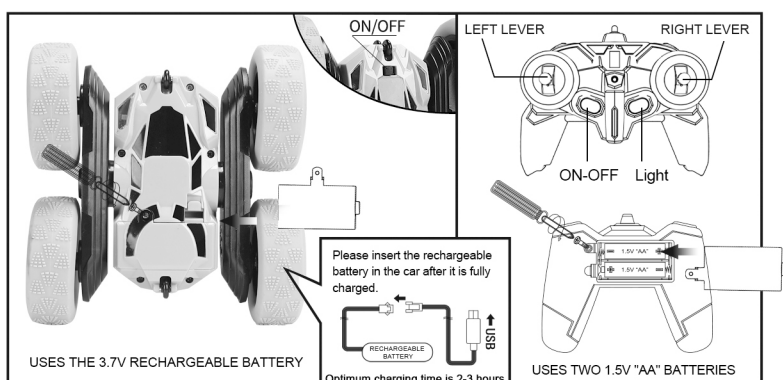

### How To Play

1. Turn on the switches on the car and press the ON-OFF button one the remote controller to turn on the remote control.
2. Pairing the controller with the car first, (red led light stop flashing means pairing successfully), then you can operate the car.
3. When your R/C model car begins to lose performance, power or function, it is time to charge the batteries!
4. Battery Charging Method: Insert the rechargeable battery USB port into the corresponding USB port, for example, computer, mobile phone or other corresponding USB port and insert the wire connector of the rechargeable battery into the wire connector at the other end of the USB cable.

### Basic operating pictures illustrating how to use the RC Car

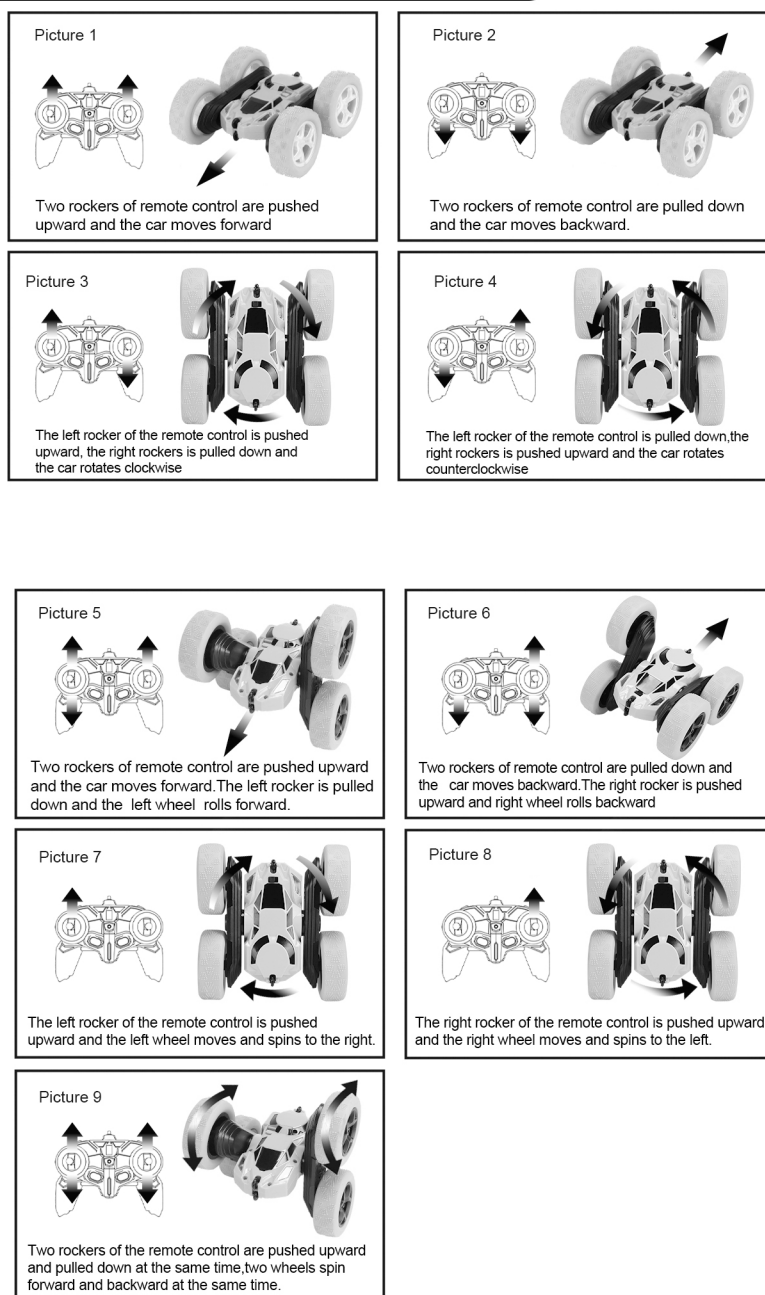

### Battery safety Information

1. Power terminals must not be short-circuited.
2. Non-rechargeable batteries cannot be charged.
3. Rechargeable batteries may only be charged under the supervision of an adult.
4. Different types of batteries or new and used batteries are not to be mixed.
5. Dispose the batteries safely. Don't dispose of batteries in fire as they may explode.
6. The battery charger's wires, plugs, casing and other components should be checked regularly for damage and discontinued if found until repaired in good condition.
7. Exhausted batteries should be removed from the toy car.
8. Keep the use instructions for future reference, it has important information.
9. Package should be kept since it has important information.
10. Rechargeable batteries are to be removed from the toy car before charging.

### Care and Maintenance

1. Always remove batteries from the toy car when it is not being used for a long time.
2. Wipe the toy car gently with a clean dry cloth.
3. Keep the toy car away from direct sunlight and avoid high temperatures.



### Pay attention to

1. In the case of inefficient power, the flipping function will be lost during playing.
2. Please do not run the car on the smooth ground, otherwise the flipping function will be lost during playing.
4. Please make sure the battery charged fully at one time.



This device complies with Part 15 of the FCC Rules. Operation is subject to the following two conditions: (1) this device may not cause harmful interference, and (2) this device must accept any interference received, including interference that may cause undesired operation.

Changes or modifications to this unit not expressly approved by the party responsible for compliance could void the user's authority to operate the equipment.

NOTE: This equipment has been tested and found to comply with the limits for a Class B digital device, pursuant to Part 15 of the FCC Rules. These limits are designed to provide reasonable protection against harmful interference in a residential installation. This equipment generates uses and can radiate radio frequency energy and, if not installed and used in accordance with the instructions, may cause harmful interference to radio communications. However, there is no guarantee that interference will not occur in a particular installation. If this equipment does cause harmful interference to radio or television reception, which can be determined by turning the equipment off and on, the user is encouraged to try to correct the interference by one or more of the following measures:

- Reorient or relocate the receiving antenna.
- Increase the separation between the equipment and receiver.
- Connect the equipment into an outlet on a circuit different from that to which the receiver is connected.
- Consult the dealer or an experienced radio/TV technician for help.

This device and its antenna(s) must not be co-located or operation in conjunction with any other antenna or transmitter.

#### Radiation Exposure Statement

The device has been evaluated to meet general RF exposure requirement in portable exposure condition without restriction.