



USER MANUAL

AI ADAPTER

SDM660

Copyright © . All rights reserved

Interface

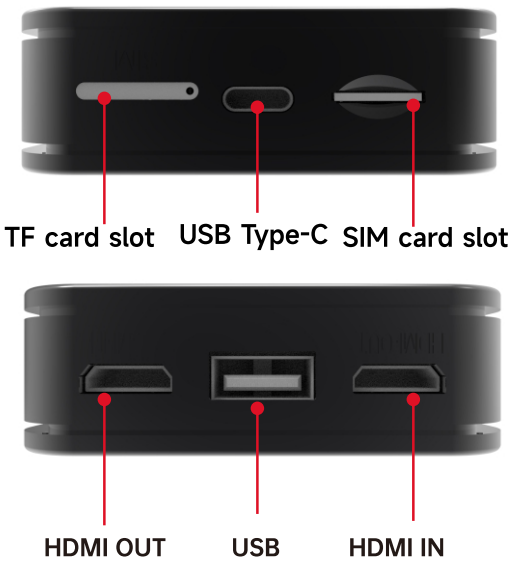

NOTE! Please follow the installation below if your car is equipped with a Type-C port for CarPlay.

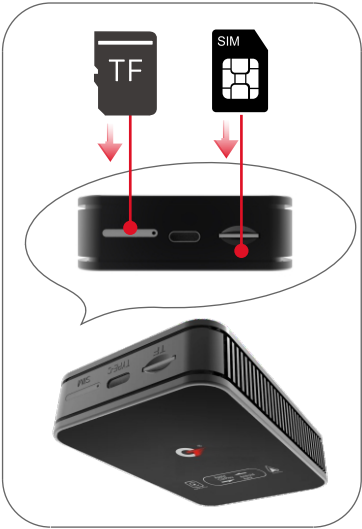
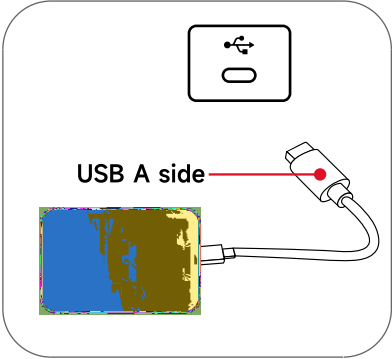

User Interface

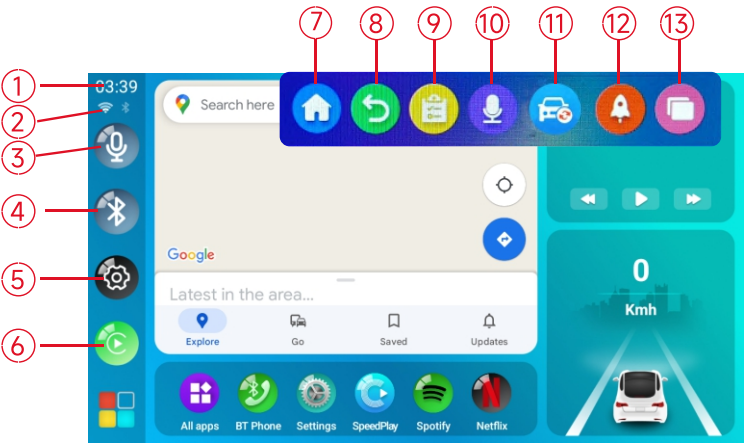

1. Clock

2. WiFi BT status

3. microphone

4. Bluetooth

5. set up

6. CarPlay

7. Home
8. Back

9. Recents

10. Voice assistant

11. Back to factory system

12. Clear

13. Split screen

Fibocom SC218series

4G SoC Module

Product advantages

- Supports multiple cameras and supports simultaneous operation of two cameras
- Support 4K@30fps Video recording and playback
- Support for MIPI DSI (2560x1600@60fps + 1080P@60fps Over DP)
- Integrated multi constellation GNSS receiver to meet the needs of fast and accurate positioning in different environments
- Comprehensive coverage of various network formats
- Support for dual USB

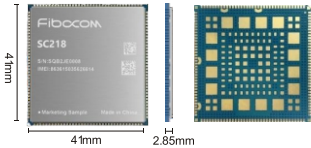

The SC218 series is a multi network LTE Cat 4 intelligent module launched by Guanghetong. Based on the Qualcomm SDM660 platform design, it adopts a high-end eight core processor, integrates a high-performance graphics engine, supports multi-channel camera input, and can smoothly play 4K videos. The module adopts LCC+LGA packaging, which is compatible with Guanghetong's SS808, SQ808, and SC128 series, making it convenient for customers to flexibly develop terminal devices.

The SC218 series supports multiple standard long-distance communication modes and dual band Wi-Fi/BT close range wireless transmission technology, as well as GNSS wireless positioning technology. SC218 is a pre installed and open Android operating system with multiple extension interfaces such as MIPI/USB/UART/SPI/I2C, making it the preferred solution for the core system of wireless intelligent products.

The SC218 series of intelligent modules can be widely applied in industries such as wireless intelligent payment, handheld, in car, smart home, smart city, etc. It is a globally outstanding core system solution for wireless intelligent products.



Qualcomm Octa-core



2560x1600@60fps



Wi-Fi 802.11 b/g/n



BT 5.0 BLE



Android13



GPS/GLONASS/Beidou



Reference design and application development support

Smart(LTE Cat 4)	SC218-EAU	SC218- NA	SC218- JP
region	Europe/Australia/Brazil/Asia	North America	Japan
Basic characteristics			
package	148 LCC+ 133 LGA		
CPU	Qualcomm's SDM660, 4xKryo Gold 2.2(or 2.4)GHz + 4xKryo Silver 1.8GHz		
GPU	A512 650MHz		
Memory	4GB LPDDR4X RAM;64GB UFS		
size (mm)	41x41x2.85		
LTE FDD	B1/2/3/4/5/7/8/20/28	B2/4/5/7/12/17	B1/3/8/18/19/21/26/28
LTE TDD	B38/40/41	B41/48	B41
WCDMA	NA	NA	NA
GSM	NA	NA	NA
Wi-Fi	802.11 b/g/n		
BT	5.0 BR/EDR/BLE		
GNSS	GPS/Beidou/GLONASS		
OS	Android 13		
working voltage	3.5~4.35V		
operation temperature	-30°C - +75°C		
weight	9.6±0.1g		
transfer rate			
LTE FDD(Mbps)	Max 150(DL)/ 75(UL)		
LTE TDD(Mbps)	Max 130(DL)/ 45(UL)		
WCDMA(Mbps)	HSPA: Max 11(UL)		
	HSPA+: Max 42(DL)		
EDGE/GPRS(Kbps)	EDGE: Max 296(DL)/ 236.8 (UL)		
	GPRS: Max 107(DL)/ 85.6(UL)		
video processing			
Video Coding	4K30: HEVC, H264, VP8, and MPEG-4		
Video decoding	4K30 8-bit: H.264, VP8, and VP9, 4K30 10-bit: HEVC		
interface			
LCD	1 set of 4-Lane MIPI_DSI interface, supports up to 2K 1 set of DP interfaces, supporting DP1.4 and up to FHD/ WUXGA@60Hz		
Camera	2 sets of 4-Lane MIPI_CSI interface, configurable as 4+4 Lane or 4+2+1 Lane ISPx2 (13MP+13MP or 24MP)		
UART	2 sets of 4-Lane MIPI_CSI interface, configurable as 4+4 Lane or 4+2+1 LaneISPx2 (13MP+13MP or 24MP)		
I2C	Multiple sets of I2C interfaces can be used for peripheral devices such as TP, Camera, Sensor, etc		
USB	2 sets of USB interfaces A set of USB3.1 interfaces, backward compatible with USB2.0. USB3.1 supports SS (5Gbps) mode and does not support software download; USB2.0 supports HS(480Mbps) mode, backward compatible with FS and LS; Support software download; Support HUB extension USB OTG. A set of USB2.0 interfaces that only support Host mode		
SDIO	30 GPIOs		
GPIO	30 GPIOs		
Speaker	1W on 8Ω load in Class-D mode		
Receiver	1 x Mono, AB		
Mic	2 x analog microphones		
Handset	Stereo CLASS AB		
USIM	2 x SIM card,support dual-SIM dual-standby		
Keys	Power on/off /Volume up /Volume down /Reset		
authentication			
Regulatory certification	RoHS*/CE*/REACH*	FCC*/RoHS*/IC*	RoHS*/TELEC*/JATE*
Operator certification	NA	NA	NA
Industry certification	HF*	NA	NA

*Planned/Under Development

FCC Warning:

This equipment has been tested and found to comply with the limits for a Class B digital device, pursuant to part 15 of the FCC Rules. These limits are designed to provide reasonable protection against harmful interference in a residential installation. This equipment generates, uses and can radiate radio frequency energy and, if not installed and used in accordance with the instructions, may cause harmful interference to radio communications. However, there is no guarantee that interference will not occur in a particular installation. If this equipment does cause harmful interference to radio or television reception, which can be determined by turning the equipment off and on, the user is encouraged to try to correct the interference by one or more of the following measures:

- Reorient or relocate the receiving antenna.
- Increase the separation between the equipment and receiver.
- Connect the equipment into an outlet on a circuit different from that to which the receiver is connected.
- Consult the dealer or an experienced radio/TV technician for help.

Caution: Any changes or modifications to this device not explicitly approved by manufacturer could void your authority to operate this equipment.

This device complies with part 15 of the FCC Rules. Operation is subject to the following two conditions:

(1) This device may not cause harmful interference, and (2) this device must accept any interference received, including interference that may cause undesired operation.

This equipment complies with FCC radiation exposure limits set forth for an uncontrolled environment. This equipment should be installed and operated with minimum distance 20cm between the radiator and your body.