

WIFI CAMERA USER MANUAL

■ Warranty Card

Warranty instruction:

- in warranty period, if there is any breakdown which caused by the product own defect, please connect with dealers or after-sale server of our company.
- Be sure not to use surface mail or cash on delivery to send back the product.
- Free maintain will not be given under the following circumstance:
 - Without valid warranty certificate or purchasing invoice or receipt.
 - The breakdown and damage caused by personal reasons, wrong usage and force majeure.
 - The breakdown and damage caused by maintenance, refit and dismantle movement of a non-our-company authorized maintainer.
 - Exceed the warranty period of our company's prescription.

Warranty period: one year

Your Name : _____ Your TEL : _____

Address : _____

Dealer : _____ Contact person : _____

TEL : _____ Purchase time : _____

In order to provide you with better service, please take good care of the warranty card, thank you for using our products!

■ User notice

Before use, please read the manual carefully and strictly follow it during use. Thank you for purchasing this product.

▲ Special statement:

This manual only introduces basic operations. For detailed product manuals and related software, please go to www.topscloud.net/doc_eng.rar download.

Please refer to the actual product, and the interface of different products may be different, the actual interface shall prevail. The instructions are for reference only.

The contents of the manual will be updated in real time with the product without further notice.

The manual may contain technical inaccuracy, or inconsistent with the product function or printed for the wrong place, please refer to our company's final interpretation.

▲ Installation precautions:

- Please change the user password while using this product to avoid being misappropriated by criminals.
- Do not install the device in a place that is damp, dusty, or accessible to children.
- Please install the device in a well-ventilated place, and do not block the vents of the device.
- Please use and store within the allowable temperature range, and do not disassemble the device at will.

01 To get started, you need

1. Download the APP "TSEye" from App Store or Google Play OR Scan below QR code to download the APP.



Android



iOS

2. Power on

Use the power adapter to connect the camera to the power socket, you will hear voice prompts such as "dudu".

Note: If the camera does not have a prompt sound for a long time, you can press and hold the camera Reset button until you hear the prompt "bi" and release it to restore the camera to factory settings and then configure the network. (If you need local storage, please install the memory card firstly, then power on the device).

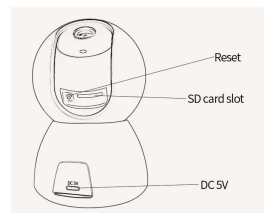

02 Add Camera

1. Register an account on your APP and login.
2. Click the "+" button (Figure 1).
3. Click the "Indoor Camera" (Figure 2).
4. Set network configuration according to the APP interface step-by-step guide. (Figure 3)

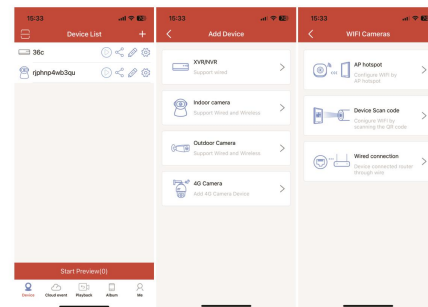

Figure 1

Figure 2

Figure 3

Configure network connection ways

Method 1: AP hotspot

Enter your Wi-Fi network and password. (Figure 4)

Follow APP interface guide to connect camera hot spot (Figure 5), after connected, back to APP, then camera will connect wifi network automatically. When the camera emits a "WiFi link succeeded" prompt, it means that the camera has successfully configured the network. (Figure 6)

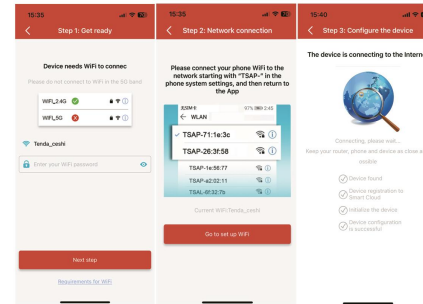

figure 4

figure 5

figure 6

Method 2: Device Scan code

Enter your Wi-Fi network and password. (Figure 7)

Scan the QR Code with the camera. (Figure 8), and then you will hear beep from the camera, click and wait for the network configuration to be completed. (Figure 9)

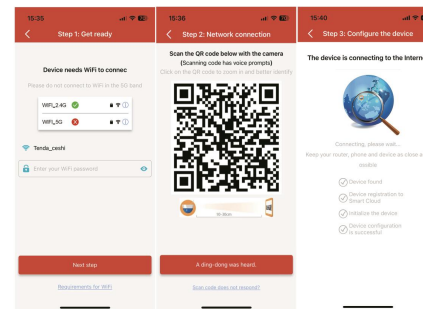

figure 7

figure 8

figure 9

Method 3: Wired Connection

Use network cable connect Camera to router.

Your mobile phone connect to the same router WiFi as your camera and click next, the camera will show in the search list. (Figure 10)

Check and add camera. (Figure 11 and Figure 12)

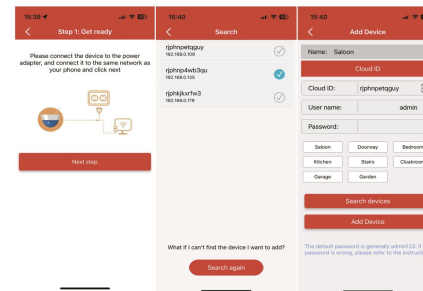

figure 10

figure 11

figure 12

03 Preview

After the configuration is completed, the device is displayed in the device list. (Figure 13) Click to open the real-time preview screen, and carry out relevant operations and settings. (Figure 14)

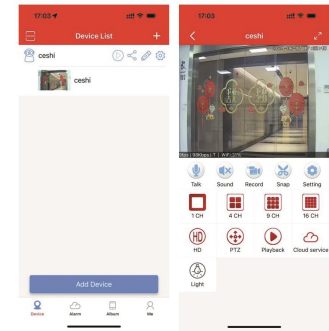

figure 13

figure 14

FCC Statement

This device complies with Part 15 of the FCC Rules. Operation is subject to the following two conditions:

- (1) This device may not cause harmful interference.
- (2) This device must accept any interference received, including interference that may cause undesired operation.

Caution: Any changes or modifications not expressly approved by the party responsible for compliance could void the user's authority to operate the equipment.

Note: This equipment has been tested and found to comply with the limits for a Class B digital device under Part 15 of the FCC Rules. These limits are designed to protect reasonably against harmful interference in a residential installation. This equipment generates uses and can radiate radio frequency energy and, if not installed and used by the instructions, may cause harmful interference to radio communications. However, there is no guarantee that interference will not occur in a particular installation. Suppose this equipment does cause harmful interference to radio or television reception, which can be determined by turning the equipment off and on. In that case, the user is encouraged to try to correct the interference by one or more of the following measures:

- (1) Reorient or relocate the receiving antenna.
- (2) Increase the separation between the equipment and receiver.
- (3) Connect the equipment to an outlet on a circuit different from the receivers.
- (4) Consult the dealer or an experienced radio/TV technician for help.

Radio Frequency Exposure Statement

The device has been evaluated to meet general RF exposure requirements. The device can be used in fixed/mobile exposure condition. The min separation distance is 20cm.