

Wireless Microphone

User Manual

M29HDC

Product Introduction

Thanks for choosing our product. This product is a smart wireless microphone that provides professional-grade recording output. Plug and play, no app required. Multiple uses. It can be used in online live broadcast, video teaching, and other occasions. The wireless Microphone consists of two parts, one is Microphone transmitter, the other one is Type-C receiver. (See as below picture)



(Transmitter)

(Receiver)

Function Introduction

1. Transmitter function introduction

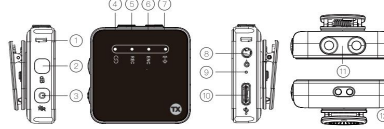

- ① Furry wind muff bracket buckle: used to install the buckle of the windproof wool cover
- ② dB key: short press in the recording state, and the recording gain volume can be adjusted in a three-step cycle. Press the first time, the green light flashes once, indicating the first level of volume; Press the second time, the green light flashes twice, indicating the second level of volume; Press the third time, the green light flashes three times, indicating the third level of volume; press and hold for 2 seconds to switch noise reduction

- ③ Power button: long press 3S, in the recording state, short press to mute
- ④ Connection indicator light: The green light flashes after power on, and the green light goes out after the connection is successful
- ⑤ REC indicator light: When recording, the green light is always on, and when muted, the green light flashes
- ⑥ Noise reduction indicator light: When the noise reduction is turned on, the green light is always on, and when the noise reduction is turned off, the light is off. Boot default noise reduction
- ⑦ Battery indicator light: flashes slowly when the battery is low, the green light is always on when it is charging, and the light is off when it is fully charged
- ⑧ External MIC 3.5mm audio input port
- ⑨ Repair button
- ⑩ Type-C charging port
- ⑪ Pickup microphone
- ⑫ 360° rotatable back clip

2. Receiver function introduction

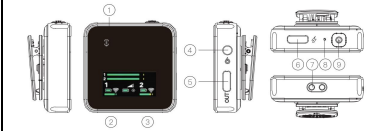

- ① Battery indicator light: The red light flashes once when the battery is turned on, and it flashes slowly when the battery is low. The red light is always on when charging in the charging case, and the light is off when it is fully charged.
- ② MIC 1 pairing indicator light: display the volume, recording status, power level and signal strength
- ③ MIC 2 code indicator light
- ④ Wired earphone/output to digital camera port
- ⑤ Type-C output recording port
- ⑥ Type-C charging port (can charge the mobile phone at the same time)
- ⑦ 360° rotatable back clip
- ⑧ Repair button
- ⑨ Power button

Usage Method

1. The operation method of connecting mobile phone to record/record video
 - ① Long press the receiver and transmitter to turn on, and then automatic pairing successful.
 - ② Used the connector to connect the receiver and mobile phone
 - ③ Turn on the camera APP in your phone can be carried out Record video.
2. The operation method of connecting to the mobile phone live broadcast
 - ① Long press the receiver and transmitter to turn on, and then automatic pairing successful.
 - ② Used the connector to connect the receiver and mobile phone
 - ③ Turn on the live broadcast APP in the mobile phone to broadcast live
3. Operation method of connecting digital camera for recording/recording video
 - ① Long press the receiver and transmitter to turn on, and then automatic pairing successful.
 - ② Used the 3.5mm jack cable to connect the receiver and digital camera
 - ③ Turn on the digital camera to record video

Product Parameter

Transport Protocol: 2.4G digital transmission input protocol (128-bit encrypted transmission)
 Transmission distance: ≥100 metres
 Sound Delay: ≤20ms
 One with two: support
 Adjustable gain: support (three-speed cycle)
 Mobile phone and camera equipment: support (3.5MM TRS)
 Mobile phone synchronous charging: support
 Microphone sensitivity: -30dB ± 3dB omnidirectional condenser microphone
 Frequency Response: 20Hz-20KHz
 Sampling Rate: 48KHz
 SNR: ≥75dB
 Working current: ≤25mA
 Shutdown current: ≤50uA
 Working Time: 7H
 Adapter: 5V/1A
 Charging Port: Type-C
 Charging Time: 1-1.5H
 Charging case: optional
 Working temperature: -10°C-50°C
 Battery capacity: 250mAh+2200mAh

Packing List Contents

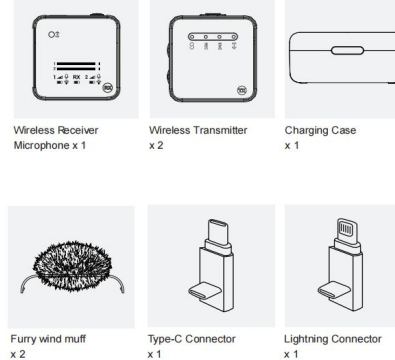

Packing List Contents

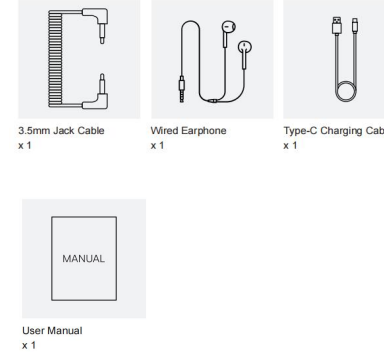

Attention

1. Please disconnect the charging and turn off before cleaning the device.
2. Non-professionals should not disassemble the equipment by themselves to avoid equipment failure and loss of repair rights.
3. Do not place the device in direct sunlight to avoid premature aging of electronic parts.
4. Avoid using it in places with flying dust or dirty environment. Dust may easily cause equipment failure.
5. Do not place the device in an environment that is too cold or too hot, causing the device to malfunction.
6. It is recommended that the ambient temperature should not exceed -10°C~45°C, Relative temperature 10%~95%.
7. Do not put anything into the device to avoid short circuit or circuit damage. Do not spill any liquid on the device.
8. Avoid friction and collision between the device and hard objects, so as not to cause surface scratches, falling off or other hardware damage.
9. The products shall not be exposed to such conditions as sunlight, fire or similar overheating.
10. This manual contains important information, please keep it.

FCC Warning:

This equipment has been tested and found to comply with the limits for a Class B digital device, pursuant to part 15 of the FCC Rules. These limits are designed to provide reasonable protection against harmful interference in a residential installation. This equipment generates, uses and can radiate radio frequency energy and, if not installed and used in accordance with the instructions, may cause harmful interference to radio communications. However, there is no guarantee that interference will not occur in a particular installation. If this equipment does cause harmful interference to radio or television reception, which can be determined by turning the equipment off and on, the user is encouraged to try to correct the interference by one or more of the following measures:

- Reorient or relocate the receiving antenna.
- Increase the separation between the equipment and receiver.
- Connect the equipment into an outlet on a circuit different from that to which the receiver is connected.
- Consult the dealer or an experienced radio/TV technician for help.

Caution: Any changes or modifications to this device not explicitly approved by manufacturer could void your authority to operate this equipment.

This device complies with part 15 of the FCC Rules. Operation is subject to the following two conditions:

(1) This device may not cause harmful interference, and (2) this device must accept any interference received, including interference that may cause undesired operation.

This equipment complies with FCC radiation exposure limits set forth for an uncontrolled environment. This equipment should be installed and operated with minimum distance 0cm between the radiator and your body.