



IP65



20000H Easy to install TUYA WIFI Bluetooth control -20°C~+45°C

Smart Wall Pack Light

Features

1. RGBCW IC with AI colorful control , cool & warm
2. App control , 16 million colors , Music sync
3. Give lighting effects more possibilities



Application



Application: wooden fences, backyard, railing, wall, pool decks, porches, patios, garage doors, gardens, villas, steps, fences, passages, stairs, etc.

Product Size

BYR-OWP-STOI

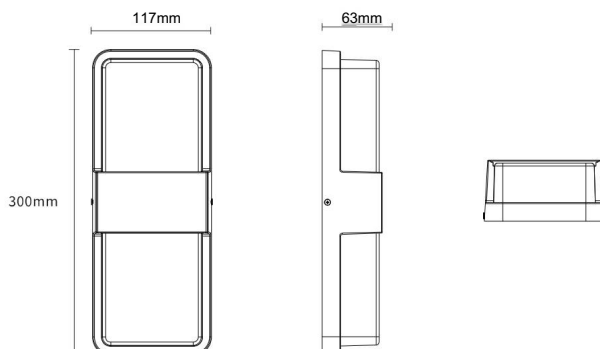

Technical Details

Model	BYR-OWP-STOI
Power	22W
Voltage	Input: AC 100-240V, 50/60Hz Output: DC 24V, 0.92A, 22W
Led type	3030RGB+2835 CCT(6500K+2700K)
Led Qty	60pcs3030 RGB+60pcs 2835 CCT(6500K+2700K)
Color temperature	RG B+CCT(6500K+2700 K)
Beam angle	120°
Lumens	R:30±10%lm G:52±10%lm B:8±10%lm6500K:52±10%lm2200K: 44±10%lm
CRI	>80
Appearance color	Black+white
Material	Aluminium+ABS+PC
Connection	2.4GHz Wifi+Bluetooth
Operating temperature	-20°C~+45°C
Storage temperature	-25°C~+55°C (25°C is best-fit)

Installation

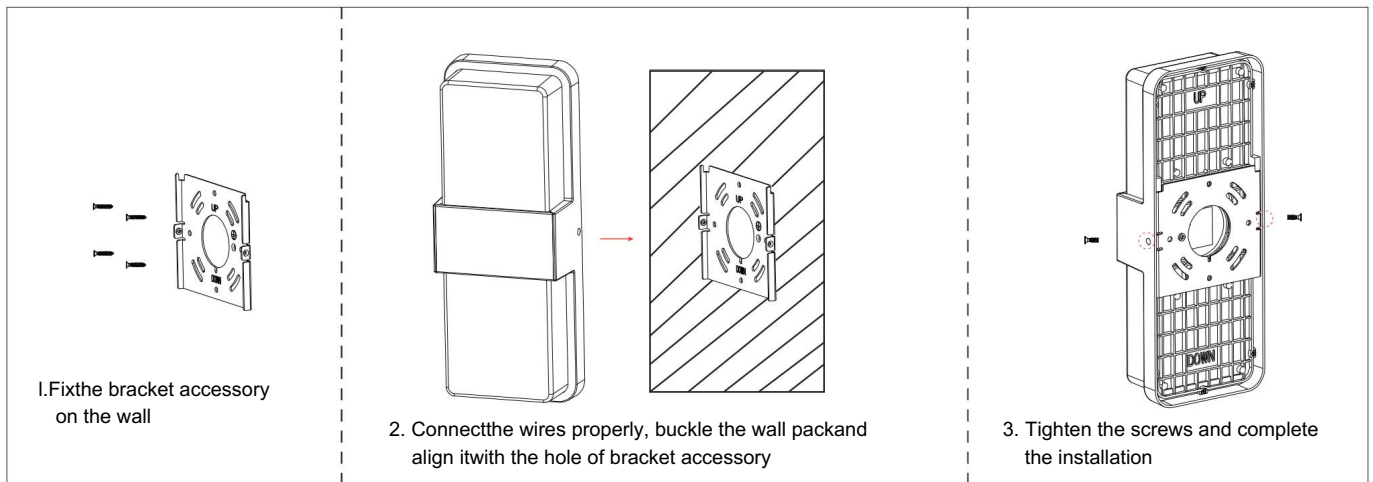

Packing

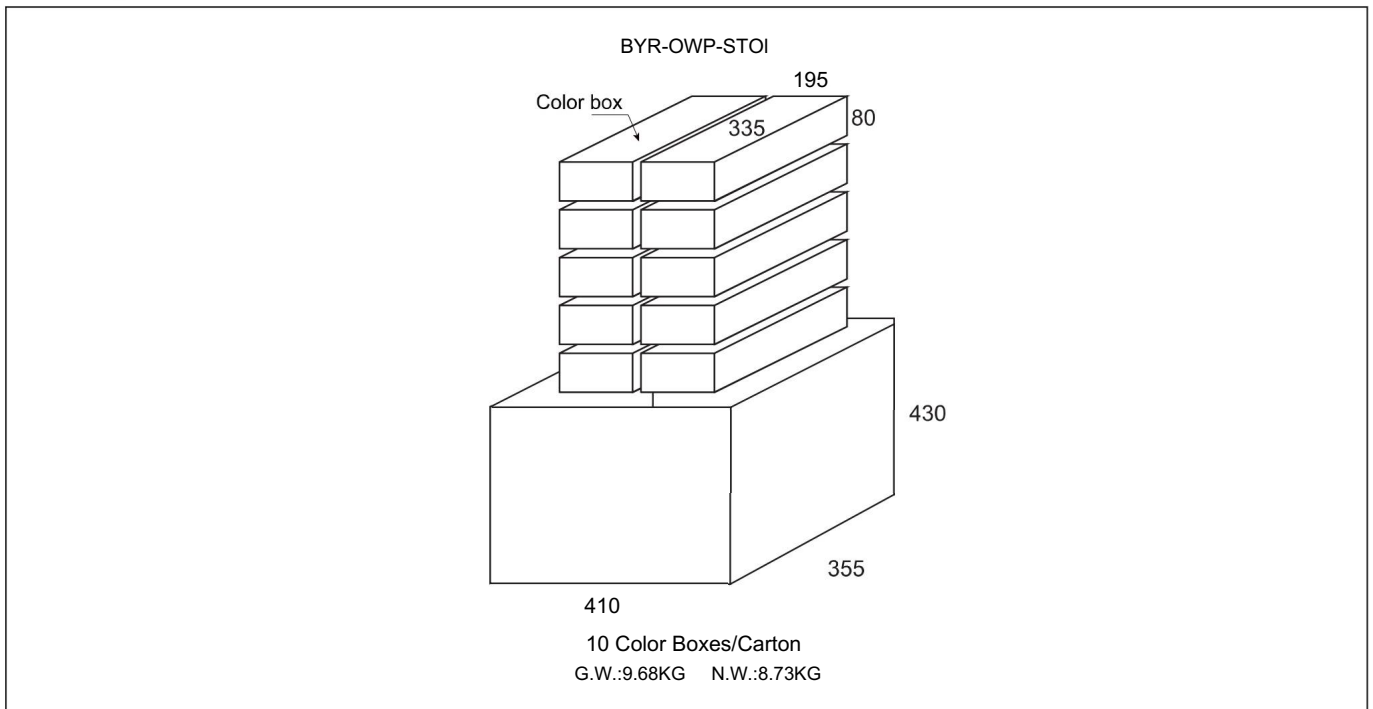

Model	Color Box	N.W./Box	Boxes/Carton	Carton	N.W./Carton
BYR-OWP-ST01	335*195*80mm	0.97kg	10pcs	355*410*430mm	9.7kg

Packing List

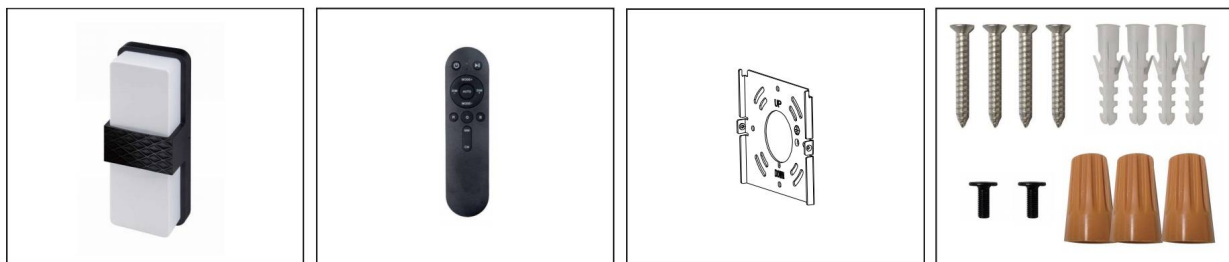

Wall pack

Remote control*1

Bracket accessory

Accessories

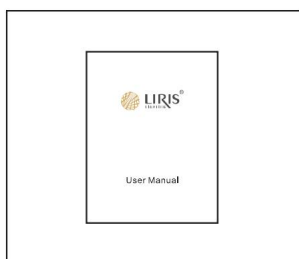

User manual*1

Remote Controller Introduction

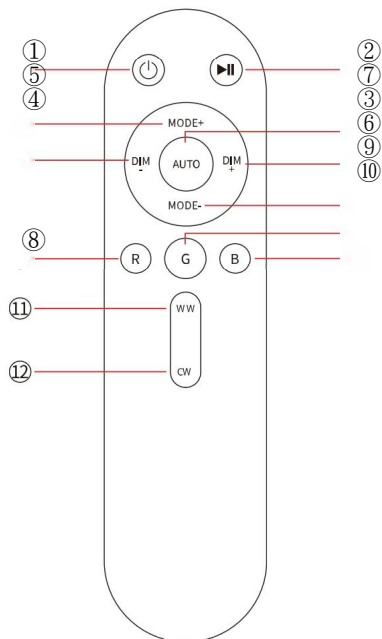

- | | |
|-----------------|---|
| ① ON/OFF | The remote control can control both networked and non-networked lights. When the light is not networked & networked, you need to turn off the power of the device for 5 seconds, then turn on the power of the light again and press the on/off button, the light appears to breathe or blink to complete the pairing. If the pairing is not successful, please repeat the steps. |
| ② ▶ II | Scenes Pause/Play |
| ③ DIM + | Brightness+ & Scene Speed+ |
| ④ DIM- | Brightness- & Scene Speed- |
| ⑤ MODE+ | Previous Scene |
| ⑥ MODE- | Next Scene |
| ⑦ AUTO | Auto Scenes Cycle |
| ⑧ R | Red |
| ⑨ G | Green |
| ⑩ B | Blue |
| ⑪ WW | Warm White |
| ⑫ CW | Cool White |

App Functions

Connect The Device Via The "tuya" App

1. First, search for the "Tuya" APP in the Apple Store or App Market, download and install it, or scan the QR code below to download and install

<https://smartapp.tuya.com/m/asmartapp.tuya.com/smartlife>



Supported device types



2. Product distribution network (please confirm that the mobile phone is connected to WI-FI and Bluetooth is on):

- ① After the product is properly connected to the lamp, turn on the power. To enter the distribution network, it is necessary to repeatedly turn on and off the power 3 times, or press and hold the switch button for 5 seconds until the light flashes to enter the distribution network mode;
- ② Open the "Tuya" APP, and turn on the Bluetooth and WiFi of the mobile phone. Select "Add Device", add the screenbar to the APP according to the on-screen prompts, and you can start using Notice

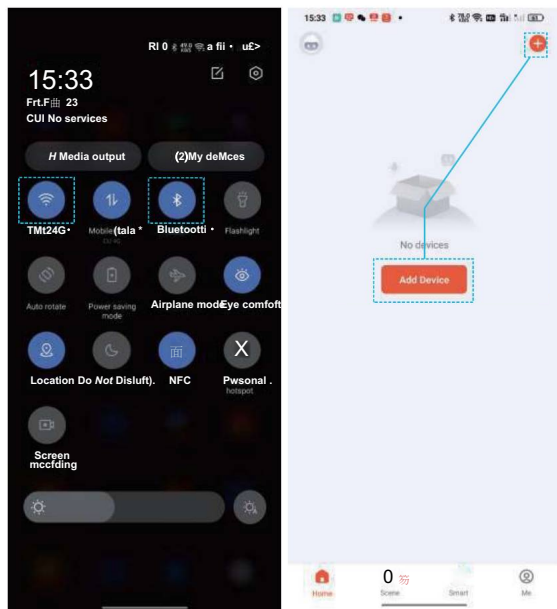

Notice

- The first time you open the APP, if there is an option to allow permissions, please select "Allow".
- If the android phone cannot search for bluetooth, please check whether to open the position!

3. Device connection: ① Add device ② Enter WiFi password ③ Connection succeeded

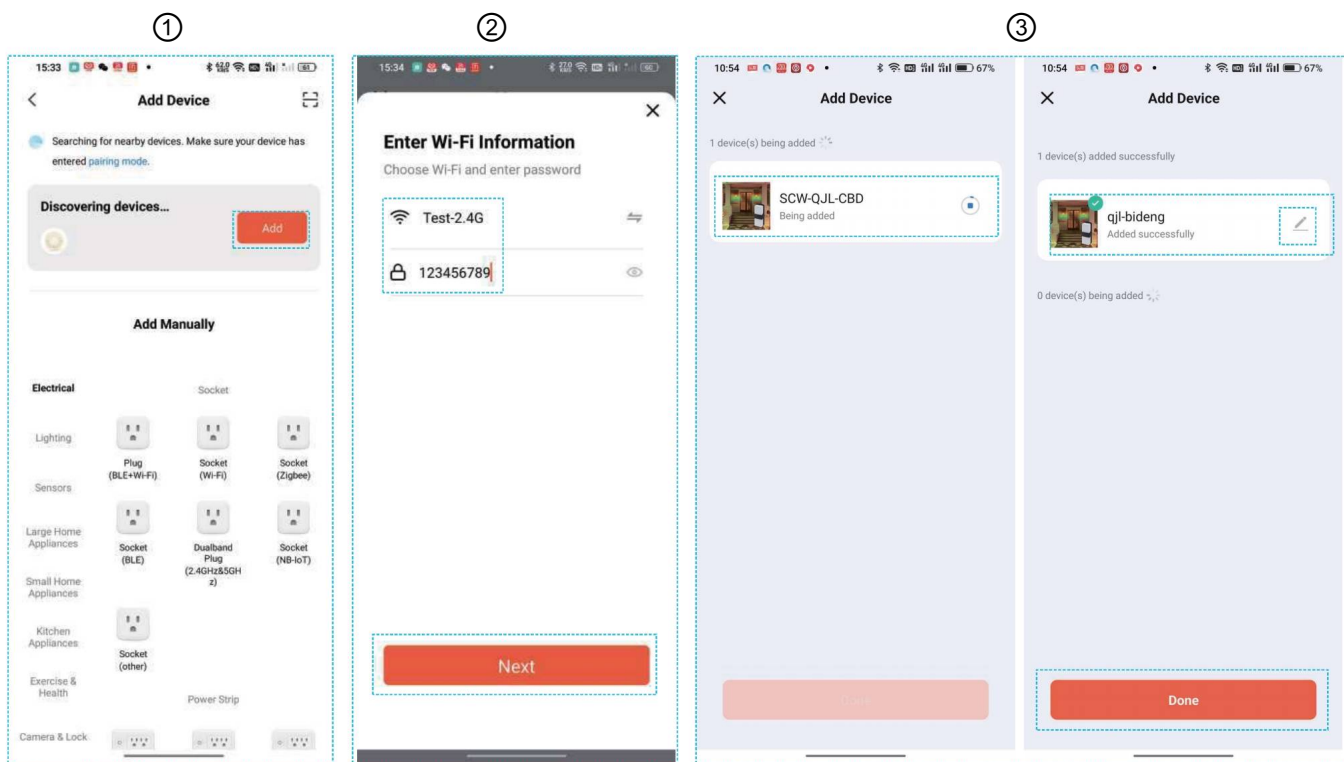

Tip: The bluetooth function in WiFi+Bluetooth dual mode is bluetooth distribution network, automatic identification of the device, after the WiFi and bluetooth is connected to the device, if the WiFi is disconnected or there is no WiFi, the mobile phone 4G or 5G signal can be used, and the bluetooth connection can be used.

“Tuya”app Introduction

1. Dimmer

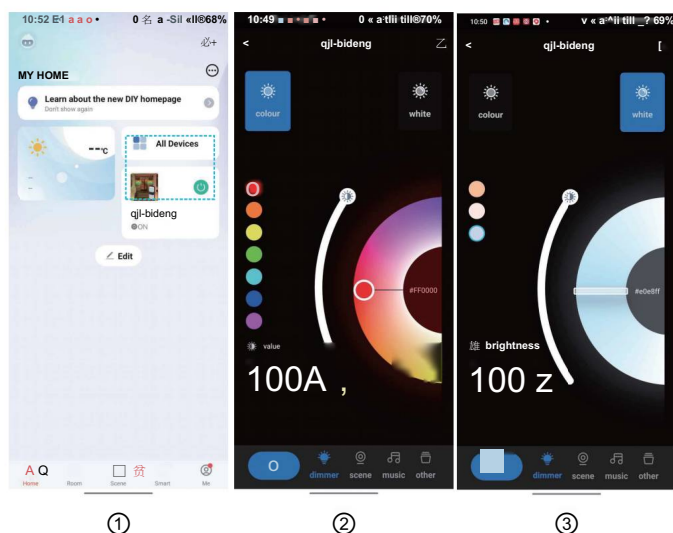

2. Scene mode

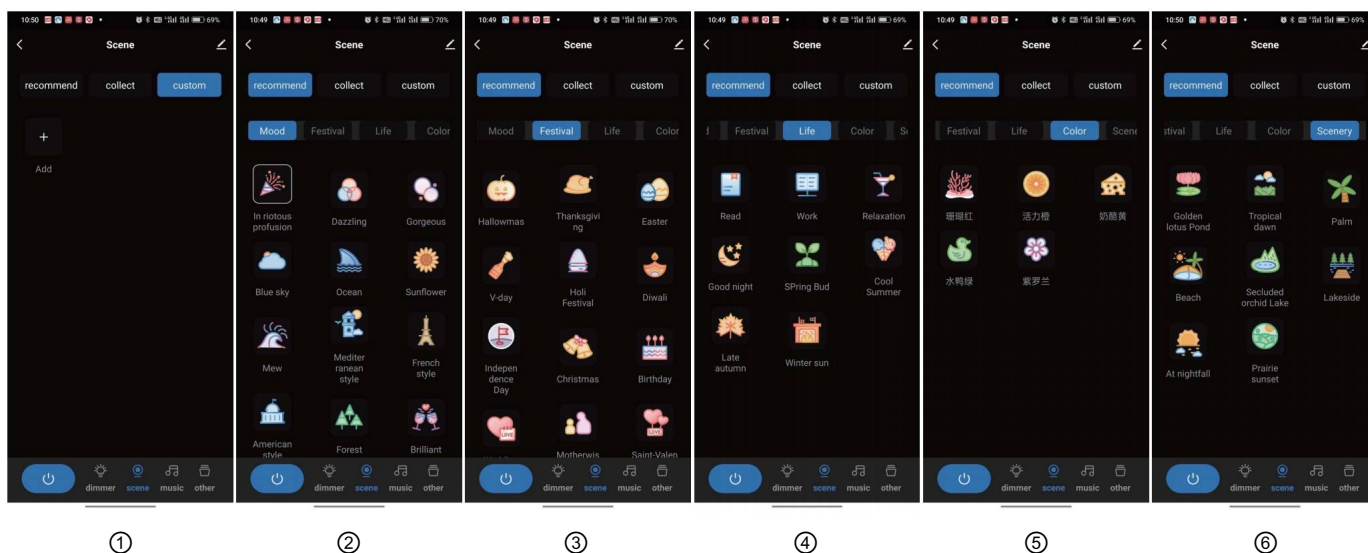

3. Music mode

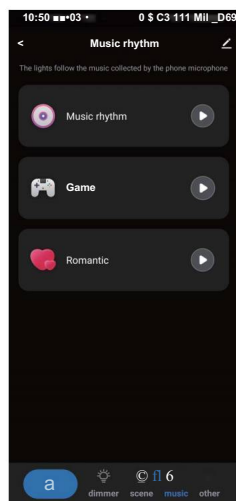

4. Other & plan (The owner can freely set the countdown and shutdown time for the string of lights every day)

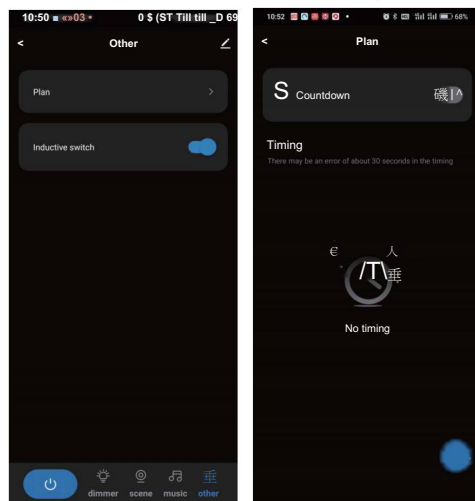

FCC Caution:

This device complies with part 15 of the FCC Rules. Operation is subject to the following two conditions: (1) this device may not cause harmful interference, and (2) this device must accept any interference received, including interference that may cause undesired operation.

Any changes or modifications not expressly approved by the party responsible for compliance could void the user's authority to operate the equipment.

NOTE: This equipment has been tested and found to comply with the limits for a Class B digital device, pursuant to Part 15 of the FCC Rules. These limits are designed to provide reasonable protection against harmful interference in a residential installation. This equipment generates, uses and can radiate radio frequency energy and, if not installed and used in accordance with the instructions, may cause harmful interference to radio communications. However, there is no guarantee that interference will not occur in a particular installation. If this equipment does cause harmful interference to radio or television reception, which can be determined by turning the equipment off and on, the user is encouraged to try to correct the interference by one or more of the following measures:

- Reorient or relocate the receiving antenna.
- Increase the separation between the equipment and receiver.
- Connect the equipment into an outlet on a circuit different from that to which the receiver is connected.
- Consult the dealer or an experienced radio/TV technician for help.

To maintain compliance with FCC's RF Exposure guidelines, This equipment should be installed and operated with minimum distance between 20cm the radiator your body: Use only the supplied antenna.