



THUNDEROBOT

MOUSE USER MANUAL

鼠标使用手册

ML7

特别说明

使用本产品前请仔细阅读使用手册，妥善保存以备参考。

本说明书提供的所有信息均准确和可靠，公司不承担任何违规操作和使用所造成的后果。

因非我司的官方系统、游戏、游戏平台升级或变更等软件原因造成的不可抗拒的因素，造成对应主硬件设备无法连接或无法操作，雷神将提供协助以解决异常问题；但不为此负质量责任。

本说明书中提到的规格为初始规格，在不影响使用的前提下升级相应规格可能不在说明书中更新，以其他书面或电子方式更新说明。

本说明书取代以前提供的所有信息。

ATTENTION

Please read the manual carefully before using this product and keep it for reference.

All information provided in this manual is accurate and reliable. We (the manufacturer) does not assume any responsibility for consequences resulting from improper operation and usage.

In the event that changes or updates to non-official systems, games, or gaming platforms result in the main hardware device being unable to connect or operate, we will provide assistance to resolve any issues. However, we do not assume quality responsibility for such occurrences.

The specifications mentioned in this manual are initial specifications. Upgrades to the relevant specifications, which do not affect usage, may not be updated in this manual. Updates may be provided in other written or electronic formats.

This manual supersedes all previously provided information.

安全信息

在使用和操作设备前，请阅读并遵守下面的注意事项，以确保设备性能最佳，并避免出现危险或非法情况。

1. 请在温度 0℃~35℃ 范围内使用本设备，并在温度 -10℃~+40℃ 范围内存放设备及其配件。当环境温度过高或过低时，可能会引起设备故障。

2. 设备及其配件可能包含一些小零件，请将设备及其配件放置在儿童接触不到的地方。儿童可能在无意之中损坏设备及其配件，或吞下小零件导致窒息或其他危险。

3. 请避免设备及其配件淋雨、进水或受潮，否则可能导致火灾或触电危险。

4. 请将设备及其电池（如果有的话）远离火源、高温和太阳直射。

5. 请勿擅自拆卸、改装设备（包含更换内置电池，如果有电池的话）及配件，否则该设备及配件将不在本公司保修范围之内。

6. 请按当地规定处理本设备及其它附件，不可将它们作为生活垃圾处理。尤其是如果有电池的话，若处置不当可能会导致电池爆炸。

7. 如果本型号配有电池：请勿自行更换电池，否则可能会损坏电池，导致电池过热、起火和人身伤害；禁止将电池扔入火中，禁止拆解、跌落、挤压或改装电池；禁止异物插入、穿刺电池；禁止将电池浸入水或其它液体中；避免电池遭受外部重击和压力，以免引起电池漏液、过热、起火或爆炸。

执行标准

GB/T 26245-2010

设备布局

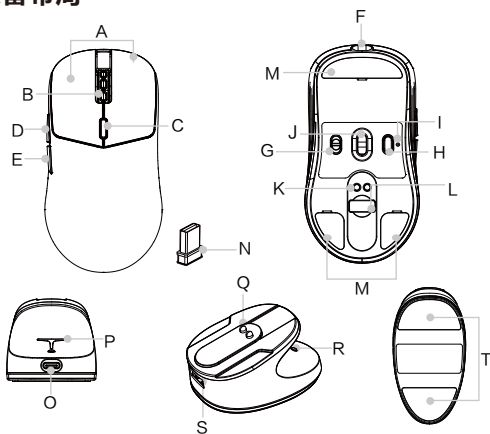

鼠标部分

- | | | | |
|---|-----------|---|---------------|
| A | 鼠标左/右键 | H | 对码键 |
| B | 中键/滚轮 | I | 对码/连接状态指示灯 |
| C | DPI切换键 | J | 光学传感器 |
| D | 前侧键 | K | 磁吸充电触点(仅部分型号) |
| E | 后侧键 | L | 2.4G接收器收纳仓 |
| F | Type-C充电口 | M | 鼠标脚贴 |
| G | 三段式开关 | N | 2.4G接收器 |

无线充电座 (仅部分型号)

- | | | | |
|---|----------|---|------------|
| O | Type-C接口 | R | 灯效切换开关 |
| P | 尾部LOGO灯 | S | 前侧Dongle插槽 |
| O | 磁吸充电触点 | T | 底部防滑贴 |

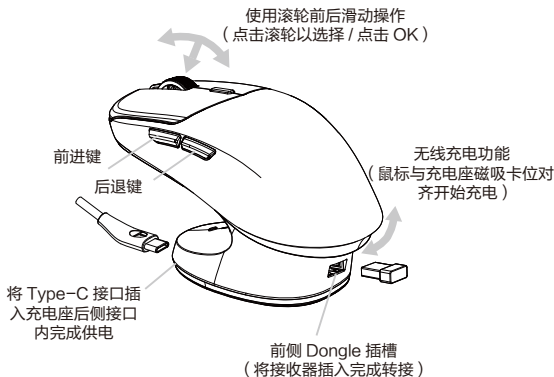

产品尺寸

鼠标: $125.6 \times 65.9 \times 38.7 \text{ mm} \pm 3\text{mm}$

无线充电座: $92.2 \times 49 \times 45.1 \text{ mm} \pm 3\text{mm}$

包装清单

雷神三模游戏鼠标 ML7 *1

雷神无线充电座 *1(仅部分型号)

2.4G 接收器 *1

产品使用手册 / 合格证 *1

鼠标充电线 *1



系统要求

Windows 11/Windows® 10/Windows® 8/Windows® 7/Windows® Vista/Windows® XP/ Mac OS x10.8 及以上

鼠标操作说明

鼠标控制模式

底部三段式开关

- ① 2.4G 开机，2.4G 模式：底部状态指示灯闪烁绿光；将鼠标接收器插入电脑，鼠标工作。
- ②  关机模式：无线状态下直接关机。
- ③  开机，蓝牙模式：底部状态指示灯闪烁蓝光，将鼠标靠近所需要连接的设备进行配对；蓝牙模式下长按底部对码键可进行对码。

* 有线模式：即插即用，不受开关影响，有线和无线同时连接状态下默认有线模式连接。有线模式状态下默认充电。

接收器对码方式

开机 2.4G 模式，按压对码键 5s 进入对码状态，对码指示灯绿光快闪，持续时间 60s，此时将接收器插入到电脑 USB 接口，对码成功后指示灯恢复 DPI 指示状态。

鼠标充电功能

设备支持有线、无线（部分型号）两种充电方式。

有线充电：使用产品附赠 Type-C 线连接鼠标与 PC 设备，即可进行充电。

无线充电（部分型号支持）：将鼠标放置于无线充电座上，对齐鼠标与充电座磁吸触点，开始充电。

充电显示

鼠标充电时，滚轮处灯光慢闪。

电量 10~25%：充电指示灯红灯慢闪；电量 25~65%：充电指示灯黄灯慢闪；

电量 65~99%：充电指示灯绿灯慢闪；电量满：充电指示灯绿光常亮。

充电时切换 DPI，指示灯变化为对应 DPI 灯色 3s，随后变回指示当下充电电量。

低电压关机值

当鼠标电量低于 10% 时，滚轮处红色灯光开始闪烁（1s/1 次）；当电压低于 3.2V 时，鼠标自动关机。

安全提示

充电电压支持最高 5V，充电电流不大于 1A。

无线充电座控制

通过点按尾部灯效切换开关（图中 R），切换充电座灯效模式。以下效果按顺序切换：

默认 RGB 流光，单色常亮（黄色、冰蓝色、粉色、红色、蓝色、绿色、紫色），单色呼吸（黄色、冰蓝色、粉色、红色、蓝色、绿色、紫色），霓虹，关闭。

鼠标灯光控制

鼠标无线状态开机时，氛围灯默认关闭。

长按组合键：后侧键 + 中键 3 秒，开启或关闭氛围灯；

点按组合键：后侧键 + 中键，可切换鼠标灯光模式，以下效果按顺序切换——RGB 流光（默认），单色常亮，单色循环呼吸，霓虹，七彩波浪）

* 有线模式下，默认开启氛围灯。

自动休眠模式

鼠标静置 3 分钟后，鼠标进入轻度休眠模式，移动光标唤醒鼠标；15 分钟之后进入深度休眠，点击按键唤醒鼠标。

DPI 指示灯

	DPI	颜色
1	800	红色
2	1200	冰蓝色（默认）
3	1600	绿色
4	3200	黄色
5	4800	青色

*点按DPI切换键进行DPI档位切换，鼠标滚轮处指示灯将按照对应档位进行光色变换。

产品中有害物质的名称及含量

部件名称	有害物质					
	铅 (Pb)	汞 (Hg)	镉 (Cd)	六价铬 (Cr(VI))	多溴联苯 (PBB)	多溴二苯醚 (PBDE)
印刷电路板组件	×	○	○	○	○	○
外壳及附件	○	○	○	○	○	○

本表格依据 SJ/T 11364 的规定编制。

○：表示该有害物质在该部件所有均质材料中的含量均在 GB/T 26572 规定的限量要求以下。

×：表示该有害物质至少在该部件的某一均质材料中的含量超出 GB/T 26572 规定的限量要求。
表中标记“×”的部件，皆因全球技术发展水平限制而无法实现有害物质的替代。



该电子电气产品含有某些有害物质，在环保使用期限内可以放心使用，超过环保使用期限之后则应该进入回收循环系统。

《废弃电器电子产品回收处理管理条例》

雷神倡导环保和低碳的消费体验，建议拥有该产品的用户在不需要此产品时，应遵守国家废弃电器电子产品回收处理相关法律法规，将其交给当地具有国家认可的回收处理资质的厂商进行回收处理，降低资源浪费，保护地球自然环境。

保修卡

尊敬的用户，本保修卡是您将来申请保修的凭证，请您配合销售商填写并妥善保管备用！

用户信息	用户姓名		电子邮件	
	通信地址			
	联系电话		邮政编码	
产品信息	产品名称		产品条码/编号/批号	
	产品型号			
销售商信息	名称			
	地址			
	联系电话		邮政编码	
	销售日期		发票号码	
备注				

注：

- (1)此表应由销售商盖章确认；
- (2)对于可适用相关“三包”规定的产品，本保修卡等同于“三包凭证”；
- (3)维修记录以授权服务机构维修凭证为准，申请服务后，请妥善保管。



扫码售后无忧

* 说明书中的中文内容仅适用于中国境内（不含港澳台地区）。

雷神计算机商品保修说明

雷神计算机商品全面遵照国家质量监督检验检疫总局、信息产业部联合颁布的《微型计算机商品修理更换退货责任规定》对计算机商品，包括但不限于键盘、鼠标等商品，实施产品“三包”服务：

产品质保期以购机日起对整机保修 1 年。

在质保期内，如因产品本身质量问题我公司提供免费维修、更换和退货服务。

●销售人员承诺的产品之外的服务及附加的配置、赠品，不在本服务范围内。

免责范围

在质保期内，下列人为和不可抗力因素导致的产品故障不属于免费维修、更换和退货服务范围：

1. 不能出示产品有效质保凭证，或产品原序列号标签有涂改、替换、撕毁现象，或产品没有序列号，或质保凭证上的型号或编码与产品实物不相符合的；
2. 产品超出雷神公司规定的质保期限的；
3. 未依据产品使用说明书或未依据说明书所指示的工作环境使用、维护、保管所导致的故障或损坏的；
4. 非雷神公司授权的维修人员对产品修理、更改或拆卸而造成的故障或损坏的；
5. 意外事故或其他不可抗力造成的损坏。

附录

附录 1 产品性能故障表

序号	性能故障
1	不能正常使用

附录 2 产品维修记录

日期	维修情况	工程师签字

Safety Information

Please read and follow the guidelines below before using and operating the device to ensure optimal performance and avoid potential hazards or illegal situations.

1. Please use the device within the temperature range of 0°C to 35°C and store the device and its accessories within -10°C to +40°C. Extreme temperatures may cause the device to malfunction.
2. The device and its accessories may contain small parts. Please keep them out of reach of children, as they may accidentally damage the device or its accessories, or swallow small parts, leading to choking or other dangers.
3. Please avoid exposing the device and its accessories to rain, water, or moisture to prevent the risk of fire or electric shock.
4. Please keep the device and its battery (if applicable) away from fire, high temperatures, and direct sunlight.
5. Do not disassemble or modify the device (including replacing the built-in battery, if applicable) or its accessories without authorization. Doing so may void the warranty.
6. Please dispose of the device and other accessories (especially the battery, if applicable) in accordance with local regulations and do not treat them as household waste. Improper disposal of batteries may lead to an explosion.
7. If the device model is equipped with a battery: Do not replace the battery yourself, as this may damage the battery, leading to overheating, fire, or injury. Do not throw the battery into fire, or disassemble, drop, crush, or modify the battery. Do not insert foreign objects into or pierce the battery. Do not immerse the battery in water or other liquids. Avoid subjecting the battery to external impacts or pressure to prevent leakage, overheating, fire, or explosion.

Device Layout

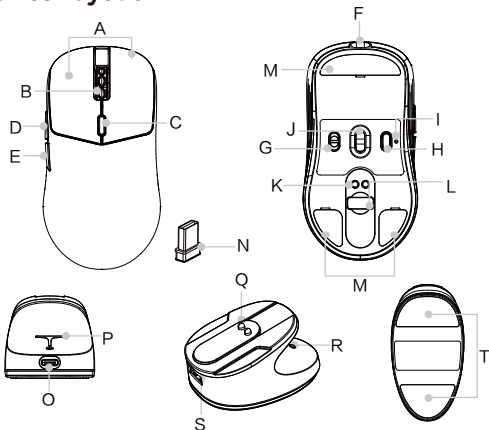

Mouse

- A Left/Right Button
- B Middle Button/Scroll Wheel
- C DPI Switch Button
- D Forward Button
- E Backward Button
- F Type-C Charging Port
- G Triple-step Switch

- H Pairing Button
- I Pairing/Connection Status Indicator
- J Optical Sensor
- K Magnetic Charging Contacts (only certain models)
- L 2.4G Receiver Compartment
- M Mouse Footpad
- N 2.4G Receiver

Wireless Charging Dock (only for certain models)

- O Type-C Port
- P Rear LOGO Light
- Q Magnetic Charging Contacts

- R Lighting Mode Switch
- S Front Dongle Slot
- T Bottom Anti-slip Pads

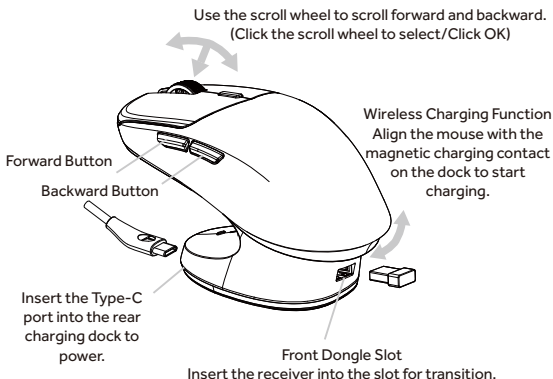

Product Dimensions

Mouse: 125.6 * 65.9 * 38.7 mm \pm 3mm

Wireless Charging Dock: 92.2 * 49 * 45.1 mm \pm 3mm

Packing List

Mouse *1

Wireless Charging Dock *1 (only for certain models)

2.4G Receiver *1

User Manual / Certificate *1

USB Cable *1

System Requirements

Windows 11 / Windows 10 / Windows 8 / Windows 7 / Windows Vista / Windows XP / Mac OS X 10.8 or later

Mouse Operation Instructions

Mouse Control Modes

Triple-step Switch at the Bottom:

- **2.4G Power On (2.4G Mode):** The status indicator on the bottom will flash green. Insert the receiver into the computer for the mouse to start working.
- **Power Off Mode:** The mouse will turn off in wireless mode.
- **Bluetooth Power On (Bluetooth Mode):** The status indicator will flash blue. Bring the mouse close to the device for pairing. In Bluetooth mode, long press the pairing button for pairing.

Wired Mode: Plug and play, unaffected by the switch. When wired and wireless connections are present, the mouse defaults to wired mode, which also enables charging.

2.4G Receiver Pairing

In 2.4G mode, press the pairing button for 5 seconds to enter pairing mode. The pairing indicator will flash green for 60 seconds. Insert the receiver into the computer's USB port. After successful pairing, the indicator will return to the DPI indicator state.

Mouse Charging Function

The device supports both wired and wireless charging (wireless for some models).

Wired Charging: Use the included Type-C cable to connect the mouse to a PC to charge.

Wireless Charging (for certain models): Place the mouse on the wireless charging dock, aligning the magnetic contacts to start charging.

Charging Indicator

The scroll wheel light will flash slowly while charging.

10-25% Battery: Red light flashes slowly.

25-65% Battery: Yellow light flashes slowly.

65-99% Battery: Green light flashes slowly.

Full Charge: Green light stays on.

When changing DPI during charging, the indicator changes to the corresponding DPI color for 3 seconds, then reverts to showing the current battery level.

Low Battery Shutdown Value

When the battery level drops below 10%, the red light on the scroll wheel will start

flashing (once per second). If the voltage drops below 3.2V, the mouse will shut down automatically.

Safety Instructions

The charging voltage should not exceed 5V, and the charging current should not exceed 1A.

Wireless Charging Dock Control

Use the rear lighting mode switch (marked R in the diagram) to toggle the charging dock's lighting modes.

Default RGB Wave - Solid Color (Yellow, Ice Blue, Pink, Red, Blue, Green, Purple) - Breathing Mode (Yellow, Ice Blue, Pink, Red, Blue, Green, Purple) - Neon - Off.

Mouse Lighting Control

When the mouse is powered on in wireless mode, the ambient lighting is turned off by default.

To turn the ambient lighting on or off: Press and hold the Backward Button + Middle Button for 3 seconds.

To cycle through lighting modes: Press Backward Button + Middle Button briefly to switch between lighting modes (default modes are RGB Flowing, Solid Single Color, Single Color Breathing, Neon, and Rainbow Wave).

In wired mode, the ambient lighting is enabled by default.

Automatic Sleep Mode

After 3 minutes of inactivity, the mouse enters light sleep mode. Move the cursor to wake it up. After 15 minutes of inactivity, it enters deep sleep mode. Click any button to wake it up.

DPI Indicator

	DPI	Colors
1	800	Red
2	1200	Ice Blue (Default)
3	1600	Green
4	3200	Yellow
5	4800	Cyan

Press the DPI Switch Button to change DPI levels.

The indicator light on the scroll wheel will change colors accordingly.

FCC Caution:

Any changes or modifications not expressly approved by the party responsible for compliance could void the user's authority to operate this equipment.

This device complies with part 15 of the FCC Rules. Operation is subject to the following two conditions:

- (1) this device may not cause harmful interference, and
- (2) this device must accept any interference received, including interference that may cause undesired operation.

This device and its antenna(s) must not be co-located or operating in conjunction with any other antenna or transmitter.

NOTE: This equipment has been tested and found to comply with the limits for a Class B digital device, pursuant to Part 15 of the FCC Rules. These limits are designed to provide reasonable protection against harmful interference in a residential installation. This equipment generates, uses and can radiate radio frequency energy and, if not installed and used in accordance with the instructions, may cause harmful interference to radio communications. However, there is no guarantee that interference will not occur in a particular installation.

If this equipment does cause harmful interference to radio or television reception, which can be determined by turning the equipment off and on, the user is encouraged to try to correct the interference by one or more of the following measures:

- Reorient or relocate the receiving antenna.
- Increase the separation between the equipment and receiver.
- Connect the equipment into an outlet on a circuit different from that to which the receiver is connected.
- Consult the dealer or an experienced radio/TV technician for help. The device has been evaluated to meet general RF exposure requirement. The device can be used in portable exposure condition without restriction.



Global: <https://www.thunderobot.com/global>
中文: <https://www.thunderobot.com>