



THUNDEROBOT

MOUSE USER MANUAL

鼠标使用手册

ML101

特别说明

使用本产品前请仔细阅读使用手册，妥善保存以备参考。

本说明书提供的所有信息均准确和可靠，公司不承担任何违规操作和使用所造成的后果。

因非我司的官方系统、游戏、游戏平台升级或变更等软件原因造成的不可抗拒的因素，造成对应主硬件设备无法连接或无法操作，雷神将提供协助以解决异常问题；但不为此负质量责任。

本说明书中提到的规格为初始规格，在不影响使用的前提下升级相应规格可能不在说明书中更新，以其他书面或电子方式更新说明。

本说明书取代以前提供的所有信息。

ATTENTION

Please read the manual carefully before using this product and keep it for reference.

All information provided in this manual is accurate and reliable. We (the manufacturer) does not assume any responsibility for consequences resulting from improper operation and usage.

In the event that changes or updates to non-official systems, games, or gaming platforms result in the main hardware device being unable to connect or operate, we will provide assistance to resolve any issues. However, we do not assume quality responsibility for such occurrences.

The specifications mentioned in this manual are initial specifications. Upgrades to the relevant specifications, which do not affect usage, may not be updated in this manual. Updates may be provided in other written or electronic formats.

This manual supersedes all previously provided information.

安全信息

在使用和操作设备前，请阅读并遵守下面的注意事项，以确保设备性能最佳，并避免出现危险或非法情况。

1. 请在温度 0℃~35℃ 范围内使用本设备，并在温度 -10℃~+40℃ 范围内存放设备及其配件。当环境温度过高或过低时，可能会引起设备故障。
2. 设备及其配件可能包含一些小零件，请将设备及其配件放置在儿童接触不到的地方。儿童可能在无意之中损坏设备及其配件，或吞下小零件导致窒息或其他危险。
3. 请避免设备及其配件淋雨、进水或受潮，否则可能导致火灾或触电危险。
4. 请将设备及其电池（如果有的话）远离火源、高温和太阳直射。
5. 请勿擅自拆卸、改装设备（包含更换内置电池，如果有电池的话）及配件，否则该设备及配件将不在本公司保修范围之内。
6. 请按当地规定处理本设备及其它附件，不可将它们作为生活垃圾处理。尤其是如果有电池的话，若处置不当可能会导致电池爆炸。
7. 如果本型号配有电池：请勿自行更换电池，否则可能会损坏电池，导致电池过热、起火和人身伤害；禁止将电池扔入火中，禁止拆解、跌落、挤压或改装电池；禁止异物插入、穿刺电池；禁止将电池浸入水或其它液体中；避免电池遭受外部重击和压力，以免引起电池漏液、过热、起火或爆炸。

执行标准

GB/T 26245-2010

包装清单

鼠标 × 1
5 号干电池 × 1
USB 接收器 × 1
产品使用手册（含保修卡、合格证）× 1

设备布局

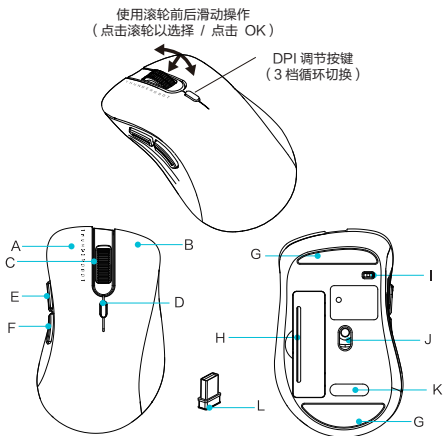

- A 鼠标左键
- B 鼠标右键
- C 鼠标中键 / 滚轮
- D DPI 切换键
- E 前进键
- F 后退键

- G 鼠标脚垫
- H 电池仓
- I 电源开关键
- J 光学传感器
- K 接收器仓口
- L 2.4G 接收器

鼠标信息参数

鼠标名称：雷神无线办公鼠标ML101

鼠标尺寸：108.6 × 67.7 × 39.3 mm

电池规格：5号干电池

DPI：800（最低）/ 1200 / 1600（最高）

产品特色

- 2.4G 无线鼠标，2.4G 模式最大有效距离 10m。
- 3 档 DPI 可调：800~1200~1600。
- 智能多级省电设计，持久续航。
- 人体工学握感舒适贴手，让您随心移动。
- 干电池供电设计，经久耐用。
- 鼠标内置接收器仓，方便携带。

功能概览

- 干电池供电无线鼠标，配 2.4G 无线接收器。
- 智能休眠模式，支持按键唤醒功能，并支持电池完全关断，更好的节约电量。

系统要求

Windows 11 / 10 / 8 / 7

Mac OS X10.1 及以上

Android 10.0 及以上

鼠标操作说明

安装及使用说明

1. 从包装盒里取出鼠标，翻转鼠标，从底部舱内取出里面的接收器。
2. 把接收器插入到已开机的电脑 USB 口中，此时电脑系统会自动安装接收器驱动，无需人工干涉。
3. 打开鼠标底部电池仓，放入 5 号干电池。
4. 把鼠标的电源开关拨到开（ON）处，就可以使用了。

异常排查

1. 是否开通电源。
2. 检查 USB 接收器是否连接正常，或更换 USB 接口。
3. 拔出接收器，再插入 USB 口，或者更换一个 USB 插口。
4. 检查鼠标是否已低电指示，按上述说明更换电池。
5. 确保鼠标离接收器连接设备，在 10 米的工作范围之内。
6. 携带产品外出或较长时间不用时，请把底部的电源开关置于关（OFF）状态。

接收器收纳功能

鼠标使用 USB 接收器，平时可以长期置于电脑的 USB 接口，对电脑没有任何影响，如果您需要单独携带鼠标外出或收纳，可以把接收器置于鼠标内部的收纳仓，方便保管，便于携带，外出不易遗失。

产品中有害物质的名称及含量

部件名称	有害物质					
	铅 (Pb)	汞 (Hg)	镉 (Cd)	六价铬 (Cr(VI))	多溴联苯 (PBB)	多溴二苯醚 (PBDE)
印刷电路板组件	X	○	○	○	○	○
外壳及附件	○	○	○	○	○	○

本表格依据 SJ/T 11364 的规定编制。

○：表示该有害物质在该部件所有均质材料中的含量均在 GB/T 26572 规定的限量要求以下。
 X：表示该有害物质至少在该部件的某一均质材料中的含量超出 GB/T 26572 规定的限量要求。
 表中标记“X”的部件，皆因全球技术发展水平限制而无法实现有害物质的替代。



该电子电气产品含有某些有害物质，在环保使用期限内可以放心使用，超过环保使用期限之后则应该进入回收循环系统。

《废弃电器电子产品回收处理管理条例》

雷神倡导环保和低碳的消费体验，建议拥有该产品的用户在不需要此产品时，应遵守国家废弃电器电子产品回收处理相关法律法规，将其交给当地具有国家认可的回收处理资质的厂商进行回收处理，降低资源浪费，保护地球自然环境。

保修卡

尊敬的用户，本保修卡是您将来申请保修的凭证，请您配合销售商填写并妥善保管备用！

用户信息	用户姓名		电子邮件	
	通信地址			
	联系电话		邮政编码	
产品信息	产品名称		产品条码/编号/批号	
	产品型号			
销售商信息	名称			
	地址			
	联系电话		邮政编码	
	销售日期		发票号码	
备注				

注：

- (1)此表应由销售商盖章确认；
- (2)对于可适用相关“三包”规定的产品，本保修卡等同于“三包凭证”；
- (3)维修记录以授权服务机构维修凭证为准，申请服务后，请妥善保管。



扫码售后无忧

* 说明书中的中文内容仅适用于中国境内（不含港澳台地区）。

雷神计算机商品保修说明

雷神计算机商品全面遵照国家质量监督检验检疫总局、信息产业部联合颁布的《微型计算机商品修理更换退货责任规定》对计算机商品，包括但不限于键盘、鼠标等商品，实施产品“三包”服务：

产品质保期以购机日起对整机保修 1 年。

在质保期内，如因产品本身质量问题我公司提供免费维修、更换和退货服务。

●销售人员承诺的产品之外的服务及附加的配置、赠品，不在本服务范围内。

免责范围

在质保期内，下列人为和不可抗力因素导致的产品故障不属于免费维修、更换和退货服务范围：

1. 不能出示产品有效质保凭证，或产品原序列号标签有涂改、替换、撕毁现象，或产品没有序列号，或质保凭证上的型号或编码与产品实物不相符合的；
2. 产品超出雷神公司规定的质保期限的；
3. 未依据产品使用说明书或未依据说明书所指示的工作环境使用、维护、保管所导致的故障或损坏的；
4. 非雷神公司授权的维修人员对产品修理、更改或拆卸而造成的故障或损坏的；
5. 意外事故或其他不可抗拒力造成的损坏。

附录

附录 1 产品性能故障表

序号	性能故障
1	不能正常使用

附录 2 产品维修记录

日期	维修情况	工程师签字

Safety Information

Please read and follow the guidelines below before using and operating the device to ensure optimal performance and avoid potential hazards or illegal situations.

1. Please use the device within the temperature range of 0°C to 35°C and store the device and its accessories within -10°C to +40°C. Extreme temperatures may cause the device to malfunction.
2. The device and its accessories may contain small parts. Please keep them out of reach of children, as they may accidentally damage the device or its accessories, or swallow small parts, leading to choking or other dangers.
3. Please avoid exposing the device and its accessories to rain, water, or moisture to prevent the risk of fire or electric shock.
4. Please keep the device and its battery (if applicable) away from fire, high temperatures, and direct sunlight.
5. Do not disassemble or modify the device (including replacing the built-in battery, if applicable) or its accessories without authorization. Doing so may void the warranty.
6. Please dispose of the device and other accessories (especially the battery, if applicable) in accordance with local regulations and do not treat them as household waste. Improper disposal of batteries may lead to an explosion.
7. If the device model is equipped with a battery: Do not replace the battery yourself, as this may damage the battery, leading to overheating, fire, or injury. Do not throw the battery into fire, or disassemble, drop, crush, or modify the battery. Do not insert foreign objects into or pierce the battery. Do not immerse the battery in water or other liquids. Avoid subjecting the battery to external impacts or pressure to prevent leakage, overheating, fire, or explosion.

Packing List

Mouse * 1

AA battery * 1

2.4G wireless dongle * 1

User manual / Certificate * 1

Device Layout

Scroll the wheel forward or backward
(Click the wheel to select/Click OK)

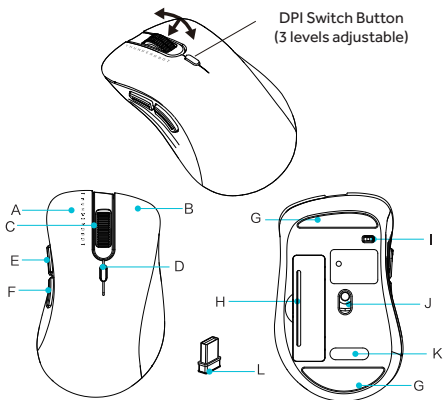

- A Left Button
- B Right Button
- C Middle Button/Scroll Wheel
- D DPI Switch Button
- E Forward Button
- F Backward Button

- G Feet Pads
- H Battery Compartment
- I Power Switch
- J Optical Sensor
- K Receiver Compartment
- L 2.4G Receiver

SPECIFICATION

Model: ML101

Dimensions: 108.6 × 67.7 × 39.3 mm

Battery Type: AA Battery

DPI Levels: 800 (lowest) / 1200 / 1600 (highest)

Product Features

- 2.4G wireless mouse with an effective range of 10m in 2.4G mode.
- Adjustable DPI with three levels: 800, 1200, and 1600.
- Intelligent multi-level power-saving design for extended battery life.
- Ergonomic design for a comfortable grip, allowing easy movement.
- Powered by replaceable batteries for long-lasting durability.
- Built-in receiver compartment for easy portability.

Function Overview

- Battery-powered wireless mouse with a 2.4G wireless receiver.
- Intelligent sleep mode with wake-up by button press, along with full power-off support for optimal energy savings.

System Requirements

Windows 11 / 10 / 8 / 7

Mac OS X 10.1 or later

Android 10.0 or later

Mouse Operation Instructions

Installation and Usage Instructions

1. Take out the mouse from the packaging. Flip the mouse over and take out the receiver from the bottom compartment.
2. Insert the receiver into an active computer USB port. The computer system will automatically install the receiver driver without manual intervention.
3. Open the battery compartment at the bottom of the mouse and insert an AA battery.
4. Turn the power switch on the mouse to the ON position, and the mouse is ready for use.

Troubleshooting

1. Ensure the power is turned on.
2. Check if the USB receiver is properly connected or try using a different USB port.
3. Remove and reinsert the receiver into the USB port, or try another USB port.
4. Check if the mouse has a low battery indicator and replace the battery as per the instructions above.
5. Ensure the mouse is within 10 meters of the receiver connection device.
6. When carrying the product or if it will not be used for an extended period, turn the power switch at the bottom to the OFF position.

Receiver Storage Feature

The mouse uses a USB receiver that can be kept in the computer's USB port without affecting the computer. If you need to carry the mouse separately or store it, the receiver can be placed inside the mouse's storage compartment. This makes it easy to keep track of, convenient to carry, and less likely to get lost when you're on the go.

FCC Caution:

Any changes or modifications not expressly approved by the party responsible for compliance could void the user's authority to operate this equipment.

This device complies with part 15 of the FCC Rules. Operation is subject to the following two conditions:

- (1) this device may not cause harmful interference, and
- (2) this device must accept any interference received, including interference that may cause undesired operation.

This device and its antenna(s) must not be co-located or operating in conjunction with any other antenna or transmitter.

NOTE: This equipment has been tested and found to comply with the limits for a Class B digital device, pursuant to Part 15 of the FCC Rules. These limits are designed to provide reasonable protection against harmful interference in a residential installation. This equipment generates, uses and can radiate radio frequency energy and, if not installed and used in accordance with the instructions, may cause harmful interference to radio communications. However, there is no guarantee that interference will not occur in a particular installation.

If this equipment does cause harmful interference to radio or television reception,

which can be determined by turning the equipment off and on, the user is encouraged to try to correct the interference by one or more of the following measures:

- Reorient or relocate the receiving antenna.
- Increase the separation between the equipment and receiver.
- Connect the equipment into an outlet on a circuit different from that to which the receiver is connected.
- Consult the dealer or an experienced radio/TV technician for help.

The device has been evaluated to meet general RF exposure requirement.

The device can be used in portable exposure condition without restriction.



Global: <https://www.thunderobot.com/global>

中文: <https://www.thunderobot.com>

合格证
Certificate of Quality

检验员 /Inspector:

检验结论:
产品经检验合格准予出厂
The product has
passed inspection.