

Hoglet

Fidget Mouse

2.4G Wireless Mouse User Manual



Overview

- A** Left button
- B** Right button
- C** Scroll wheel & middle button
- D** Power switch
- E** USB receiver
- F** Battery box

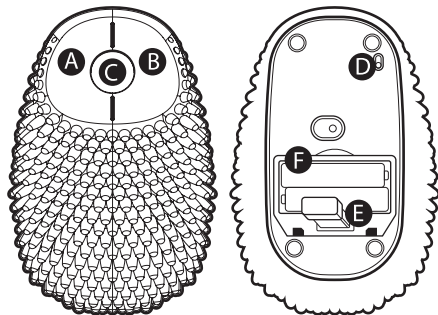

1

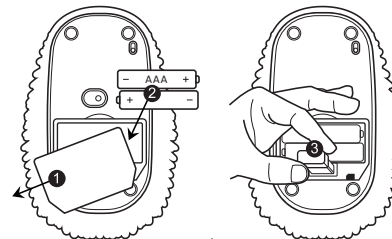

- 1** Remove the battery cover
- 2** Install the batteries
- 3** Remove the USB receiver
- 4** Install the USB receiver in the computer USB port
- 5** Turn the mouse on

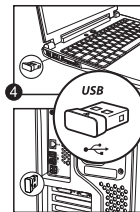

2

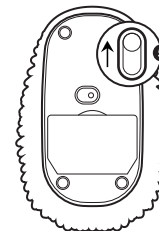

Basic Data Parameters

Data transmission: 1 Mbps

Frequency: 2405 MHz - 2476 MHz

Channel: 16

Engine: Optical

Voltage: 1.5 V

Current: 11 mA

Mouse Key Life: >3 Million Clicks

Tracking Resolution: 1600 DPI

Polling Rate: 250 Hz

System Requirement: workable USB port

Trouble Shooting

If the *Hoglet* is unresponsive, try the following steps:

1. Replace the current batteries with new batteries and ensure proper installation
2. Disconnect and reconnect the nano receiver to the USB port to establish a new connection to the mouse

3

3. Move the mouse closer to the USB receiver
4. Toggle the on/off power switch
5. Contact us at care@hedgehoghealth.com if your problem persists

Warning:
Changes or modifications to this unit not expressly approved by the party responsible for compliance could void the user's authority to operate the equipment.

NOTE:
This device complies with part 15 of the FCC Rules. Operation is subject to the following two conditions: (1) This device may not cause harmful interference, and (2) this device must accept any interference received, including interference that may cause undesired operation.

FCC Statement:
This equipment has been tested and found to comply with the limits for a Class B digital device, pursuant to part 15 of the FCC Rules. These limits are designed to provide reasonable protection against harmful interference in a residential installation. This equipment generates, uses and can radiate radio frequency energy and, if not installed and used in accordance with the instructions, may cause harmful interference to radio communications. However, there is no guarantee that interference will not occur in a particular installation. If this equipment does cause harmful interference to radio or television reception, which can be determined by turning the equipment off and on, the user is encouraged to try to correct the interference by one or more of the following measures:
— Reorient or relocate the receiving antenna.
— Increase the separation between the equipment and receiver.
— Connect the equipment into an outlet on a circuit different from that to which the receiver is connected.
— Consult the dealer or an experienced radio/TV technician for help.

HedgeHogHealth.com
@hedgehoghealth

4