

尺寸:91X95mm
材质:80g哑粉单色双面印刷 +风琴折+圆角处理



THE MOUNT MAGSAFE

User Manual

Components

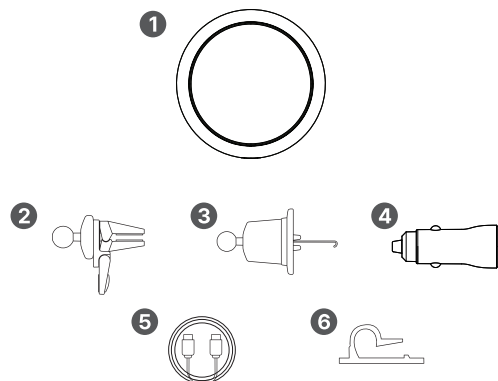

- ① The Mount : MagSafe
- ② Clip-Type Air Vent Mount
- ③ Hook-Type Air Vent Mount
- ④ 30W Car Charger
- ⑤ USB-C Cable
- ⑥ 3pcs, Cable Clips

Description

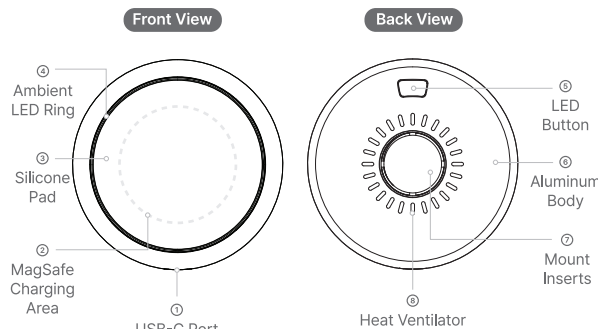

- ① Connect the Device with the Car Charger via the included USB-C Cable.
- ② Place your mobile phone on the silicone pad to start charging.

* This device only supports Mobile Phones with MagSafe® Support
* To ensure optimal charging speed, please use the included 30W Car Charger Adapter

- ③ The Ambient LED Ring is designed to diffuse outwards, minimizing eye strain for the user.

* How to Use the Ambient Light

- Choose from 10 colors that best match your vehicle.
- Press Once : to change colors
- Double Press: to adjust the Brightness Level (3 Levels)
- Long-Press : to Enable and Disable the Ambient LED Ring

- ④ The Full-Body Aluminum design offers advantages in Heat Dissipation allowing for faster charging speeds.

- ⑤ The Ball mount slot is 17mm in diameter.

Installation Guide

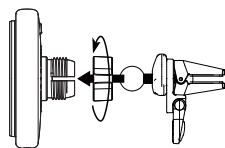

① Mount Assembly

Insert the Air Vent Mount into The Mount : MagSafe.

Turn it clockwise to secure it in place.

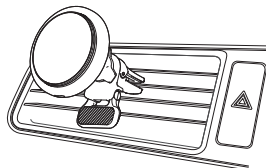

② Clip Type Air Vent Mount

Clip the Air Vent Mount onto the Air Vent, and turn the valve clockwise to secure it in place.

Installation Guide

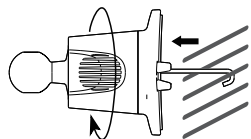

③ Hook Type Air Vent Mount

Fix the Mount by rotating clockwards.

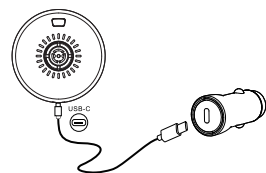

④ Connect the Cable

Plug the car charger into the cable port.

* For Optimal Charging Speed: Please use the included Adapter or a power source that support Q.C 3.0 standards with 30W output.

Instructions for Use

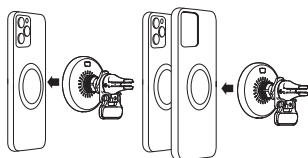

① For MagSafe-Compatible Devices

After connecting the charging cable, attach your smartphone to the device to start charging.

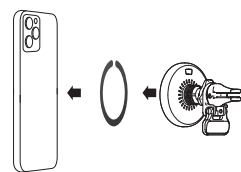

② For Non-MagSafe Devices

Use an MagSafe Compatible Case or attach an Magnetic Ring.

* We cannot guarantee compatibility for Third Party Accessories.

Recommended Usage

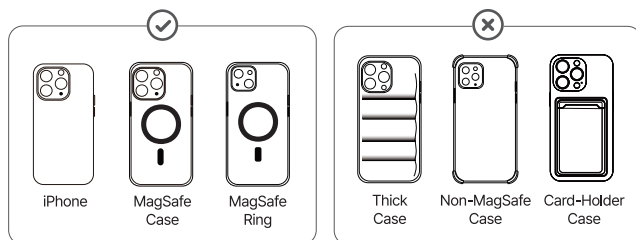

1. We recommend using an iPhone with MagSafe functionality.
2. If using a phone case, please use one that supports MagSafe.
3. For devices without MagSafe support you can use a MagSafe Ring or MagSafe Compatible case.

* Wireless charging does NOT work with Mobile Devices that do NOT support wireless charging.
* MagSafe cases and rings are not included in the package.
* Compatibility with third-party accessories is not guaranteed.

Product Specifications

- Certified Qi2 for fast wireless charging up to 15W.
- Offers 10 LED colors to match your vehicle's atmosphere.
- Uses powerful neodymium magnets to securely hold your phone.
- Features a silicone pad on the front to protect your devices from scratches during daily use.

Attention

- This Device works with Mobile Devices that support wireless charging.
- Connect the charger to a power source before use.
- Use the included 30W car charger for optimal charging speed.
- To fully utilize Qi2 Charging speeds, your phone must also support Qi2.
- For "your" safety, the device may stop operating if the temperature exceeds 50°C.
- Do not place magnetic cards between your phone and the mount, as it may damage the card.
- Keep magnetic materials away during charging.
- Do not expose to fire or submerge in water.
- Do not use in high-temperature or high-humidity environments.
- Do not operate aggressively or apply strong impacts.

The Mount is manufactured, distributed and sold by Carple. The Mount and its stylized logo are trademarks or registered trademarks of Carple. iPhone, MagSafe are trademarks of Apple Inc. All other trademarks are the property of their respective owners.

FCC Warning

This device complies with part 15 of the FCC Rules. Operation is subject to the following two conditions:(1) This device may not cause harmful interference, and (2) this device must accept any interference received, including interference that may cause undesired operation.

Any Changes or modifications not expressly approved by the party responsible for compliance could void the user's authority to operate the equipment.

This equipment has been tested and found to comply with the limits for a Class B digital device, pursuant to part 15 of the FCC Rules. These limits are designed to provide reasonable protection against harmful interference in a residential installation. This equipment generates uses and can radiate radio frequency energy and, if not installed and used in accordance with the instructions, may cause harmful interference to radio communications. However, there is no guarantee that interference will not occur in a particular installation. If this equipment does cause harmful interference to radio or television reception, which can be determined by turning the equipment off and on, the user is encouraged to try to correct the interference by one or more of the following measures:

- Reorient or relocate the receiving antenna.
- Increase the separation between the equipment and receiver.
- Connect the equipment into an outlet on a circuit different from that to which the receiver is connected.
- Consult the dealer or an experienced radio/TV technician for help.

FCC RF exposure statement:
The equipment complies with FCC radiation exposure limits set forth for an uncontrolled environment. This equipment should be installed and operated with minimum distance between 20cm the radiator your body.

THE MOUNT MAGSAFE

Product Name : The Mount MagSafe
Model : MG1
Input : 5V~3A, 9V~3A Max
Output : 15W Max
Made in China



KC ID : R-R-C7P-CARPLE-MG1
FCC ID : 2BF9E-MG1