

4.2.2 Channel Ture-Wireless Home Theater System

Model: ThunderBeat

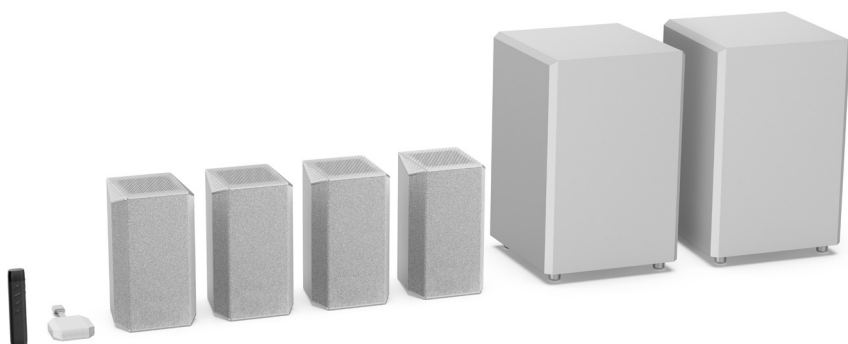

Instruction Manual

Contents

- 1. Important Safety Instructions 4
 - 1.1 Safety4
 - 1.2 Caution5
 - 1.3 Warning5
- 2. What's in the Box 6
- 3. Identifying the Parts 7
 - 3.1 Satellite Speaker7
 - 3.2 Wireless Subwoofer.....7
 - 3.3 Dongle7
 - 3.4 Remote Control8
- 4. LED Indicators..... 8
- 5. Remote control 9
 - 5.1 Introduction the remote control.....9
 - 5.2 Replace the Remote Control Battery9
 - 5.3 Pair up with the Dongle.....9
 - 5.4 Precautions Concerning Batteries9
- 6. Placement and Mounting 10
 - 6.1 Placement.....10
 - 6.2 Wall Mounting (if using option-B).....10
- 7. Connections 11
 - 7.1 Connect Power11
 - 7.2 Adapter connect power11
 - 7.3 Pair up with the Subwoofer/Satellite Speaker and Dongle.....11
- 8. Basic Operation 12
 - 8.1 Standby/ON12
 - 8.2 Automatic Power Off Function12
 - 8.3 Select Modes12
 - 8.4 Adjust the Volume12
 - 8.5 Setup menu12
- 9. Play audio 12
 - 9.1 Use HDMI eARC to play audio12
 - 9.2 Use USB to play audio13
 - 9.3 Use AUX to play audio.....13
 - 9.4 Use Bluetooth to play audio14
- 10. Troubleshooting 15
- 11. Specifications..... 16

1. Important Safety Instructions

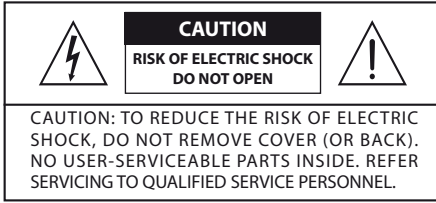



The lightning flash with arrowhead symbol, within an equilateral triangle, is intended to alert the user to the presence of uninsulated "dangerous voltage" within the product's enclosure that may be of sufficient magnitude as to constitute a risk of electric shock to persons.



The exclamation point within an equilateral triangle is intended to alert the user to the presence of important operating and maintenance (servicing) instructions in the literature accompanying the appliance.

1.1 Safety

- 1 **Read these instructions** – All the safety and operating instructions should be read before this product is operated.
- 2 **Keep these instructions** – The safety and operating instructions should be retained for future reference.
- 3 **Heed all warnings** – All warnings on the appliance and in the operating instructions should be adhered to.
- 4 **Follow all instructions** – All operating and usage instructions should be followed.
- 5 **Do not use this apparatus near water** – The appliance should not be used near water or moisture – for example, in a wet basement or near a swimming pool and the like.
- 6 **Clean only with a dry cloth.**
- 7 **Do not block any ventilation openings.** Install in accordance with the manufacturer's instructions.
- 8 Do not install near any heat sources such as radiators, heaters, stoves, or other apparatus (including amplifiers) that produce heat.
- 9 Do not defeat the safety purpose of the polarized or grounding plug. A polarized plug has two blades with one wider than the other. A grounding plug has two blades and a third grounding prong. The wide blade or the third prong is provided for your safety.
- 10 Protect the power cord from being walked on or pinched particularly at plugs, convenience receptacles, and the point where they exit from the apparatus.
- 11 Only use attachments/accessories specified by the manufacturer.
- 12  Use only with the cart, stand, tripod, bracket or table specified by the manufacturer, or sold with the apparatus. When a cart or rack is used, use caution when moving the cart/apparatus combination to avoid injury from tip-over.
- 13 Unplug the apparatus during lightning storms or when unused for long periods of time.
- 14 Refer all servicing to qualified personnel. Servicing is required when the apparatus has been damaged in any way, such as power supply cord or plug is damaged, liquid has been spilled or objects have fallen into the apparatus, the unit has been exposed to rain or moisture, does not operate normally, or has been dropped.
- 15  This equipment is a Class II or double insulated electrical appliance. It has been designed in such a way that it does not require a safety connection to electrical earth.
- 16 The apparatus shall not be exposed to dripping or splashing. No objects filled with liquids, such as vases, shall be placed on the apparatus.
- 17 Minimum distance around the apparatus for sufficient ventilation is 5cm.
- 18 The ventilation should not be impeded by covering the ventilation openings with items, such as newspapers, table-cloths, curtains, etc...
- 19 No naked flame sources, such as lighted candles, should be placed on the apparatus.
- 20 Batteries should be recycled or disposed of as per state and local guidelines.
- 21 The use of apparatus in moderate climates.

1.2 Caution

- Use of controls or adjustments or performance of procedures other than those described herein, may result in hazardous radiation exposure or other unsafe operation.
- To reduce the risk of fire or electric shock, do not expose this apparatus to rain or moisture. The apparatus must not be exposed to dripping or splashing and objects filled with liquids, such as vases, must not be placed on apparatus.
- The mains plug/appliance coupler is used as the disconnect device, the disconnect device must remain readily operable.
- Danger of explosion if battery is incorrectly replaced. Replace only with the same or equivalent type.

1.3 Warning

- The battery (batteries or battery pack) shall not be exposed to excessive heat such as sunshine, fire or the like.
- Before operating this system, check the voltage of this system to see if it is identical to the voltage of your local power supply.
- Do not place this unit close to strong magnetic fields.
- Do not place this unit on the amplifier or receiver.
- If any solid object or liquid falls into the system, unplug the system and have it checked by qualified personnel before operating it any further.
- Do not attempt to clean the unit with chemical solvents as this may damage the finish. Use a clean, dry or slightly damp cloth.
- When removing the power plug from the wall outlet, always pull directly on the plug, never yank on the cord.
- Changes or modifications to this unit not expressly approved by the party responsible for compliance will void the user's authority to operate the equipment.
- The rating label is pasted on the bottom or back of the equipment.



Battery usage CAUTION

To prevent battery leakage which may result in bodily injury, property damage, or damage to the apparatus:

- Install all batteries correctly, + and - as marked on the apparatus.
- Do not mix old and new batteries.
- Do not mix alkaline, standard (Carbon-Zinc) or rechargeable (Ni-Cd, Ni-MH, etc.) batteries.
- Remove batteries when the unit is not used for a long time.



Bluetooth®

The Bluetooth® word mark and logos are registered trademarks owned by Bluetooth SIG, Inc. and any use of such marks by Zhong Shan City Richsound Electronic Industrial Ltd. is under license. Other trademarks and trade names are those of their respective owners.



The terms HDMI, HDMI High-Definition Multimedia Interface, HDMI trade dress and the HDMI Logos are trademarks or registered trademarks of HDMI Licensing Administrator, Inc.



Dolby, Dolby Atmos, and the double-D symbol are registered trademarks of Dolby Laboratories Licensing Corporation. Manufactured under license from Dolby Laboratories. Confidential unpublished works. Copyright © 2012-2024 Dolby Laboratories. All rights reserved.



For DTS patents, see <http://patents.dts.com>. Manufactured under license from DTS, Inc. or DTS Licensing Limited. DTS, DTS:X, Virtual:X, and the DTS:X logo are registered trademarks or trademarks of DTS, Inc. in the United States and other countries. © 2021 DTS, Inc. ALL RIGHTS RESERVED.

2. What's in the Box

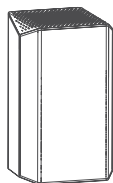

Satellite Speaker x 4

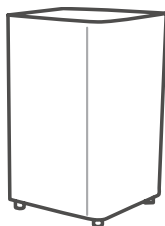

Wireless Subwoofer x 2

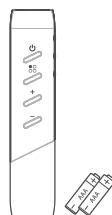

Remote Control /
AAA Batteries x 2

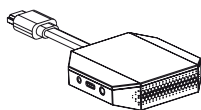

Dongle x 1

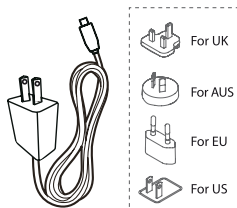

AC adapter x1

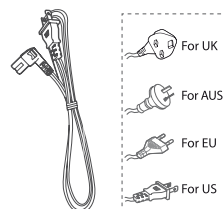

AC Power Cord x 6



RCA to 2.5mm
Audio Cable x1



3.5mm to 2.5mm
Audio Cable x1



3.5mm to 3.5mm
Audio Cable x1

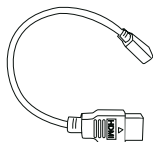

HDMI Extension Cable x 1

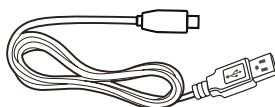

USB-C Cable x 1



Instruction Manual x1

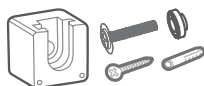

Wall Mount Kit x 4 sets

- Power cord quantity and plug type vary by regions.
- Images, illustrations and drawings shown on this User Manual are for reference only, actual product may vary in appearance.

3. Identifying the Parts

3.1 Satellite Speaker

- 1 **LED Indicators**
- 2 **Wall Mounting Bracket Screw Hole (M4)**
- 3 **USB Socket**
For maintenance and upgrade services, and manual pairing with Dongle.
- 4 **Floor Stand Screw Hole (1/4")**
Used to install a floor support.
- 5 **AC~ Socket**
Use to connect the power cable.

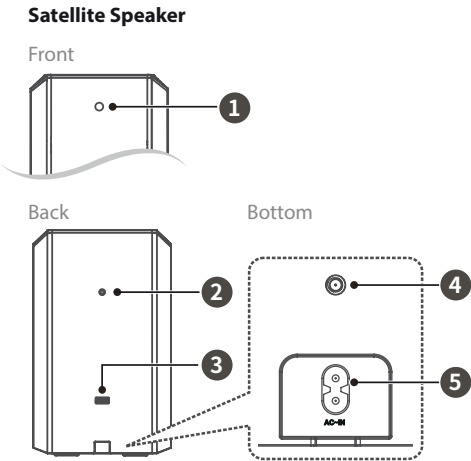

3.2 Wireless Subwoofer

- 6 **USB Socket**
For maintenance and upgrade services, and manual pairing with Dongle.
- 7 **AC~ Socket**
Use to connect the power cable.
- 8 **LED Indicators**

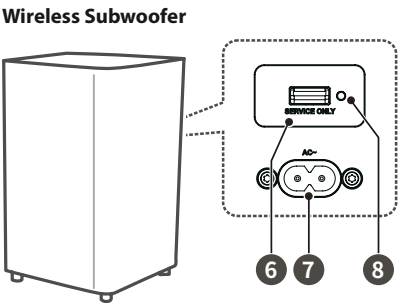

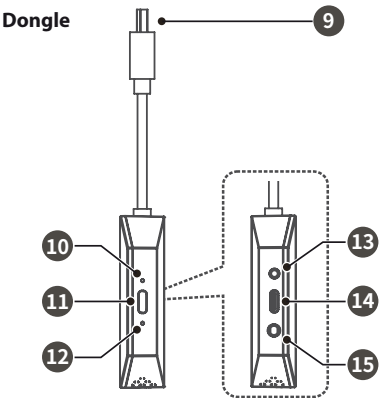

3.3 Dongle

- 9 **HDMI Input Plug**
Connect the HDMI ARC/eARC port on your TV.
- 10 **LED 1 Indicators**
Power and source status indicator.
- 11 **Reset Button**
Press and hold for 3 seconds to enter bluetooth pairing mode.
Press and hold for 8 seconds to restore factory defaults.
- 12 **LED 2 Indicators**
Pairing status indicator.
- 13 **2.5mm Center output**
- 14 **Dongle Power Supply Port**
- 15 **3.5mm AUX Input**

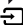

3.4 Remote Control

- 16 Display Window** Show the current status.
- 17**  Switch the Satellite Speaker between ON and STANDBY mode.
- 18 SETTING** Setup menu.
- 19 VOL +** Increase the volume level.
- 20 VOL -** Decrease the volume level.
- 21**  Mute or resume the sound.
- 22**  Select the Bluetooth mode.
- 23**  Select the play function.

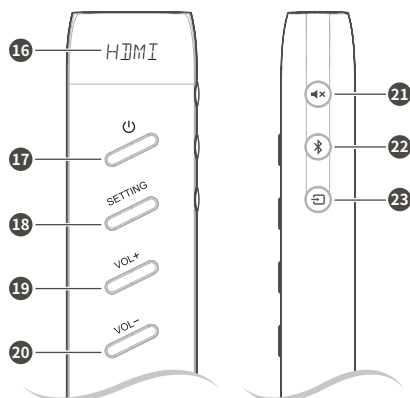

4. LED Indicators

Satellite speakers/Wireless subwoofer (LED Indicators)

Standby	Solid orange
Power Off	Off

All pairings successful	Solid white
Partial pairings successful	Solid yellow
No pairing successful	Solid orange

Dongle (LED 1 Indicators) : Power and source status indicator

Standby	Solid red
Power Off	off

USB playback	Solid purple
AUX playback	Solid orange
HDMI eARC playback	Solid white
Bluetooth playback	Solid blue

Play Dolby Atmos audio	White Status LED flash 3 times then solid white
------------------------	---

Restore factory defaults	Press and hold the reset button for 8S: After the LED indicator of Dongle flashes green and white alternately for 5 times, the indicator turns red, and the factory default setting is restored.
--------------------------	---

Dongle (LED 2 Indicators) : Pairing status indicator

All pairings successful	Solid green
Partial pairings successful	Solid yellow
No pairing successful	Solid red

5. Remote control

5.1 Introduction the remote control

This remote control is a fully functional and easy to operate Bluetooth wireless remote control, convenient for users to wireless control sound system ON/OFF, function switching, volume adjustment and other functions.

5.2 Replace the Remote Control Battery

1. Pinch the front and back of the battery cover and slide down to open the battery cover.
2. Insert two **AAA** size batteries (included). Make sure the (+) and (-) ends of the batteries match the (+) and (-) ends indicated in the battery compartment.
3. Close the battery cover.

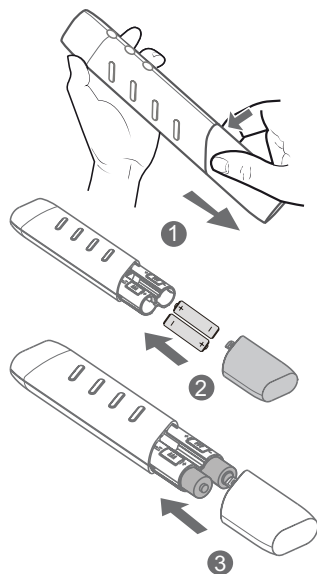

5.3 Pair up with the Dongle

1. Make sure the Wireless Subwoofer/Satellite Speaker and Dongle are powered on and the remote control is equipped with batteries.
2. Press the **SETTING** and **VOL -** buttons of the remote control for 3S at the same time to pair with the Dongle. The display will show: ":::::". "
3. After successful pairing, the display will show: "√".

5.4 Precautions Concerning Batteries

- Be sure to insert the batteries with correct positive "⊕" and negative "⊖" polarities.
- Use batteries of the same type. Never use different types of batteries together.
- Either rechargeable or non-rechargeable batteries can be used. Refer to the precautions on their labels.
- Do not drop the remote control.
- Do not allow anything to impact the remote control.
- Do not spill water or any liquid on the remote control.
- Do not place the remote control on a wet object.
- Do not place the remote control under direct sunlight or near sources of excessive heat.
- Remove the battery from the remote control when not in use for a long period of time, as corrosion or battery leakage may occur and result in physical injury, and/or property damage, and/or fire.
- Do not use any batteries other than those specified.
- Do not mix new batteries with old ones.
- Never recharge a battery unless it is confirmed to be a rechargeable type.

6. Placement and Mounting

6.1 Placement

- A Placed on a table.
- B Hang on the wall.
- C Mounting on the Floor Stand (Floor Stand Sold Separately).

A: Placed on a table

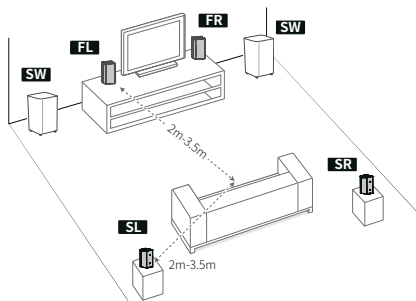

B: Hang on the wall

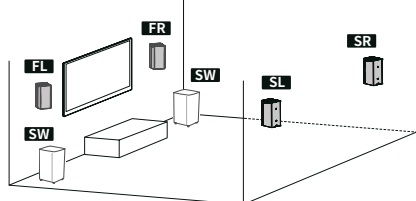

C: Mounting on the Floor Stand

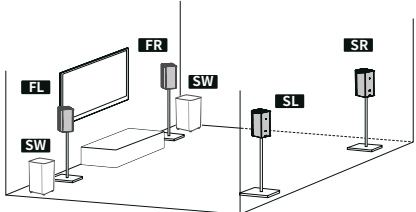

- If required, Satellite Speaker can be mounted on the floor stand (sold separately).

6.2 Wall Mounting (if using option-B)

- Installation must be carried out by qualified personnel only. Incorrect assembly can result in severe personal injury and property damage (if you intend to install this product yourself, you must check for installations such as electrical wiring and plumbing that may be buried inside the wall). It is the

installer's responsibility to verify that the wall will safely support the total load of the Satellite Speaker and wall brackets.

- Additional tools (not included) are required for the installation.
- Do not overtighten screws.
- Keep this instruction manual for future reference.
- Use an electronic stud finder to check the wall type before drilling and mounting.

WARNING

- To prevent injury, this apparatus must be securely attached to the floor/wall in accordance with the installation instructions.
- Suggested wall mounting height: ≤ 1.5 meters.

1. The Satellite Speaker can be fixed to the wall using the included wall mount package.
2. **Note:** Before installing the wall bracket, you need to connect the power cables of the Satellite Speaker.

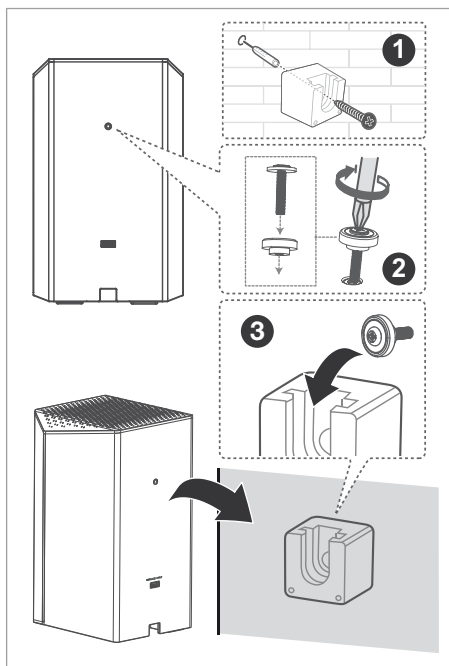

7. Connections

7.1 Connect Power

Risk of product damage!

- Risk of product damage! Ensure that the power supply voltage corresponds to the voltage printed on the back or the underside of the Satellite Speaker.
- Satellite Speaker
Connect the mains cable to the AC~ socket of the Satellite Speaker and then into a mains socket.
- Subwoofer
Connect the mains cable to the AC~ socket of the subwoofer and then into a mains socket.

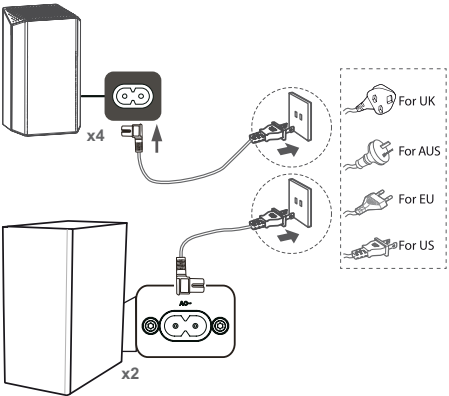

7.2 Adapter connect power

- Connect the adapter to the power supply port of Dongle and then into a mains socket.

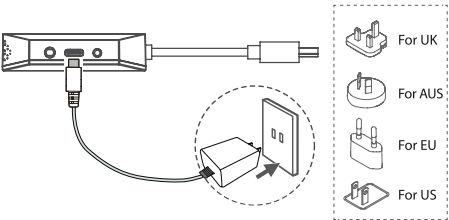

7.3 Pair up with the Subwoofer/Satellite Speaker and Dongle

Automatic pairing

The subwoofer / Satellite Speaker and Dongle will automatically pair when both units are plugged into the mains sockets and turned on.

- Determine the status based on the Wireless Subwoofer or Satellite Speaker indicator.

LED State	Status
Solid orange	No pairing successful
Solid yellow	Partial pairings successful
Solid white	All pairings successful

NOTE:

- If the automatic pairing fails, pair manually.

Manual pairing

1. Ensure that all the cables are well connected and the sound system is in ON mode.
2. Use the USB-C cable to connect one end to the power supply port of Dongle, and then plug the other end into the USB port on the Satellite Speaker and Wireless Subwoofer.
3. The LED indicator of the Satellite Speaker and Wireless Subwoofer flashes green and hear the voice prompt, indicating that the pairing has been completed. If the connection fails, repeat steps 1 ~ 2.

NOTE:

- Make sure that the dongle is at least 1m away from wireless devices such as routers.
- If the pairing connection fails again, check for electrical interference (e.g., from an electronic device) in the surrounding area, clear the interference, and repeat the above steps.

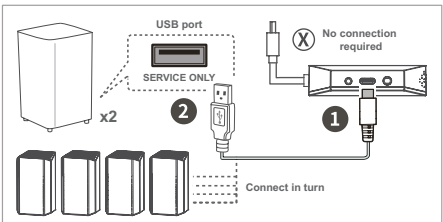

Tips:

- The USB power supply of the TV and other devices may be powered off after being turned off, so it is recommended to use an adapter for power supply as much as possible;
- The system boot time is 15 seconds, please operate after 15 seconds of booting;
- When the LED indicator of the Satellite Speaker or Wireless Subwoofer turns orange during use, indicating that a Satellite Speaker or Wireless Subwoofer is disconnected, find the disconnected Satellite Speaker or Wireless Subwoofer, power on again, and wait for about 1 minute to automatically connect successfully. Or reconnect by manual pairing.

8. Basic Operation

8.1 Standby/ON

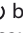
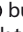

- Ensure the remote is paired with the Dongle.
- Press the  button on the remote control to switch the sound system ON.
- Press the  button again to switch the sound system back to STANDBY mode.

8.2 Automatic Power Off Function

The Satellite Speaker automatically turns to **Standby** mode after about 15 minutes if the TV or the external Satellite Speaker is disconnected, switched off or the volume is too close to mute.

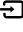

- To switch the Satellite Speaker off completely, remove the mains plug from the mains socket.
- Please turn the Satellite Speaker off completely to save energy when not in use.

8.3 Select Modes

Press the  (SOURCE) button repeatedly on the remote control to select the **HDMI eARC**, **AUX**, **USB** and  (**Bluetooth**) mode. The selected mode will show on the display.

Display	Mode
HDMI	HDMI eARC
BT	Bluetooth
AUX	AUX
USB	USB

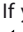
8.4 Adjust the Volume

- Press the **VOL+/VOL-** buttons on the remote control to adjust the volume.
- If you wish to turn the sound off, press the  (MUTE) button on the remote control. Press the  (MUTE) button again or press the **VOL+** button on the remote control to resume normal listening.

8.5 Setup menu

Satellite speakers allow you to make personalized sound adjustments.

1. Press the **SETTING** button repeatedly to select the sound menu to be adjusted: **BASS, SUR, MODE, FH**.
2. Press **VOL+/VOL-** to change the sound level.

Press (SETTING)	Press (VOL+/VOL-)
BASS	BAS-5 ~ BAS+5
SUR	SUR-5 ~ SUR+5
MODE	KTV
	News
	Movie
	Music
FH	FH-ON
	FH-OFF

Tip:

- When the router is too close to the Satellite speakers, there will be noise, stuttering, frequency hopping, etc. You can press the **SETTING** button repeatedly to select the **FH MODE**, and set to **FH-ON**.

9. Play audio

9.1 Use HDMI eARC to play audio

1. Ensure that your Projector/TV/laser TV supports HDMI ARC/eARC output, and if so, receive audio from your Projector/TV/laser TV through this device.
 2. Ensure the Wireless Subwoofer / Satellite Speaker / Remote Control and Dongle are powered on and paired.
 3. In the Projector/TV/laser TV Settings menu, set the corresponding Settings or press the buttons on the remote control to select the HDMI function.
- Dongle (LED 1 Indicators) Solid white

4. Connect Dongle's HDMI input plug to TV's HDMI ARC/eARC port; Dongle enters the HDMI eARC mode by default.

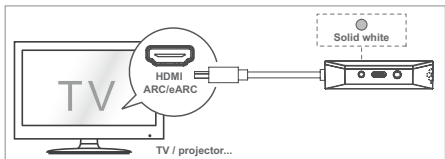

Audio (abbreviation)	
✓	PCM
✓	Dolby Digital
✓	Dolby Digital Plus
✓	Dolby TureHD
✓	Dolby Atmos
✓	DTS
✓	DTS-HD
✓	DTS: X
✓	DTS Virtual: X

9.2 Use USB to play audio

1. Ensure the Wireless Subwoofer / Satellite Speaker / Remote Control and Dongle are powered on and paired.
 2. Connect one end of the USB-C cable to the Type-C port of the Dongle and the other end to the USB port of the computer.
 3. Press the button on the remote control to select the USB function.
- Dongle (LED 1 Indicators) Solid purple
4. Set your computer's sound output to: Speakers (**ThunderBeat**).

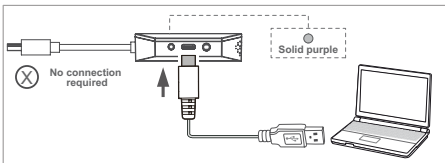

9.3 Use AUX to play audio

1. Ensure the Wireless Subwoofer / Satellite Speaker / Remote Control and Dongle are powered on and paired.
2. Press the button on the remote control to select the AUX function.

- Dongle (LED 1 Indicators) Solid orange
- A. Use a RCA to 2.5mm Audio Cable to connect the TV's audio output sockets to the Dongle's 2.5mm Center output port.
 - B. Use a 3.5mm to 3.5mm Audio Cable to connect to Dongle's 3.5mm AUX input port and mobile phone, and you can listen to audio from your mobile phone through this device.

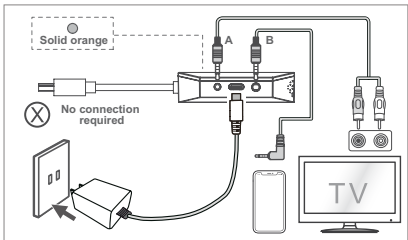

Wired central connection

If your Projector/TV/Laser TV supports Center Speaker Input, you can output the center channel of the speaker system's sound from your Projector/TV/Laser TV in the following ways.

1. Use the 3.5mm to 2.5mm Audio Cable, the 2.5mm plug connects to the dongle's 2.5mm center output, and the 3.5mm plug connects to the center speaker input jack on the Projector/TV/laser TV.
2. In the "Audio menu" of the Projector/TV/Laser TV, set the speaker of the Projector/TV/Laser TV to: Use as the center channel.

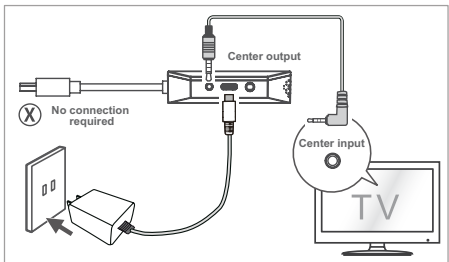

NOTE:

- Some Projector/TV/Laser TVs have a Center Speaker Input setting that requires you to select the Projector/TV/Laser TV as the video input to use for the center channel.
- If other Projector/TV/laser TVs have a "Speaker setting", you can choose the "On", "Off" or "Center" options.

9.4 Use Bluetooth to play audio

1. Ensure the Wireless Subwoofer / Satellite Speaker / Remote Control and Dongle are powered on and paired.
2. Press the  button on the remote control to select the Bluetooth function. The LED 1 indicator of the dongle flashes blue quickly.
3. On the Bluetooth device, switch on Bluetooth, search for and select “ThunderBeat” to start connection.
4. When you hear a prompt tone and the LED 1 indicator of the dongle lights up blue, the Bluetooth pairing is successful.
5. Play audio from a Bluetooth device to listen to the audio from a Bluetooth device through this device.

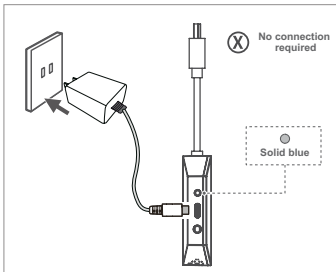



Tips:

- The effective connection distance between the Satellite Speaker and the Bluetooth device is about 10 meters.
- Satellite Speakers are not guaranteed to be compatible with all Bluetooth devices.
- Any obstruction between the Satellite Speaker and the Bluetooth device will shorten the effective operating distance.
- When placing Satellite Speakers, please keep away from electronic devices that may interfere with the Bluetooth connection.

10.Troubleshooting

To keep the warranty valid, never try to repair the system yourself. If you encounter problems when using this Satellite Speaker, check the following points before requesting service.

Problem	Solution
No power	<ul style="list-style-type: none">• Ensure that the AC cord of the apparatus is properly connected .• Ensure that there is power at the AC outlet.• Press  (standby) button to turn the Satellite Speaker on.
Remote control does not work	<ul style="list-style-type: none">• Before you press any playback control button, first select the correct source.• Reduce the distance between the remote control and the Satellite Speaker.• Insert the battery with its polarities (+/-) aligned as indicated.• Replace the battery.• Aim the remote control directly at the sensor on the front of the Satellite Speaker.
No sound	<ul style="list-style-type: none">• Make sure that the Satellite Speaker is not muted. Press MUTE or +/- (VOL) button to resume normal listening.• Press  button on the remote control to switch the Satellite Speaker to standby mode. Then press the  button again to switch the Satellite Speaker on.• Unplug both the Satellite Speaker and the subwoofer from the mains socket, then plug them again. Switch on the Satellite Speaker.• Ensure the audio setting of the input source (e.g. TV, game console, DVD player, etc.) is set to PCM or Dolby Digital mode while using digital (e.g. HDMI, OPTICAL) connection.• The subwoofer is out of range, please move the subwoofer closer to the Satellite Speaker. Make sure the subwoofer is within 5 m of the Satellite Speaker (the closer the better).• The Satellite Speaker may have lost connection with the subwoofer. Repair the units by following the steps on the section "Pair up with the Subwoofer/Satellite Speaker and Dongle".• The Satellite Speaker may not be able to decode all digital audio formats from the input source.
TV has display problem while viewing HDR content from HDMI source.	<ul style="list-style-type: none">• Some 4K HDR TVs require the HDMI input or picture settings to be set for HDR content reception. For further setup details on HDR display, please refer to the instruction manual of your TV.
I can't find the Bluetooth name of this Satellite Speaker on my Bluetooth device for Bluetooth pairing	<ul style="list-style-type: none">• Ensure the Bluetooth function is activated on your Bluetooth device.• Ensure you have paired the Satellite Speaker with your Bluetooth device.• The Satellite Speaker has a Bluetooth® function that can receive a signal within 8 metres. Keep a distance within 8 metres between the Satellite Speaker and your Bluetooth® device.
This is a 15 mins power off function, one of the ERPII standard requirement for saving power	<ul style="list-style-type: none">• When the unit's external input signal level is too low, the Satellite Speaker will be turned off automatically in 15 minutes. Please increase the volume level of your external device.

11.Specifications

Satellite Speaker

Power	100-240V~ 50/60Hz
Power Consumption	20 W < 0.5 W (StandBy)
Impedance	8Ω
Frequency response	120 Hz - 20 KHz
Frequency range	5150MHz ~ 5250MHz; 5725MHz ~ 5850MHz (Micropower)
Dimension (WxHxD)	5.59" x 9.13" x 5.16" (142 x 232 x 131 mm)
Net weight	3.81 lbs x 4 (1.73 kg x 4)
Operating temperature	0°C - 45°C

Wireless Subwoofer

Power	100-240V~ 50/60Hz
Power Consumption	40 W < 0.5 W (StandBy)
Impedance	3Ω
Frequency response	40 Hz - 120 Hz
Frequency range	5725MHz ~ 5850MHz (Micropower)
Dimension (WxHxD)	10.24" x 15.94" x 10.24" (260 X 405 X 260 mm)
Net weight	14 lbs x 2 (6.35 kg x 2)

Dongle

Adapter Model	DK12-050-1200-SU
Adapter Ratings	Input: 100-240V~ 50/60Hz, 0.25A (Max.) Output: 5V --- 1.2A
Frequency range	2400MHz ~ 2483.5MHz 5150MHz ~ 5250MHz 5725MHz ~ 5850MHz (Micropower)

Amplifier (RMS Output power)

Total	480 W
Satellite Speaker	(30W x 2) x 4
Wireless Subwoofer	120W x 2

Remote Control

Distance/Angle	19.7 feet (6m)
Battery type	AAA (1.5V x 2)

- Design and specifications are subject to change without notice.



WARNING: This product can expose you to chemicals, including styrene, which is known to the State of California to cause cancer, and Bisphenol A, which is known to the State of California to cause birth defects or other reproductive harm. For more information, go to www.P65Warnings.ca.gov.

EN

FCC INFORMATION (for US customers)

NOTE:

- This equipment has been tested and found to comply with the limits for a Class B digital device, pursuant to Part 15 of the FCC Rules. These limits are designed to provide reasonable protection against harmful interference in a residential installation. This equipment generates, uses and can radiate radio frequency energy and, if not installed and used in accordance with the instructions, may cause harmful interference to radio communications.
- However, there is no guarantee that interference will not occur in a particular installation. If this equipment does cause harmful interference to radio or television reception, which can be determined by turning the equipment off and on, the user is encouraged to try to correct the interference by one or more of the following measures:
 - Reorient or relocate the receiving antenna.
 - Increase the separation between the equipment and receiver.
 - Connect the equipment into an outlet on a circuit different from that to which the receiver is connected.
 - Consult the dealer or an experienced radio / TV technician for help.

This device complies with Part 15 of the FCC Rules.

Operation is subject to the following two conditions:

- (1) this device may not cause harmful interference, and
 - (2) this device must accept any interference received, including interference that may cause undesired operation.
- Shielded cables must be used with this unit to ensure compliance with the Class B FCC limits.

IC Notice: CAN ICES (B) / NMB (B)

This device contains licence-exempt transmitter(s)/receiver(s) that comply with Innovation, Science and Economic Development Canada's licence-exempt RSS(s). Operation is subject to the following two conditions:

1. This device may not cause interference.
2. This device must accept any interference, including interference that may cause undesired operation of the device.

Warning:

- This equipment should be installed and operated with minimum distance 20cm between the radiator & your body.
- Changes or modifications to this unit not expressly approved by the party responsible for compliance could void the user's authority to operate the equipment."



FR

Réglement de la FCC (pour les clients américains)

REMARQUE :

- Ce dispositif a été testé et déclaré conforme aux limites d'un dispositif numérique de classe B, conformément à la partie 15 des règles de la FCC.
Ces limites ont pour but d'assurer une protection raisonnable contre le brouillage nuisible dans une installation résidentielle. Cet équipement produit, utilise et peut émettre de l'énergie en radio fréquence et, s'il n'est pas installé et utilisé conformément aux directives, il peut causer un brouillage nuisible dans les communications radio.
- Cependant, il n'est pas garanti que des interférences ne se produiront pas dans une installation particulière. Si cet appareil provoque des interférences nuisibles à la réception radio ou de télévision, ce qui peut être déterminé en mettant l'appareil hors tension, l'utilisateur est encouragé à essayer de corriger l'interférence par une ou plusieurs des mesures suivantes :
 - Réorienter ou déplacer l'antenne de réception.
 - Augmenter la distance entre l'appareil et le récepteur.
 - Brancher l'appareil à une prise sur un circuit différent de celui sur lequel le récepteur est branché.
 - Consulter le revendeur ou un technicien radio/TV expérimenté.

Cet appareil est conforme à la partie 15 des règles de la FCC. Son fonctionnement est soumis aux deux conditions suivantes :

- (1) ce dispositif ne peut pas causer d'interférences nuisibles et
 - (2) cet appareil doit accepter toute interférence reçue, y compris les interférences qui peuvent causer un mauvais fonctionnement.
- Des câbles blindés doivent être utilisés avec cet appareil pour assurer la conformité avec les limites de la classe B de la FCC. fonctionnement de l'appareil.

Avis d'Industrie Canada: CAN ICES (B) / NMB (B)

L'émetteur/récepteur exempt de licence contenu dans le présent appareil est conforme aux CNR d'Innovation, Sciences et Développement économique Canada applicables aux appareils radio exempts de licence. L'exploitation est autorisée aux deux conditions suivantes :

1. L'appareil ne doit pas produire de brouillage;
2. L'appareil doit accepter tout brouillage radioélectrique subi, même si le brouillage est susceptible d'en compromettre le fonctionnement.

Avertissement :

- Pour rester en conformité avec les consignes d'exposition aux RF, placez le produit à au moins 20 cm des personnes proches.
- Les changements ou modifications de cet appareil non expressément approuvées par la partie responsable de la conformité pourraient annuler l'autorisation de l'utilisateur à utiliser l'équipement.

The device for operation in the band 5150 – 5250 MHz is only for indoor use to reduce the potential for harmful interference to co-channel mobile satellite systems.

les dispositifs fonctionnant dans la bande de 5 150 à 5 250 MHz sont réservés uniquement pour une utilisation à l'intérieur afin de réduire les risques de brouillage préjudiciable aux systèmes de satellites mobiles utilisant les mêmes canaux.

