

# Android car radio player

## User Manual

The operating system of this product only supports the official system update. If the user updates the third-party ROM system or uses the crack method to modify the system file, it may lead to system instability, data loss and security risks, We do not endorse and assume any responsibility for users in these situations

## Precautions

For your safety, please try not to watch the video and operate the machine while driving; please turn the volume to a level where you can clearly hear the outside sound when driving. Before starting the operation, please read this manual and other manuals of the system to understand the relevant safety warnings and warning signs on this manual and on the machine. After reading, keep them at your fingertips for reference.

Please pay attention to traffic safety.

If you are having trouble operating the system, please park your car in a safe place and operate it.

Do not allow children to operate the machine to avoid personal injury or damage to the device.

Please follow the traffic rules when using the satellite navigation function.

Please do not use it where electronic equipment or fire is prohibited. For example, gas stations, wineries, electromagnetic interference areas, etc., otherwise it may cause danger.

Do not care, maintain, or install this machine yourself. Do not install or service the unit while the power is on. It is very dangerous to install and repair the machine by trained or inexperienced personnel who have not been trained in electronic equipment or vehicle accessories.

Do not store or install this machine in direct sunlight, or place it in other hazardous materials, especially the LCD screen. If the LCD screen is just near the air duct of the air conditioner when installing, please ensure that the cool air or hot air is not directly blown onto the machine, otherwise the machine may be damaged or even damage to the car or the human body.

Do not scratch the display with some sharp objects. Do not press hard on the display. Otherwise, the display or touch screen may be damaged.

In order to ensure the normal operation of the machine and prevent fire or electric shock, please do not expose the machine to humid air, and do not spill liquid on the machine.

## Reset

1. When using the machine for the first time, press and hold the "RST" button for more than 3 seconds to restore the machine to factory settings.
2. When an abnormal situation such as freezing occurs due to improper operation, press and hold the reset "RST" button for more than 3 seconds.

Tip: Since the reset gap between the panels is small, please use a pen tip or similar pointed object to click this button.

## Start/Stop the device

1. When ACC is turned on, the device is turned on by default. Press and hold this button for more than 3 seconds to turn off the screen power, but the device power is not completely turned off. When the car is turned off, the device power will be turned off.
2. When the car is started, the navigation will work.

## set up

Click the "⚙️" setting icon on the touch screen, click the corresponding option to make corresponding settings, and slide up and down to find the settings you need.

- 1; Connection Settings

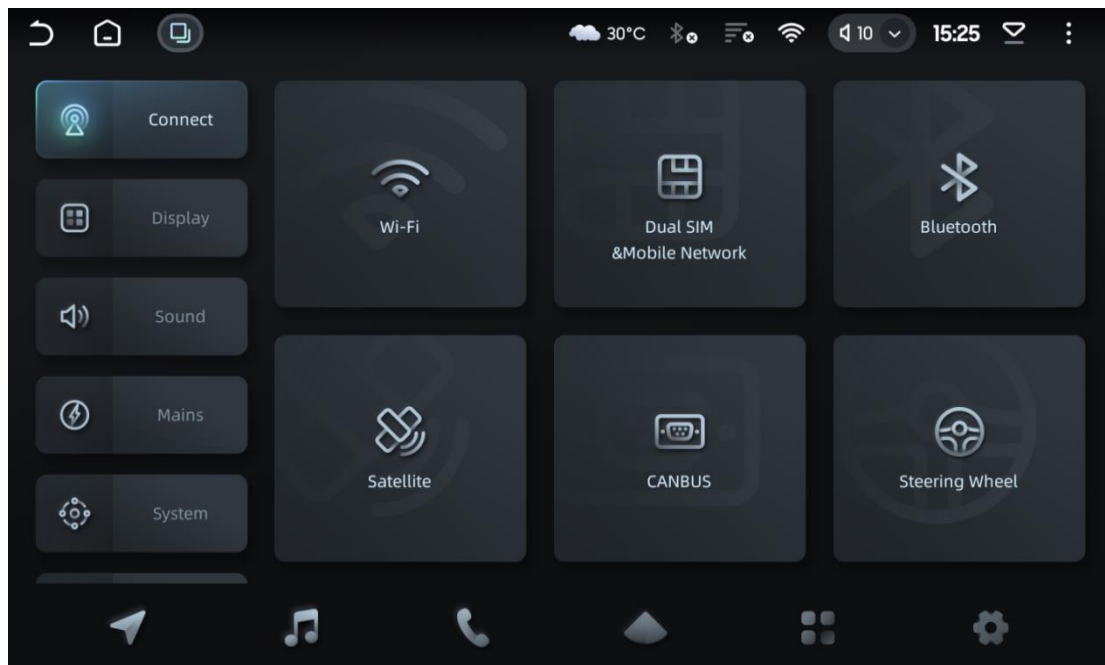

1. WIFI settings, enter the WIFI password, and you can use the wireless network after the connection is successful.
2. Dual SIM and mobile network: SIM card selection, operator information WLAN data usage and wireless data usage details.

3. Bluetooth: Connect to the mobile phone Bluetooth for making calls, connect to OBD to obtain car data.

4. Satellite: Display the machine GPS signal,

5: Car model selection: canbus car model settings.

6: Steering wheel button learning: Learn the steering wheel button function, which can be customized. After learning, the multi-function steering wheel button function can be realized by setting the corresponding steering wheel button.

7: Gyroscope calibration, calibrate the gyroscope settings on the machine home page.

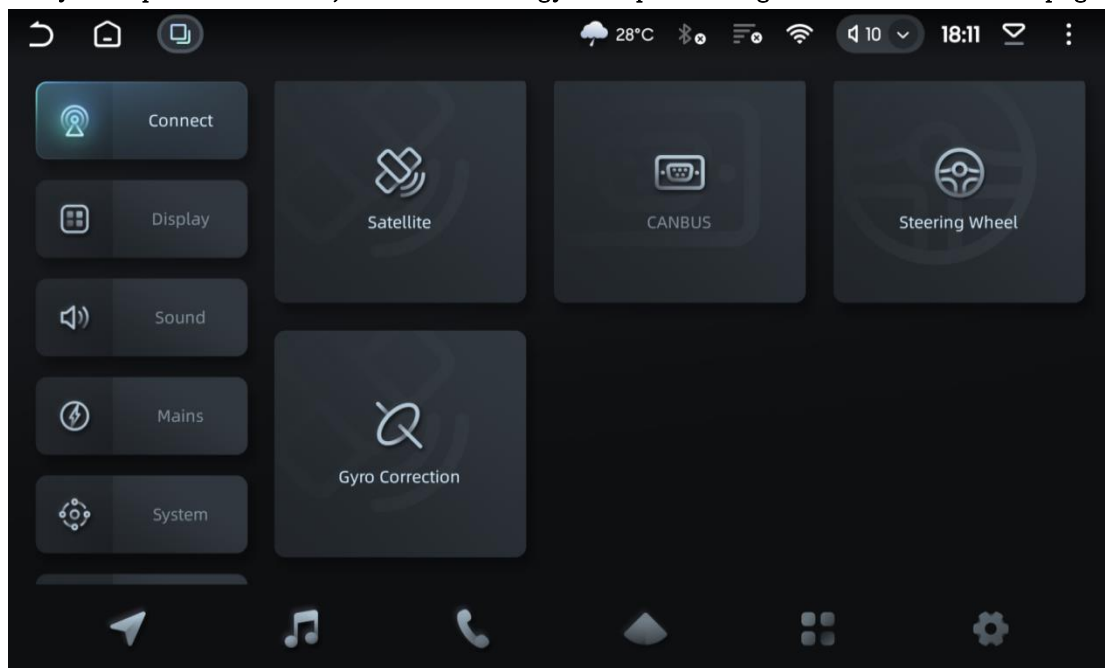

## 2 : display setting

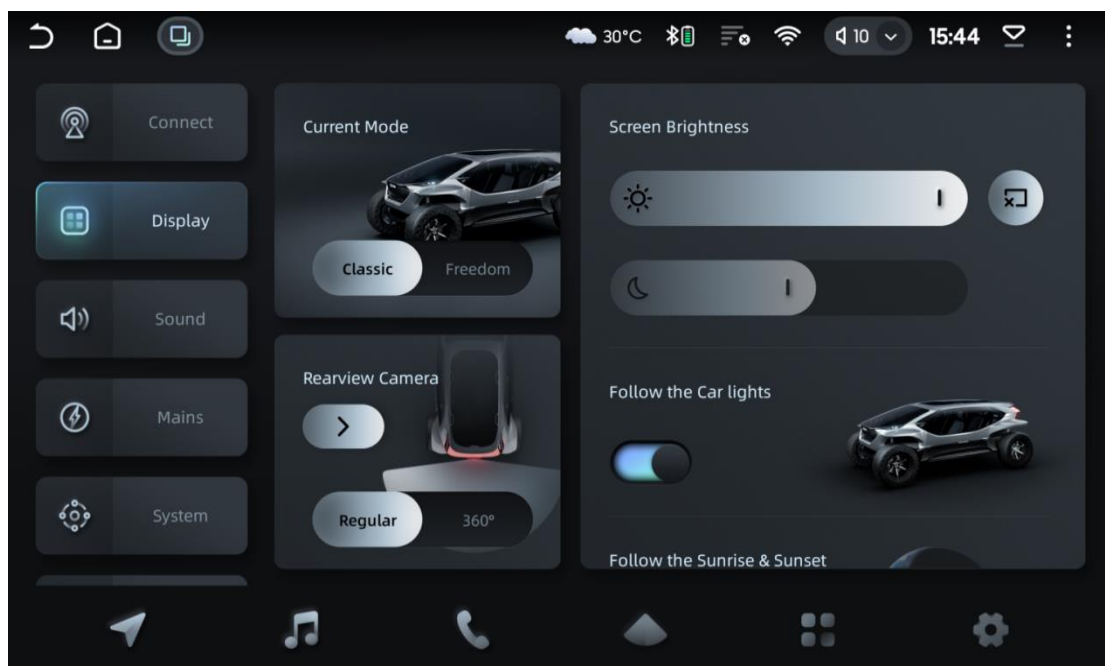

- 1: Switch between classic mode and free mode.
- 2: Switch between reversing camera and panoramic camera, and set the camera format.
- 3: Adjust screen brightness, adjust the screen brightness.
- 4: Follow the car lights, the screen brightness will automatically brighten and dim according to the car lights.

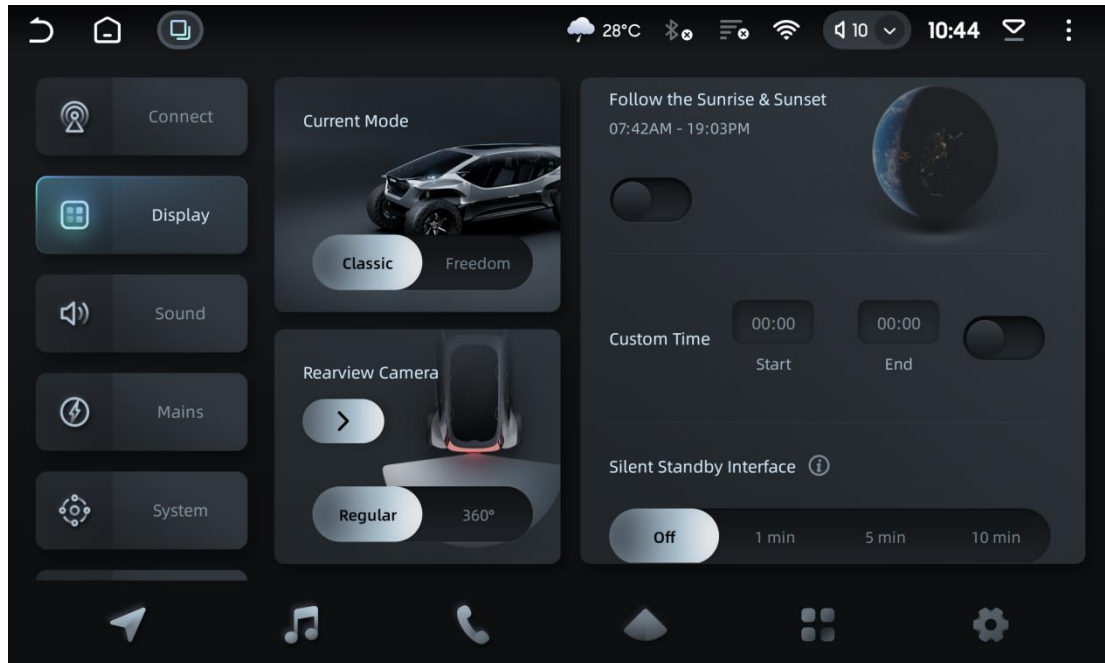

5. Follow the sunrise and sunset. The screen brightness will automatically brighten and dim according to the sunrise and sunset time.
6. Custom time, set the time for screen brightness.
7. Automatically turn off the screen; set the lock screen time

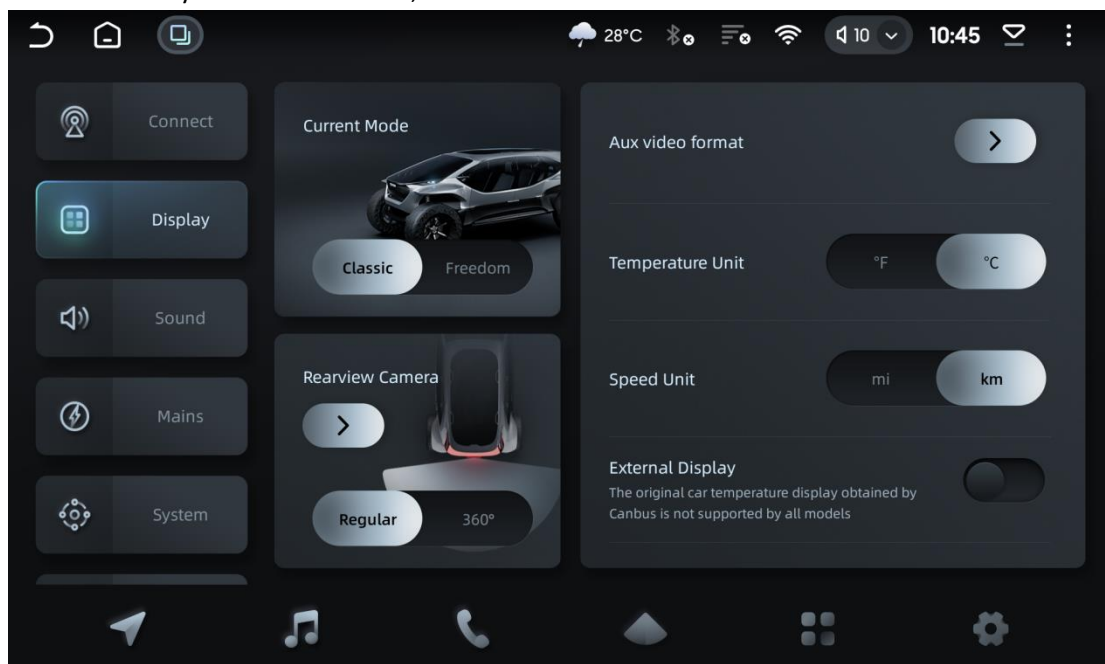

- 8; AUX video format, switch AUX format.
- 9; Temperature unit, switch °F or °C.
- 10; Speed unit, switch mi and KM.

11; Outside temperature display, display the outside temperature.

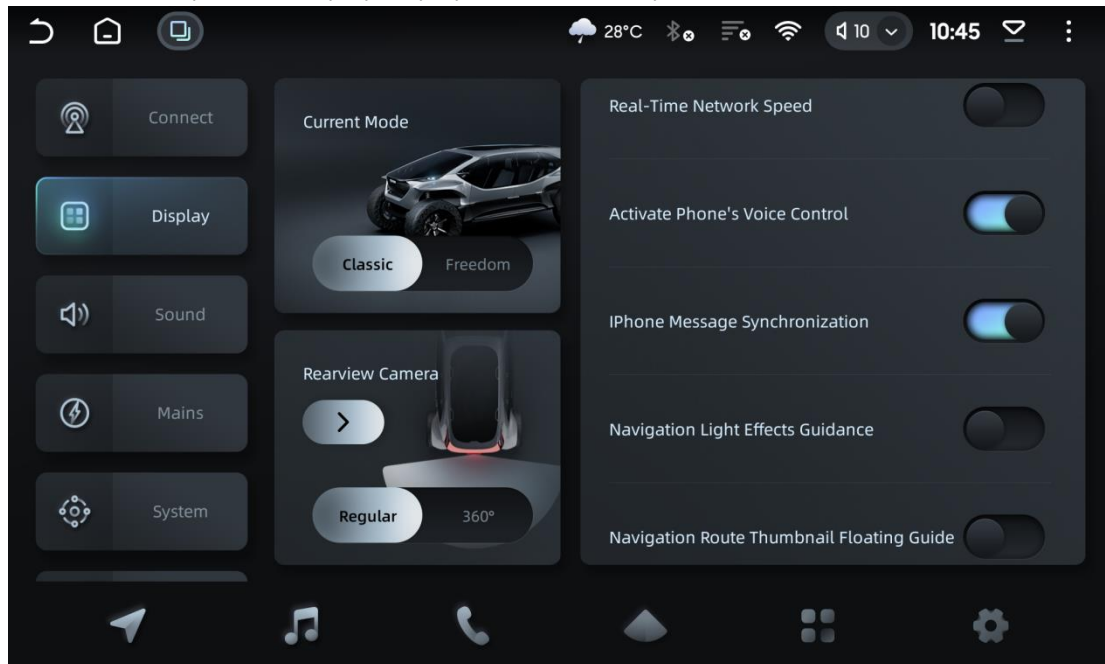

12; Real-time network speed, display network speed at any time.

13; Wake up the mobile phone voice control system, the car computer can wake up the mobile phone voice control.

14; iPhone notification disappears synchronously, and mobile phone notifications are displayed on the car computer page.

15; Navigation light guidance.

16; Navigation floating window, the navigation software can float other applications.

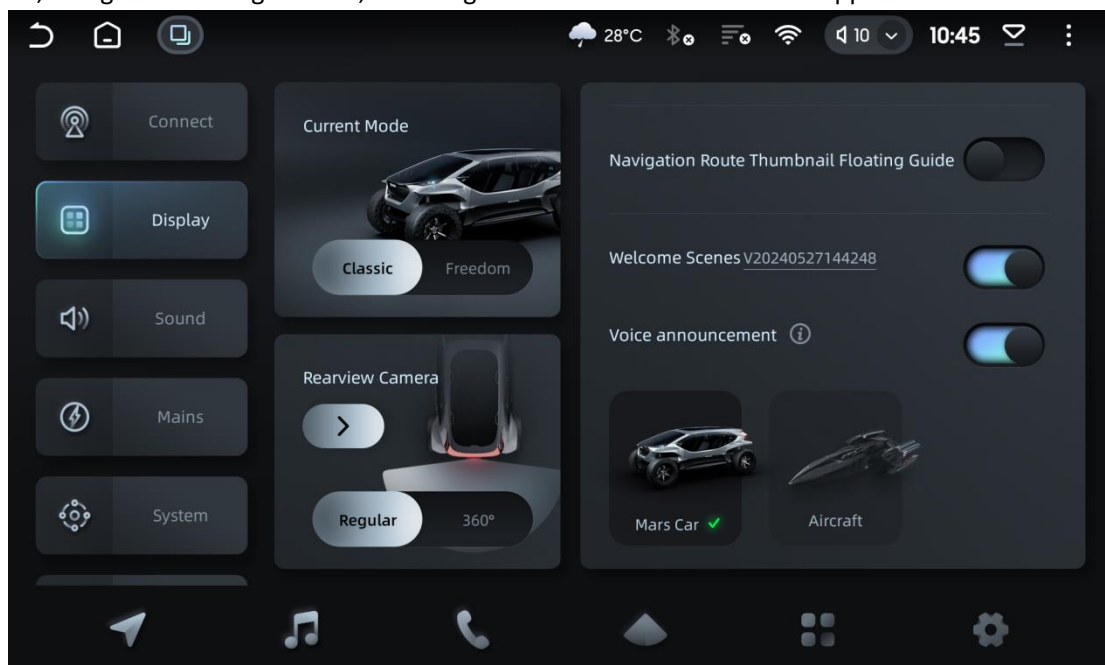

17; Welcome page scene setting, each time the vehicle is started, the welcome page video will be played randomly according to the time, weather and festival.

18; Voice broadcast, each time the vehicle is started, the welcome message and time will be broadcast, and the weather in the last 2 hours can be broadcast if there is a network.

### 3 : Sound Settings

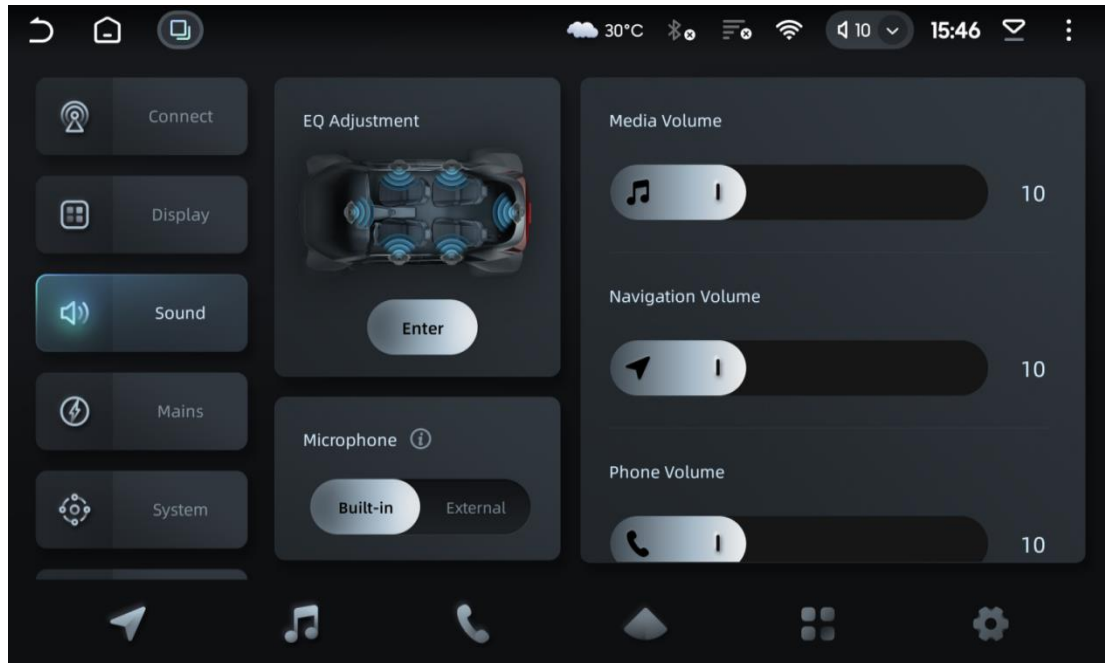

1: EQ sound adjustment, sound balance setting.

2: Switch between internal and external microphones, you can only choose one of the two, to ensure the best sound effect.

3: Media volume, adjust the media volume.

4: Navigation volume, adjust the navigation volume.

5: Phone volume, adjust the phone volume.

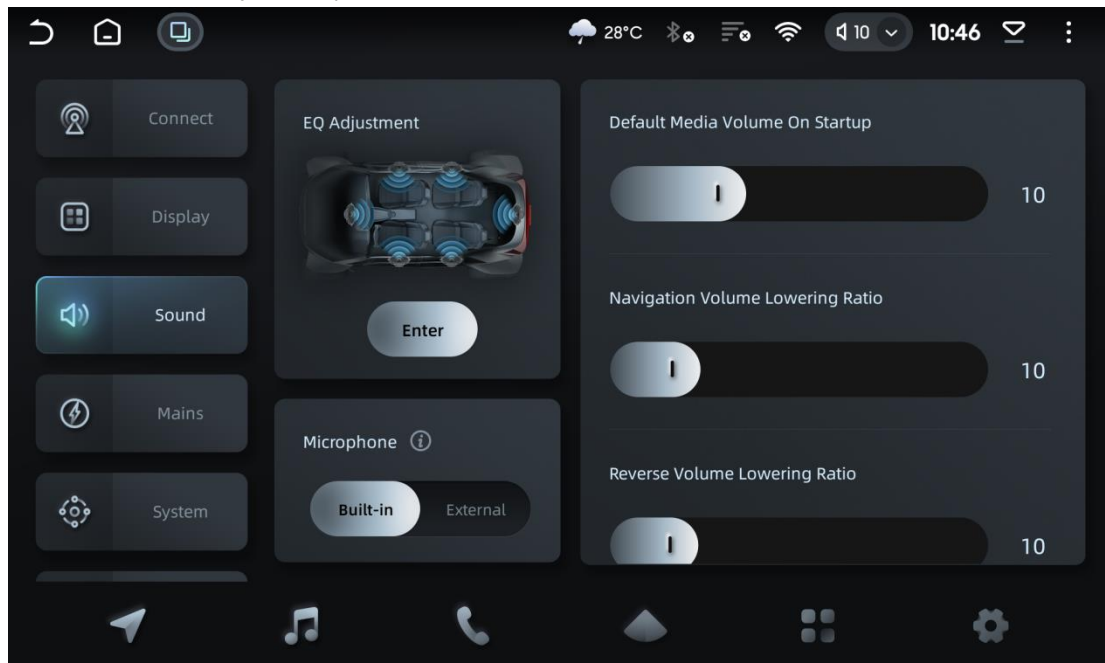

6; Default volume when starting up: The default volume when starting up. The larger the setting, the louder the volume when starting up.

7; Navigation reduction ratio: The sound is reduced during navigation: The larger

the setting value, the louder the multimedia volume when reversing.

8: Reversing reduction ratio: The sound is reduced during reversing: The larger the setting value, the louder the multimedia volume when reversing.

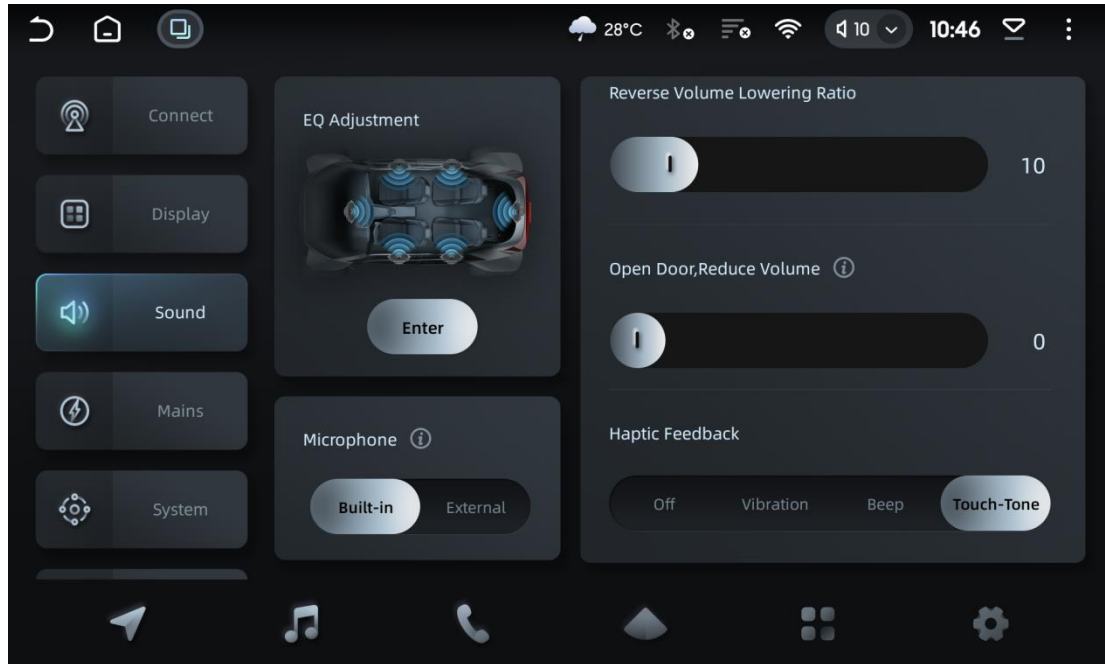

9: Open the door to reduce the volume. When the car door is opened, the volume will automatically decrease to the set value.

10: Touch feedback, adjust the button tone and vibration mode of the screen touch.

#### 4 : Power Settings

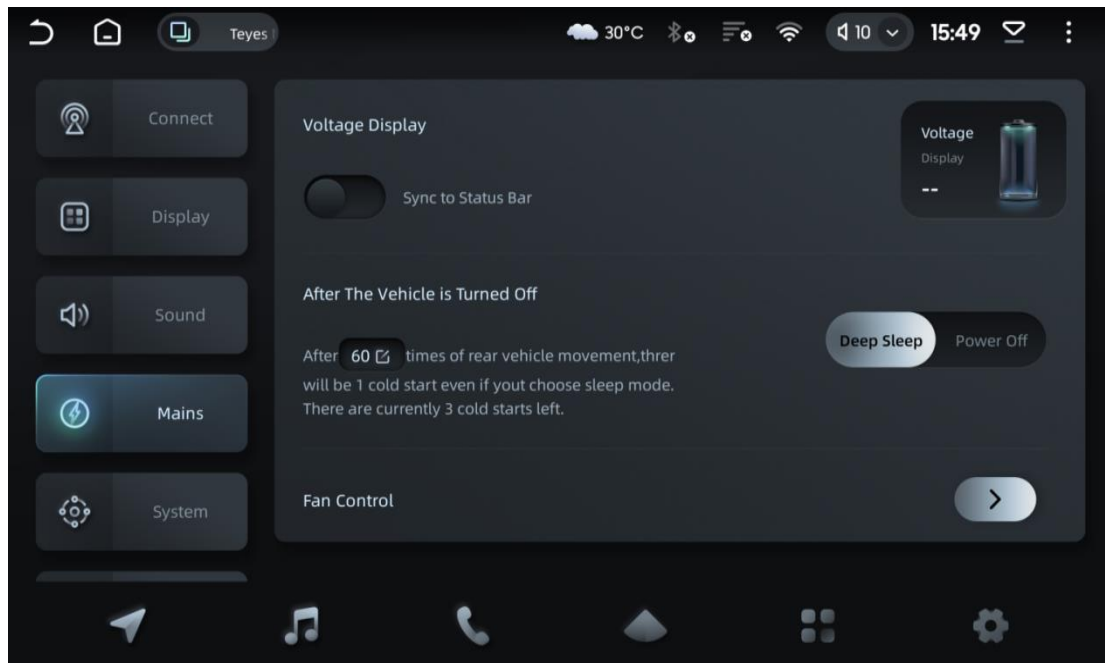

1: Voltage display, the voltage is displayed in the status bar.

2: Sleep mode setting: After turning it on, the next time you start the vehicle, the device will not start in restart mode, but from sleep mode.



3: Fan control, manually turn on and off the fan switch.

## 5: System Settings

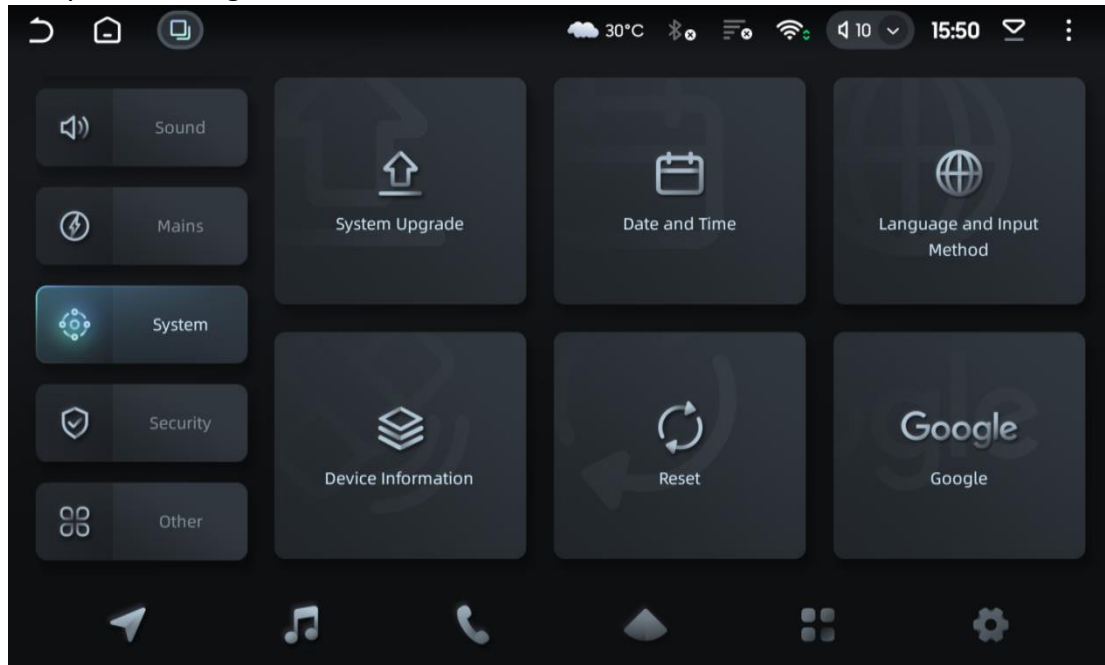

1: System upgrade, upgrade the system to the latest version.

2: Date and time: set the date and time, time zone, etc.

3; Language and input method, set the language and input method, keyboard, etc.

4; About this machine, vehicle machine status, configuration, version number and other related information.

5; Reset, (restore factory settings, all machine data will be cleared, please choose carefully).

6; Google account, log in to personal account.

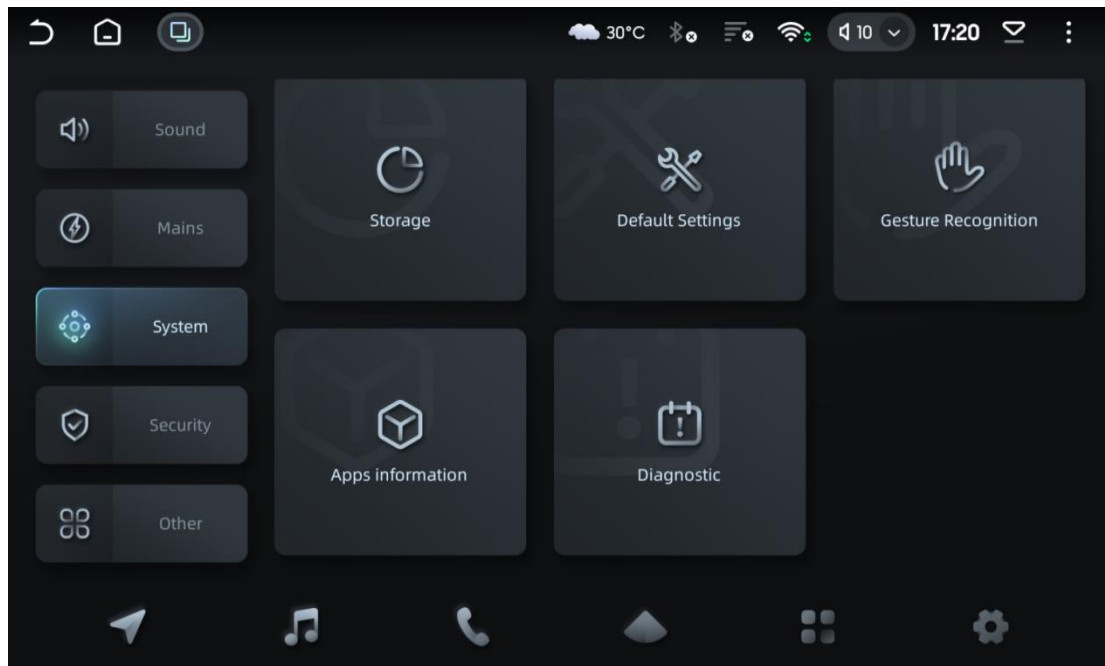

7; Storage, query the internal storage of the machine.

8; Factory settings, password 168.

9; Gesture recognition, slide two fingers up or down at the same time to increase or decrease the volume.

10; Application information, query all application information.

11; Fault log, software, protocol fault problems can upload logs.

## 6 ; Security Settings

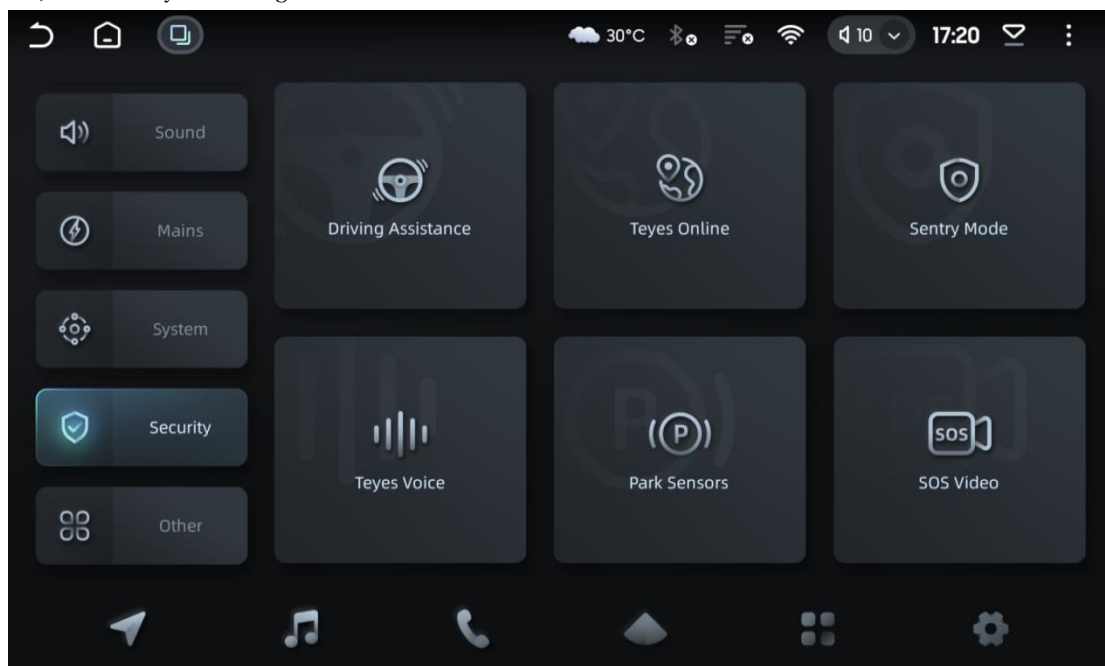

1: Driving assistance, ADAS vehicle warning.

2: teyes online, view car location, travel history, real-time camera and other functions.

- 3: Sentry mode, parking monitoring function.
- 4; Voice setting, voice control function.
- 5: Radar setting, applicable to teyes front and rear radar settings.
- 6; sos video

## 7. othersettings

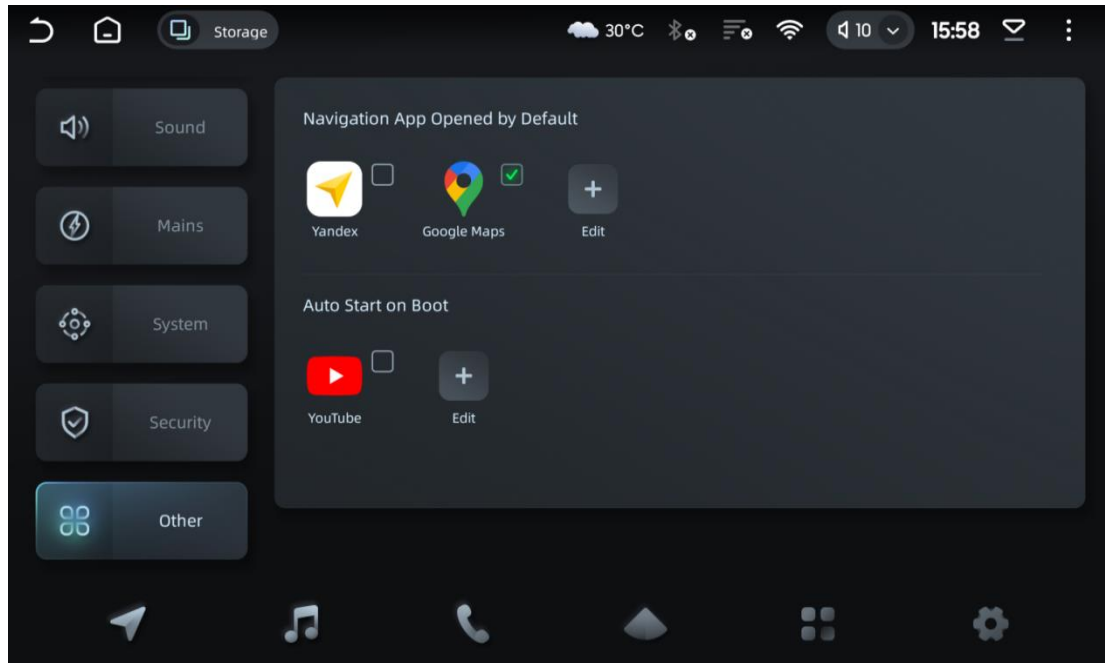

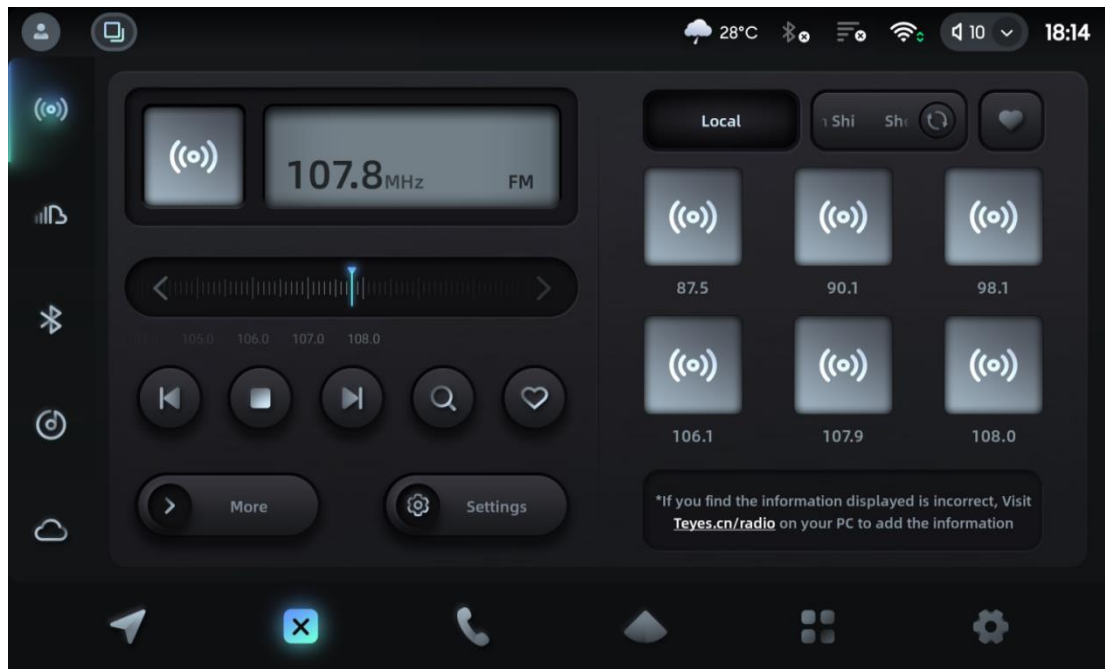

- 1: Navigation software that opens by default. Select the navigation software and the navigation will open the software by default.
- 2: Automatically start when the computer is turned on. Set a certain application to automatically open the software when the computer is turned on.

Radio

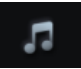
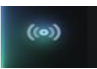

Click the music icon on the main interface “” “” , Entering radio mode

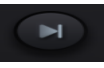
To enter the radio interface for the first time, long press “” 3 seconds, the radio will automatically search for radio stations. After the search is completed, the channel bar on the right will display the searched radio frequency band results. Click “” Manually adjust the frequency band forward, Click “” Manually adjust the frequency band backward。

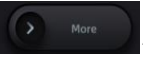
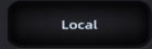
Click “” , More radio stations can be switched, and different radio frequencies can be switched。 Click “” , The radio band will receive local radio stations



。 Click “” Switch to Radio Settings, Click “” Save the current frequency band to the favorite station list.

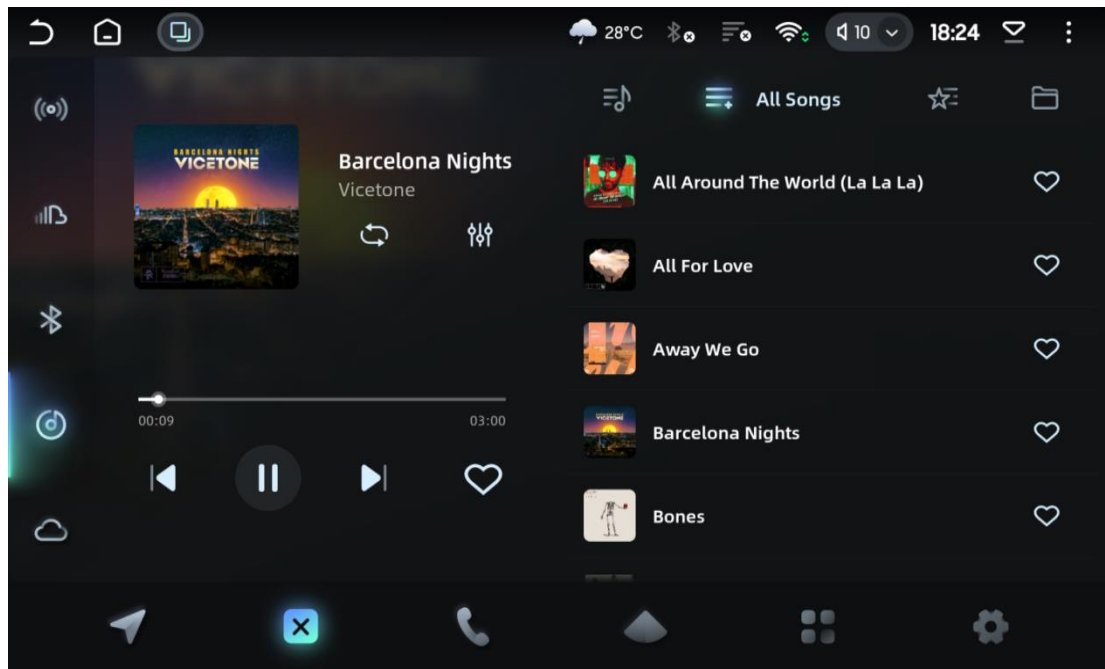

music

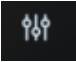

Click “” icon to enter the music player

Click“”Switch to the previous music, Click“”Switch to next music, Click“”





Play and Pause Music,Click“”Enter the sound EQ settings, Click“”Collect the current

music.Click “” Switch music loop mode, Click “” , Enter the music playlist

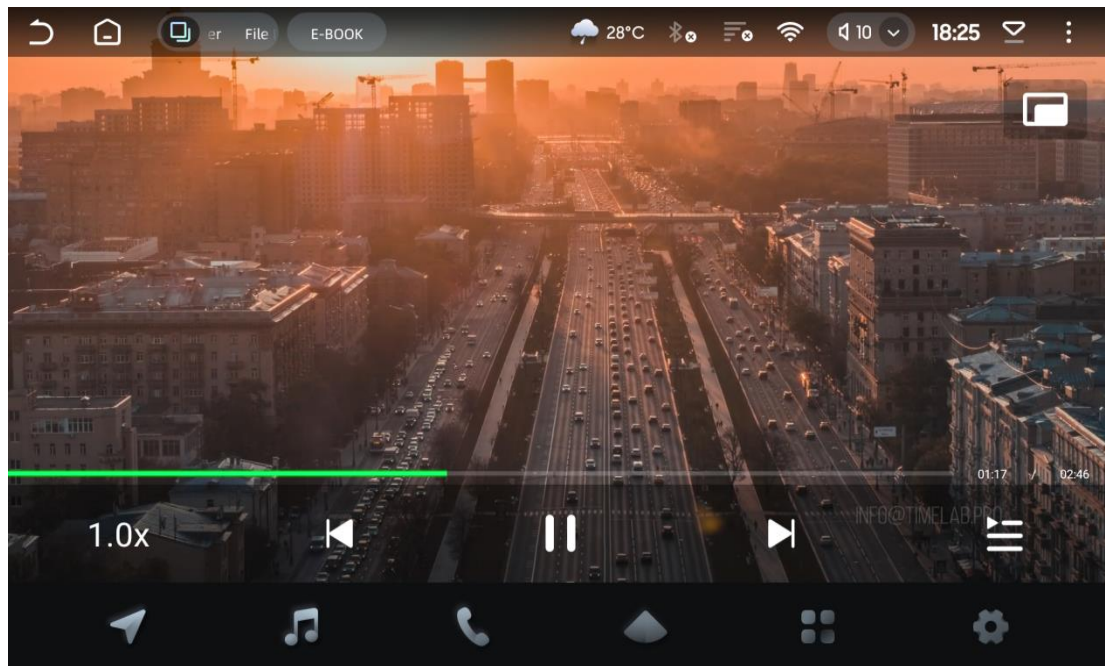
In the music list interface, music is categorized by current playlist, all, favorites, and internal storage, and by music list folder, artist, and album.

video



Click “” Play previous video, Click “” Play next video, Click “”  
 Pause Video, Click “” Enter the video playlist。Click “” , Enter  
 picture-in-picture video playback.

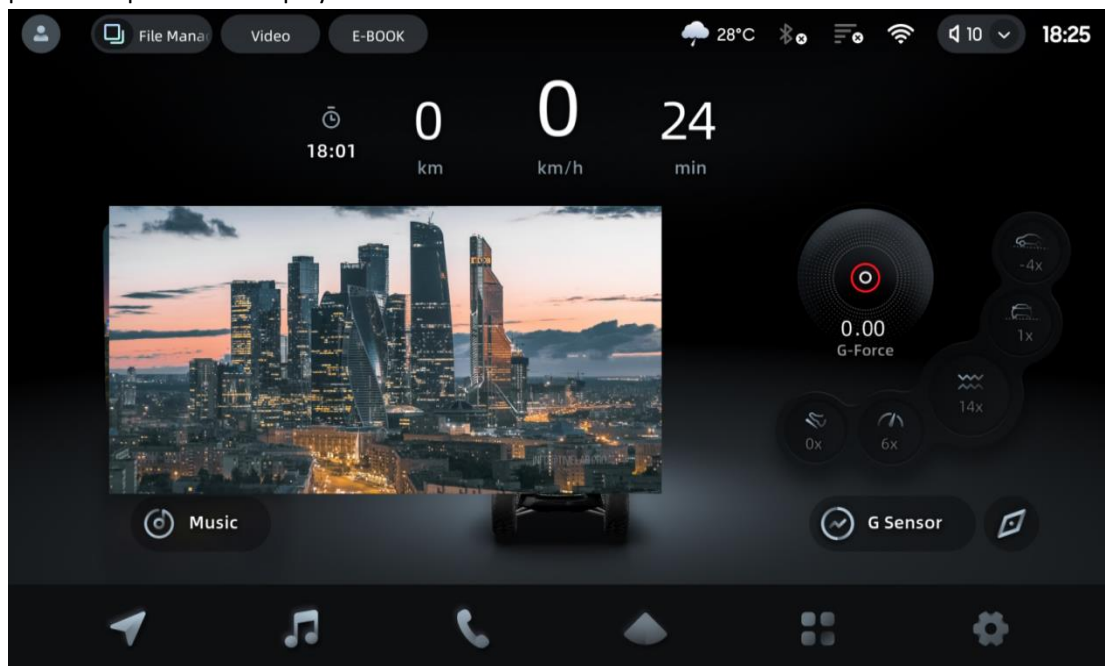

Bluetooth

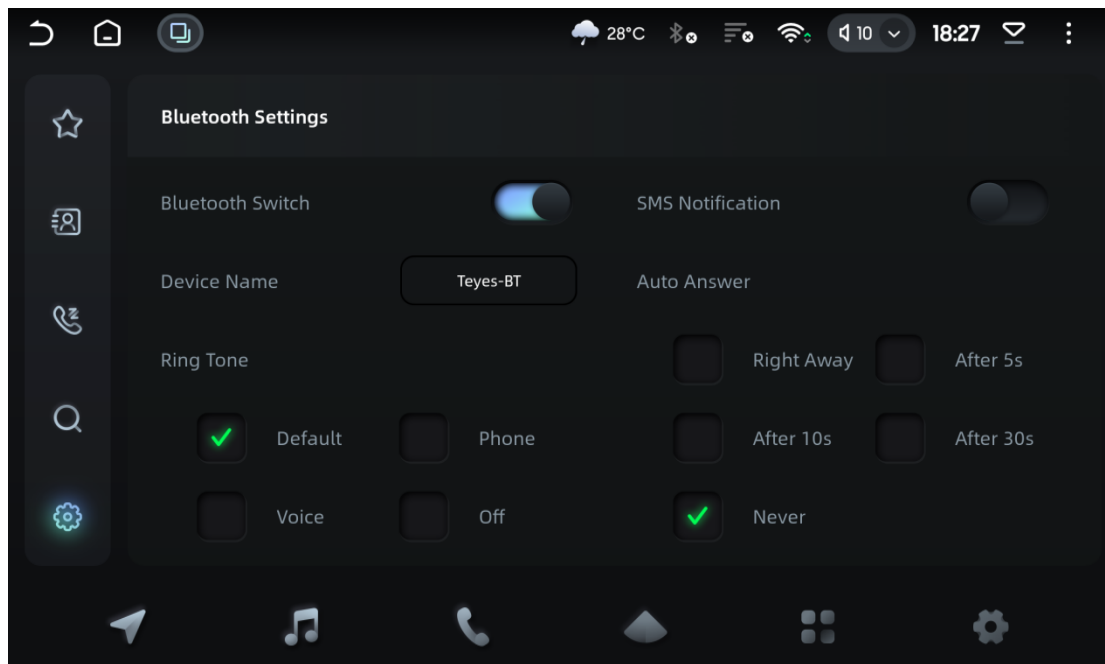

To use the Bluetooth hands-free function, you must first establish a connection between the vehicle and the phone.

1. Turn on the Bluetooth on the phone and activate the Bluetooth device search
2. Search for Bluetooth, the default device name is "teyes-BT"
3. After connecting, the phone will prompt you to enter the connection password "0000"
4. After the connection is successful, the connected status is displayed.。 “”

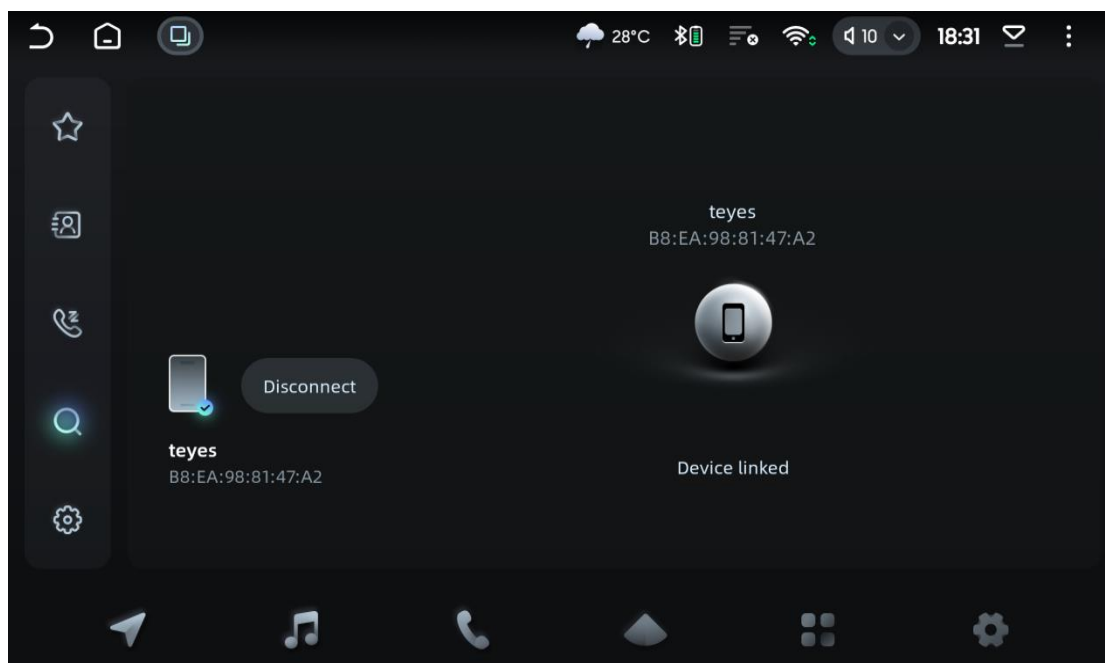

After the Bluetooth connection is successful, you can answer or hang up the call directly on the Bluetooth interface and synchronize the phone book , Click“”Search nearby BluetoothClick“”View call logs, Click“”Set Bluetooth name and connection key。

## Home page settings

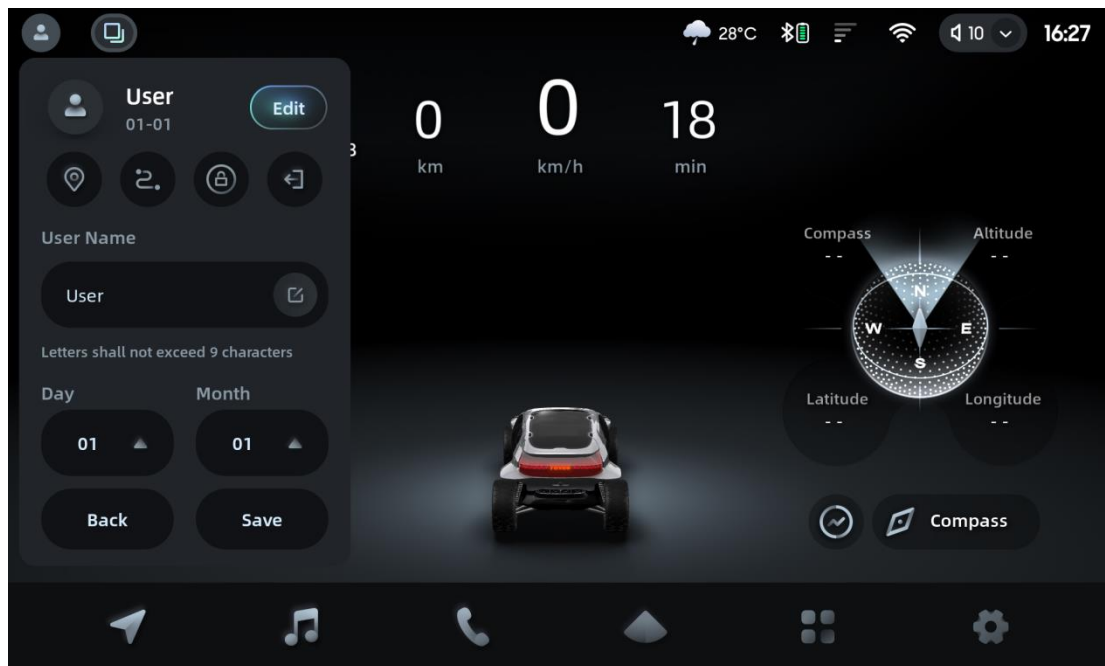



1; Click “” , Set the owner's personal information.

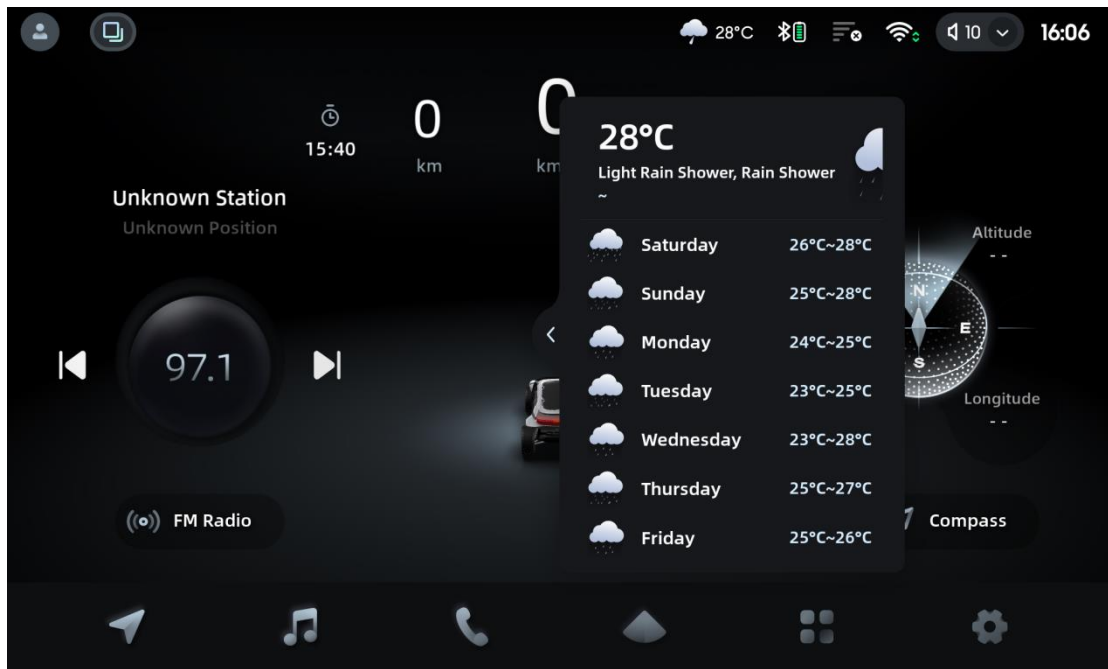



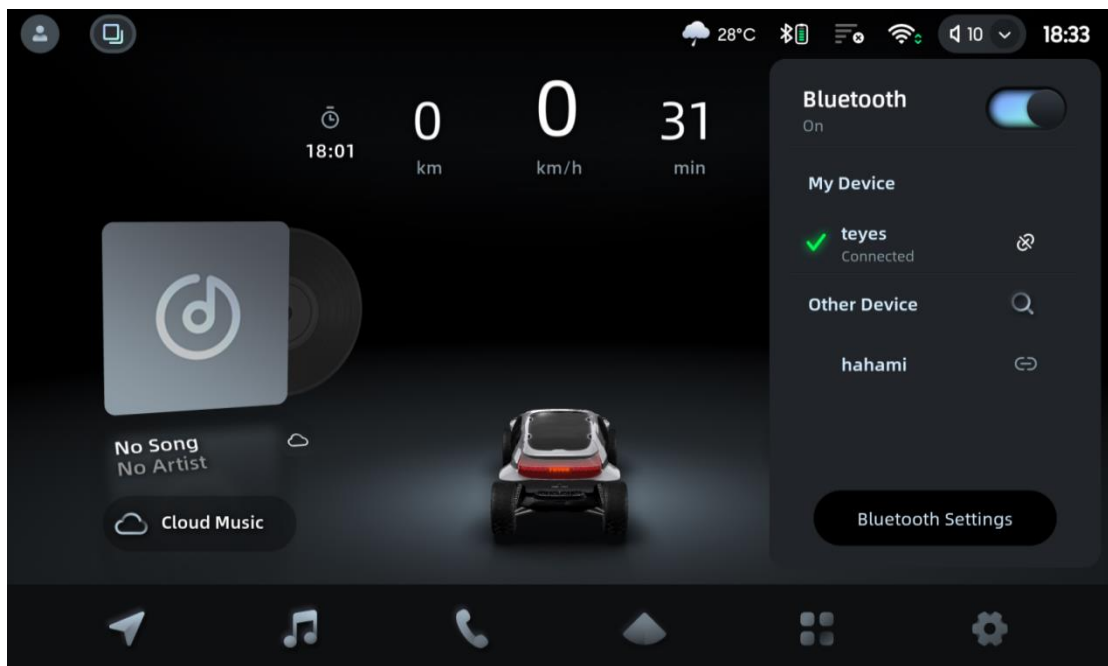

2; Click “ 28°C” Quickly check the weather.

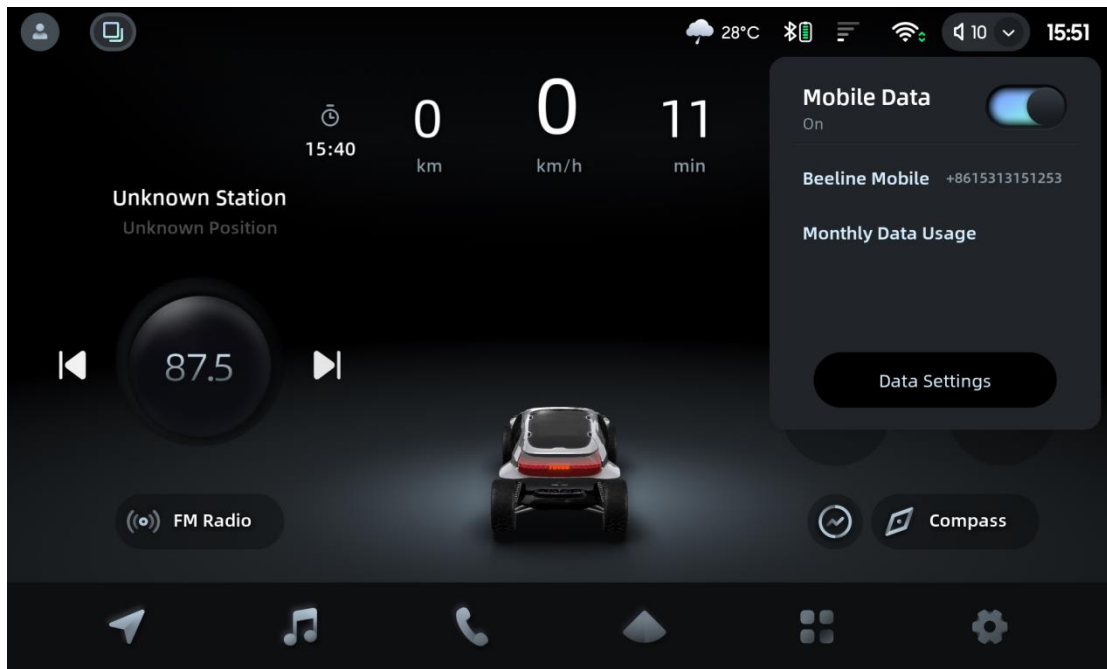

3; Click “ ” Allows for fast Bluetooth connections.



4; Click “” You can turn mobile data on or off.

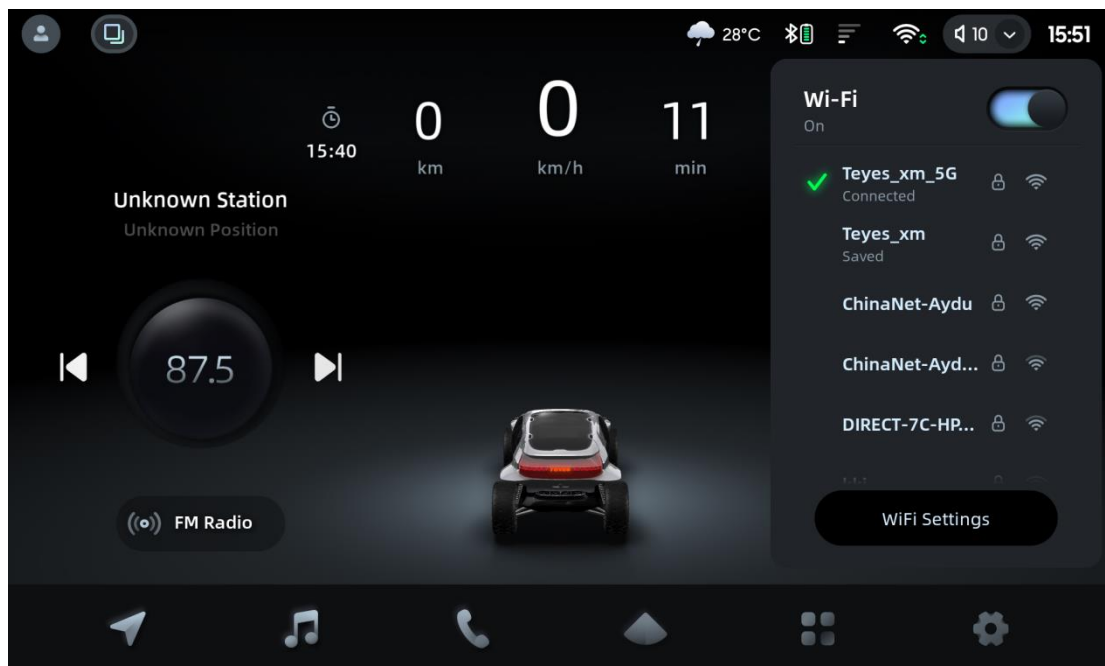

5; Click “” Can connect to wireless wifi network.

Bottom bar settings

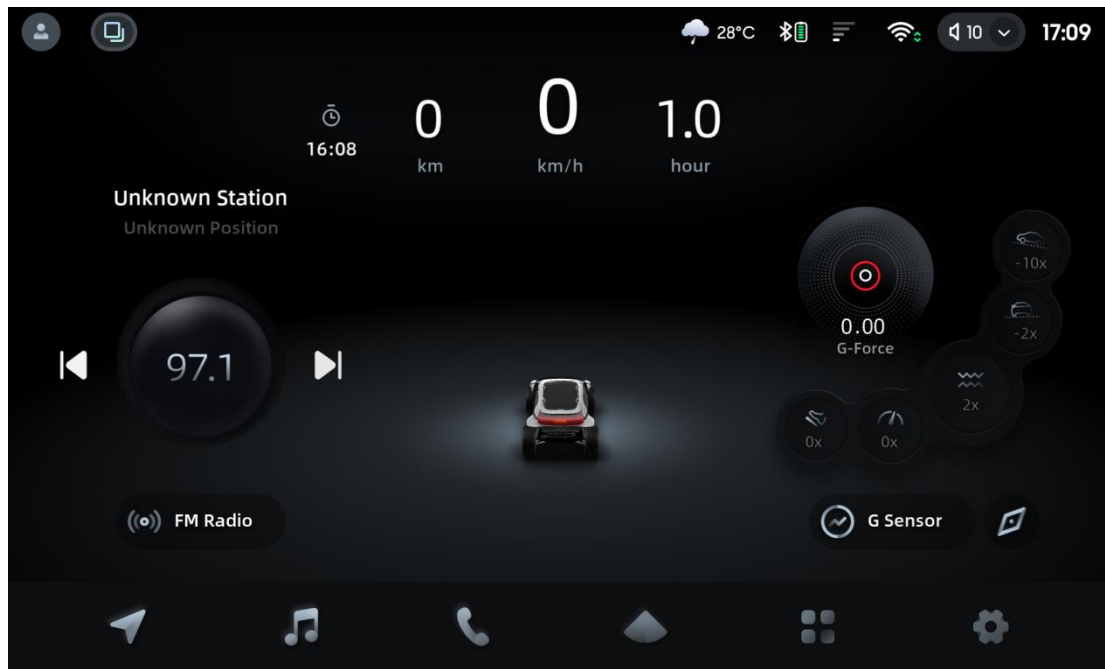

1; Click “” Open navigation.

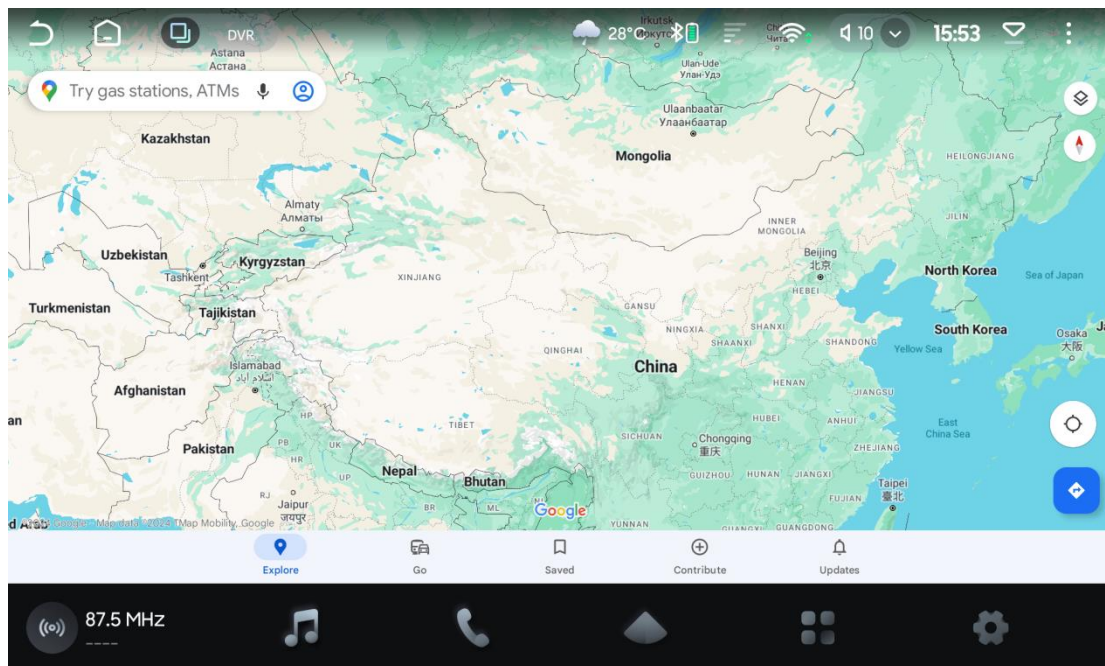

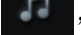

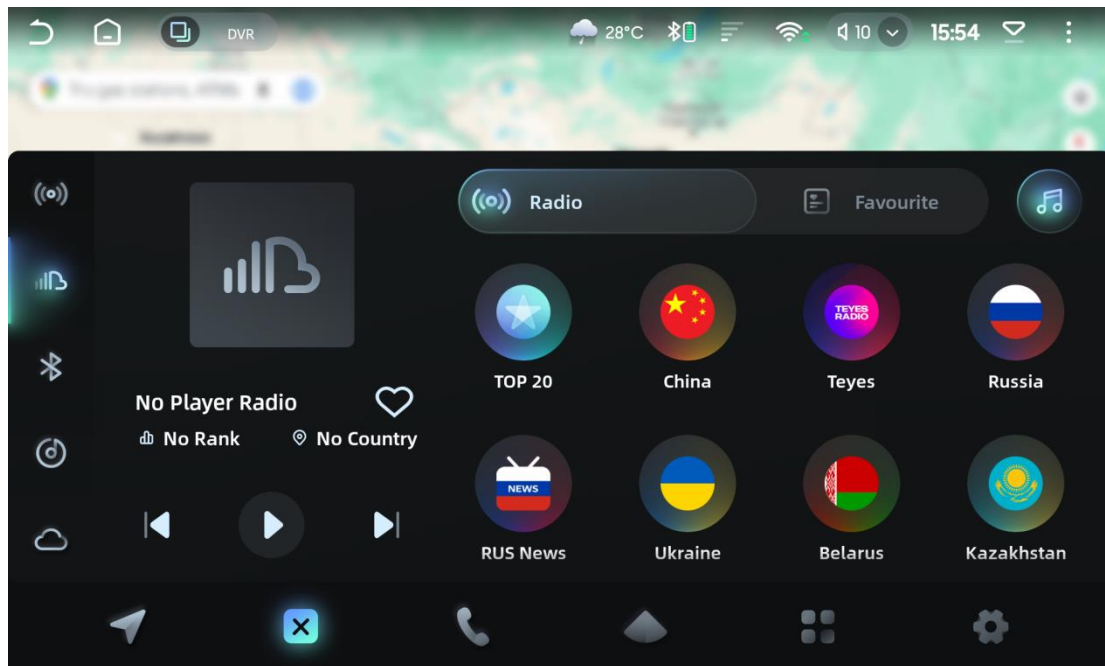
2; Click “” Open the media, there are quick operation programs such as radio, online radio, Bluetooth music, music, cloud music, etc.



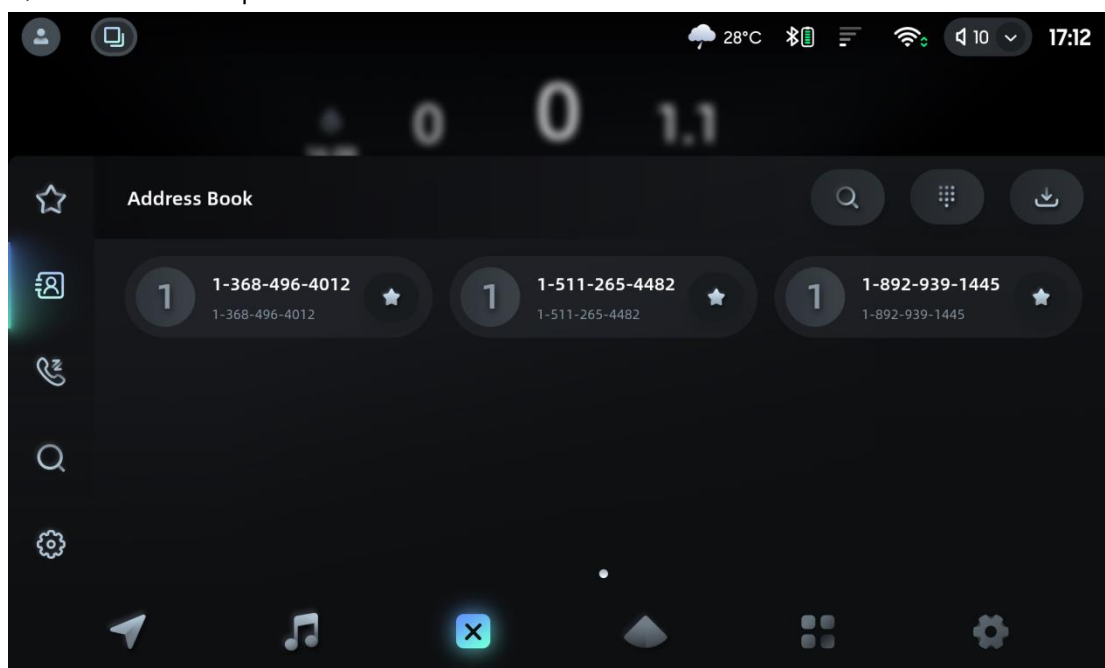

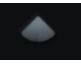

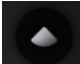
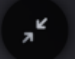
3; Click “” Open Phone.

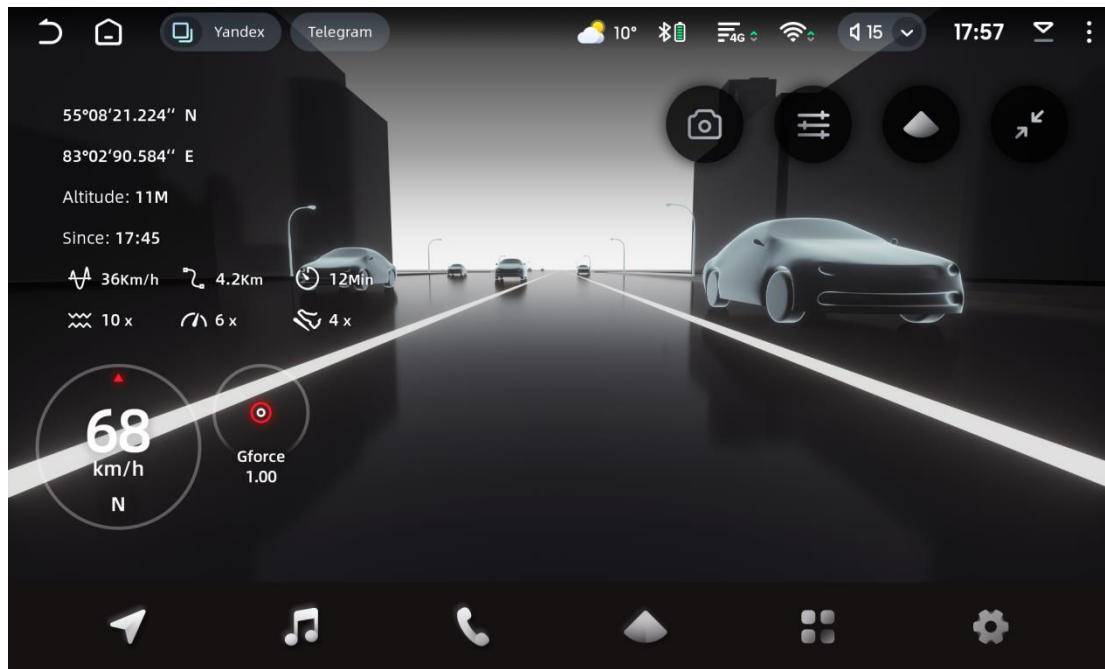

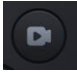
4; Click “” Open the front, rear and panoramic application pages。 Click “” Take a photo, Click “” Enter the camera parameter settings, Click “” Switch between front and rear view, or panoramic view, Click “” Zoom in and out,

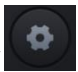

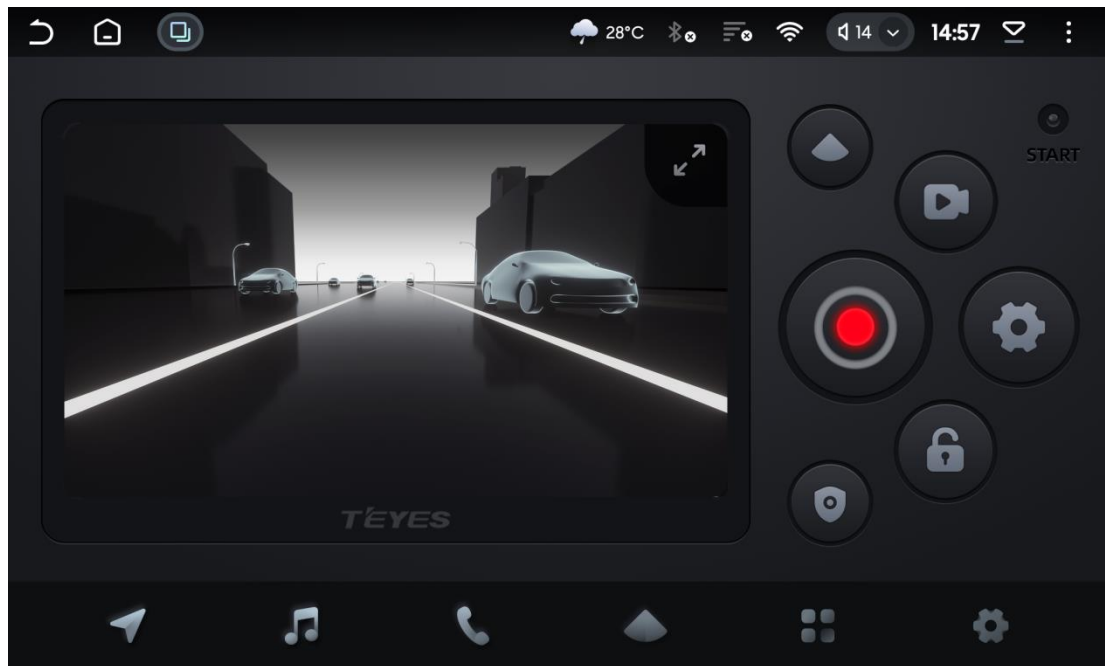

Click “” View recorded video files, Click “” Recording Video, Click “” Go to Settings, Click “” Switch camera view.





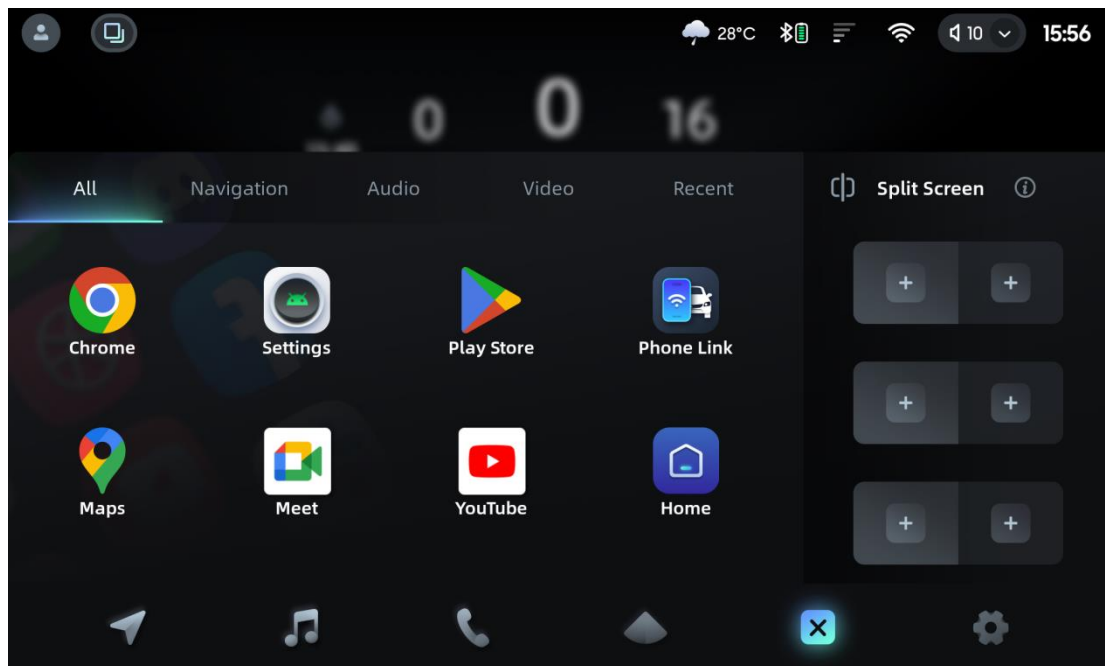

5; Click “” Open the software bar, you can classify the software separately, all, navigation, music, video, recent use. Set two software, click the application to display the application in split screen

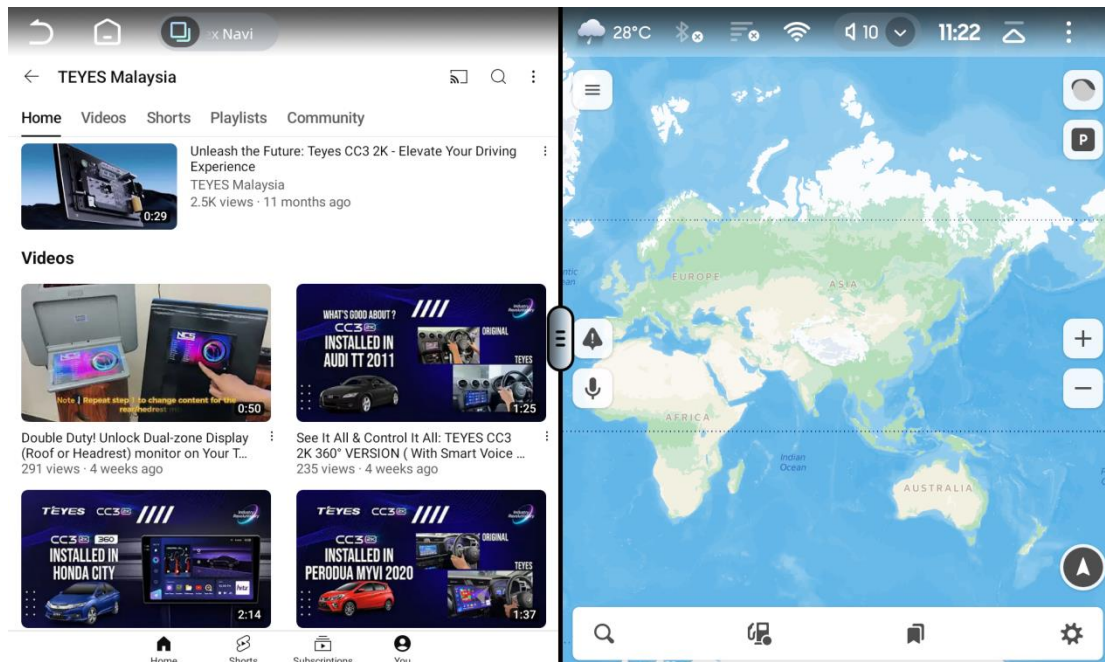

Click “” You can also split the screen between two apps, Click “” You can hide the bottom.status.bar.



6; Click “” You can view various status information of the machine, such as: Bluetooth, mobile data, Bluetooth, settings, playing music, temperature, clock, weather, voltage, screen brightness, sound, EQ, etc.



7; Slide the status bar at the bottom of the homepage to the right and click the + sign to add commonly used software, and press and hold for 3 seconds to delete

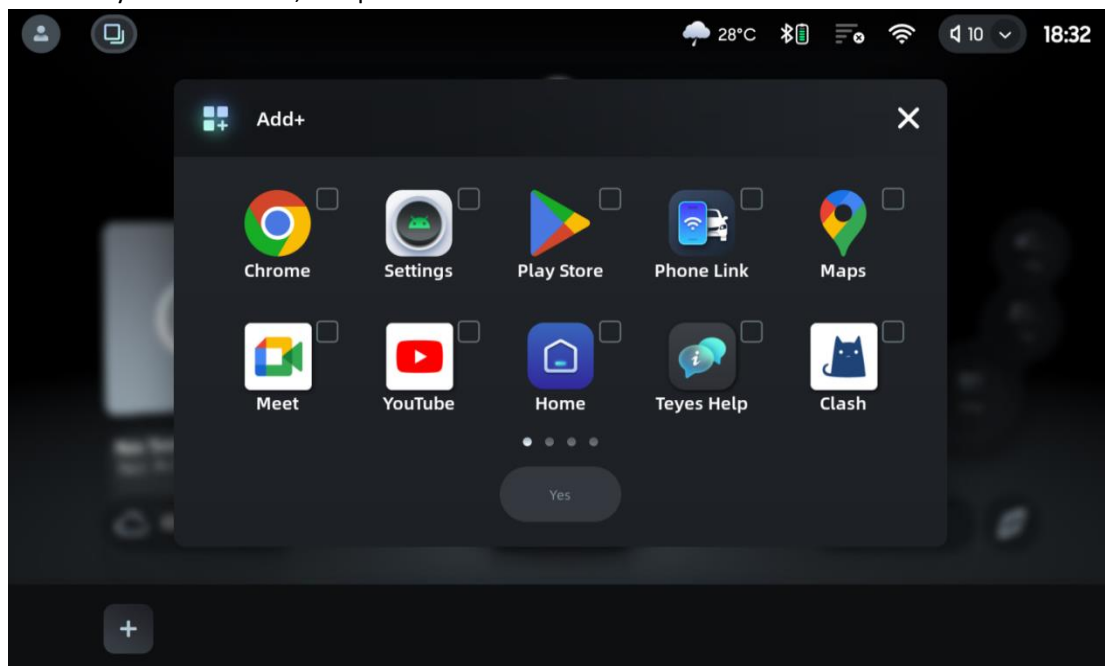

8; Click Home “ FM Radio” Can open radio stations, online radio stations, Bluetooth music, music, cloud music and other quick operation programs

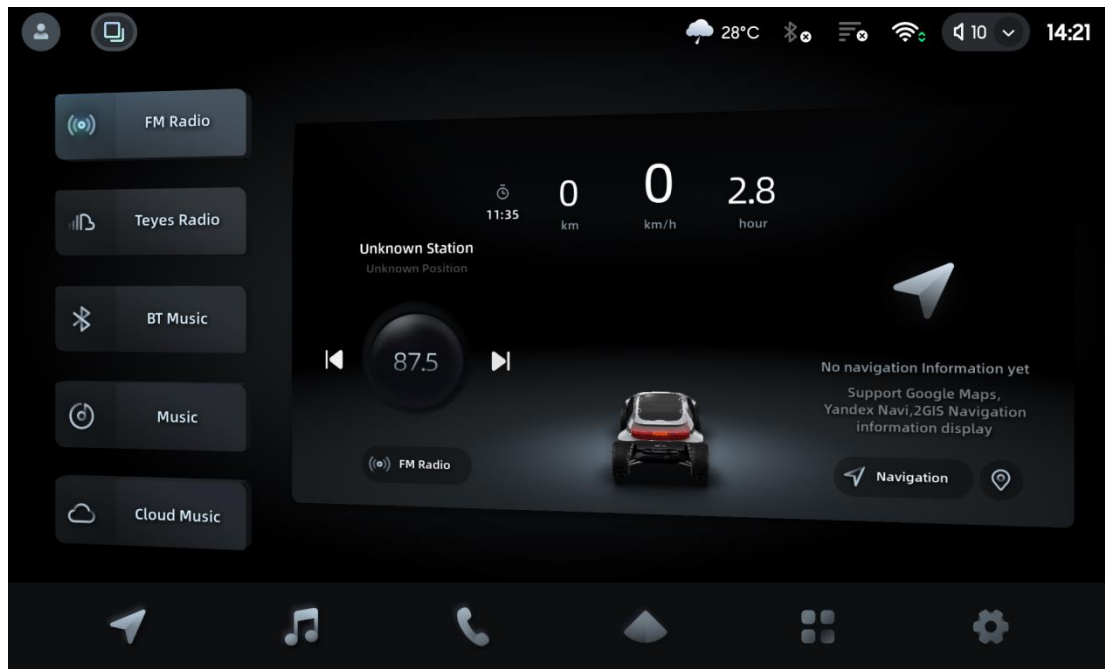

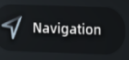
9; Click Home “ Navigation” You can open quick operation programs such as tire pressure, compass, Bluetooth, navigation, weather, etc.

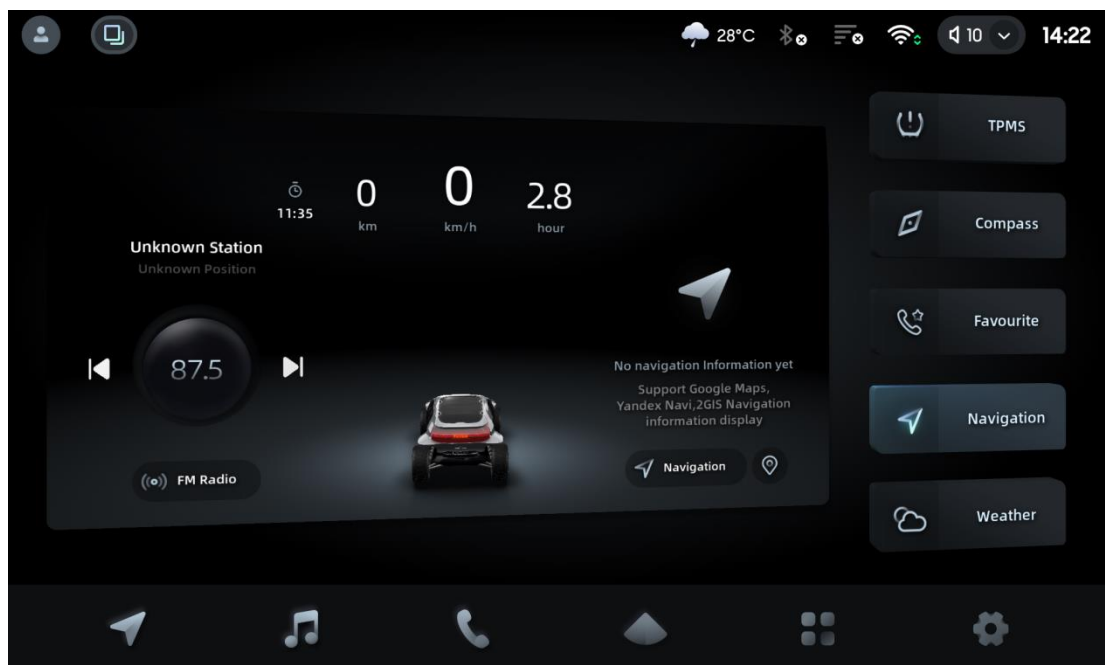

10; Click or slide “” Car model, you can switch the car model perspective and rotate it 360



degrees.

## Screen maintain

### 1. Notes

\*Do not leave the screen in direct sunlight or high temperature for a long time, otherwise it may cause screen failure

\*When not using the device, please avoid direct sunlight on the display

\*Please use the monitor within the following temperature range

Operating temperature range: -20 degrees Celsius ~ +70 degrees Celsius

Storage temperature range: -20 degrees Celsius ~ +80 degrees Celsius

\*Don't press hard on the LCD screen, otherwise it may cause malfunction

\*Vehicles with safety devices such as airbags should be careful not to interfere with the operation of the safety devices.

### 2. About LCD screen

\*There are sometimes small black dots or flashing dots (bright spots) on the LCD screen of the monitor. This is a unique phenomenon of the LCD monitor and is not a malfunction.

\*When used in cold areas, the LCD screen may be dark, but after a while it will return to normal brightness.

\*If there is direct sunlight in the display, it is not easy to see the picture because of the reflection of light.

### 3. About maintain

\*When there is dust on the cleaning screen or dirt on the monitor, turn off the power and wipe gently with a soft cloth.

\*Do not use volatile oils such as volatile oils or thinners to wipe the screen.

## GPS antenan

The GPS antenna can be mounted inside the car, such as on the outside of the vehicle, such as the roof. The GPS antenna must have an open "field of view" towards the sky. If the vehicle's glass is fitted with an explosion-proof membrane, the insulation film may weaken the strength of the GPS antenna's acceptance of the satellite signal.

### GPS antenna installation steps

\*When using a 3M fixed GPS antenna, be sure to use a suitable oil-soluble detergent to clean the paste position. After cleaning, remove the back paper, place the GPS

antenna in a proper position, and press firmly.

\*Remove the side panel and pass the thread through the storage box until the main console of the center console. Pay attention to tie the cable to the original car.

\*Connect the GPS antenna plug to the device

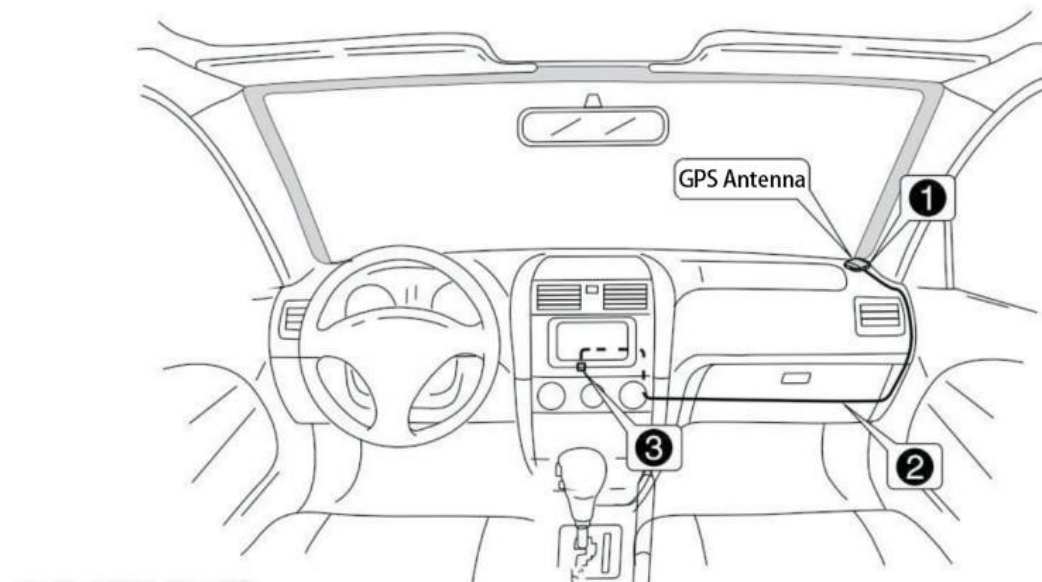

#### Precautions

\*When connecting the GPS antenna, make sure the system power is off.

\*Do not shorten or lengthen the GPS antenna; changing the length of the antenna may cause a short circuit or antenna failure.

\*The GPS antenna should be installed as far as possible to a horizontal plane; otherwise it may affect the navigation positioning accuracy.

\*Do not use a GPS antenna to wrap or interfere with the steering wheel or shift lever, as this may be dangerous.

#### Malfunctions;

If you encounter the following problems during use, the troubleshooting will help you solve the problem quickly. If the problem is still not solved, please contact the professional or consult the sales office. Do not open the machine yourself to avoid serious consequences Processing method

Situation	Reason	Processing method
Unable to start	ACC is not turned on, car power is not turned on	Turn on the ACC and turn on the vehicle power
	Power cable is not plugged into the device	Plug in the power cable
	This device fuse is burned	Replace the fuse with the

	off	same rated current
The touch screen does not respond	The system is processing (road search, etc.), wait a moment, if it still can't respond normally, it is recommended to contact the after-sales service to assist with the processing.	
Reversing without rear view image	Camera not installed	Install it
	Camera system does not match	Replace the camera with the matching system
The system does not start, there is a rear view image when reversing, the button is invalid.	Product design focuses on driving safety, preset reverse rear view priority	The system must be started normally after the reverse operation has been terminated.
GPS cannot be located	GPS antenna is not inserted	Insert GPS antenna
	Maybe in the GPS signal shielding area	Try to drive the vehicle for a while to see if the GPS signal is restored. If it is not restored, please contact after-sales service.
Cannot locate and navigate after booting	Some remote areas or roads have not been built on this map.	Please contact the after-sales service department to confirm the update map.
No information on the map	It may be that the navigation scale is set too large or too small. Try changing the scale size to see if you can restore the map display. If it is still not resolved, it may be caused by losing the location information, you can try to reset the destination.	

## FCC Statement

This equipment has been tested and found to comply with the limits for a Class B digital device,

pursuant to part 15 of the FCC Rules. These limits are designed to provide reasonable

protection against harmful interference in a residential installation. This equipment generates,

uses and can radiate radio frequency energy and, if not installed and used in accordance with

the instructions, may cause harmful interference to radio communications. However, there

is no guarantee that interference will not occur in a particular installation. If this

equipment does cause harmful interference to radio or television reception, which can be determined by turning the equipment off and on, the user is encouraged to try to correct the interference by one or more of the following measures:

- Reorient or relocate the receiving antenna.
- Increase the separation between the equipment and receiver.
- Connect the equipment into an outlet on a circuit different from that to which the receiver is connected.
- Consult the dealer or an experienced radio/TV technician for help.

Caution: Any changes or modifications to this device not explicitly approved by manufacturer could void your authority to operate this equipment.

This device complies with part 15 of the FCC Rules. Operation is subject to the following two conditions:

(1) This device may not cause harmful interference, and (2) this device must accept any interference received, including interference that may cause undesired operation.

This equipment complies with FCC radiation exposure limits set forth for an uncontrolled environment. This equipment should be installed and operated with minimum distance 20cm between the radiator and your body.