

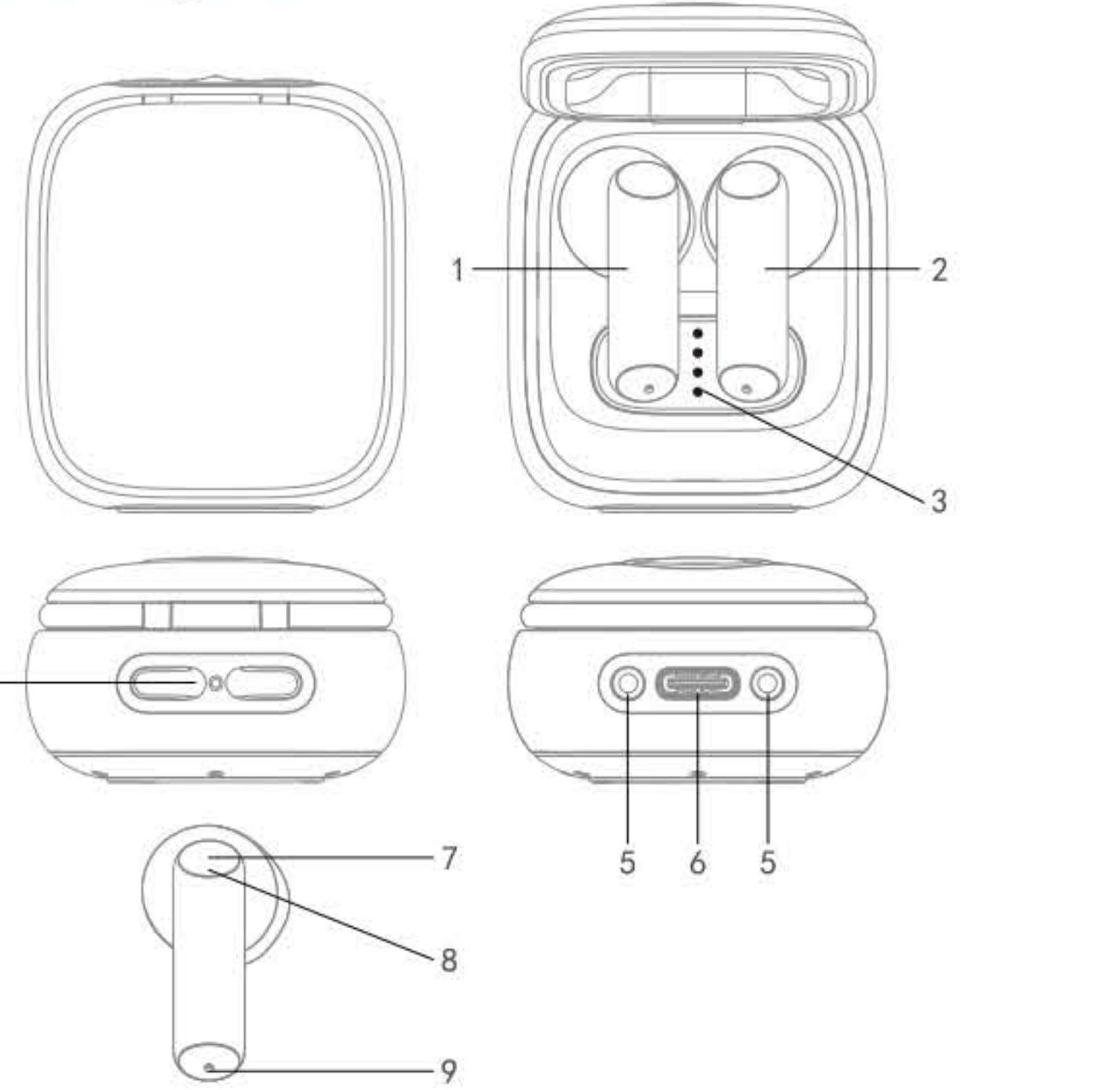

Guard series Bluetooth headset

operating manual

Appearance layout



- 1.Appearance layout:left ear, 2.Appearance layout:auris dextra
3.Battery indicator: from top to bottom, it indicates 100%, 75%, 50%, and 25% battery level.
4.Lanyard buckle: can be used to put a portable lanyard through.
5.Charging light: flashes when charging and stays on when fully charged.
6.Charging port: TYPE-C.
7.Touch buttons: single click (play/pause, answer/hang up calls, long press to reject calls whenreceiving calls)double click (next song), triple click (increase volume on the main device/decrease volume on the auxiliary device), long press (2 seconds to summon siri, 4 seconds to power on, 4 seconds to power off).Earphone indicator: flashing (waiting to pair), light off (connected successfully).
8.Earphone indicator: flashing (waiting to pair), light off (connected successfully).
9.Microphone.

Bluetooth Connection Diagram

- 1.The maximum effective connection distance between the headset and the phone is no more than 10 meters in the absence of obstacles.
2.Take out the headset, and the headset indicator light will start to flash. This indicates that the Bluetooth of the headset is in the standby connection state.
3.Activate the "Search Bluetooth" function on your phone. Please refer to your phone's manual for correct operation.
4.In the Bluetooth search list on your phone, select and click on "AIPI Little Prince Collection" to establish the connection.

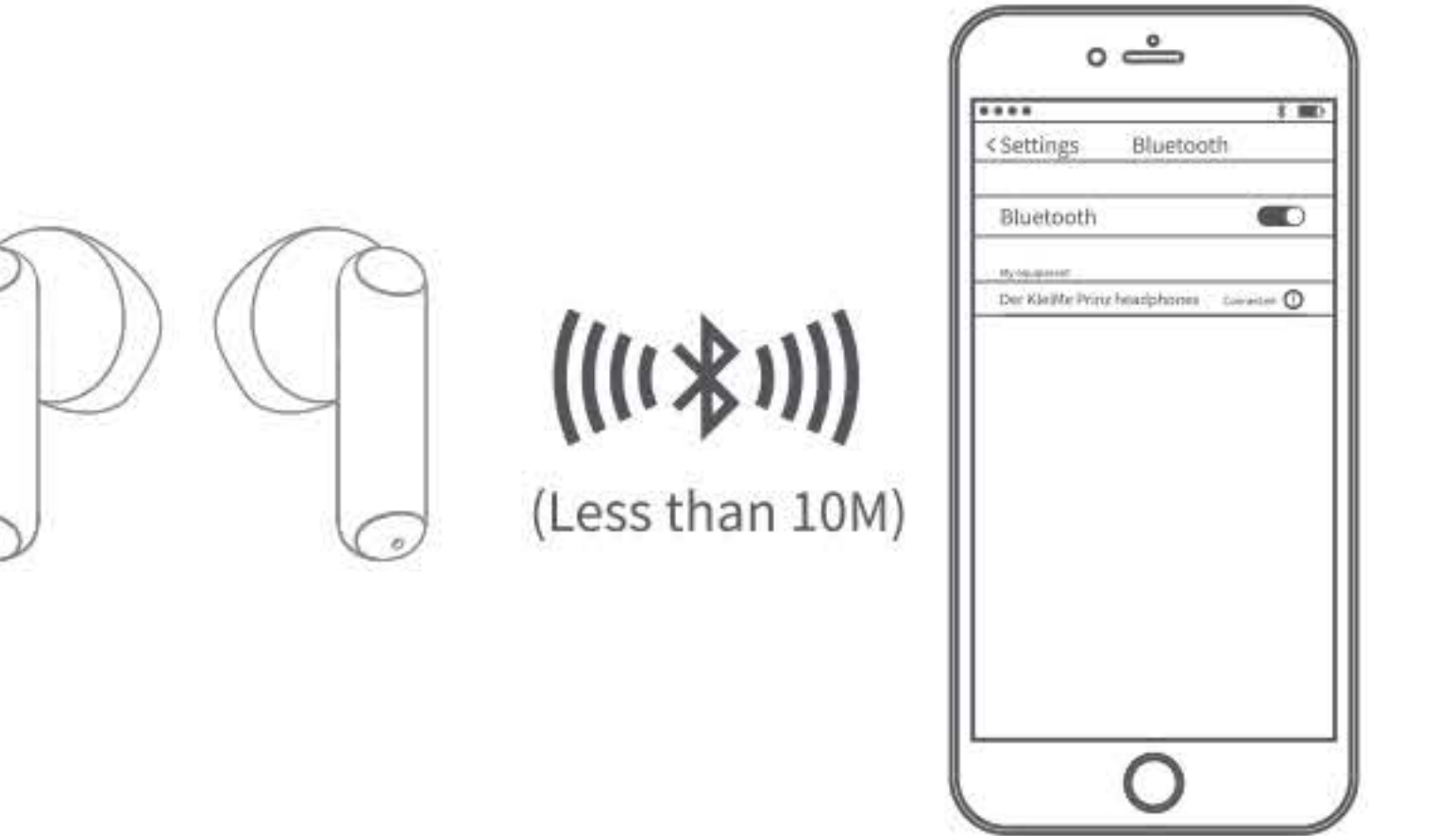

Note: When connecting this device with a mobile phone or other Bluetooth electronic devices, radio signals are used, but such connection is not stable and reliable in all situations. Therefore, in case of emergency, please do not rely solely on this device for communication.

Bluetooth Connection Diagram

Product Model	APWZ-605
Bluetooth Version	5.2
Effective Distance	≤10m
Battery Specification	300mAh lithium battery
Supported Audio Protocol	A2DP AVR CP
Charging Function	Supports USB charging/DC 5V adapter
Continuous Music Play Time	About 3H (tested at 70% volume)
Rated Power (Complete machine Working)	5mW
Speaker Impedance	32Ω +15%
Frequency Response	20Hz-20kHz
Operating Temperature	-10°C~45°C

Note: The data in this manual is derived from laboratory testing, and actual use may vary slightly.

Light Status

Indicator color	Working condition
The headphone light flashes rapidly	Working condition
Headphone light off	Waiting pair

Product charging

Charge the machine: Use the TYPE-C charging cable, connect the product to the USB port of the computer, you can also use the 5V-1A power adapter to charge, if you need fast charging, please use the 5V-1A power adapter.



Security specification

- 1.Protect from sun exposure and rain, and prevent severe vibration, impact or extrusion.
2.Should be stored in the ambient temperature -10°C~45°C, the relative humidity is not greater than 75% of the indoor, should avoid contact with corrosive substances, away from the fire source.
3.This product is not to be discarded as ordinary garbage, such waste equipment must be carried to the appropriate The battery recycling point is processed.
4.The material is lead-free environmental protection material.
5.This product is not suitable for children under 14 years of age alone and must be used under adult supervision.
6.This product complies with the electronic standard GB8898 report, No. R0317120224S.

Note: If consumers violate the above warning and cause personal and property damage, they will bear all the costs.

Packing list

Bluetooth headset *1 Charging cable *1 instruction manual *1 Necklace *1

Matters needing attention

- *Please carefully read the following content before using this product. Incorrect usage methods or incompatible devices may damage your product or cause damage to this product.
*Do not scratch the surface of this product's shell with sharp objects. Do not throw, shake, strongly press, or attempt to disassemble the product.
*When not using for a long time, please ensure that the product is fully charged at least once every three months.
*Do not use chemicals or strong cleaners to clean this product.
*After charging your digital products, please unplug the connecting cable promptly to prevent the cable from consuming some of the power of this product.

Notes/Precautions

- *When using, please carefully check if the voltage of the product to be charged is compatible with this product.
*Please do not place it in water, fire, or environments with extremely high or low temperatures.
*Keep this product away from children and do not allow them to play with it.
*Please do not forcibly dismantle or modify the product to avoid damaging its protective mechanisms, which may cause the battery to overheat, catch fire, or explode.
*If any abnormal odor, excessively high temperature (normal use generates heat but should not be hot to the touch), or shape changes occur while the product is in use, charging, or storage, please stop using it immediately and contact the dealer.
*Please note that any shortened lifespan or damage to the product caused by incorrect use or placement by the user does not fall under the warranty or manufacturer's liability. Thank you for your understanding.

Warranty Instructions

- 1.Thank you for choosing our company's product. If the product malfunctions or is damaged due to quality issues, please promptly return it to the designated repair center or dealership. We offer a 7-day money-back guarantee, a 15-day replacement policy, and a 1-year warranty from the date of purchase.
2.Faults or damages caused by self-disassembly or improper use are not covered by the warranty.
3.Please keep this card properly and present it for warranty repairs. Any alteration is not allowed.

Warranty Coverage

Quality issues that arise under normal use conditions and are not caused by external forces are covered by the warranty. However, damage caused by unauthorized disassembly, ingress of foreign objects, dampness, tampering or tearing of product labels, as well as any other visible human-caused damage, and natural disasters such as earthquakes, floods, and fires are not covered.

The product's model approval code is displayed through the "product nameplate label".

FCC Warning

This device complies with Part 15 of the FCC Rules. Operation is subject to the following two conditions:
(1) This device may not cause harmful interference, and (2) this device must accept any interference received, including interference that may cause undesired operation.

NOTE 1: This equipment has been tested and found to comply with the limits for a Class B digital device, pursuant to part 15 of the FCC Rules. These limits are designed to provide reasonable protection against harmful interference in a residential installation. This equipment generates, uses and can radiate radio frequency energy and, if not installed and used in accordance with the instructions, may cause harmful interference to radio communications. However, there is no guarantee that interference will not occur in a particular installation. If this equipment does cause harmful interference to radio or television reception, which can be determined by turning the equipment off and on, the user is encouraged to try to correct the interference by one or more of the following measures:
- Reorient or relocate the receiving antenna.
- Increase the separation between the equipment and receiver.
-Connect the equipment into an outlet on a circuit different from that to which the receiver is connected.
-Consult the dealer or an experienced radio/TV technician for help.

NOTE 2: Any changes or modifications to this unit not expressly approved by the party responsible for compliance could void the user's authority to operate the equipment.

The device has been evaluated to meet general RF exposure requirement. The device can be used in portable exposure condition without restriction.

The device must not be co-located or operating in conjunction with any other antena or transmitter.

Warranty Card

User Name: _____

Contact Address: _____

Product Name: _____

Contact Number: _____

Specification and Model: _____

Purchase Date: _____

Problem Description:

Date: _____

Certificate of Quality

Inspector: _____

Production Date: See product seal or identification code