

## 2 Packing list



Sculpfun G9



Smoke exhaust duct  
Throat hoop, Flange



Power supply



USB data cable



USB security key



Material fixture\*2  
Hand screw\*2



Focusing sheet\*5



Free materials



Tool accessories  
package



U Disk\*1



Manual



Ruler\*1



Coherent paper\*5



Goggles\*1

### 3 Introducing G9

The machine should only be operated from the front. Be careful to avoid tipping, which could cause laser leakage.



Product appearance structure

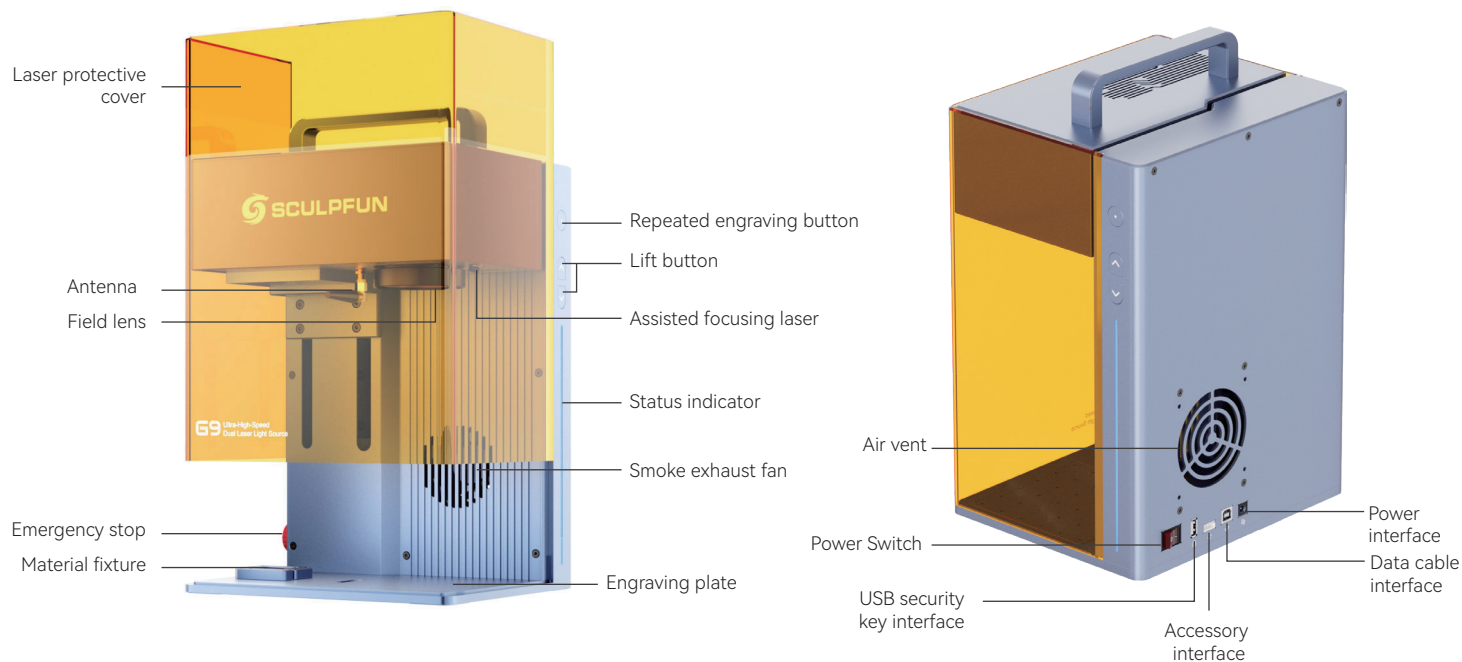



# Indicator light description

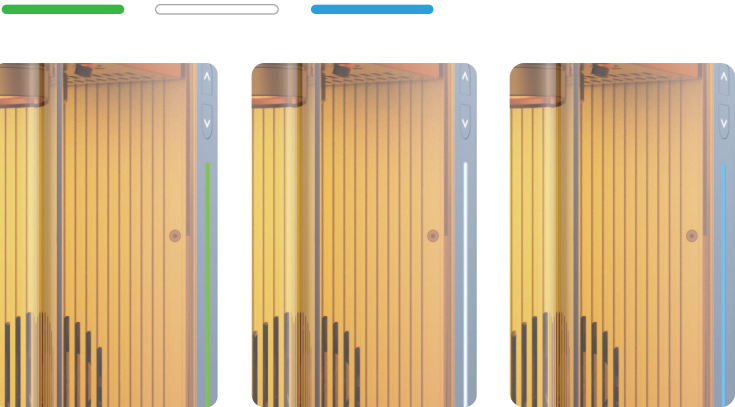

Three color statuses of the indicator light



Indicator light identification	Indicator Color	Device status
Always on	Solid green 	The machine is in standby or focusing
	Solid white 	Red light processing
	Solid blue 	Blue light processing

## Product parameter specifications

G9 detailed parameters		
	Red light	Semiconductor blue light
Laser power	2W	10W
Wavelength	1064nm	455nm
Input	12VDC 9A 108W	
Engraving area	105*105mm	
Marking speed	≤5000mm/s	
Spot accuracy	0.01mm	
Support system	Android / iOS / iPad / Windows / macOS / compatible with lightburn	
Certification	CE / ROHS / FCC / FDA	
Connection method	WIFI / USB	
Working temperature	10-30°C	
Cooling system	Semiconductor+air cooling	
Preview method	Rect preview+outline preview	
Support file formats	SVG / DXF/ JPG / PNG / BMP	
Product size	230*195*321mm	
Product weight	7. KG	

## 1 Preparation in advance

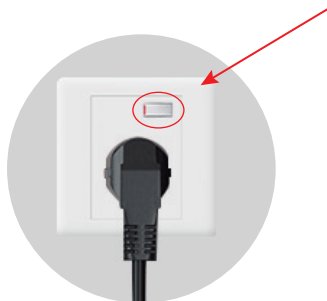
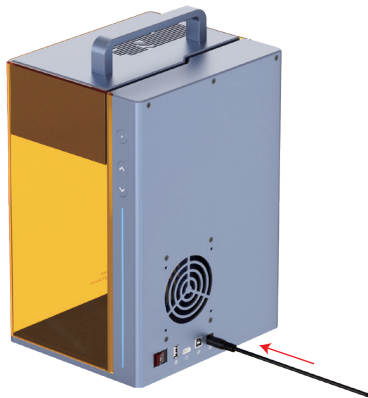

When connecting the machine to the power supply, it is recommended to plug it into a socket with an independent switching power supply.

- 1 • Connect the power interface of the machine.

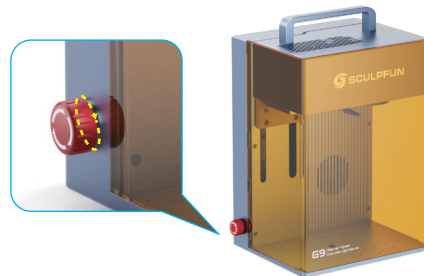

- 2 • Plug in the data cable and plug the other end of the interface into the computer.

- 3 • Make sure the emergency stop switch is not on.

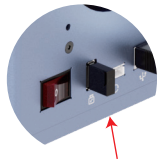

Note: Do not insert a U disk into the USB security key interface, as it may damage the U disk.

- 4 • Check whether the USB security key interface is plugged in.

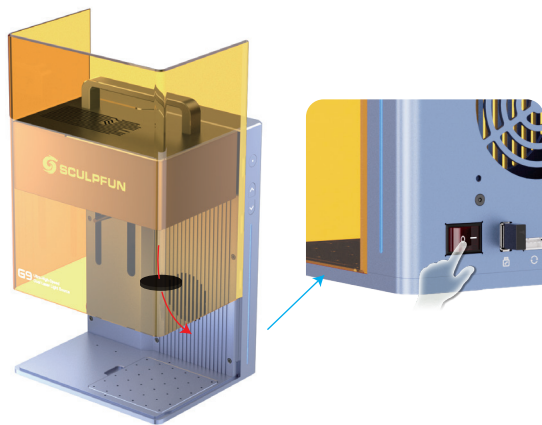

- 5 • Open the PVC laser cover, remove the field lens cover inside the laser head, and turn on the boat-shaped switch on the back of the machine.

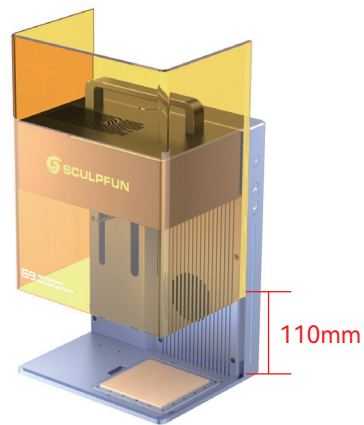

- 6 • Open the cover, put in materials, focus, etc.

The laser protective cover uses a magnetic design and can slide up to 110mm. Sliding it further may cause the cover to fall off.



## 2 PC software/mobile app usage

### PC software

After connecting the G9 to the software, you can start creating work content. For a detailed tutorial on how to use the software to operate the G9 for material processing, please scan the QR code to learn more.



QR code

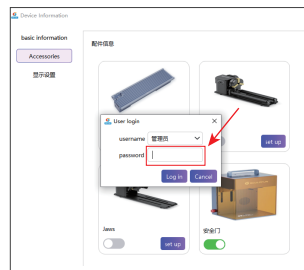

To use G9 accessories and configure the parameters, open the device information, enter the password "sculfun001," and then set up the corresponding accessory parameters.



Caution—use of controls or adjustments or performance of procedures other than those specified herein may result in hazardous radiation exposure.

## Guide to the use of G9 with a PC -win as an example

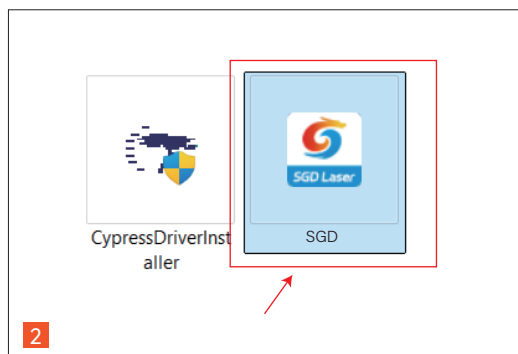
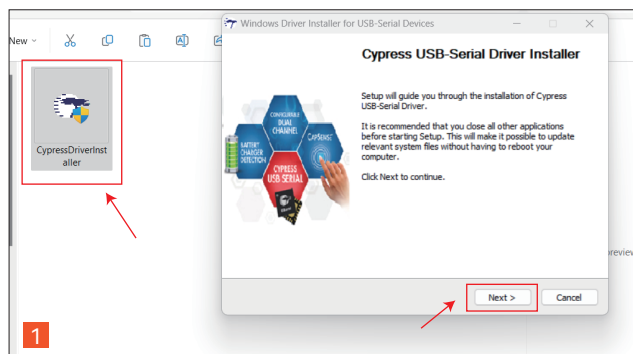

1. The windows system needs to install the driver, open the attached U disk and find "CypressDriverInstaller.exe", double-click to run the file, and complete the driver installation.
2. Open the U disk and find the SGD Laser computer software, and complete the installation.

3

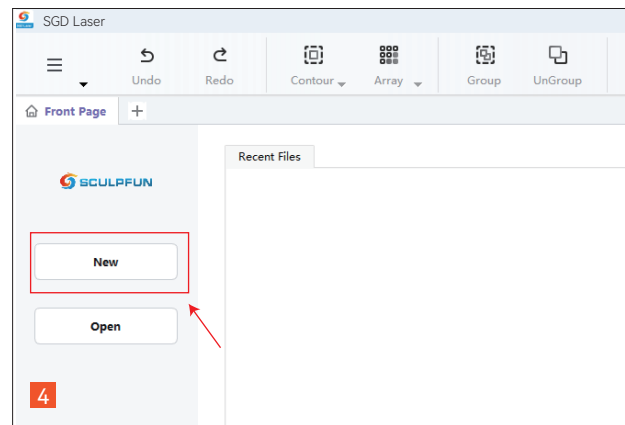

3. Power on the G9 and connect the data cable to the computer.

4. Open the SGD LASER software and click "New" to create a new canvas.

# Main interface introduction overview

