

AL7005 Installation Instruction

What's Included

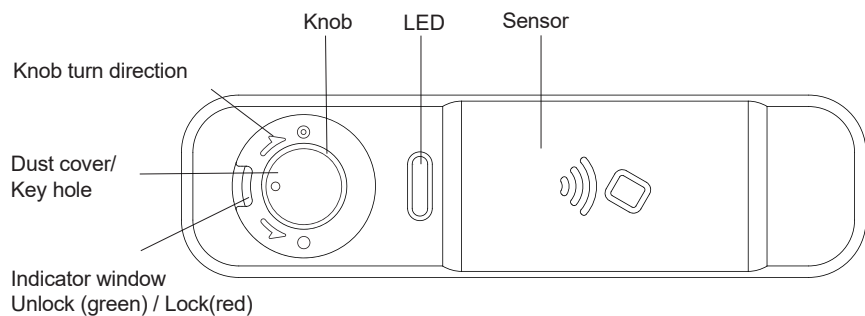

Standard				Option			

Battery Setting

1

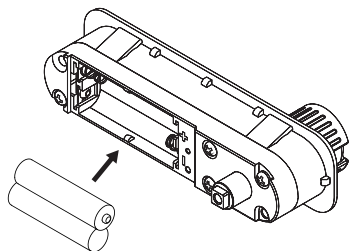

2

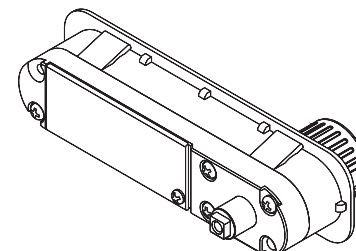
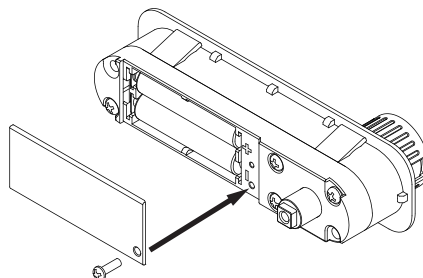

Assembling

1

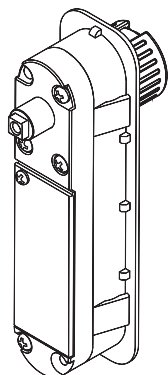

2

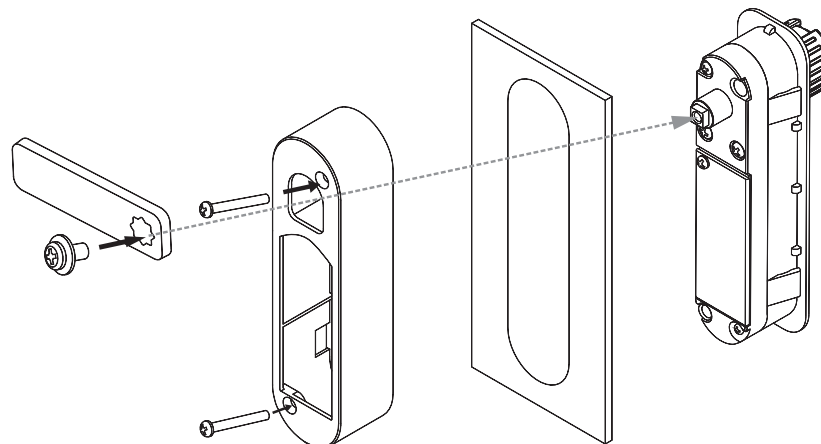

AL7005 Operation Instruction

Locking & Unlocking

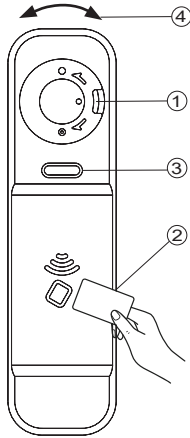

To Lock

- ① In the Unlock Status - Green indicator
- ② Touch a compatible card to the lock
- ③ The green LED flash and hear 1 "Beep"
- ④ Rotate the knob to lock the door

To Unlock

- ① In the Lock Status - Red indicator
- ② Use the same/register card to touch the lock
- ③ The green LED flash and hear 1 "Beep"
- ④ Rotate the knob to unlock the door

※Touch the card without turning the knob after 10 seconds, the red LED flash and hear 1 "Beep", then please touch it again.

Light (LED) and Sound Instructions

Operation Instructions	LED Instructions	Sound Instructions
Master Card Lock/Unlock	Green light flashes once	1 short beep
Correct User Card Unlock	Green light flashes once	1 short beep
Incorrect User Card Unlock	Red light flashes twice	2 short beeps
User Card Lock	Green light flashes once	1 short beep
Touch the card without turning the knob after 10 seconds	Red light flashes twice	2 short beeps
Low Battery Lock/Unlock	Green light flashes once, rotate the knob to the lock/unlock position, red light flashes 3 times	1 short beep

Technical Specifications

- **Card Specifications** : 13.56 MHz frequency, ISO14443A RFID card
- **Battery** : 2 x AAA alkaline batteries
- **Low Battery Warning** : When the battery is running low, rotate the knob to the unlock/lock position, and the red light will flash three times. At this point, please replace the batteries as soon as possible. If the battery is totally out of power, then please use the Master Key to unlock and replace the new batteries.

Forget the card or Urgent Condition

- If you lose the User Card and can't unlock the cabinet, you can use the Master card to unlock and reset the User Card.
- In emergencies or when replacing the battery, use the administrator key to unlock. After unlocking, turn the key backs to the locked position, then pull it out. Now the lock can be used again.

Please rotate to unlock as directed

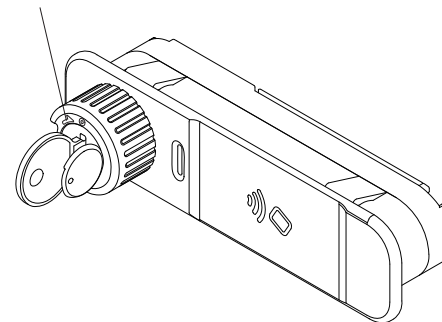

After opening, remember to turn it back to the locked position and pull it out (indicator window will be red)

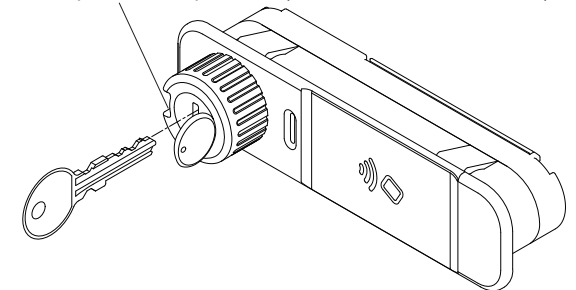

AL7005 FCC Approval

● This device complies with part 15 of the FCC Rules. Operation is subject to the following two conditions:

(1) This device may not cause harmful interference, and

(2) this device must accept any interference received, including interference that may cause undesired operation.

NOTE: This equipment has been tested and found to comply with the limits for a Class B digital device, pursuant to part 15 of the FCC Rules. These limits are designed to provide reasonable protection against harmful interference in a residential installation.

This equipment generates, uses and can radiate radio frequency energy and, if not installed and used in accordance with the instructions, may cause harmful interference to radio communications. However, there is no guarantee that interference will not occur in a particular installation.

If this equipment does cause harmful interference to radio or television reception, which can be determined by turning the equipment off and on, the user is encouraged to try to correct the interference by one or more of the following measures:

—Reorient or relocate the receiving antenna.

—Increase the separation between the equipment and receiver.

—Connect the equipment into an outlet on a circuit different from that to which the receiver is connected.

—Consult the dealer or an experienced radio/TV technician for help.

Changes or modifications not expressly approved by the party responsible for compliance could void the user's authority to operate the equipment.

● This equipment complies with FCC radiation exposure limits set forth for an uncontrolled environment. This equipment should be installed and operated with a minimum distance of 20 cm between the radiator and a human body.