



V380 Pro

Download

Search for "V380 Pro" in the App store or scan the QR code below to download and install the V380 Pro APP.



Scan the QR code to download the V380 Pro APP

Reset the camera

- 1.Power on the camera.
- 2.Press and hold the reset button for several seconds,the camera will prompt "Restore factory default setting".

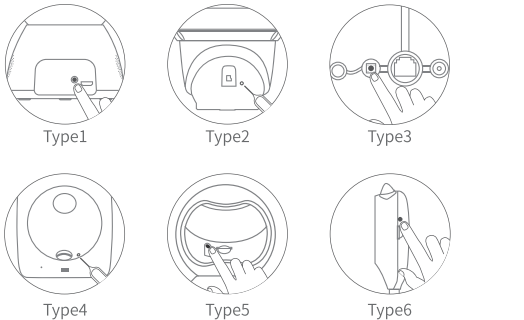

Note:The position of the reset button is for reference only,depending on your device.

Scan the QR code to configure the network

Note:Turn on your phone's WiFi before you add a camera.

Scan the QR code tag

- 1.Open V380 Pro APP to register your account and login,click the "+" button on the home page.
- 2.Scan the QR code of the camera body tag with your phone.

Note:Camera body QR code tags usually at the bottom or on the side of the device.



- 3.The bulb panoramic cameras don't support scan QR code to add cameras, please select AP hotspot to connect cameras.
- Note:When the APP version is upgraded,please take the actual APP interface as the basis.

Scan the QR code below for Tutorial Videos when you need.



If the camera body tag is damaged,you can scan the QR code below to configure the network.



WiFi selection

- 1.Connect your mobile phone to 2.4GHz WiFi first.
- 2.Confirm the connected WiFi and enter the password.

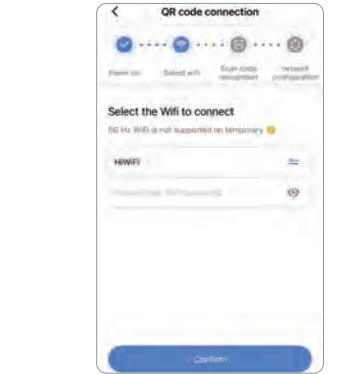

Note:Please select WiFi without "5G",The WiFi name should not contain any special characters.

QR code configuration

- 1.The APP will generate the QR code and then use camera to scan this QR code.
- 2.After the camera identifies the QR code successfully,it will prompt "Configuration received".Click "I have heard the tone" in the APP after hearing that tone.
- 3.After the connection completed,it will prompt "WiFiconnected".

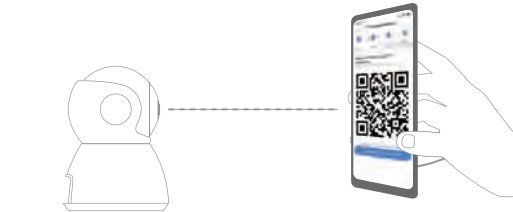

Adding completed

- 1.The APP automatically connects the camera.
- 2.After the camera is successfully networked,you can create groups for the camera and set the name.

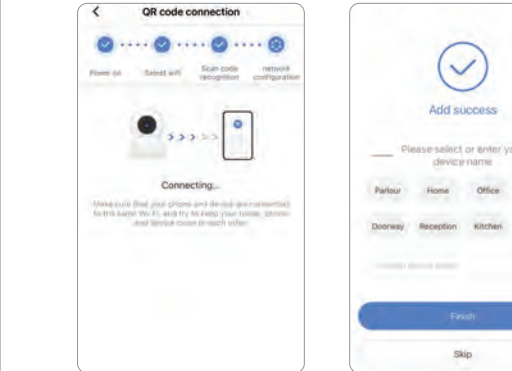

Hotspot configuration

- 1.Click "Can't find the QR code on the device?".
- 2.Select "WiFi Smart Camera"- "AP hotspot connection".

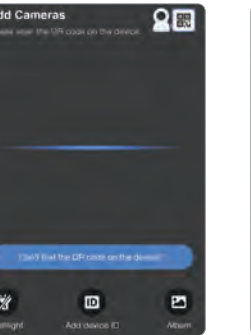

Note:Please connect your phone to wifi required by your device first.

Android

- 1.Select WiFi and enter your WiFi password.
- 2.Select "Connect AP hotspot"button and connect to the device hotspot(MV+ID).
- 3.The device will automatically connect to WiFi after returning to the APP.

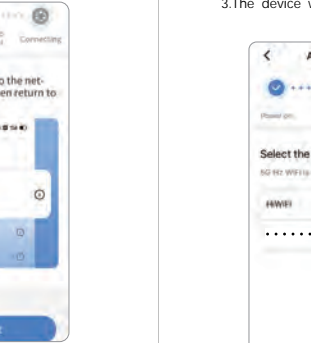
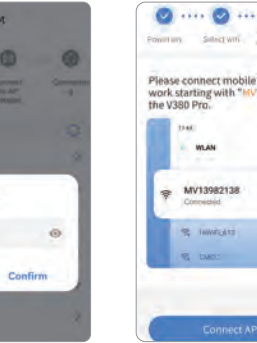

Note:You can find the corresponding ID on the device body tag which is for the hotspot's name.

iOS

- 1.Enter your WiFi password.(If you want to connect to other WiFi,please connect your mobile phone to the WiFi you need and then return to the APP to refresh).
- 2.Select "Connect AP hotspot"button and connect to the device hotspot(MV+ID).
- 3.The device will automatically connect to WiFi after returning to the APP.

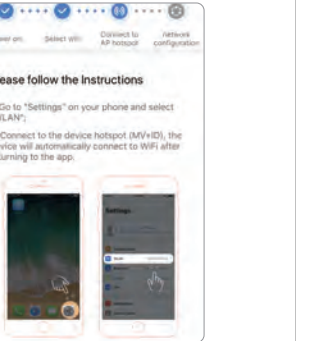

Real-time preview

The added camera can be viewed in the device list,and the real-time preview interface can be viewed by selecting the camera.

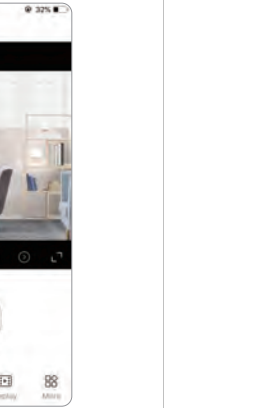

Video replay

After connecting the camera in the APP,open the real-time preview interface,and click "Replay" in the function bar.

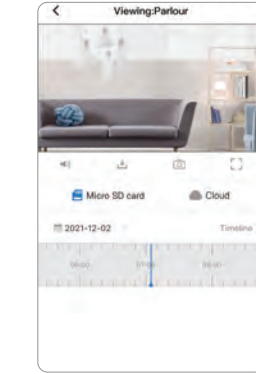

Video recording with Micro SD card

Before installing the Micro SD card,power off the camera first,and then turn on the power after installation.

· Ordinary camera supports up to 128G capacity of the TF card.

The format of 32G and below is "FAT32".

The format of 64G and above is "exFAT".

Settings

In the device list,click - -1Recording settingsl.

1.Recording settings

· Continuous recording:continuous recording will be performed during the working period of the camera.

· Event recording:recording will be started only when the alarm is triggered.

· Record audio:whether audio is included during recording.

2.Video quality setting

· You can set the quality of video by yourself:HD or SD.

FAQ

Q:The camera can't connect to WiFi.

A:

1.The wrong password is a common cause of connection failure.Please confirm whether the password entered is correct.

2.Please confirm that the connected WiFi is 2.4GHz.If you use a

2.4GHz-5GHz dual-band router,please select 2.4GHz WiFi.

3.The WiFi name should not contain special symbols and should not be hidden.The restrictions such as AP isolation and WiFi squatter prevention of the router cannot be opened.

Q:There is a prompt "Device offline" in the device list.

A:

1.Please restart the camera and confirm that the camera can start normally and connect to WiFi.

2.Please turn off the router functions of the firewall,blacklist,WiFi squatter prevention,MAC address binding,etc.To support remote preview,which

requires the router to connect to WAN.

3.If the router is replaced or the WiFi password is changed,please reset the camera and reconfigure the network.

FCC Warning Statement

Changes or modifications not expressly approved by the party responsible for compliance could void the user's authority to operate the equipment. This equipment has been tested and found to comply with the limits for a Class B digital device, pursuant to Part 15 of the FCC Rules. These limits are designed to provide reasonable protection against harmful interference in a residential installation. This equipment generates uses and can radiate radio frequency energy and, if not installed and used in accordance with the instructions, may cause harmful interference to radio communications. However, there is no guarantee that interference will not occur in a particular installation. If this equipment does cause harmful interference to radio or television reception, which can be determined by turning the equipment off and on, the user is encouraged to try to correct the interference by one or more of the following measures:

Reorient or relocate the receiving antenna.
Increase the separation between the equipment and receiver.

Connect the equipment into an outlet on a circuit different from that to which the receiver is connected.

Consult the dealer or an experienced radio/TV technician for help.

This device complies with part 15 of the FCC Rules. Operation is subject to the following two conditions: (1) This device may not cause harmful interference, and

(2) this device must accept any interference received, including interference that may cause undesired operation.

RF Exposure Statement

To maintain compliance with FCC's RF Exposure guidelines, This equipment should be installed and operated with minimum distance of 20cm the radiator your body. This device and its antenna(s) must not be co-located or operation in conjunction with any other antenna or transmi