

# A42

## Thermal Printer

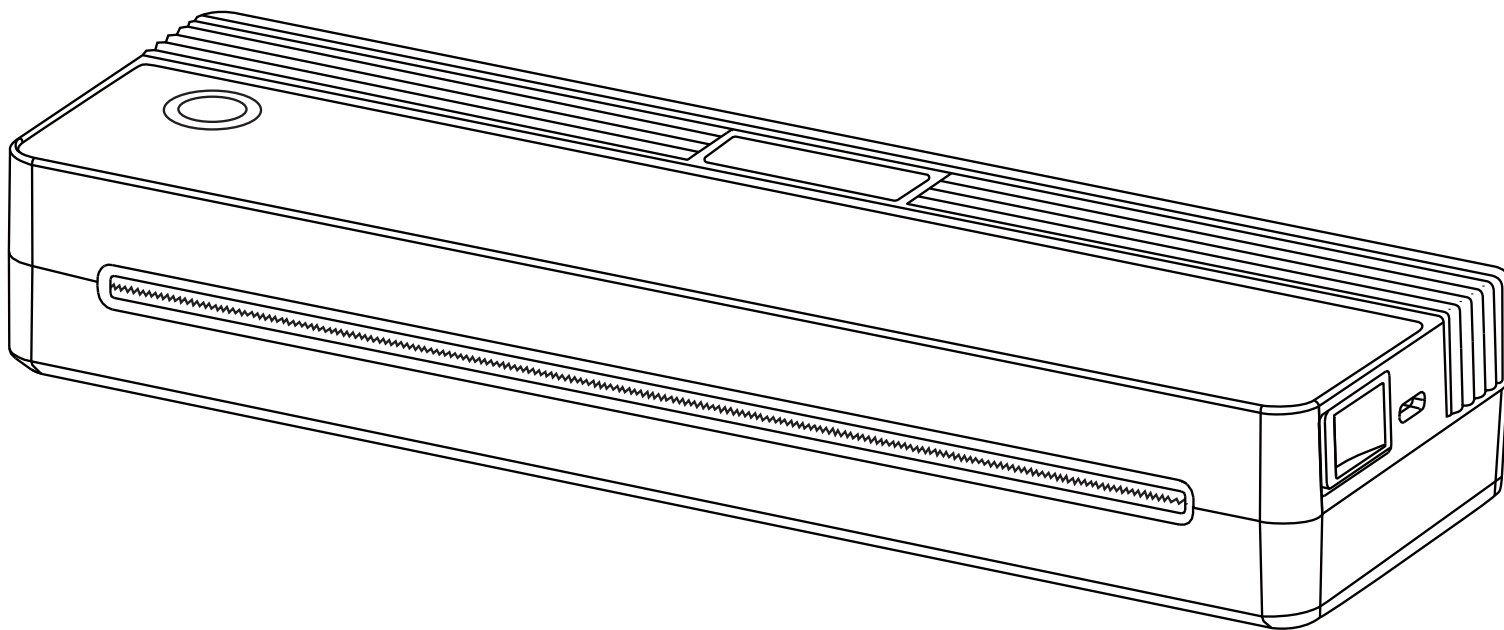

Instruction manual

# Specifications

Product Name	Thermal Printer
Model	A42
Net Weight	About 620g
Size	262*80.7*47mm
Type	Thermal Print
Input Voltage	DC 5V
Battery Capacity	2000mAh
Auto Shut Down Time	30min
Standby Time	About 30 days
Full Charge time	About 1.50H
Continuous printing	90 sheets of A4 thermal paper
Printing Width	210mm
Charge Port	Type-C
Wireless communications	Bluetooth

## Packing List

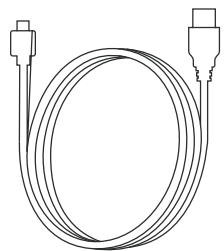

USB cabel\*1

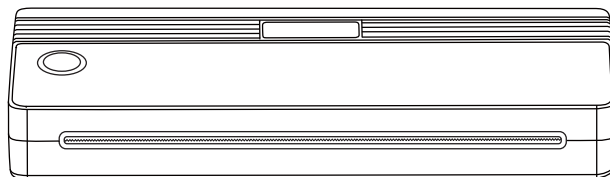

Printer host\*1

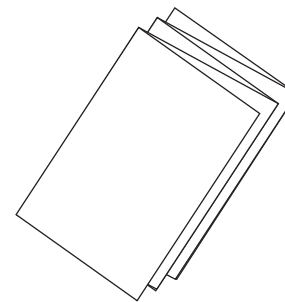

Manual\*1

## Appearance Introduction

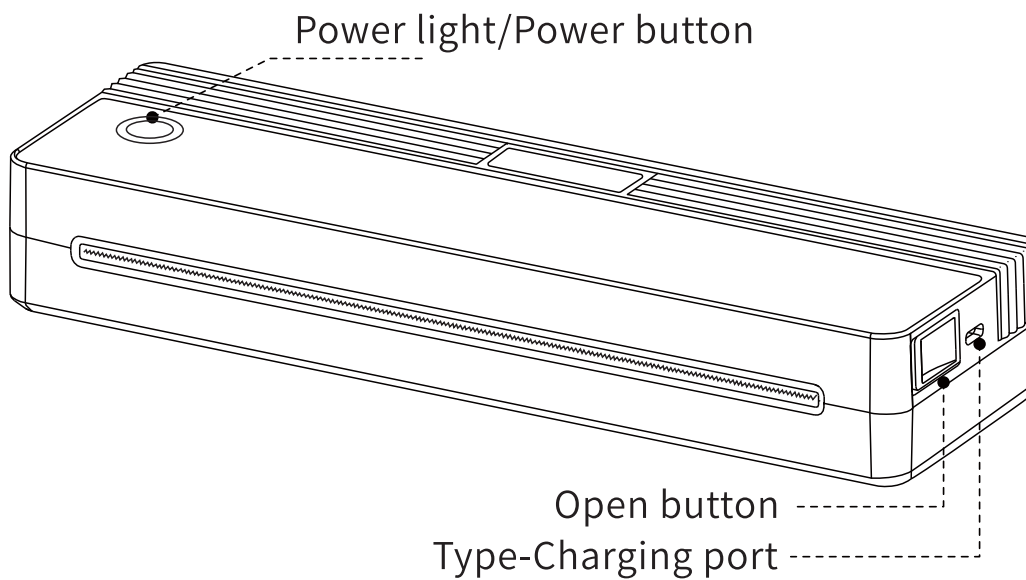

## Open cover mode

- Pull the open cover button on both sides of the machine to open the machine.

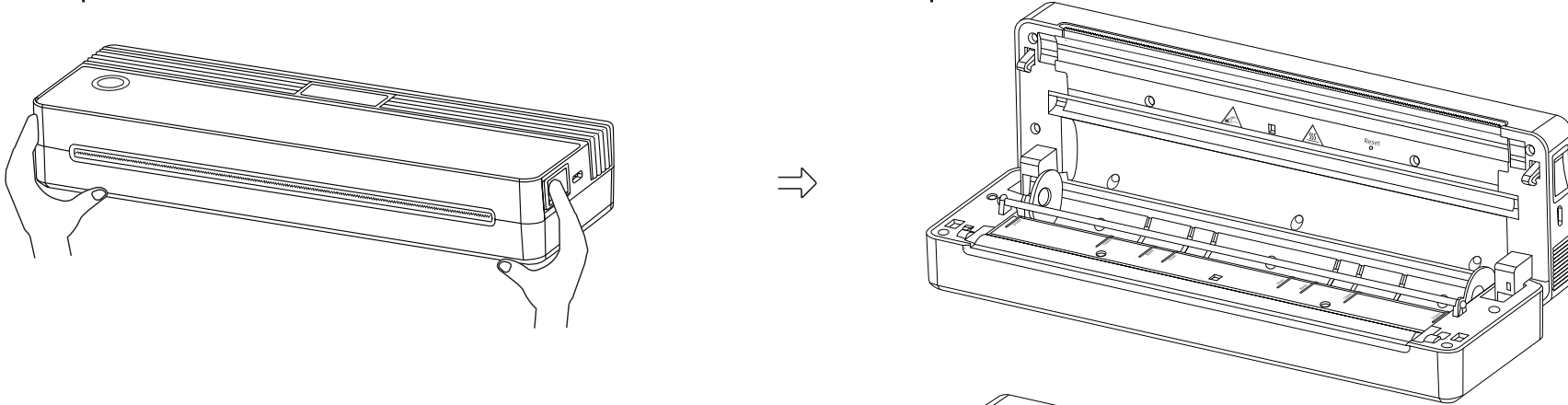

## Paper loading mode

### Way of wrapping paper

- Press the open button to open the paper bin and put the paper into the bin according to the diagram. Pay attention to both sides of the paper.

Printing surface  
on top

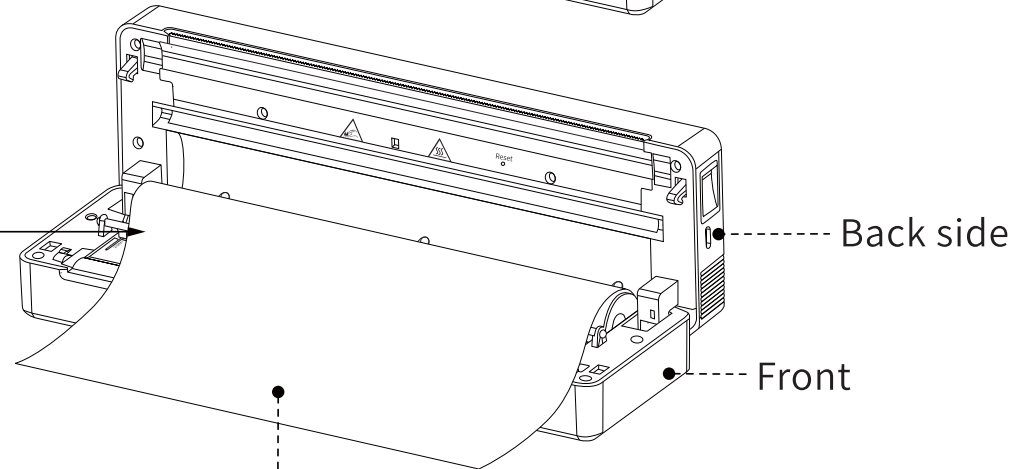

Paper needs to be exposed to the machine

## Folding method of paper loading

- ① Face up to ensure that the paper is parallel to the machine to prevent paper skew and paper jam;
- ② Align the paper inlet and insert it until the paper is sucked and cannot be removed or inserted.

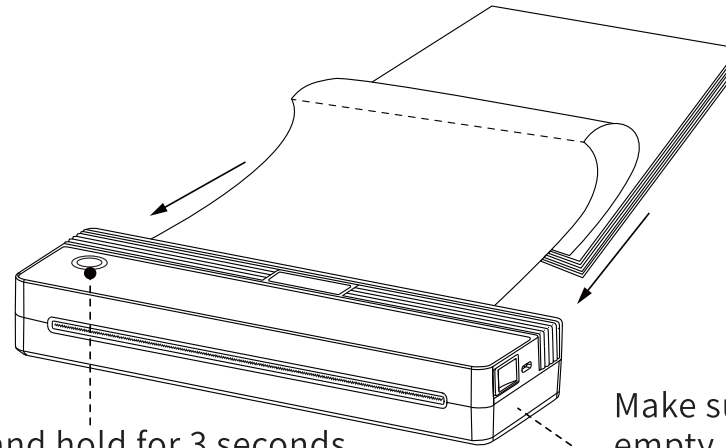

Press and hold for 3 seconds to switch on the machine.

Make sure the paper bin is empty and the lid is tightly closed before loading paper.

## Paper bin card pick installation

- Press the open cover button to open the paper bin, the pick according to different consumable width (2 inches, 3 inches, 4 inches, 8 inches) printing requirements Card position.

## Use process

- 1、For the first time, long press the power button for 3 seconds to start the device, and double-click the power button to print device information

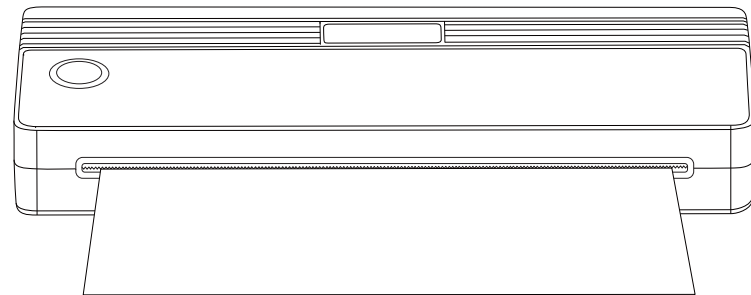
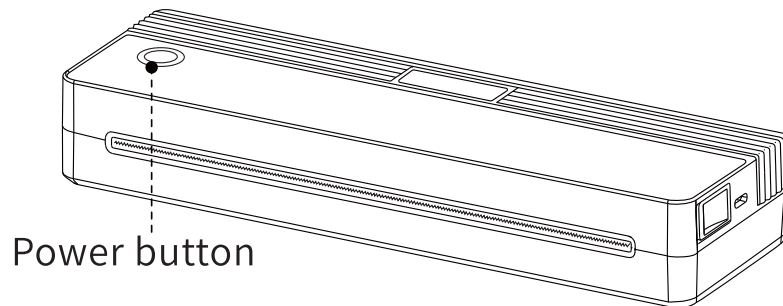

## 2、Software installation:

- ① Scan the corresponding QR code on the right to download;
- ② Apple users can search for iPrint in APPstore to download the APP;
- ③ Android users can search for iPrint in the app shop to download the app.



## 3、Click Connect Device to search for a Bluetooth connection and start printing after a successful connection:

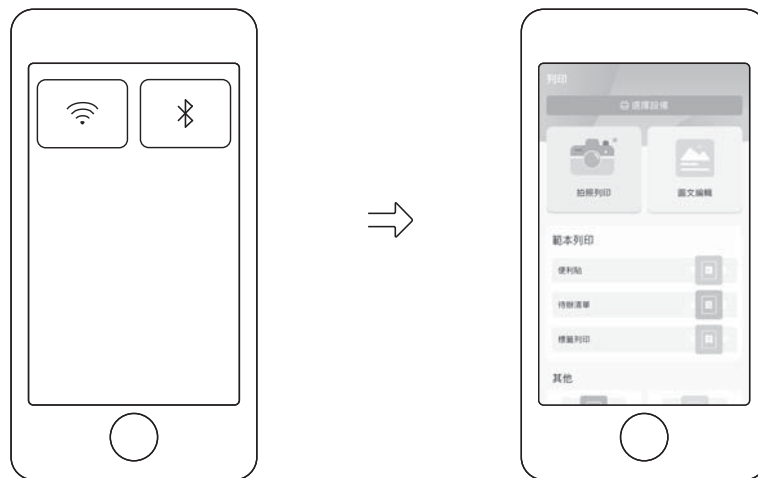

## Indicator light

- White light is always on:the printer is idle and not connected to Bluetooth
- Blue steady on:The Bluetooth connection is successful
- Blue blinking:Bluetooth connection successful Data is being transferred or printed
- Steady red:The battery is low
- Blinking red:The device status is abnormal (lack of paper/overheat/open cover)
- Yellow light flashes quickly:cancellation of data in
- Green light is always on:fully charged (when the device is switched off)

## Power button

- Press and hold the power button for 3S to turn on or off, turn on when the indicator is on, and turn off when the indicator is off
- Double-click the power button to spit out the device information slip and two-dimensional code to check the device status

## Common problem

Q:Can't print, what to do?

- A: ① Confirm whether the Bluetooth of the mobile phone is turned on, and exclude the possibility of others connecting to the printer;  
② Check whether the printer is properly connected;  
③ Check whether the thermal paper has been used up and replace the printing paper in time;  
④ If the print head is overheated, please wait for the print head to cool down before trying to print;  
⑤ Restart the printer. If the problem persists, insert a thin metal needle into the reset hole;  
⑥ Call customer service.

Q:Why is it printed on white paper with no content?

A:This may be a problem caused by the printer paper not installed correctly, please try to place the printer paper on the reverse side.

## Description of hazardous substances in products

Component name	Harmful substance					
	Plumbum (Pb)	Mercury (Hg)	Cadmium (Cd)	Hexavalent chromium (Cr(VI))	Polybrominated biphenyls (PBB)	Polybrominated diphenyl ethers (PBDE)
Circuit board	×	○	○	○	○	○
Shell	○	○	○	○	○	○
Screw	○	○	○	○	○	○
Packaging material	○	○	○	○	○	○

This form is prepared in accordance with the provisions of SJ/T 11364-2014  
 ○:Indicates that the content of the hazardous substance in all homogeneous materials of the part is below the limit requirements specified in GB/T 26572-2011.  
 ×:Indicates that the content of the hazardous substance in at least one homogeneous material of the part exceeds the limit requirements specified in GB/T 26572-2011, and there is currently no mature alternative in the industry to meet the environmental requirements of the EU RoHS Directive.

	<p>The number in this label indicates that the environmental protection service life of the product under normal use is 10 years. Some components may also have an environmental service life label, and its environmental service life is determined by the number in the label.</p>
---	---





Instructions:  
 Circuit board:Lead in ceramic or glass of electronic components on boards/circuit modules.



## Warning:

- This product has built-in lithium battery, do not use in the temperature above 40°C environment, do not near the open flame and other heat sources, do not place in the hot sun, such as unmanned, closed car;
- Do not disassemble, hit, puncture or modify the battery, do not use the battery for other purposes;
- Do not handle in fire or water to avoid fire or burn caused by short circuit of battery;
- Operating temperature range is 0°C to 40°C, please do not operate outside the recommended temperature range;
- Used batteries should be recycled or disposed of in accordance with local regulations and product instructions.
- If you suspect a battery problem, contact an after-sale service center for help.

## Note:

- Replacing the battery with the wrong model may cause explosion. Dispose of the used battery according to the instructions;
-   70°C  Note the maximum temperature of the print head is 70°C, please be careful not to touch it, children must be used under adult supervision;
-   Note that the tearing blade is sharp, please be careful not to touch it.

## Special instructions:

- Since this product is not sold with a power adapter, please configure it in accordance with CCC certification。

## **FCC Statement**

Any Changes or modifications not expressly approved by the party responsible for compliance could void the user's authority to operate the equipment.

This device complies with part 15 of the FCC Rules. Operation is subject to the following two conditions:

- (1) This device may not cause harmful interference, and
- (2) This device must accept any interference received, including interference that may cause undesired operation.

## **FCC Radiation Exposure Statement:**

This equipment complies with FCC radiation exposure limits set forth for an uncontrolled environment .This equipment should be installed and operated with minimum distance 20cm between the radiator& your body. This transmitter must not be located or operating in conjunction with any other antenna or transmitter.

Note : This equipment has been tested and found to comply with the limits for a Class B digital device, pursuant to part 15 of the FCC Rules. These limits are designed to provide reasonable protection against harmful interference in a residential installation. This equipment generates,uses and can radiate radio frequency energy and, if not installed and used in accordance with the instructions, may cause harmful interference to radio communications. However, there is no guarantee that interference will not occur in a particular installation. If this equipment does cause harmful interference to radio or television reception, which can be determined by turning the equipment off and on, the user is encouraged to try to correct the interference by one or more of the following measures:

- Reorient or relocate the receiving antenna.
- Increase the separation between the equipment and receiver.
- Connect the equipment into an outlet on a circuit different from that to which the receiver is connected.
- Consult the dealer or an experienced radio/TV technician for help.



The paper tearing blade has a sharp edge.  
Do not touch it to prevent getting cut.



- After printing, avoid direct contact with the print head to prevent overheating and potential scalding.
- Wait for at least thirty minutes after turning off the power before attempting to touch the print head.



The product is not suitable for children!