

## 中山市家贝电器有限公司

ZHONGSHAN JIABEI ELECTRICAL APPLIANCES CO., LTD



### 高穿透隔空无线充电器

High Penetration Long Distance Wireless Charger

地址: 中山市小榄镇绩东二怡笑街2号  
Add: No. 2, Jidong Er yixiao Street, Xiaolan Town,  
Zhongshan City  
手机: 13802664499 电话: 0760-22261806  
网址: www.jiabei888.com Q Q: 308021056  
邮箱: zsjabei888@163.com



#### 参数规格

型号	JB-WXC10	JB-WXC20	JB-WXC30
输入	12V=1.5A	12V=1.5A	12V=1.5A
无线充输出	10W(Max)	10W(Max)	10W(Max)
充电距离	5-10mm	5-20mm	5-30mm

#### 安装步骤

\* 请确保桌面是非金属材料，且厚度不超过产品可充电的最大距离。

① 连接适配器：请连接附带和适配器，使无线充电器通电。



② 贴充电区域标识贴：确定充电区域，对准位置贴上充电区域标识贴，确保桌面没有金属介质与桌下无金属横梁。

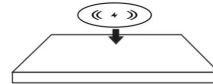

注意：如果是玻璃或大理石桌子的可选择3M胶固定方式。如果是木质桌子，可选择打螺丝固定方式。

③ 粘好无线充：

1) 3M胶固定方式：先将3M胶贴到无线充产品表面，将无线充对准桌面的充电区域，撕下无线充上面3M胶的贴纸，将无线充粘贴桌下。

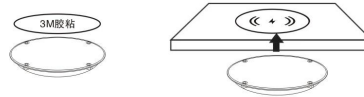

2) 螺丝固定方式：无线充对准桌面的充电区域，将无线充用螺丝固定到桌下。

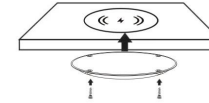

④ 将手机放在无线充电区域中心，显示充电即可使用。

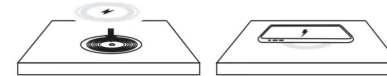

#### 注意

请勿私自拆卸设备。

充电器的有效充电距离是5-30mm，请勿将手机直接放置在充电器上，这样会触发充电器的异物检测功能。

请勿在无线充电贴上放置金属杂物或磁卡，可能会引起损坏或充电器不工作。

请在使用过程中如果遇到接收线圈或发射板过热停止充电，请移开充电设备，待冷却后重试。

\* 确保手机有无线充电功能。

请勿在高温或者潮湿的环境下使用或存放该无线充。

指示灯状态：

通电—红绿灯快闪2s后灭掉。

待机状态—指示灯熄灭。

正在充电—红灯常亮。

充满电—充电设备如果充满电后会发出充电完成信号，绿灯将亮。

## ZHONGSHAN JIABEI ELECTRICAL APPLIANCES CO., LTD



### 高穿透隔空无线充电器

High Penetration Long Distance Wireless Charger

Add: No. 2, Jidong Er yixiao Street, Xiaolan Town,  
Zhongshan City  
Tel: 13802664499 0760-22261806  
Site: www.jiabei888.com  
Q Q: 308021056  
Email: zsjabei888@163.com



#### Parameters

Model	JB-WXC10	JB-WXC20	JB-WXC30
Input	12V=1.5A	12V=1.5A	12V=1.5A
Wireless-Charging Output	10W(Max)	10W(Max)	10W(Max)
Charging Distance	5-10mm	5-20mm	5-30mm

#### Installation

\* Please ensure that the desktop is made of non-metallic material and the thickness does not exceed the maximum distance that the product can charge.

① Connect adapter: Please connect the included and adapter to power up the wireless charger.



② Stick charging area label: Determine the charging area, align it with the position, and stick the charging area label. Ensure that there is no metal medium on the desktop and no metal crossbeam under the desk.

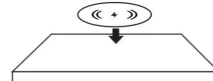

Attention: If it is a glass or marble table, 3M adhesive fixation method can be selected. If it is a wooden table, you can choose to fix it with screws.

③ Adhesive wireless charging:

1) 3M adhesive fixation method: First, apply 3M adhesive to the surface of the wireless charging product, align the wireless charging with the charging area on the desktop, remove the 3M adhesive sticker on top of the wireless charging, and stick the wireless charging under the table.



2) Screw fixation method: Align the wireless charger with the charging area of the desktop, and fix the wireless charger with screws under the table.

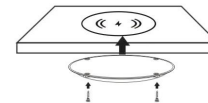

④ Place the phone in the center of the wireless charging area and display charging ready for use.



#### Attention

Do not disassemble the device without permission.

The effective charging distance of the charger is 5-30mm. Do not place the phone directly on the charger as this will trigger the foreign object detection function of the charger.

Do not place metal debris or magnetic cards on the wireless charging sticker as it may cause damage or the charger may not function.

If you encounter overheating in the receiving coil or transmitting board during use and stop charging, please remove the charging device and try again after it cools down.

\* Ensure that the phone has wireless charging function.

Do not use or store the wireless charger in high temperature or humid environments.

Indicator light status:

Power on - the traffic lights flash quickly for 2 seconds and then turn off.

Standby mode - The indicator light is off.

Charging - the red light is constantly on.

Fully charged - If the charging device is fully charged, it will issue a charging completion signal and the green light will be on.

This device complies with Part 15 of the FCC Rules. Operation is subject to the following two conditions: (1) this device may not cause harmful interference, and (2) this device must accept any interference received, including interference that may cause undesired operation

NOTE: This equipment has been tested and found to comply with the limits for a Class B digital device, pursuant to Part 15 of the FCC Rules. These limits are designed to provide reasonable protection against harmful interference in a residential installation. This equipment generates, uses and can radiate radio frequency energy and, if not installed and used in accordance with the instructions, may cause harmful interference to radio communications. However, there is no guarantee that interference will not occur in a particular installation.

If this equipment does cause harmful interference to radio or television reception, which can be determined by turning the equipment off and on, the user is encouraged to try to correct the interference by one or more of the following measures:

- Reorient or relocate the receiving antenna.
- Increase the separation between the equipment and receiver.
- Connect the equipment into an outlet on a circuit different from that to which the receiver is connected.
- Consult the dealer or an experienced radio/TV technician for help.

Warning: changes or modifications not expressly approved by the party responsible for compliance could void the user's authority to operate the equipment

#### Radiation Exposure Statement

This equipment complies with FCC radiation exposure limits set forth for an uncontrolled environment.

This equipment should be installed and operated with minimum distance 20cm between the radiator and your body.